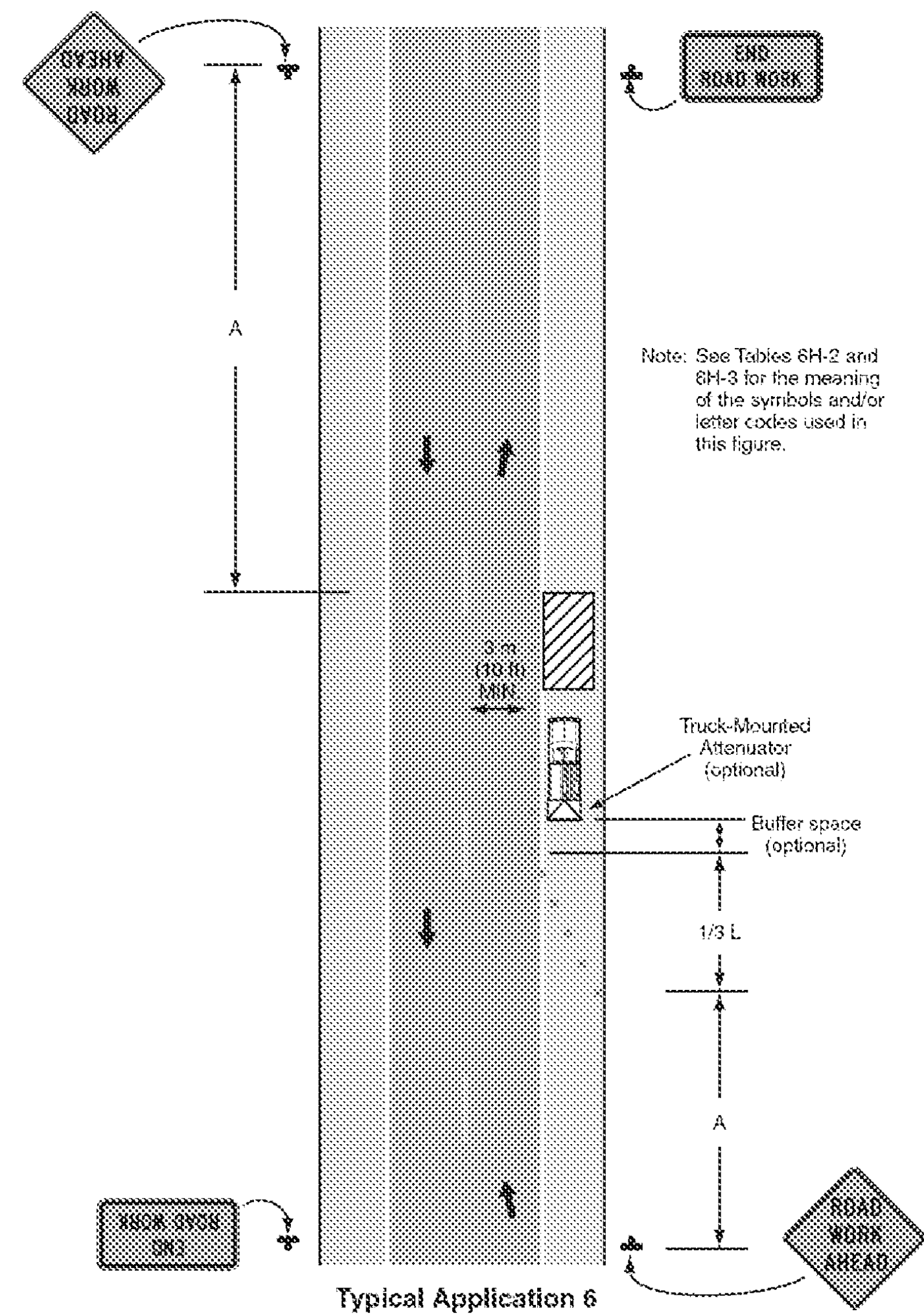
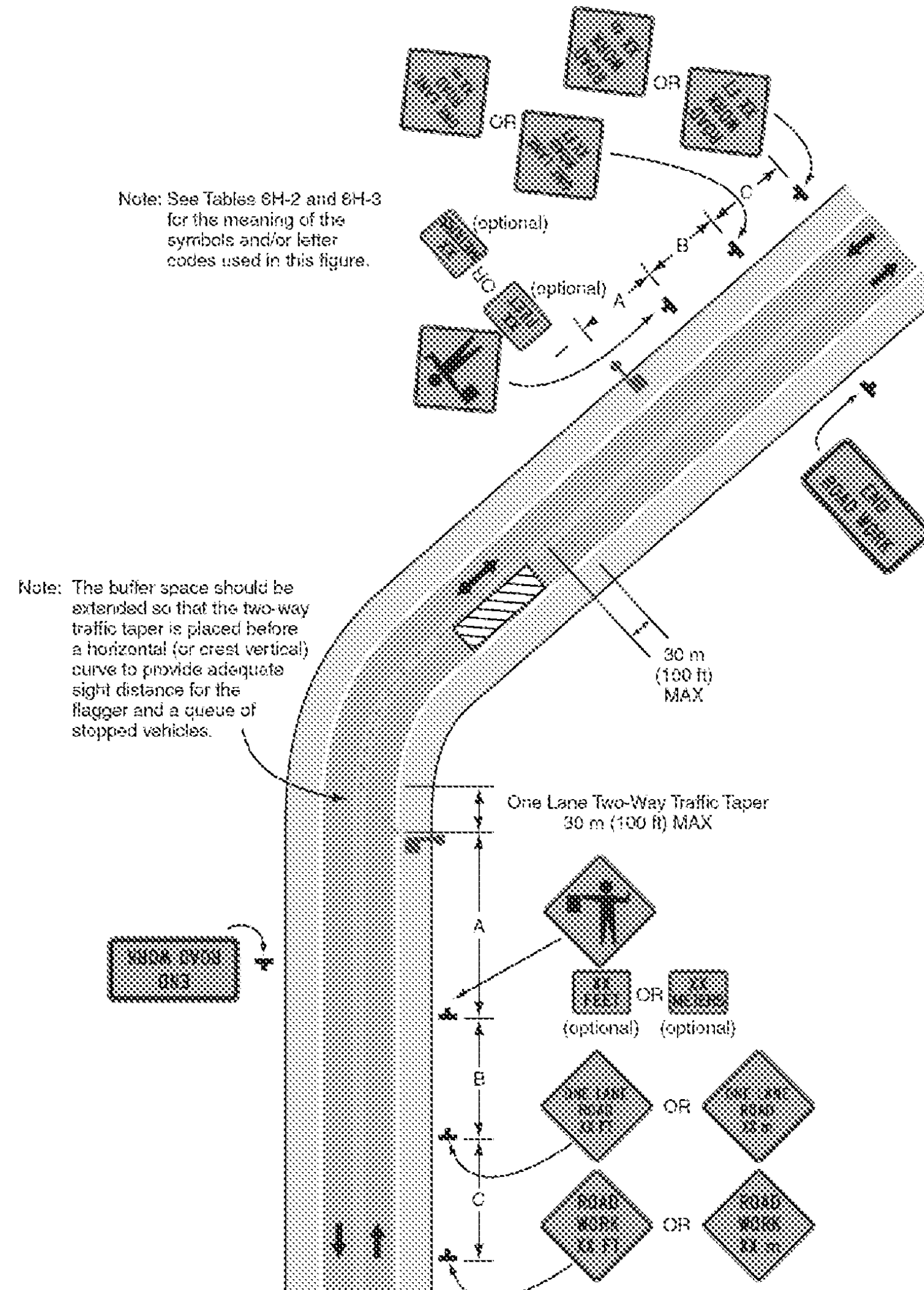

Figure 6H-6. Shoulder Work with Minor Encroachment (TA-6)



Typical Application 6

Figure 6H-10. Lane Closure on Two-Lane Road Using Flaggers (TA-10)



Typical Application 10

Figure 6H-22. Right Lane Closure on Far Side of Intersection (TA-22)

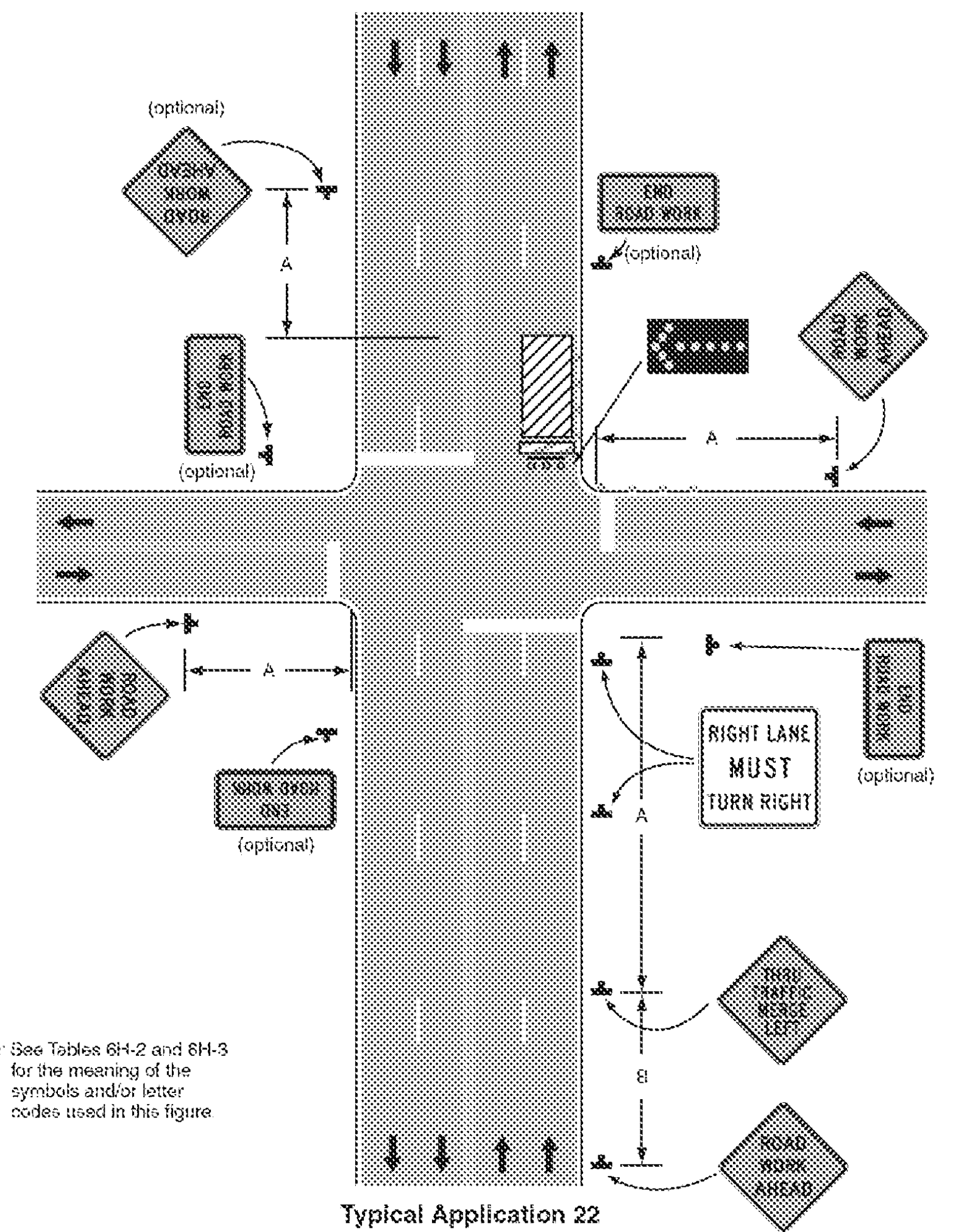

Typical Application 22

Notes for Figure 6H-22---Typical Application 22  
Right Lane Closure on Far Side of Intersection

- Guidance:
1. If the work space extends across a crosswalk, the crosswalk should be closed using the information and devices shown in Figure 6H-29.
- Option:
2. The normal procedure is to close on the near side of the intersection any lane that is not carried through the intersection. However, when this results in the closure of a right lane having significant right turning movements, then the right lane may be restricted to right turns only, as shown. This procedure increases the through capacity by eliminating right turns from the open through lane.
  3. For intersection approaches reduced to a single lane, left-turning movements may be prohibited to maintain capacity for through vehicular traffic.
  4. Flashing warning lights and/or flags may be used to call attention to the advance warning signs.
  5. Where the turning radius is large, it may be possible to create a right-turn island using channelizing devices or pavement markings.

**TRAFFIC CONTROL  
DETAILS  
SHEET 3**

PROJECT NAME: ROYALTON-MIDDLESEX

PROJECT NUMBER: IMG SIGN(19)

FILE NAME: z09a020+cp.dgn

PLOT DATE: 8/12/2009

PROJECT LEADER: CRB

DRAWN BY: JJB

DESIGNED BY: JJB

CHECKED BY: BDB

CLD REF. NO.: 09-0106

SHEET 160 OF 163