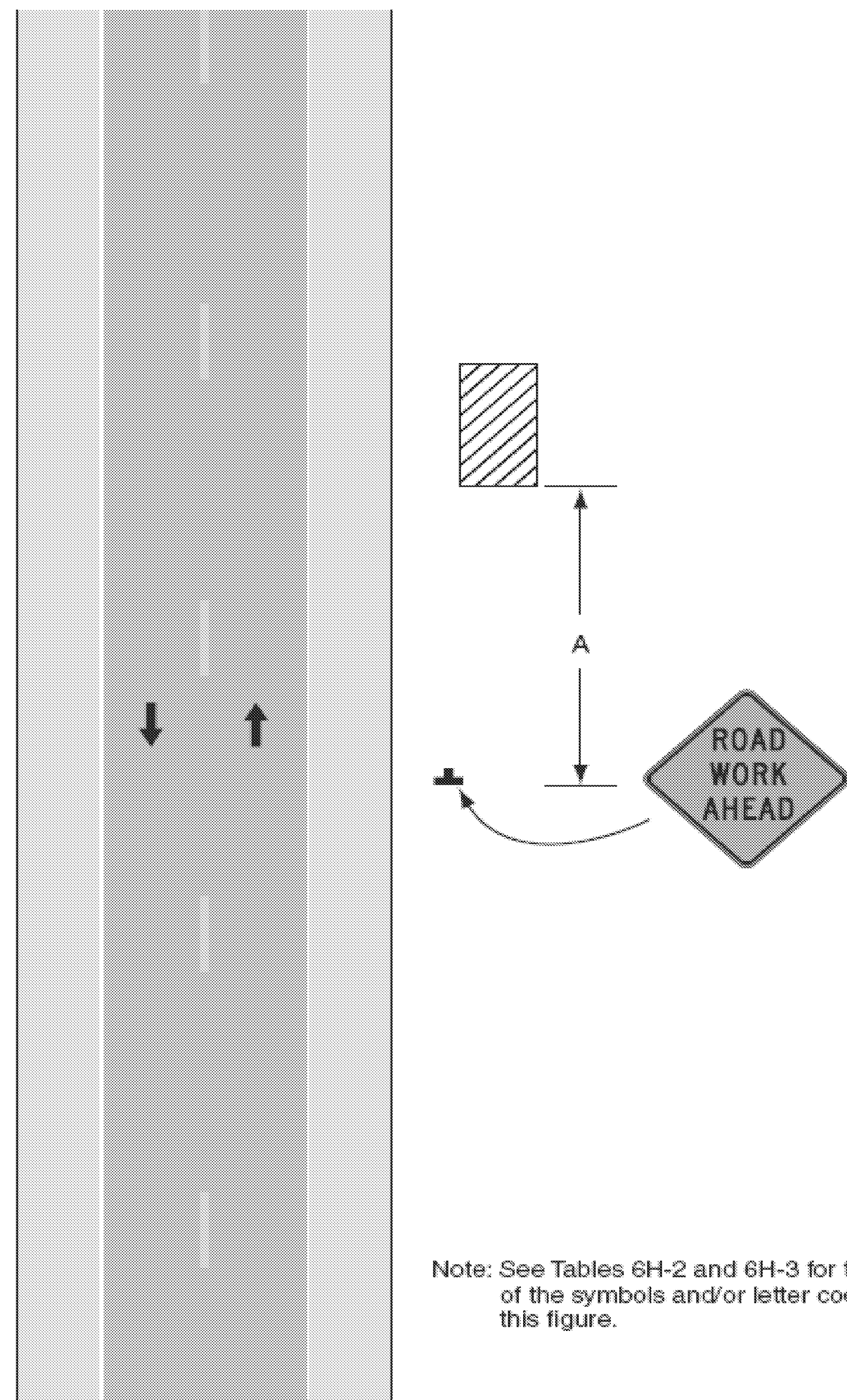
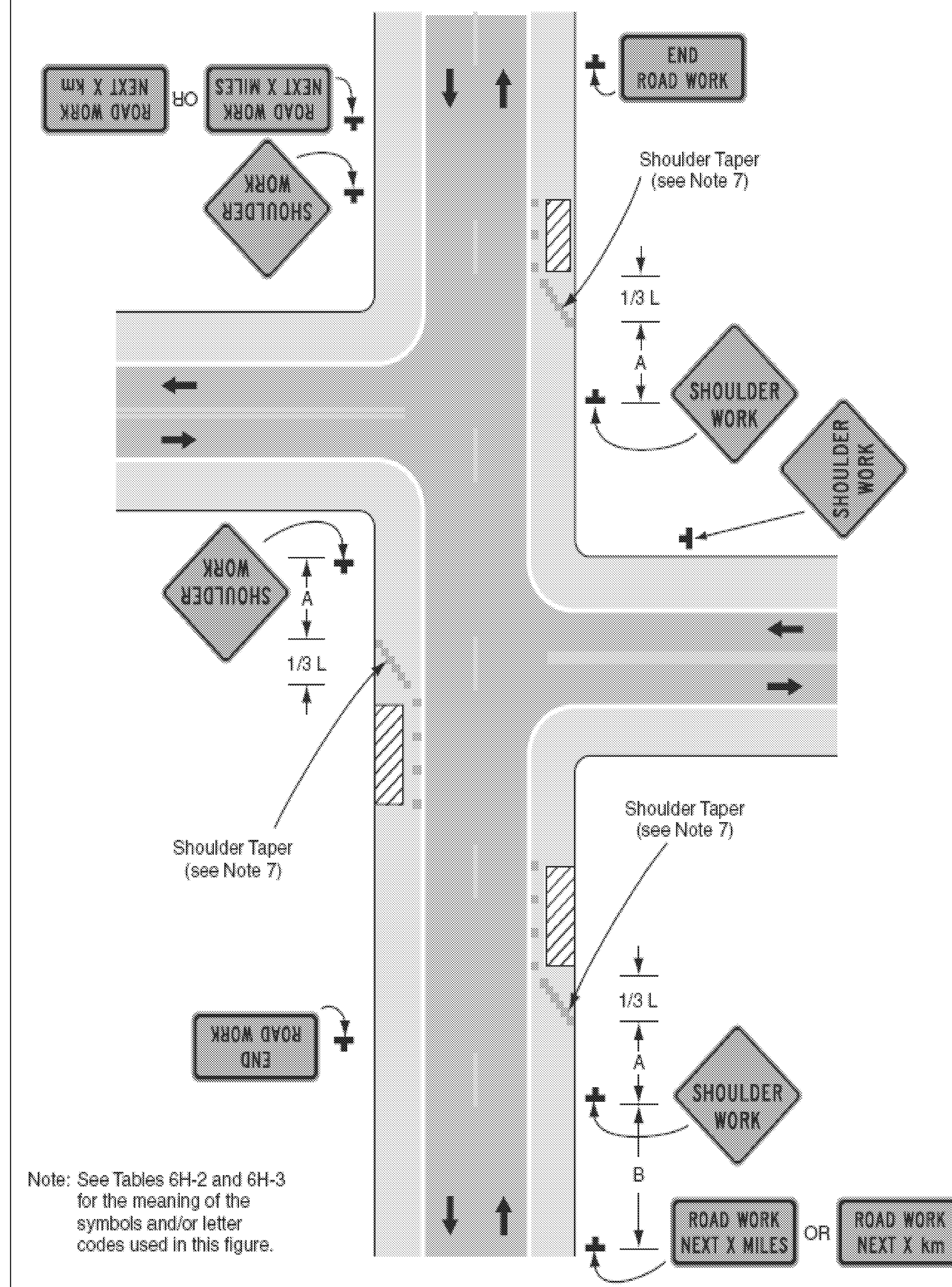

Figure 6H-1. Work Beyond the Shoulder (TA-1)



Typical Application 1

Figure 6H-3. Work on Shoulders (TA-3)



Typical Application 3

Figure 6H-4. Short-Duration or Mobile Operation on Shoulder (TA-4)

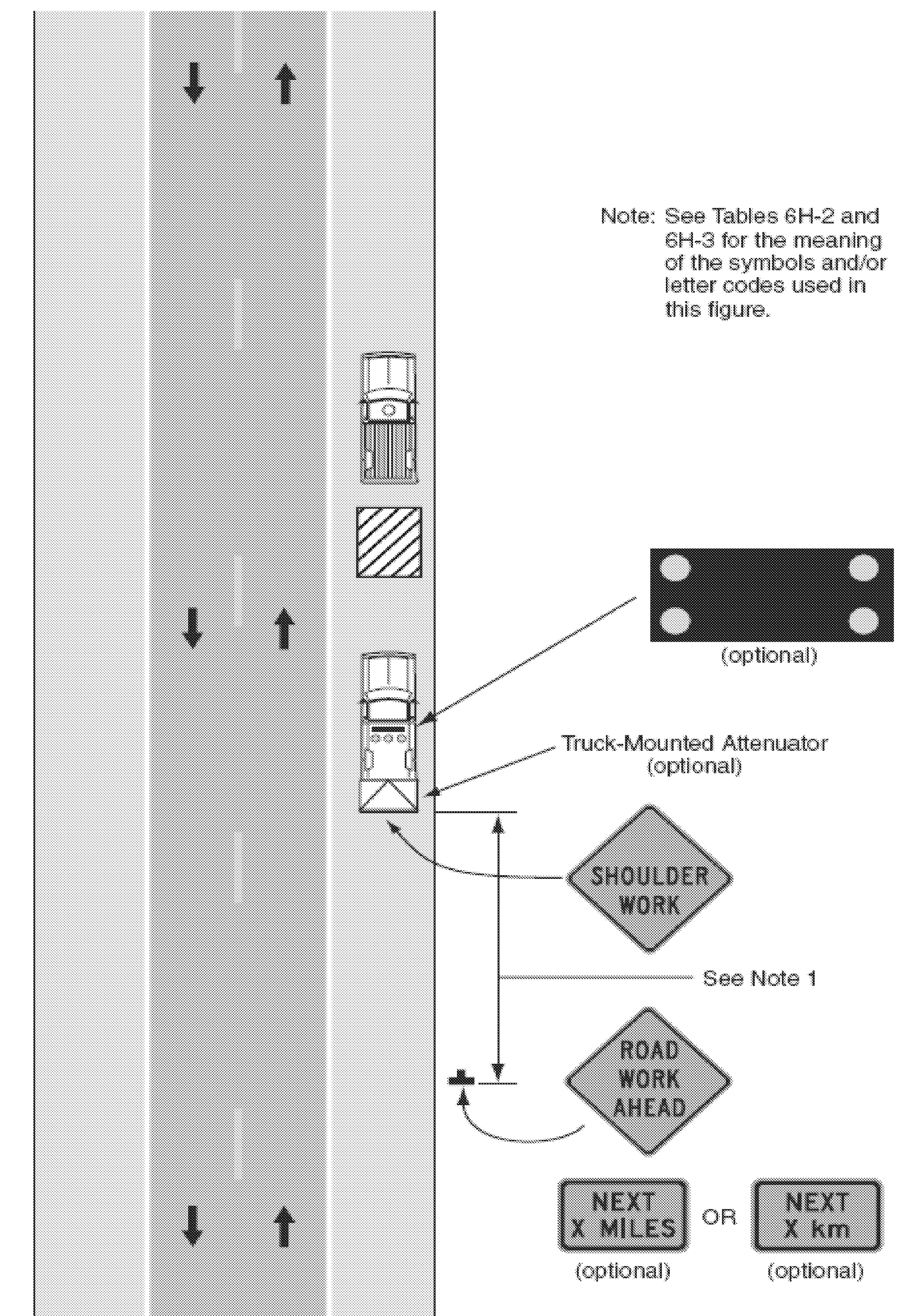

Typical Application 4

Table 6H-3. Meaning of Letter Codes on Typical Application Diagrams

Road Type	Distance Between Signs**		
	A	B	C
Urban (low speed)*	30 (100)	30 (100)	30 (100)
Urban (high speed)*	100 (350)	100 (350)	100 (350)
Rural	150 (500)	150 (500)	150 (500)
Expressway / Freeway	300 (1,000)	450 (1,500)	800 (2,640)

* Speed category to be determined by highway agency

** Distances are shown in meters (feet). The column headings A, B, and C are the dimensions shown in Figures 6H-1 through 6H-4. The A dimension is the distance from the transition or point of restriction to the first sign. The B dimension is the distance between the first and second signs. The C dimension is the distance between the second and third signs. (The third sign is the first one in a three-sign series encountered by a driver approaching a TTC zone.)

TRAFFIC CONTROL DETAILS SHEET 2

PROJECT NAME: COLCHESTER-HIGHGATE

PROJECT NUMBER: IMG SIGN (17)

FILE NAME: 09A016.DGN

PROJECT LEADER: EPD

DESIGNED BY: BMB

PLOT FILE: 09A016TCD-2.1

PLOT DATE: 8/21/2009

DRAWN BY: BMB

CHECKED BY: EPD

SHEET 213 OF 221