

Plan

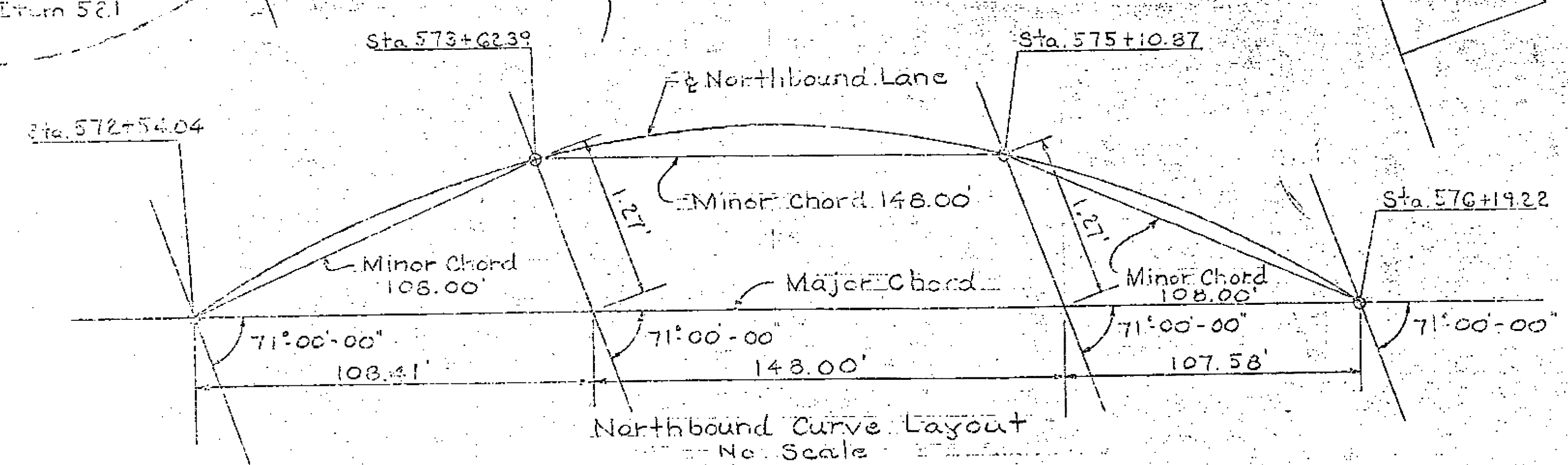

Northbound Curve Layout  
No. Scale

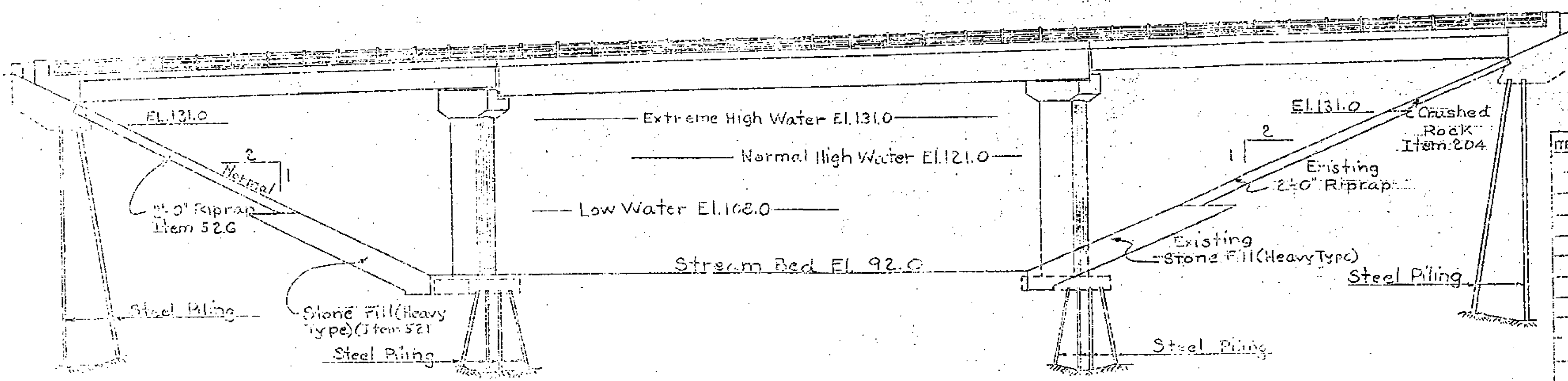

Elevation

List of Bridge Sheets

- BR 200 Superstructure Plan & Elevation
- BR 201 Bridge Quantity Sheet
- BR 202 Preliminary Information
- BR 203 Easings
- BR 204 Framing and Railing Plan
- BR 205 Details of Abutment #1
- BR 206 Details of Abutment #2
- BR 207 Details of Pier #1
- BR 208 Details of Pier #2
- BR 209 Approach Slab #1
- BR 210 Approach Slab #2
- BR 211 Reinforcing Steel Schedule
- BR 212-216 Channel Sections

- Bridge Standards
- SCWPG-30-62 Sheets 1-4
  - SB-56-62 Sheets 1&2
  - SCB-02-62, SCB-06-62

Reference Sheets

- Interstate Plan (Scale 1"=50')
- Interstate Profile

Notes

1. For General Notes see Pier #1 sheet.
2. Superstructure to be as per Std. SCWPG-30-62
3. Bridge railing to be as per Std. SB-56-62
4. Bridge curb to be as per Std. SCB-06-62.
5. Railing posts to be set normal to grade.
6. For summary of quantities see Bridge Quantity Sheet.
7. All girders parallel to minor chords.
8. Stations are true length only along sun line.

ST. ALBANS - HIGHGATE  
IM BPNT(4)  
SHEET 20 OF 32  
BRIDGE 96N&S  
FOR REFERENCE ONLY

ITEM NO.	ITEM	UNIT	NET	TOTAL	FINAL
	CHAN. EXCAV. OF EARTH	C.Y.			
	CHAN. EXCAV. OF ROCK	C.Y.			
	UT. CLASS. CHAN. EXCAV.	C.Y.			
	STRUCT. EXCAV.	C.Y.			
	CONC. CLASS. AA (MOD.)	C.Y.			
	CONC. CLASS. B (MOD.)	C.Y.			
	STEEL	LB.			
	ASPHALT FIBER COATING	S.Y.			
	CRUSHED ROCK (MOD.)	C.Y.			
	CRUSHED ROCK (REG.)	C.Y.			
	STONE FILL (HEAVY TYPE)	C.Y.			
	STONE FILL (REG.)	C.Y.			

STATE OF MISSISSIPPI  
DEPARTMENT OF TRANSPORTATION

TOWN OF Swanton-Highgate  
ROUTE NO. 189  
Missisquoi River Bridge No. 1  
Superstructure Plan & Elevation  
SCALE: 1"=20'

DESIGNED BY Webster Martin  
CHECKED BY A.J.C.  
DATE 11/10/51  
BR-200 OF 210