

FRAMING PLAN-LEFT LANE  
Scale: 1" = 20'

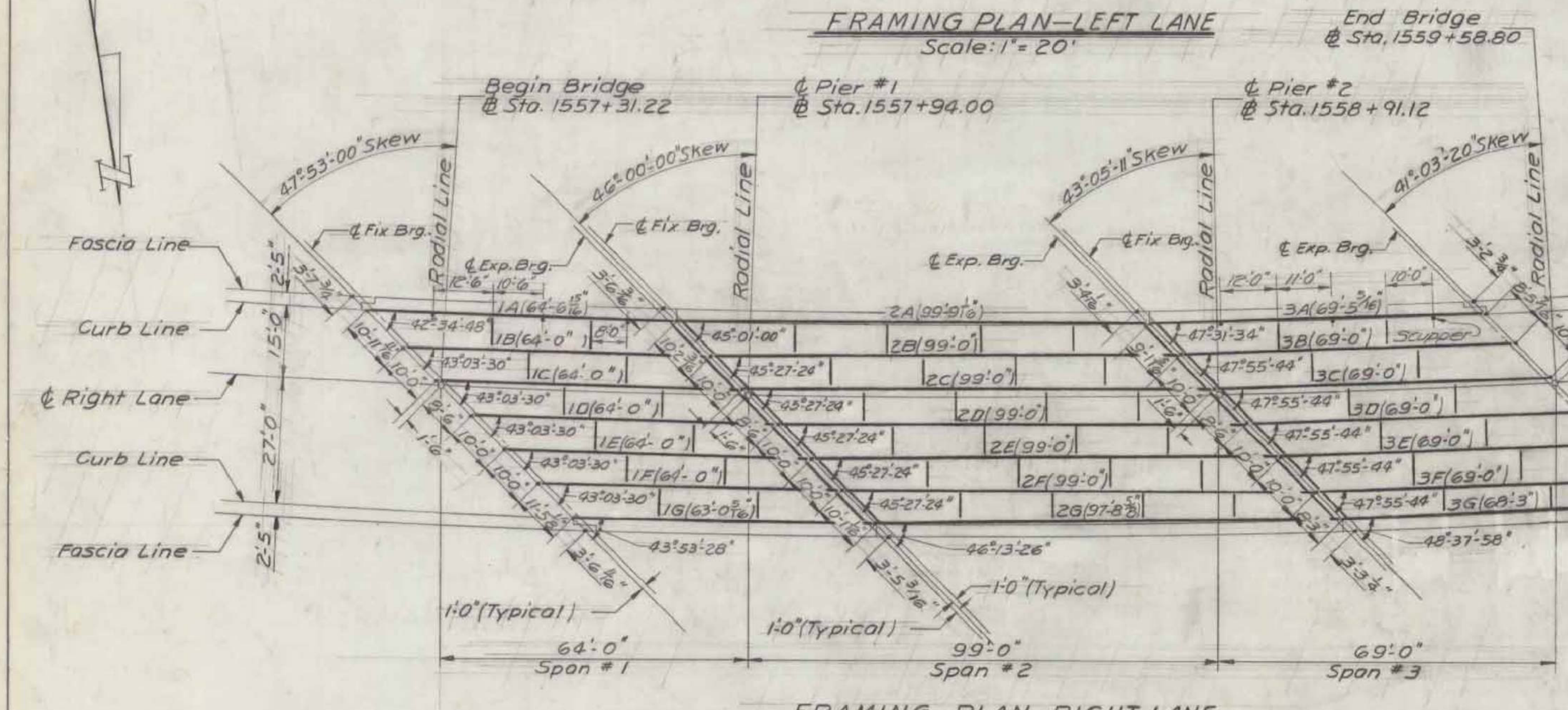

FRAMING PLAN-RIGHT LANE  
Scale: 1" = 20'

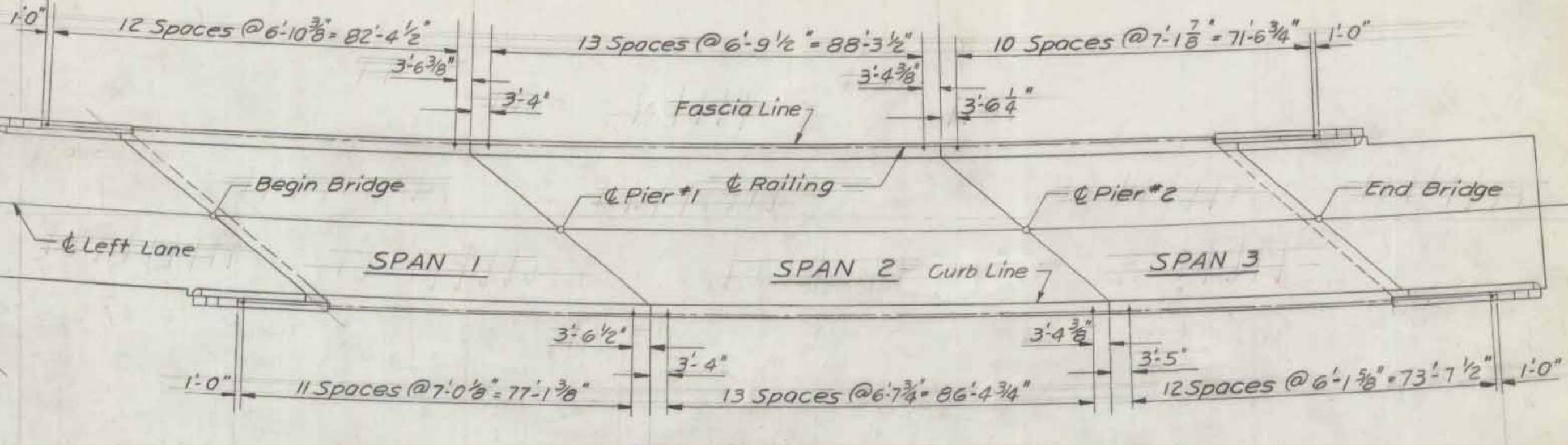

RAILING PLAN-LEFT LANE  
Scale: 1" = 20'

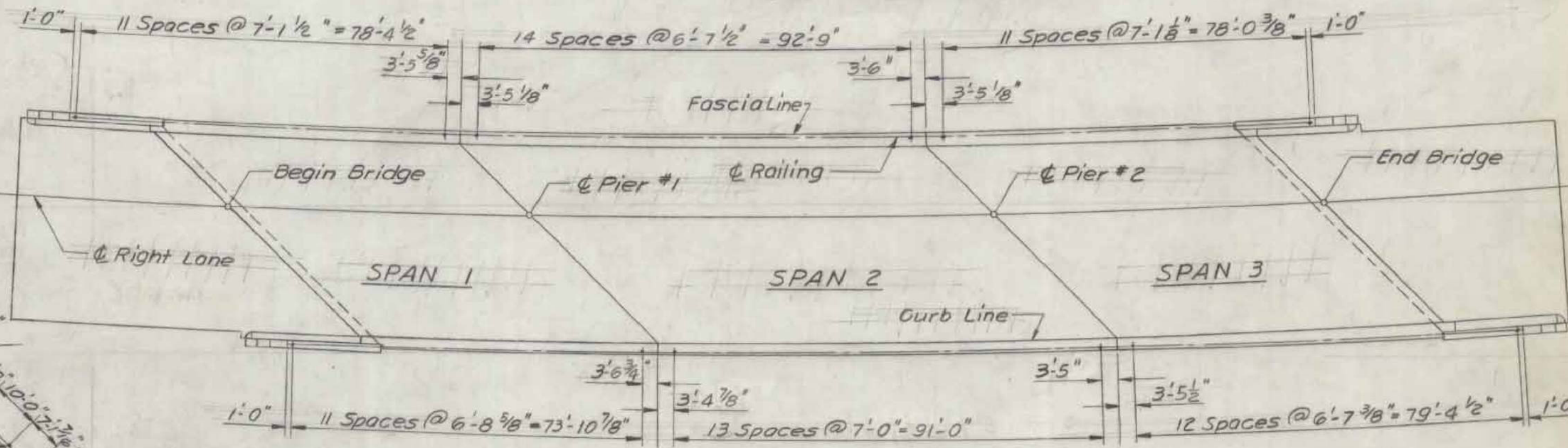

RAILING PLAN-RIGHT LANE  
Scale: 1" = 20'

Note:  
See Standard Sheets  
SCB-31-60, SCB-42-60, SCB-D-60,  
SB-20-60, SB-55-60

- NOTES:
1. Intermediate diaphragms and end diaphragms at piers shall be 16E42.7.
  2. For deck reinforcing bar schedule see bridge sheet #16 & #17.
  3. The structural steel fabricator shall be responsible for the location and length of steel diaphragms.

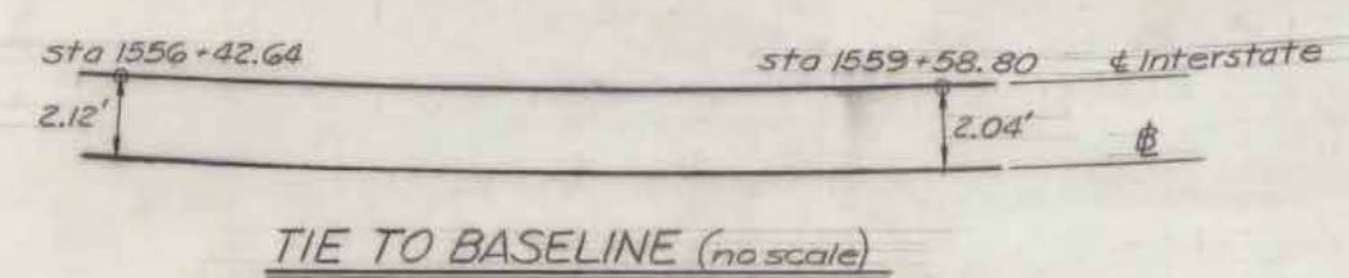

TIE TO BASELINE (no scale)

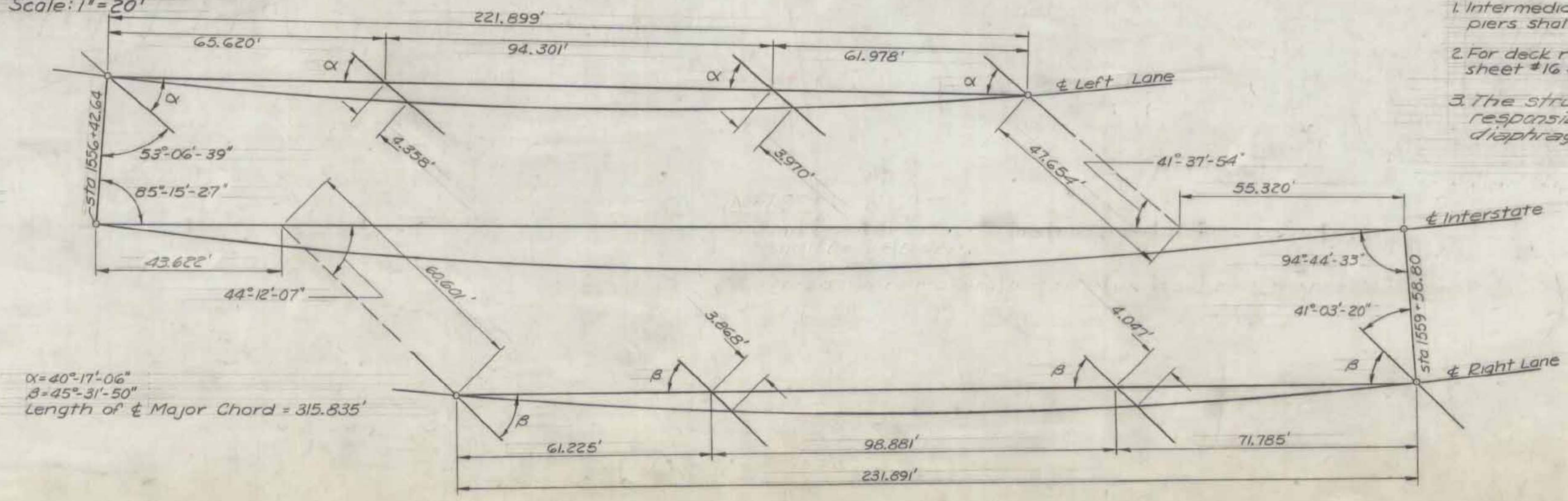

LAYOUT FROM MAJOR CHORD (no scale)

$\alpha = 40^\circ-11'-06''$   
 $\beta = 45^\circ-31'-50''$   
Length of  $\phi$  Major Chord = 315.835'

RICHMOND  
IM BPNT (3)  
SHEET 10 OF 18  
BRIDGE 56  
FOR REFERENCE ONLY

VERMONT  
STATE HIGHWAY DEPARTMENT  
TOWNS OF BOLTON-RICHMOND  
INTERSTATE ROUTE 89  
INTERSTATE BRIDGE OVER US-2  
RICHMOND INTERCHANGE  
FRAMING PLANS &  
RAILING PLANS  
M'FARLAND-JOHNSON  
CONSULTING ENGINEERS  
BINGHAMTON, NEW YORK  
DESIGNED: L.H.S. CHECKED: P.A.S. DATE: 7-25-61  
DRAWN: H.H.T. IN CHARGE: H.H.T. SCALE: 1" = 20'  
PROJECT NO. I 89-2 (8) SH 103 OF 261  
CONTRACT NO. 4 BRIDGE SHEET 11 OF 18