

FRAMING PLAN - LEFT LANE
Scale: 1" = 20'

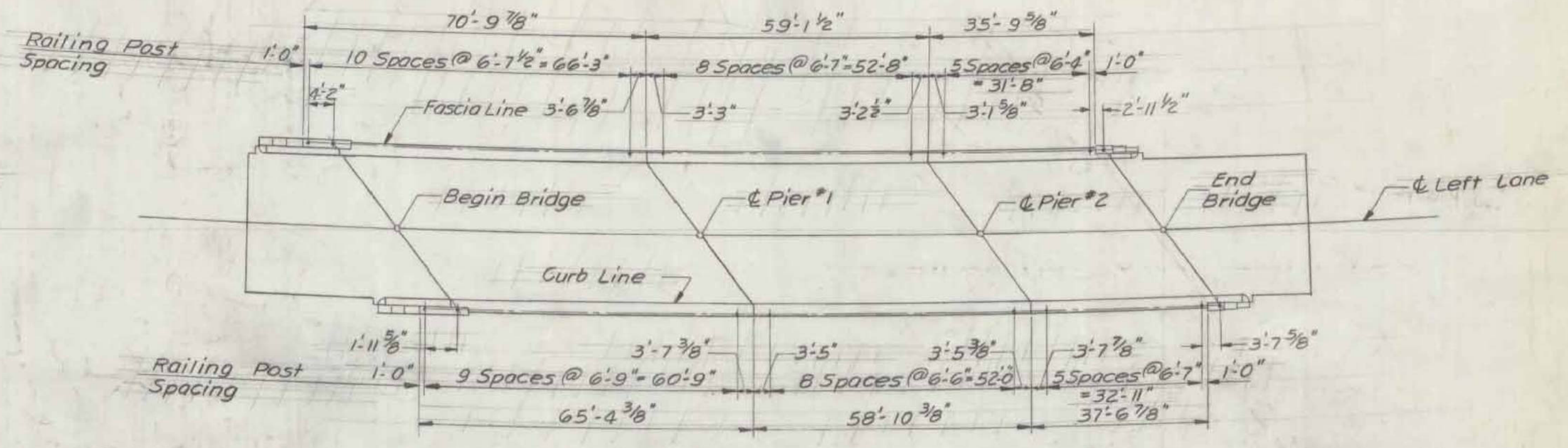

RAILING PLAN - LEFT LANE

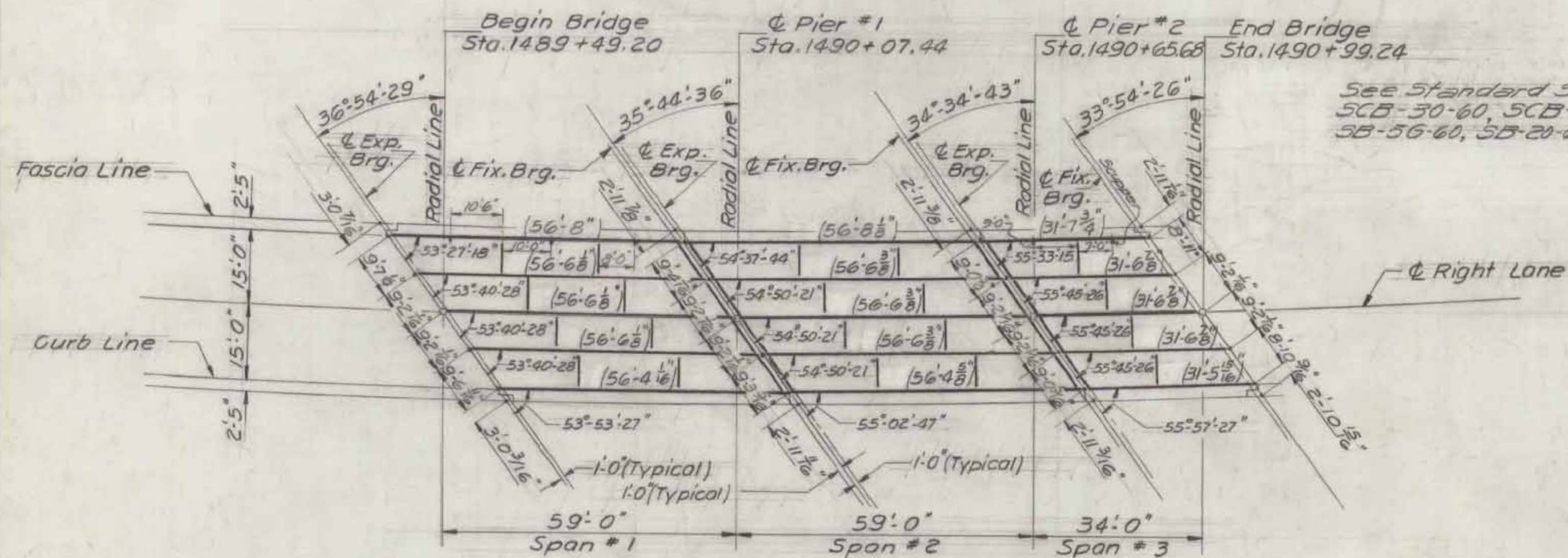

FRAMING PLAN - RIGHT LANE
Scale: 1" = 20'

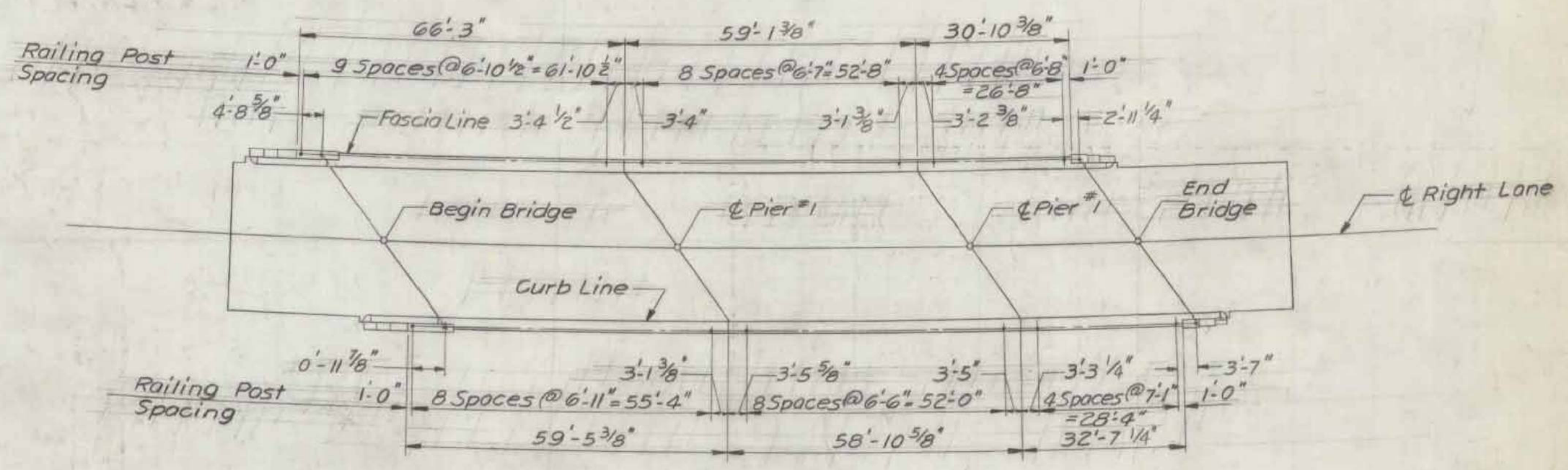

RAILING PLAN - RIGHT LANE

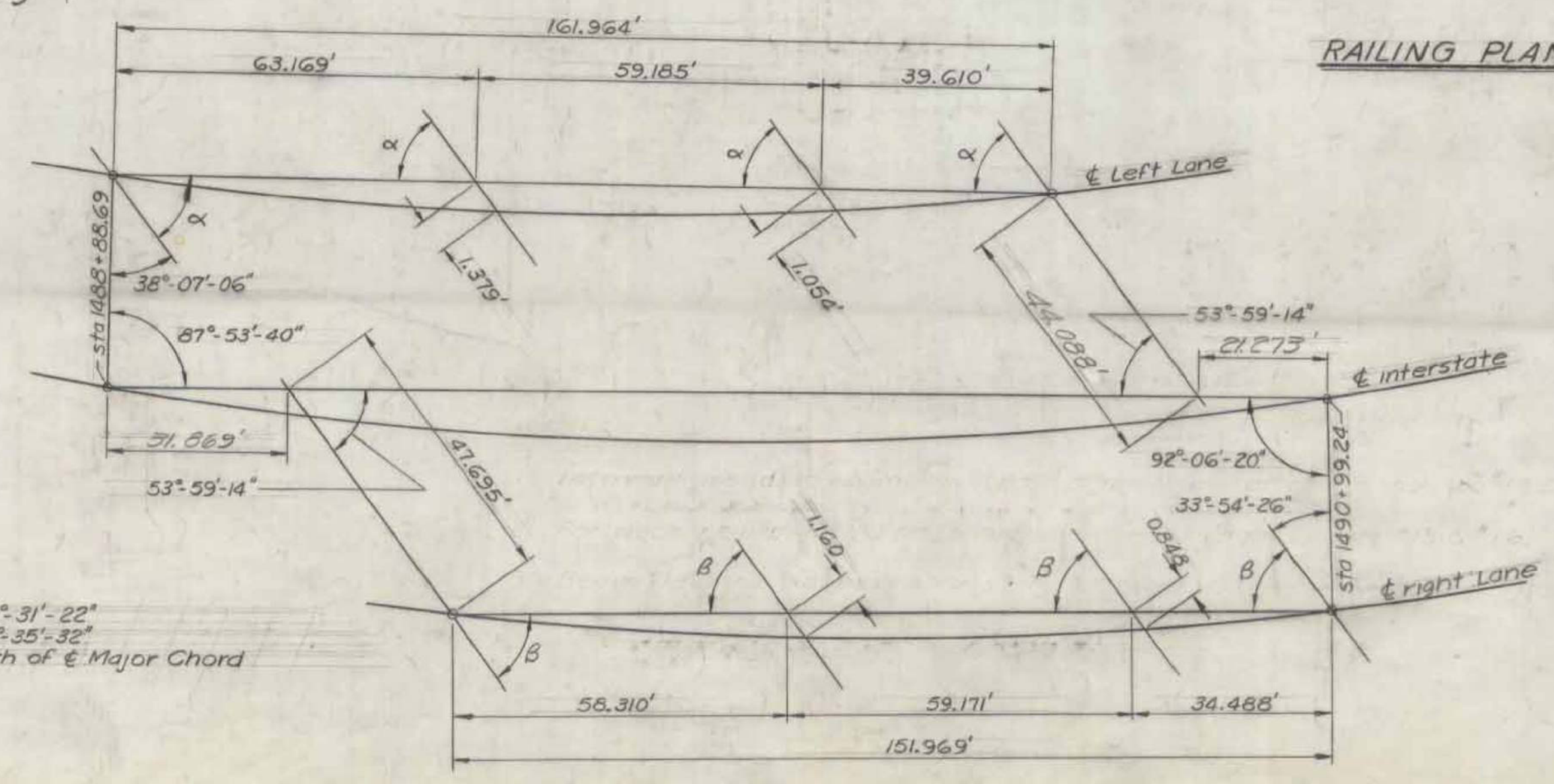

LAYOUT FROM MAJOR CHORD

NOTES

- Intermediate diaphragms and end diaphragms at piers shall be 18" x 24".
- For deck reinforcing bar schedule see bridge sheets #15 & #16.
- Beam lengths in parenthesis are center to center of bearings.
- The structural steel fabricator shall be responsible for the location and length of steel diaphragms. Diaphragms shall be spaced at equal intervals, between adjacent beams.

RICHMOND
IM BPNT (3)
SHEET 8 OF 18
BRIDGE 55
FOR REFERENCE ONLY

VERMONT
STATE HIGHWAY DEPARTMENT
TOWNS OF BOLTON-RICHMOND
INTERSTATE ROUTE 89
INTERSTATE BRIDGE OVER
RELOCATED SA-6
FRAMING PLANS
& RAILING PLANS
M^{rs} FARLAND-JOHNSON
CONSULTING ENGINEERS
BINGHAMTON, NEW YORK

DESIGNED: H.B.	CHECKED: H.B.	DATE: 2/28/61
DRAWN: H.H.T.	IN CHARGE: H.B.	SCALE: 1" = 20'
PROJECT NO. I 89-2 (8) SH. 105 OF 261		
CONTRACT NO. 4 BRIDGE SHEET 10 OF 17		