

STATE OF VERMONT
AGENCY OF TRANSPORTATION



PROPOSED IMPROVEMENT
BRIDGE PROJECT

TOWN OF RICHMOND
COUNTY OF CHITTENDEN
BRIDGES NO. 55 N&S, 56 N&S, AND 59 S ON I-89

PROJECT LOCATION: BRIDGES NO. 55 N&S LOCATED ON I-89 OVER JERICHO ROAD (T.H. 4)
BRIDGES NO. 56 N&S LOCATED ON I-89 OVER U.S. 2 AT EXIT 11
BRIDGE NO. 59 S LOCATED ON I-89 OVER KENYON ROAD (T.H. 8)

PROJECT DESCRIPTION: THIS PROJECT INVOLVES CLEANING AND REPAINTING THE EXISTING STEEL SUPERSTRUCTURE MEMBERS AND MINOR ASSOCIATED WORK.

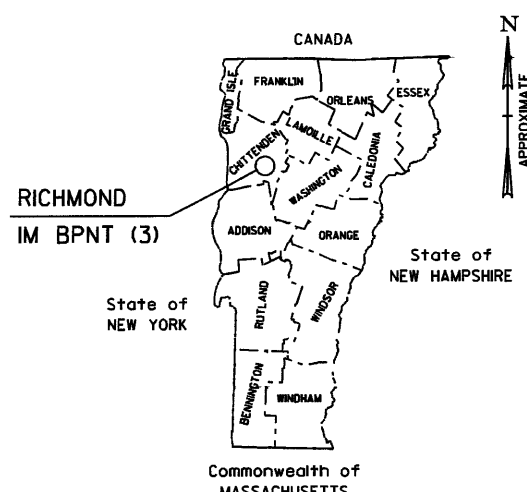

LOCATION MAP
NOT TO SCALE

RECORD PLANS

CONTRACTOR: AMSTAR OF WESTERN NEW YORK - CHEERTOWAGA, NY
RESIDENT ENGINEER: SCOTT WHEATLEY
CONSTRUCTION BEGAN: JUNE 28, 2010
CONSTRUCTION COMPLETE: OCTOBER 16, 2010
RECORD PLANS BY: SCOTT WHEATLEY

I HEREBY CERTIFY THAT ALL THE CONSTRUCTION REQUIRED BY THIS SET OF DRAWINGS HAS BEEN ACCOMPLISHED AS INDICATED HEREIN.

BY: *Scott Wheatley* RESIDENT ENGINEER
DATE: March 29, 2011

NOTE: Any further information concerning final quantities, amounts or other details relative to this project may be found at Central File in the electronic archives.

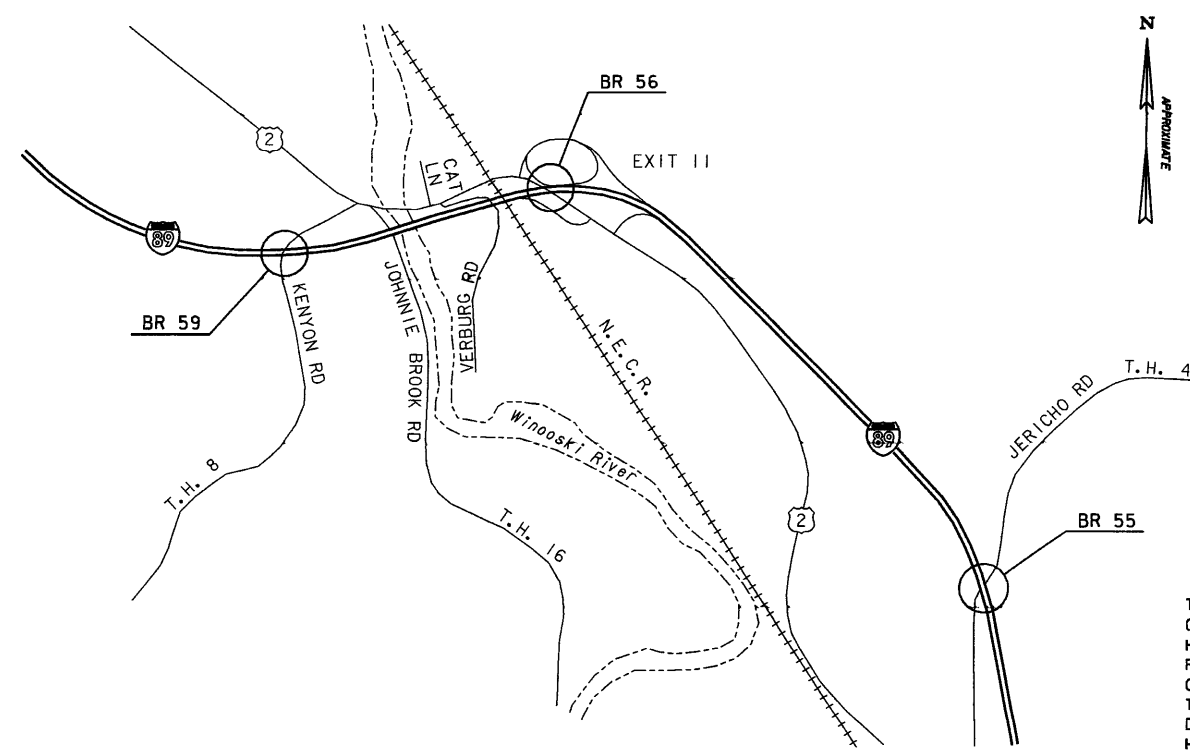

PLAN
NOT TO SCALE

THESE PLANS ARE SUBJECT TO SUCH ENGINEERING CHANGES AS MAY BE REQUIRED BY THE FEDERAL HIGHWAY ADMINISTRATION OR THE DIRECTOR OF PROGRAM DEVELOPMENT. CONSTRUCTION IS TO BE CARRIED ON IN ACCORDANCE WITH THESE PLANS AND THE STANDARD SPECIFICATIONS FOR CONSTRUCTION DATED 2006, AS APPROVED BY THE FEDERAL HIGHWAY ADMINISTRATION ON JUNE 15, 2006 FOR USE ON THIS PROJECT. INCLUDING ALL SUBSEQUENT REVISIONS AND SUCH REVISED SPECIFICATIONS AND SPECIAL PROVISIONS AS ARE INCORPORATED IN THESE PLANS.

DIRECTOR OF PROGRAM DEVELOPMENT
APPROVED: *John M. Weaver, P.E.* DATE: 12-28-09
PROJECT MANAGER: JOHN M. WEAVER, P.E.
PROJECT NAME: RICHMOND
PROJECT NUMBER: 1M BPNT (3)

VHB Vanasse Hangen Brustlin, Inc.

SHEET 1 OF 18 SHEETS

INDEX OF SHEETS

- 1 TITLE SHEET
- 2 QUANTITY SHEET
- 3 PROJECT NOTES & STANDARD DETAILS
- 4-6 TRAFFIC CONTROL SHEETS
- 7-8 REFERENCE SHEETS - BRIDGE 55
- 9-10 REFERENCE SHEETS - BRIDGE 56
- 11-12 REFERENCE SHEETS - BRIDGE 59
- 13-16 REFERENCE SHEETS - STANDARDS
- 17 REFERENCE SHEET - BRIDGE 55 RIGHT OF WAY
- 18 REFERENCE SHEET - BRIDGE 56-59 RIGHT OF WAY

STANDARD SHEETS

- E-100 01/02/04
- E-100A 01/02/04
- E-101 05/30/05
- E-102 06/30/03
- E-102A 05/01/04
- E-103 03/01/04
- E-106 03/01/04
- E-107 06/30/03
- E-107A 06/08/09

CONVENTIONAL SYMBOLS

- COUNTY LINE
- TOWN LINE
- LANDS OF ACCESS
- POINT OF ACCESS
- FENCE LINE
- STONE WALL
- TRAVELLED WAY
- GUARD RAIL
- RAILROAD
- SURVEY LINE
- CALVERT
- POWER POLE
- TELEPHONE POLE
- TREES
- CONTROL OF ACCESS
- ROAD LINE
- PROPERTY LINE
- BOUNDARY LINE
- SLOPE RIGHTS
- CLEAR TIME
- TOP OF CUT
- TOE OF SLOPE

DATUM
VERTICAL: N/A
HORIZONTAL: N/A