

BIT CONCRETE CURB, ITEM 355*
 NB 257+00.00' - 258+00.00'
 NB 262+50.24' - 266+43.24'

THREECABLE GUARD RAIL
 W/ STEEL POSTS, ITEM 342*
 NB 257+00' - 258+25.24'
 NB 261+60' - 266+60.24'
 NB 268+70' - 272+00.24'
 SD 260+98' - 266+86.14'

PLANK GUARD RAIL
 ITEM 340
 SD 271+75.14'
 NB 259+45.24'
 NB 271+95.24'

PROPERTY LINE FENCE w/
 STEEL POSTS, ITEM 583-I
 NB 257+00' - 268+00.24'
 SB 257+00' - 272+00.24'

JUTE MATTING, ITEM 623
 Med 259+00' - 261+24.14'
 NB 259+00' - 261+00.24'
 SD 259+00' - 261+00.24'
 Med 262+70' - 264+45.14'
 Med 266+84' - 269+10.14'
 SD 267+00' - 267+70.14'
 NB 268+00' - 269+00.24'
 Med 271+20' - 272+00.14'

STONE FILL FOR SLOPE PROTECTION - ITEM 612
 S.B. 263+75' - S.B. 266+25.14'

PLAN	SUBMITTED	DATE
BY	NO.	BY
DATE	NO.	DATE
NO.	NO.	NO.

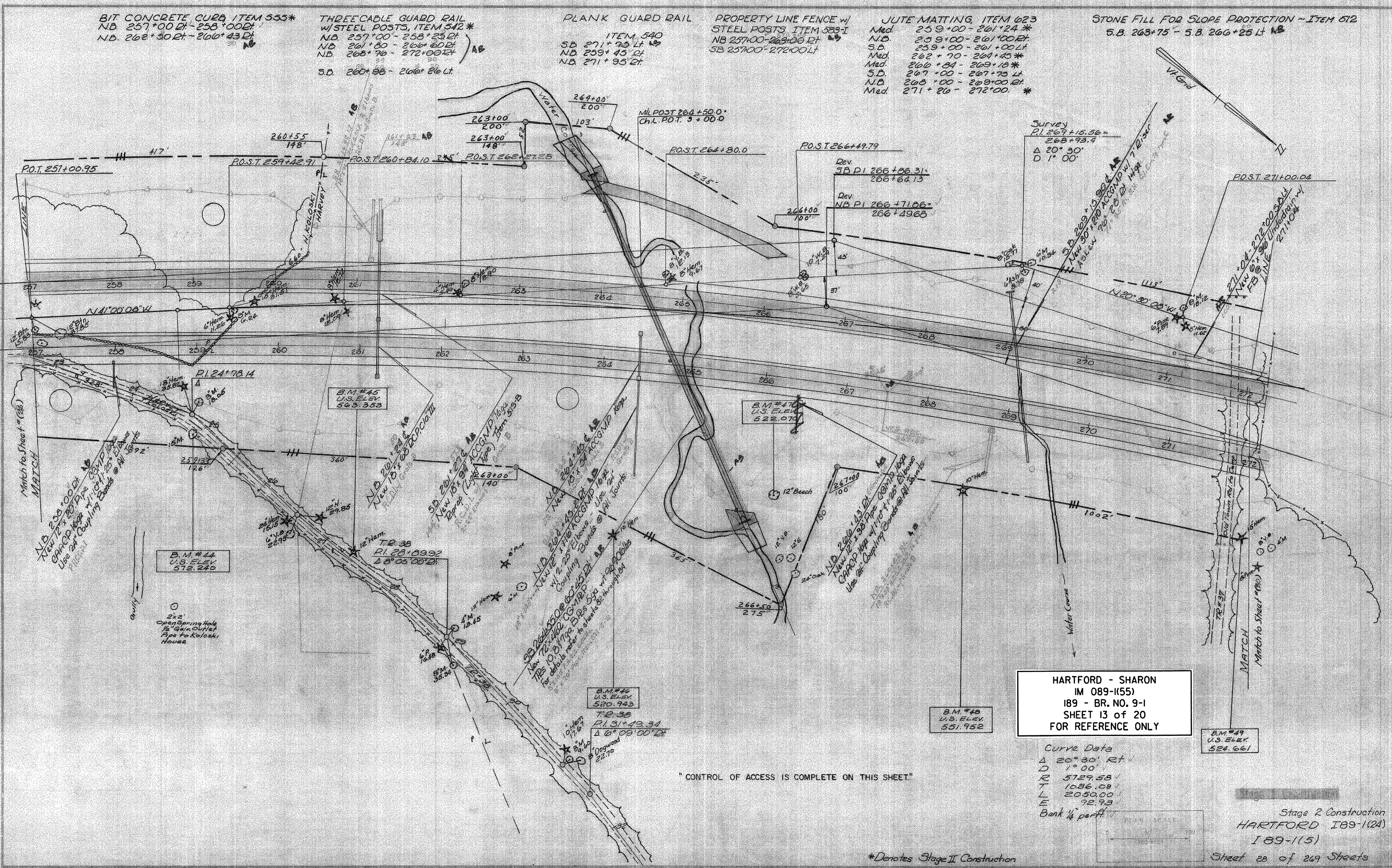

HARTFORD - SHARON
 IM 089-1155)
 189 - BR. NO. 9-1
 SHEET 13 of 20
 FOR REFERENCE ONLY

Curve Data
 Δ 20° 30' Rt
 D 1' 00'
 E 5729.58
 T 1086.109
 L 2050.00
 E 72.93
 Bank 1/4 part

"CONTROL OF ACCESS IS COMPLETE ON THIS SHEET"

*Denotes Stage II Construction

Stage 2 Construction
 HARTFORD 189-1124)
 189-115)
 Sheet 13 of 209 Sheets
 Sheet 01 of 141