

**INDEX OF SHEETS**

SHEET NO. 1	TITLE PAGE
2	ALIGNMENT SHEET
3	TYPICAL CROSS SECTION OF IMPROVEMENT (BIT. CONC. PAV'T. ITEM 361-B MOD.)
4	R.O.W. DETAIL SHEET
5	QUANTITY SHEET (ITEMS)
6	QUANTITY SHEET (DRAINAGE)
7-8	EARTHWORK AND GRADE SHEETS
9-12	PLAN AND PROFILE SHEETS
13	BLANK
14-15	BLANK
16	A-61 SOLID ROCK EXCAVATION
17	B-1 BANKING TABLES
18	B-5 TYPICAL SLOPE GRADING
19	B-6 MUCK EXCAVATION
20	B-10 EMBANKMENT ON SLOPE
21	D-2 HEADWALLS AND UNDERDRAIN
22	D-3 JUTE MATTING
23	D-4 SPECIAL ELBOWS
24	D-8 R.C. DROP INLETS
25	D-10 DROP INLET TOPS
26	D-11 D.I. GRATE, TYPE A
27	D-13 R.C. CATCH BASIN
28	D-16 PRECAST CURB D.I., D.I. GRATE TYPE B
29	E-31 CONSTRUCTION IDENTIFICATION SIGNS
30	F-1 PROPERTY LINE FENCE
31	G-1 STANDARD STEEL BEAM GUARD RAIL
32	G-3a THREE CABLE GUARD RAIL LEAD END ANCHORAGE
33	G-4 PLANK GUARD RAIL, WOOD MARKER POSTS
34	J-1 BOUNDARY MARKERS
35	J-4 FIELD OFFICE
36	BLANK
37	SCB-30-12
38-39	DETAILS BRIDGE I 91 OVER U.S. 5 AT 3518+11.0 (BR. 100-112)
40-41	DETAILS BRIDGE I 91 OVER OTTAUQUICHEE RIVER AT 3529+95.0 (BR. 200-222)
42	SB-R3-64
43-44	SB-R1-64 (SHEETS 1 AND 2)
45-46	SCB-D1, D2, D4, D6-62
47-48	BLANK
49-50	GROSS SECTIONS (INTERSTATE)
51-52	EXTENDED GROSS SECTIONS 3520+00 TO 3527+80

*Added in Final  
Struct. Steel Details with Extd. Weights  
1. Earthwork Sheet*

STATE OF VERMONT  
DEPARTMENT OF HIGHWAYS  
**PROPOSED IMPROVEMENT**  
TOWNS OF HARTLAND-HARTFORD  
COUNTY OF WINDSOR  
**INTERSTATE ROUTE 91  
BELLOWS FALLS-WHITE RIVER JCT. ROAD**

CONTRACT NO. 4  
BEGINNING AT A POINT 1.363 MILES SOUTHERLY OF THE HARTLAND-  
HARTFORD TOWN LINE AND EXTENDING NORTHERLY 0.473 MILES  
LENGTH OF ROADWAY 2010.37 FEET = 0.380 MILES  
LENGTH OF BRIDGES 489.63 FEET = 0.093 MILE  
LENGTH OF CONTRACT 2500.00 FEET = 0.473 MILES

**STAGE I CONSTRUCTION**

ADT 1965	3500
ADT 1985	8060
DHV 1985	1160
D	5 1/2 %
T	7 %
V	60 MPH

PROJECT NAME & NUMBER STAGE I & 2-2 SPAN WELDED PLATE  
HARTLAND-HARTFORD I 91 (22) GRADING & DRAINAGE GIRDER BRIDGES  
RECORD PLANS  
MATERIALS

SUBBASE OF GRAVEL - SMITH LEHEUREUX GRAVEL PIT - HARTLAND, VT.  
SUBBASE OF CRUSHED ROCK - SMITH LEHEUREUX QUARRY (PERINI CRUSHER) - HARTLAND, VT.  
CONCRETE CLASS AA B B - MILLER READY MIX INC. - WHITE RIVER JCT., VT. & V. LEDANON, N. Y.  
REINFORCING STEEL & STEEL PILING - REPLEHEN STEEL CORP. - ALBANY, N. Y.  
METAL CULVERT PIPE - NEW ENGLAND METAL CULVERT CORP. - WHITE RIVER JUNCTION, VT.  
REINFORCED CONCRETE W.P.P., GUARD RAIL ITEMS, PROPERTY LINE FENCE & EROSION CONTROL  
ITEMS - S. T. CRISWOLD & CO., INC. - WILLISTON, VT.  
STRUCTURAL STEEL - A. LEO NASH STEEL CO. - PITTSFIELD, MASS.  
GRANITE BRIDGE CURB - E. L. SMITH WHETMORE & MORSE QUARRIES - BARRE, VT.  
BRIDGE PILING - WARD WELLS CO., INC. - NATICK, MASS.  
BRIDGE PAINT - AMSTERDAM COLOR WORKS INC. - NEW YORK, N. Y.

CONTRACTOR - MILLER CONSTRUCTION INC.  
WINDSOR, VT.  
CHIEF RESIDENT ENGINEER - ROY E. NICHOLSEN  
RES. ENG. - JAMES A. MCCREA & GLEASON W. AYERS  
INSPECTORS - ALLEN J. NEWTON, JOSHUA PAVIS & ALLAN COUCH  
RECORD PLANS - GLEASON W. AYERS  
CONTRACT  
DATED - MARCH 1, 1965.  
STARTED - MARCH 11, 1965.  
COMPLETED - AUGUST 26, 1966.  
ACCEPTED - AUGUST 3, 1966.

57

PROJECT: HARTLAND-HARTFORD  
SHEET: I 91-1(22), C-4, S-1  
TYPE: GRADING & DRAINAGE  
FOUR STAGE 2 SEE I 91-1(31)  
CONTRACTOR: MILLER CONSTRUCTION INC.  
WINDSOR, VT.  
LOCATION: Beginning at a point 1.363 miles southerly of the Hartland-Hartford  
Town Line and extending northerly 0.473 miles.  
Box 251 3883

WINDSOR-HARTLAND I 91-1(22) C-4 S-1  
CONTRACTOR - MILLER CONSTRUCTION INC.  
WINDSOR, VT.  
CONS. COMPLETED - AUGUST 26, 1966.  
RECORD PLANS - GLEASON W. AYERS.

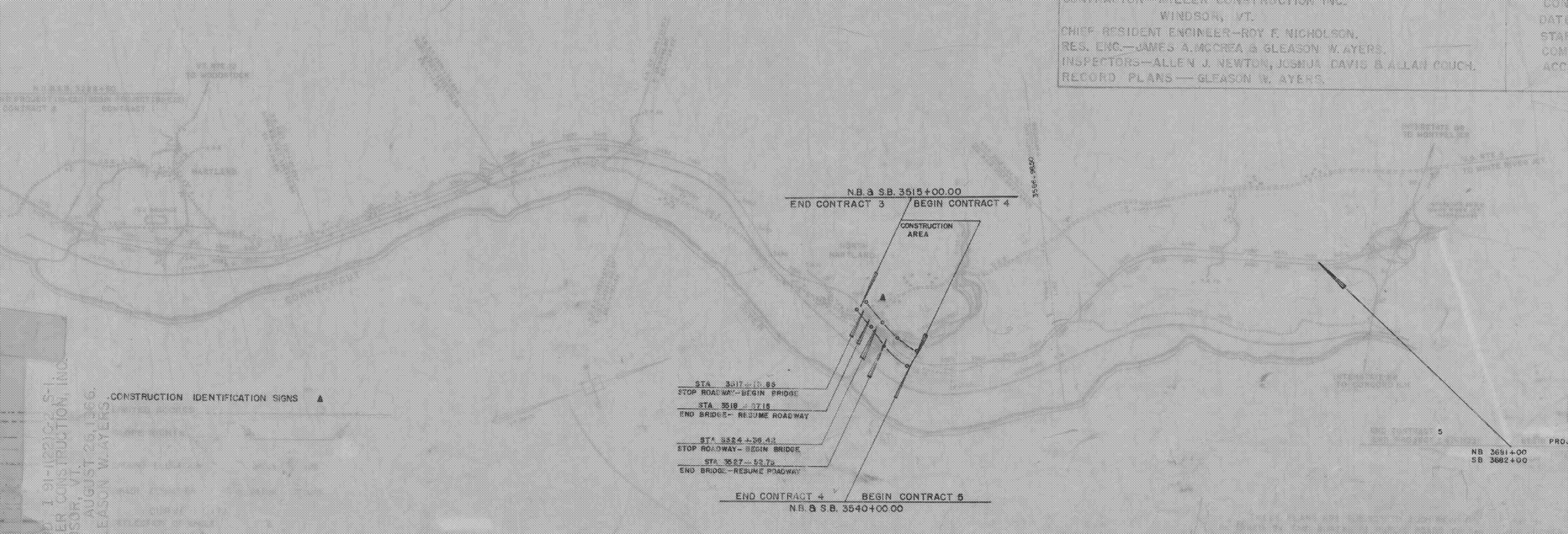

SCALE IN FEET  
0 1000 2000 4000

WINDSOR-HARTLAND  
IM MEMB(14)  
SHEET 34 OF 39  
BRIDGE 40S  
FOR REFERENCE ONLY

APPROVED: *R.H. Currier*  
ASST. CHIEF ENGINEER  
DATE: 9/26/69  
DISTRICT: *J.P. Perkins* 11/21/63  
*E.H. McKinney* 1/10/63  
*Sam Brown* 1/14/63  
*J.S. Chase* 1/17/63  
*L.M. Lane* 1/19/63  
*J.P. Bishop* 1/11/63