

STATE OF VERMONT
AGENCY OF TRANSPORTATION



PROPOSED IMPROVEMENT
TOWNS OF BROOKFIELD, WILLIAMSTOWN AND BERLIN
COUNTIES OF ORANGE & WASHINGTON
INTERSTATE ROUTE 89 (NB)

BEGINNING IN THE TOWN OF BROOKFIELD AT MILE MARKER 37.729 AND EXTENDING NORTHERLY ALONG INTERSTATE ROUTE 89 (NORTHBOUND) FOR A DISTANCE OF 50,904.48 FT (9.641 MILES) TO MILE MARKER 47.370 IN THE TOWN OF BERLIN.

LENGTH OF ROADWAY = 50,904.48 FT = (9.641 MILES)
LENGTH OF PROJECT = 50,904.48 FT = (9.641 MILES)

WORK TO BE PERFORMED UNDER THIS PROJECT INCLUDES SURFACE PREPARATION INVOLVING PATCHING, POTHOLE REPAIR, AND CRACK-SEALING; THE CONSTRUCTION OF A MODIFIED BITUMINOUS CONCRETE PAVEMENT, OR COLD PLANE & PAVE ON THE EXISTING INTERSTATE TYPICAL, AND APPLICABLE PAVEMENT MARKINGS.

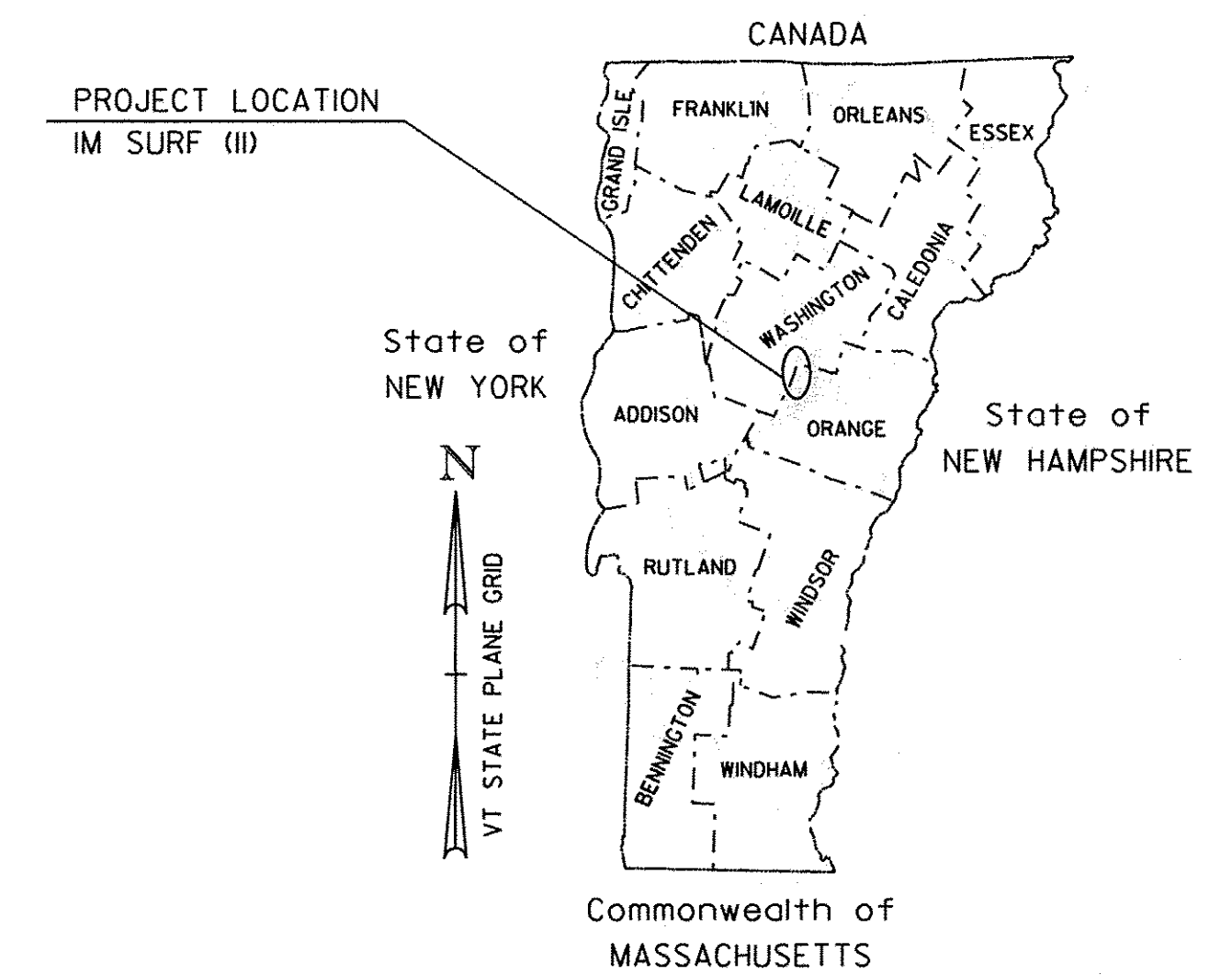

INDEX OF SHEETS

1. TITLE SHEET
2. ALTERNATE A TYPICAL SECTION
3. ALTERNATE B TYPICAL SECTION
4. BRIDGE DETAIL SHEET
5. ASPHALTIC PLUG JOINT DETAIL SHEET
- 6.-8. QUANTITY SHEETS
9. TYPICAL INTERCHANGE #5 CONSTRUCTION DETAILS
10. TYPICAL INTERCHANGE #6 CONSTRUCTION DETAILS
11. CONSTRUCTION APPROACH SIGNING SHEET
12. INTERCHANGE TRAFFIC CONTROL SHEET
13. PAVEMENT MARKING DETAIL SHEET
14. ROUGHNESS DATA INFORMATION SHEET
15. RUTTING DATA INFORMATION SHEET

STANDARDS

E-100	CONSTRUCTION APPROACH SIGNS	01/02/04
E-101	CONSTRUCTION SIGN DETAILS	05/30/03
E-102	CONSTRUCTION SIGN DETAILS	06/30/03
E-102A	CONSTRUCTION SIGN DETAILS	05/01/04
E-103	MAINLINE TRAFFIC CONTROL DIVIDED HIGHWAY ONE LANE CLOSED	03/01/04
E-105	TRAFFIC CONTROL FOR CONSTRUCTION VEHICLE U- TURNS ON DIVIDED HIGHWAY	05/01/04
E-106	TRAFFIC CONTROL - MISCELLANEOUS DETAILS	03/01/04
E-107A	BREAKAWAY BARRICADE DETAILS	08/08/95
E-191	PAVEMENT MARKING DETAILS	02/01/99
E-193	PAVEMENT MARKING DETAILS	08/18/95

CONVENTIONAL SYMBOLS

COUNTY LINE	
TOWN LINE	
LIMITS OF ACCESS	
POINT OF ACCESS	
FENCE LINE	
STONE WALL	
TRAVELED WAY	
GUARD RAIL	
RAILROAD	
SURVEY LINE	
CULVERT	
POWER POLE	
TELEPHONE POLE	
TREES	
CONTROL OF ACCESS	
PROPERTY LINE	
R.O.W. TAKING LINE	
SLOPE RIGHTS	
TOP OF CUT	
TOE OF SLOPE	

SURVEYED BY :
SURVEYED DATE :

DATUM
VERTICAL
HORIZONTAL

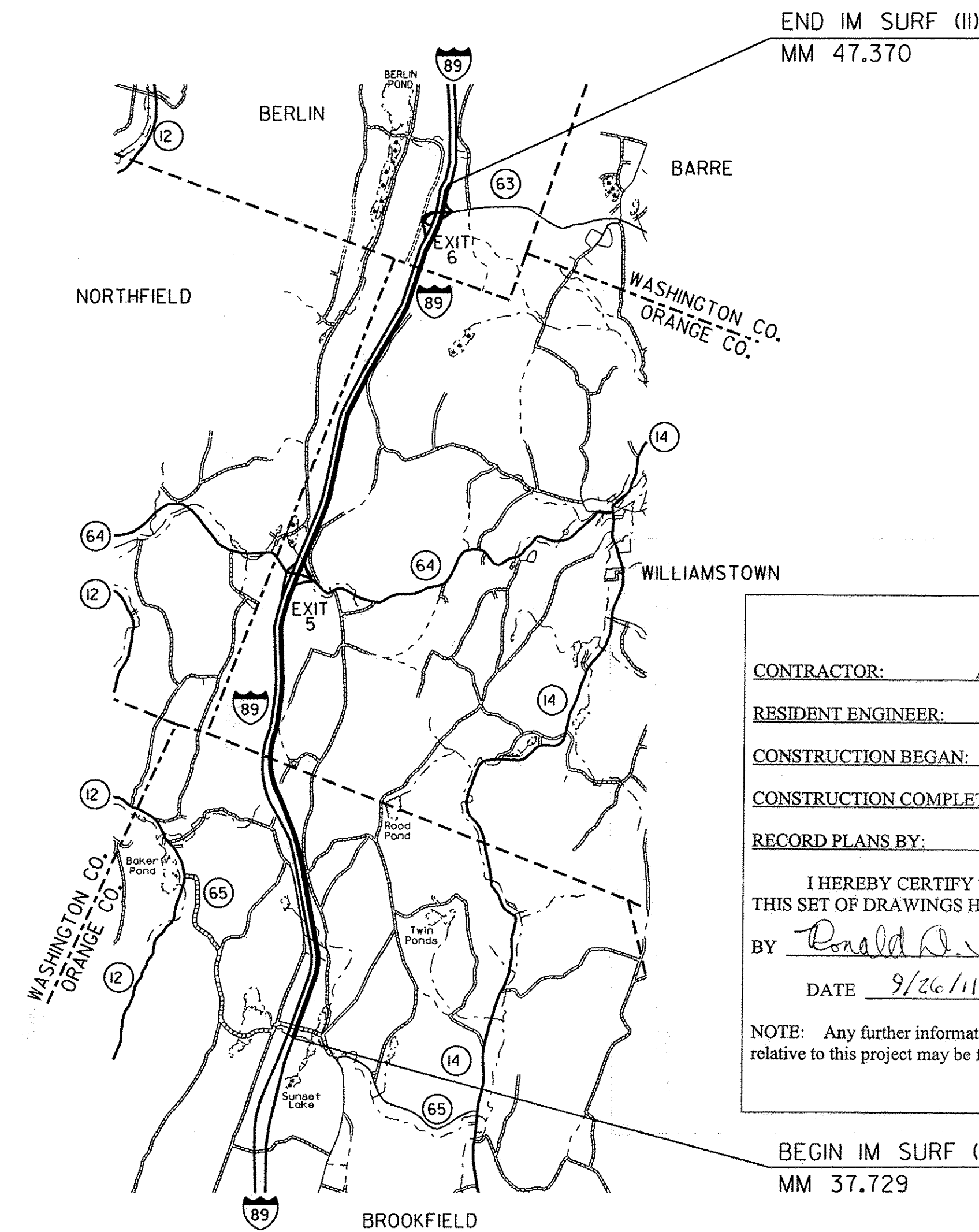
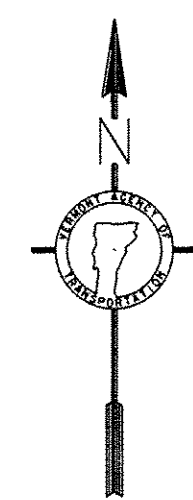

END IM SURF (II)
MM 47.370

BEGIN IM SURF (II)
MM 37.729

RECORD PLANS

CONTRACTOR: ALL STATES ASPHALT, INC. - SUNDERLAND MA
RESIDENT ENGINEER: CARL FIELDER
CONSTRUCTION BEGAN: SEPTEMBER 9, 2009
CONSTRUCTION COMPLETE: OCTOBER 28, 2009
RECORD PLANS BY: CARL FIELDER & AMOS KEMPTON
I HEREBY CERTIFY THAT ALL THE CONSTRUCTION REQUIRED BY THIS SET OF DRAWINGS HAS BEEN ACCOMPLISHED AS INDICATED HEREIN.
BY *Ronald D. Shay* FOR RESIDENT ENGINEER CARL FIELDER
DATE 9/26/11

NOTE: Any further information concerning final quantities, amounts or other details relative to this project may be found at Central Files in the electronic archives.

TRAFFIC DATA

SECTION	AADT	
	2009	2019
BEGIN PROJECT TO EXIT 5	6900	8100
EXIT 5 TO EXIT 6	8300	9700
EXIT 6 TO END PROJECT	8600	10,000

THESE PLANS ARE SUBJECT TO SUCH ENGINEERING CHANGES AS MAY BE REQUIRED BY THE FEDERAL HIGHWAY ADMINISTRATION OR THE DIRECTOR OF PROGRAM DEVELOPMENT.
CONSTRUCTION IS TO BE CARRIED ON IN ACCORDANCE WITH THESE PLANS AND THE STANDARD SPECIFICATIONS FOR CONSTRUCTION DATED 2006, AS APPROVED BY THE FEDERAL HIGHWAY ADMINISTRATION ON JUNE 15, 2006 FOR USE ON THIS PROJECT, INCLUDING ALL SUBSEQUENT REVISIONS AND SUCH REVISED SPECIFICATIONS AND SPECIAL PROVISIONS AS ARE INCORPORATED IN THESE PLANS.

DIRECTOR OF PROGRAM DEVELOPMENT
APPROVED *[Signature]* DATE 6-9-09
PROJECT MANAGER / TED DOMEY
PROJECT NAME : BROOKFIELD-BERLIN
PROJECT NUMBER : IM SURF (II)
SHEET 1 OF 15 SHEETS