

USE REVISED SIGN FACE LAYOUTS (AS NOTED)

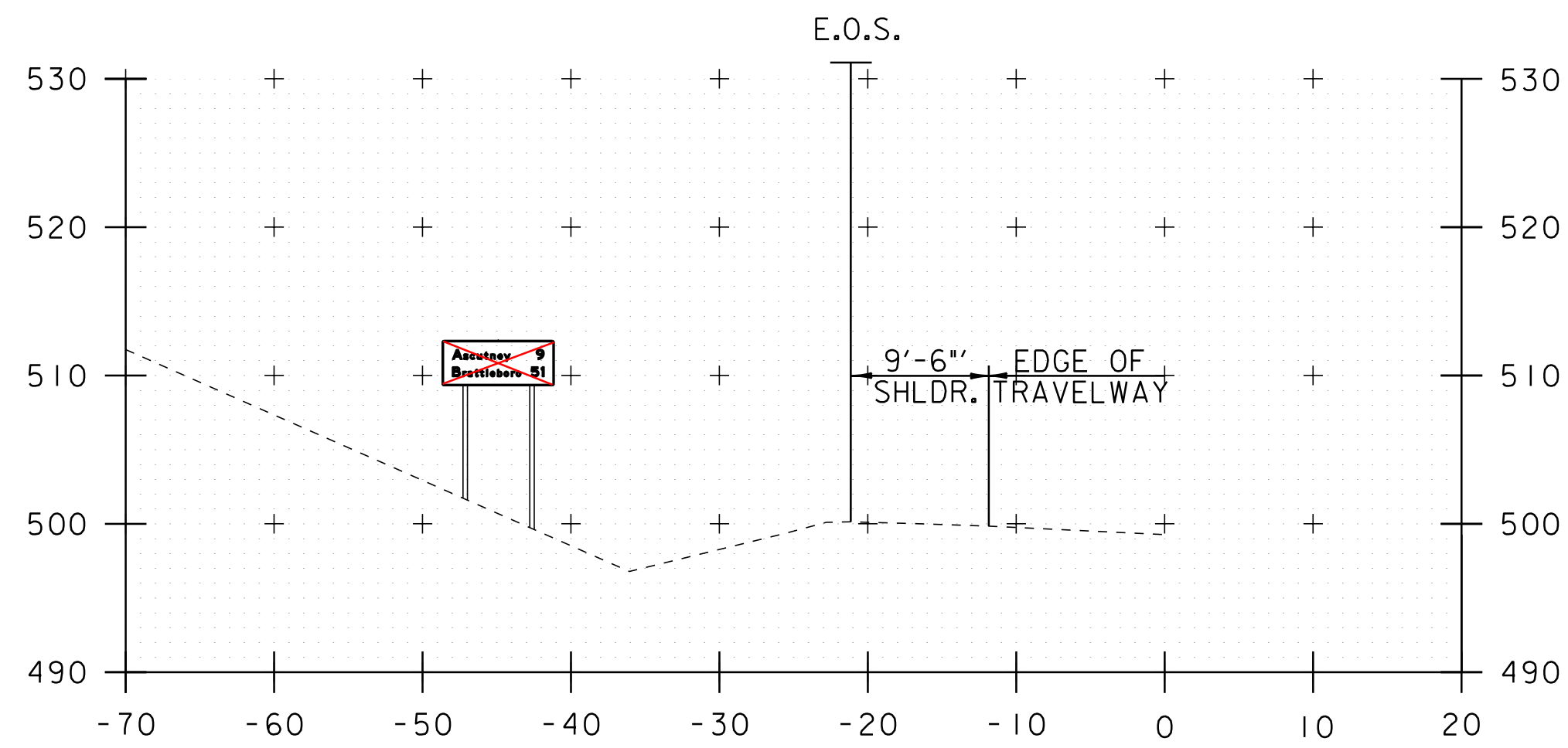

*SOUTHBOUND
MM 59.700 LT
LEFT POST = 10.7' 10.8'
RIGHT POST = 12.7' 13.2'
3" DIAMETER TUBULAR STEEL

SEE SHEET #36/56

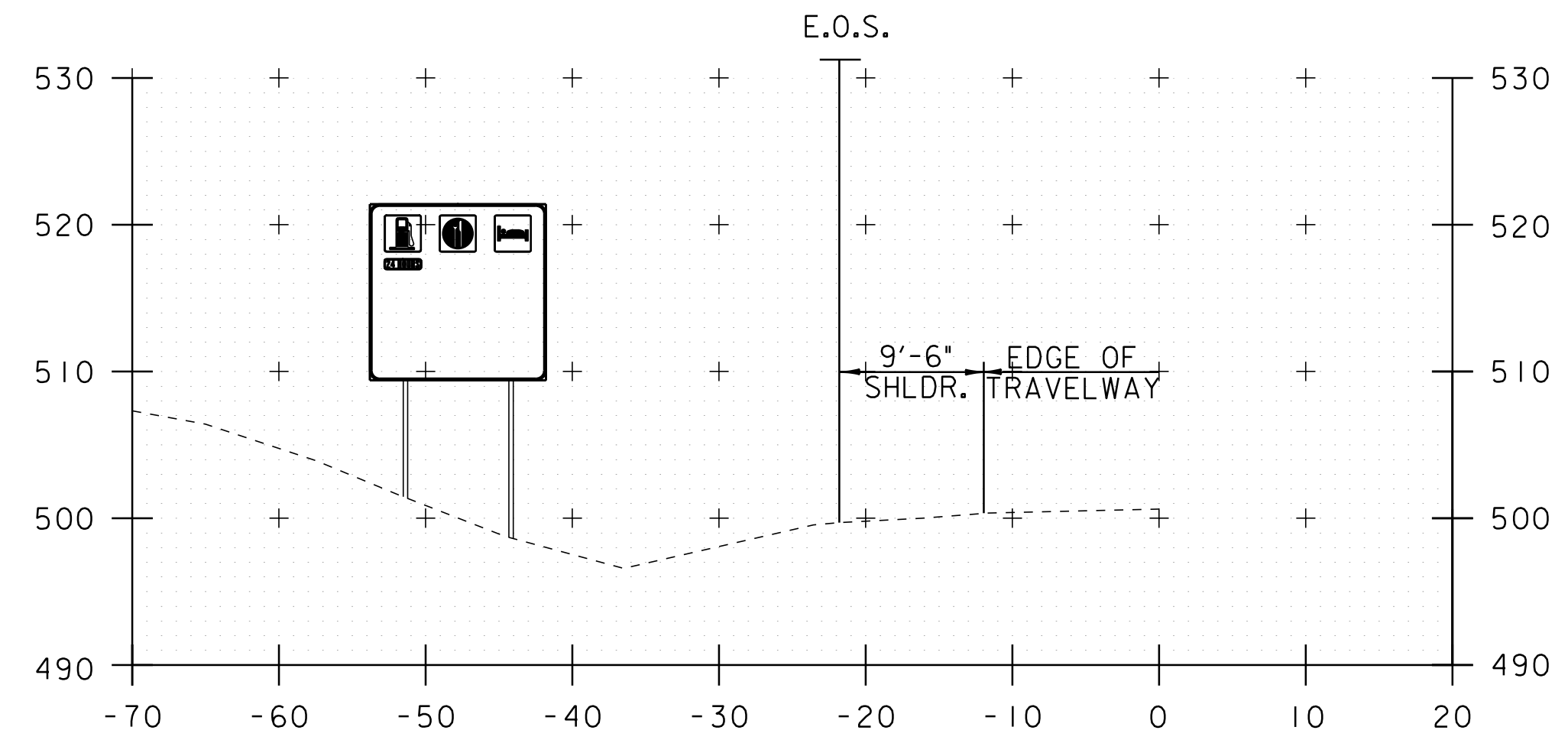

*SOUTHBOUND
MM 60.900 LT
LEFT POST = 20.0'
RIGHT POST = 22.7'
W 8x18 W-SHAPE STEEL

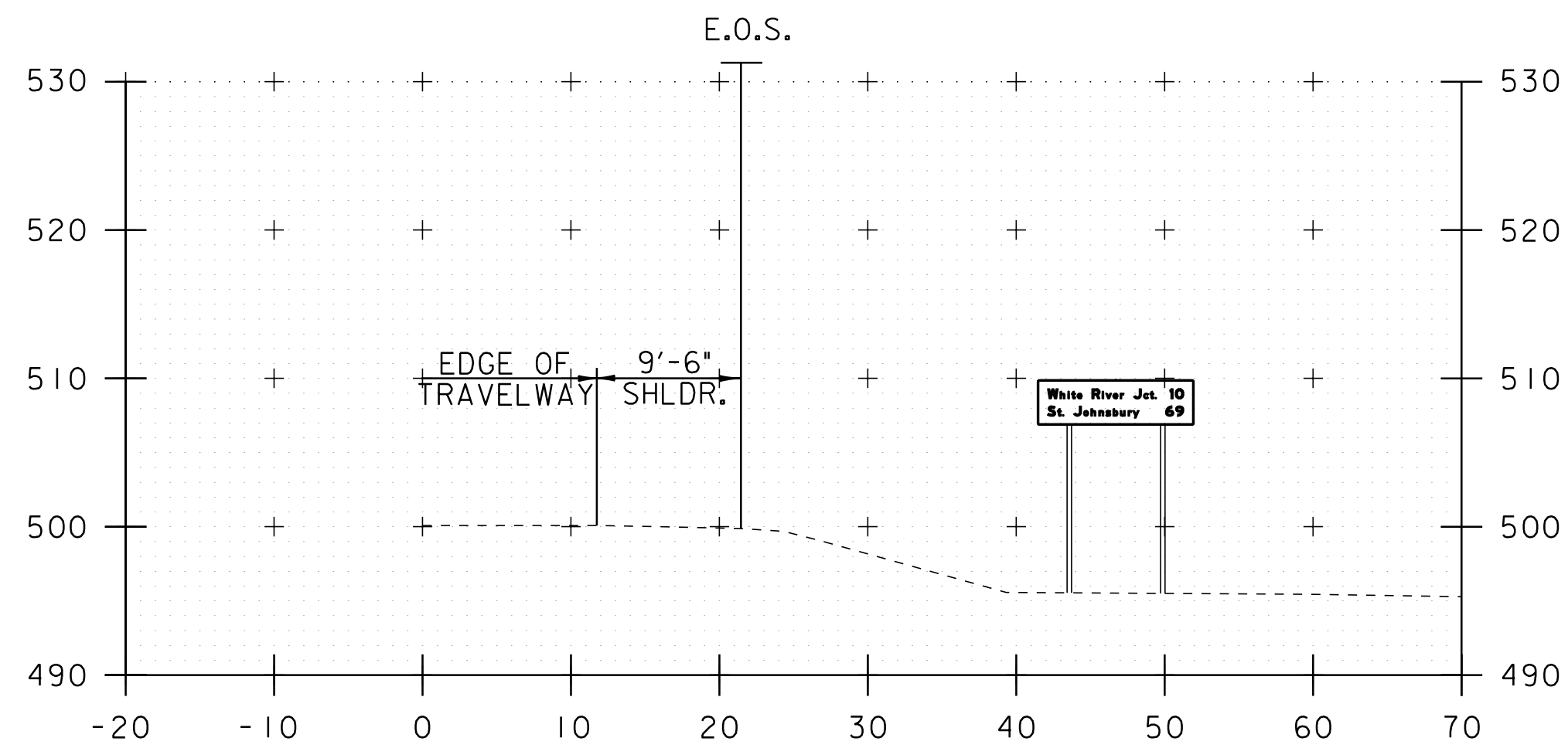

NORTHBOUND
MM 61.140 RT
LEFT POST = 14.3'
RIGHT POST = 14.4'
3" DIAMETER TUBULAR STEEL

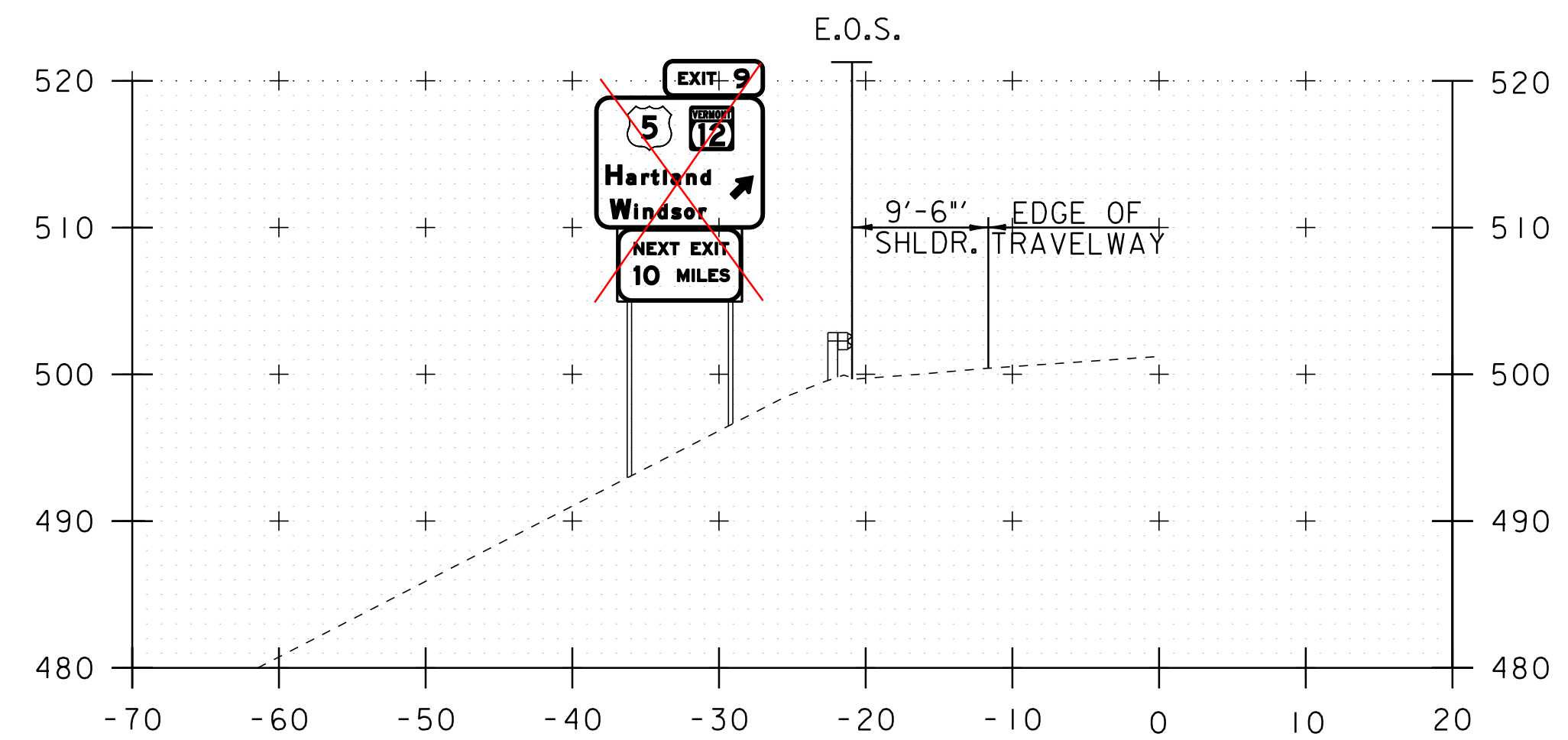

*SOUTHBOUND
MM 60.710 LT
LEFT POST = 25.2' 26.5'
RIGHT POST = 21.5' 22.5'
~~W 8x18 W-SHAPE STEEL~~
W 8x21 W-SHAPE STEEL

CALCULATED REVISED BOLT TENSION = 19.8 KIP
USE MINIMUM TENSION = 28.4 KIP

SEE SHEET #35/56

* THIS SIGN FACE HAS BEEN SHOWN ON THE CROSS SECTION AT THE PROPER STATION AND OFFSET. DUE TO THE ORIENTATION OF THE STATION LINE, THE TEXT AND SYMBOLS HAVE BEEN SHOWN ON THE BACK OF THE PROPOSED GUIDE SIGN FOR ALL SIGNS TO BE INSTALLED ON THE SOUTHBOUND SIDE OF INTERSTATE 91.

NOT TO SCALE

TRAFFIC SIGN CROSS SECTION SHEET #2

PROJECT NAME: WINDSOR - HARTLAND
PROJECT NUMBER: IM 091-(6)

FILE NAME: p07al42.dgn
PROJECT LEADER: D.E.G.
DESIGNED BY: M.J.L.
IPARM FILE: p07al42xsc2.i

PLOT DATE: 16-AUG-2011 13:43
DRAWN BY: C.A.K.
CHECKED BY: R.A.B.
SHEET 39 OF 56