

646.426 DURABLE 6 INCH WHITE LINE, RECESSED POLYUREA
 RAMP A:
 STA A0+25.0 - STA A0+90.3 EDGE LINE LT/RT
 STA A0+25.0 - STA A23+00.0 EDGE LINE RT
 STA A17+50.0 - STA A18+75.0 DASHED LANE LINE CL

646.81 PAINTED CURB
 RAMP A:
 STA A0+25.0 - STA A0+81.0 LT (60 LF)
 STA A0+25.0 - STA A0+81.0 RT (100 LF)

646.622 TEMPORARY 6 INCH WHITE LINE, PAINT
 RAMP A:
 STA A0+25.0 - STA A0+90.3 EDGE LINE LT/RT
 STA A0+25.0 - STA A23+00.0 EDGE LINE RT
 STA A17+50.0 - STA A18+75.0 DASHED LANE LINE CL

646.436 DURABLE 6 INCH YELLOW LINE, RECESSED POLYUREA
 RAMP A:
 STA A0+25.0 - STA A0+90.0 EDGE LINE RT
 STA A0+39.0 - STA A14+17.0 EDGE LINE CL

646.632 TEMPORARY 6 INCH YELLOW LINE, PAINT
 RAMP A:
 STA A0+25.0 - STA A0+90.0 EDGE LINE RT
 STA A0+39.0 - STA A14+17.0 EDGE LINE CL

646.466 DURABLE 12 INCH WHITE LINE, RECESSED POLYUREA
 RAMP A:
 STA A14+17.0 - STA A17+50.0 SOLID GORE LINES CL

646.662 TEMPORARY 12 INCH WHITE LINE, PAINT
 RAMP A:
 STA A14+17.0 - STA A17+50.0 SOLID GORE LINES CL

646.492 DURABLE LETTER OR SYMBOL, THERMOPLASTIC
 RAMP A:
 STA A0+62.0 RT YIELD LINE (5 EA)

646.692 TEMPORARY LETTER OR SYMBOL, PAINT
 RAMP A:
 STA A0+62.0 RT YIELD LINE (5 EA)

S.B. MM 60.061
 RAMP A STA A23+00.00
 END RAMP A

S.B. MM 60.223, RT
 N
 ONE WAY →
 N

604.412, 604.415 OR 604.418 REHAB DROP INLETS, CATCH BASINS OR MANHOLES (SEE NOTE 2)

RAMP A:
 STA A0+52.0 RT
 STA A1+78.0 RT
 STA A8+91.0 LT

621.76 REPLACE GUARDRAIL POST
 RAMP A:
 STA A0+25.0 - STA A14+56.00 LT&RT (5 EA)

676.10 DELINEATOR WITH STEEL POST
 SEE ITEM DETAIL SUMMARY SHEETS

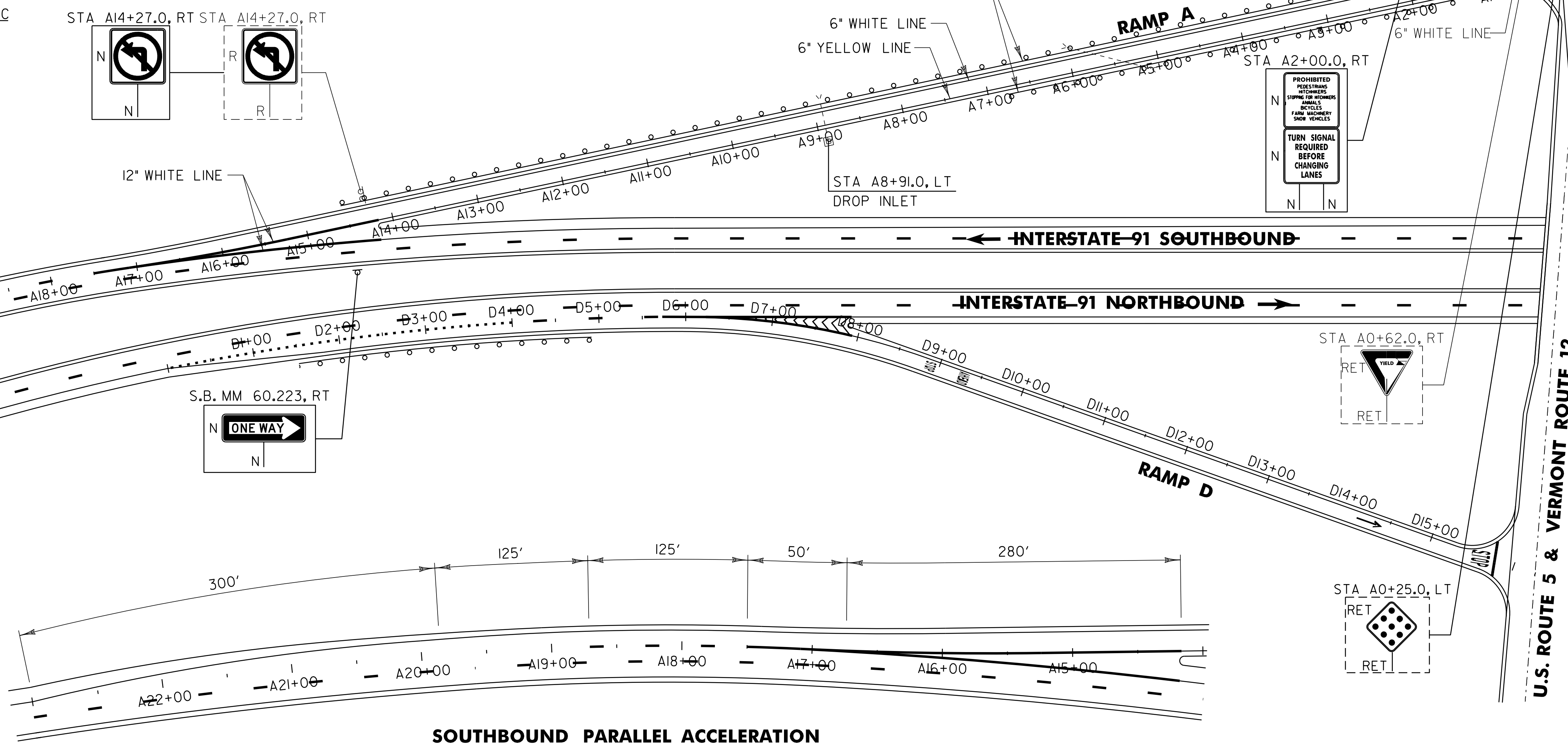

SOUTHBOUND PARALLEL ACCELERATION LANE DETAIL

NOTES:

- SEE SHEET 18 FOR RAMP D DETAILS.
- THE CONTRACTOR SHALL REHAB. THE EXISTING DROP INLETS, CATCH BASINS OR MANHOLES TO A DEPTH AS DIRECTED BY THE RESIDENT ENGINEER. ALL REHAB. WORK WILL BE PAID FOR UNDER THE APPLICABLE REHAB. ITEM AS DIRECTED BY THE RESIDENT ENGINEER.

SIGN LEGEND

R = REMOVE
S = SALVAGE
N = NEW
RET = RETAIN
B-B = BACK TO BACK
EXISTING = - - - - -
NEW = _____

NOT TO SCALE

INTERCHANGE #9 RAMP A DETAIL SHEET

PROJECT NAME: WINDSOR - HARTLAND	PLOT DATE: 16-AUG-2011 13:41
PROJECT NUMBER: IM 091-(161)	DRAWN BY: C.A.K.
FILE NAME: p07al42.dgn	CHECKED BY: R.A.B.
PROJECT LEADER: D.E.G.	SHEET 15 OF 56
DESIGNED BY: M.J.L.	
IPARM FILE: p07al42int1.i	