

- ① HATCHING REPRESENTS APPROXIMATE WORK AREA ASSOCIATED WITH RAMMING OPERATION. CONTRACTOR HAS THE OPTION TO RAM STEEL CASING EITHER FROM THE OUTLET OR INLET SIDE.
- ② FINAL GRADING LIMITS, AREA WILL BE GRADED TO DRAIN TOWARDS THE CULVERT INLET
- ③ DURING CONSTRUCTION FLOW WILL BE MAINTAINED VIA EXISTING 18 INCH ACCGMP USING BYPASS PUMPING OR APPROVED ALTERNATIVE
- ④ STONE FILL TYPE II, 6 FT W., 14 FT L., 2 FT D.
- ⑤ EXISTING 18 INCH ACCGMP TO REMAIN UNDISTURBED
- ⑥ THE CONTRACTOR WILL BE RESPONSIBLE FOR PROVIDING TEMPORARY ACCESS TO THE CULVERT INLET. PAYMENT SHALL BE MADE UNDER ITEM 900.640 SPECIAL PROVISION (PIPE RAMMING) (42" SP(SL)). CONTRACTOR SHALL UTILIZE PROPOSED ACCESS ROAD TO GAIN ACCESS TO CULVERT OUTLETS AND TRIBUTARY. ALL RESULTING DISTURBED EARTH SHALL BE STABILIZED AND RESTORED UPON COMPLETION OF CONSTRUCTION
- ⑦ NEW 42" X 225 FT SP (SL) CULVERT SHALL BE RAMMED TO PROPOSED LOCATION AND GRADE. NEW REINFORCED CONCRETE STRAIGHT HEADWALL AT INLET
- ⑧ EXISTING 24" ACCGMP SHALL BE ABANDONED AND FILLED WITH (FLOWABLE FILL) UPON INSTALLATION OF PROPOSED CULVERTS
- ⑨ EXISTING DEPRESSIONS LOCATED ON THE EASTERN EMBANKMENT SHALL BE PROPERLY BACKFILLED USING EARTH BORROW, COMPACTED, SEEDING AND MULCHED
- ⑩ STONE FILL TYPE III, 6 FT W., 36 FT L., 3 FT D.

MM88.877 PIPE ALIGNMENT			
POINT	STA.	NORTHING	EASTING
POB	0+00.00	719683.9610	1462058.8426
PIPE INLET	0+37.77	-	-
PIPE OUTLET	2+62.76	-	-
POE	3+12.93	719585.4091	1462355.8443

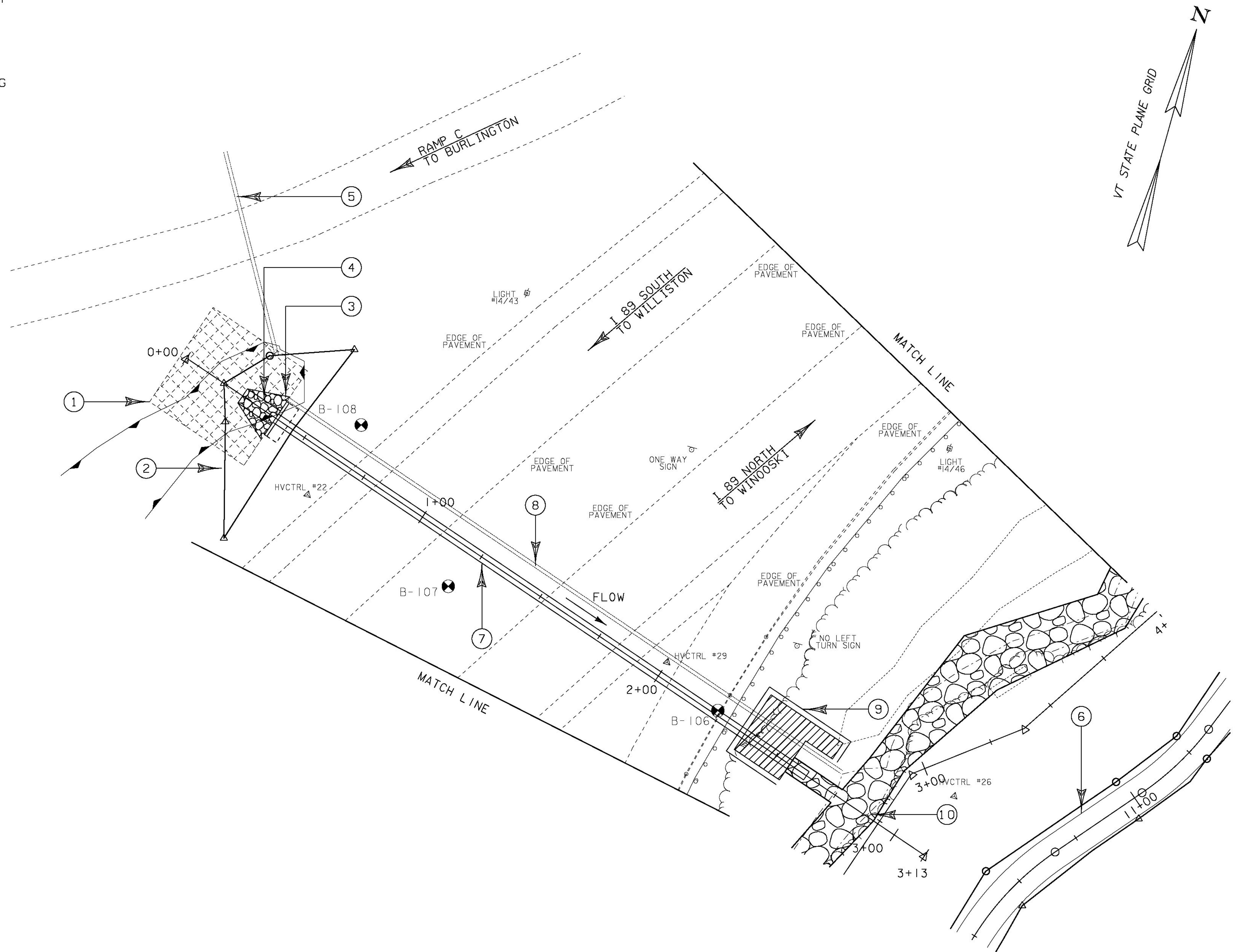

MM 88.877

PROJECT NAME: SOUTH BURLINGTON

PROJECT NUMBER: IM SCRP(3)

FILE NAME: d07a104bdr.dgn

PROJECT LEADER: K. UPMAL

DESIGNED BY: B. KIPP/B. McADAMS

LAYOUT SHEET 8

PLOT DATE: 13-JAN-2010

DRAWN BY: J. DEVLIN

CHECKED BY: B. KIPP

SHEET 32 OF 69