

AGENCY OF TRANSPORTATION



PROPOSED IMPROVEMENT CITY OF SOUTH BURLINGTON COUNTY OF CHITTENDEN INTERSTATE 89

WORK TO BE PERFORMED AT EIGHT CULVERT LOCATIONS, MILE MARKERS 87.300, 88.736, 88.787, 88.838, 88.867, 88.877, 88.880 AND 88.896 ON INTERSTATE 89 IN THE CITY OF SOUTH BURLINGTON.

THE PROJECT SHALL CONSIST OF INSTALLATION OF A CURED IN PLACE PIPE LINER, TEMPORARY ACCESS ROADS, PIPE RAMMING, CONCRETE HEADWALLS, CHANNEL EXCAVATION, EMBANKMENT STABILIZATION AND OTHER RELATED ITEMS.

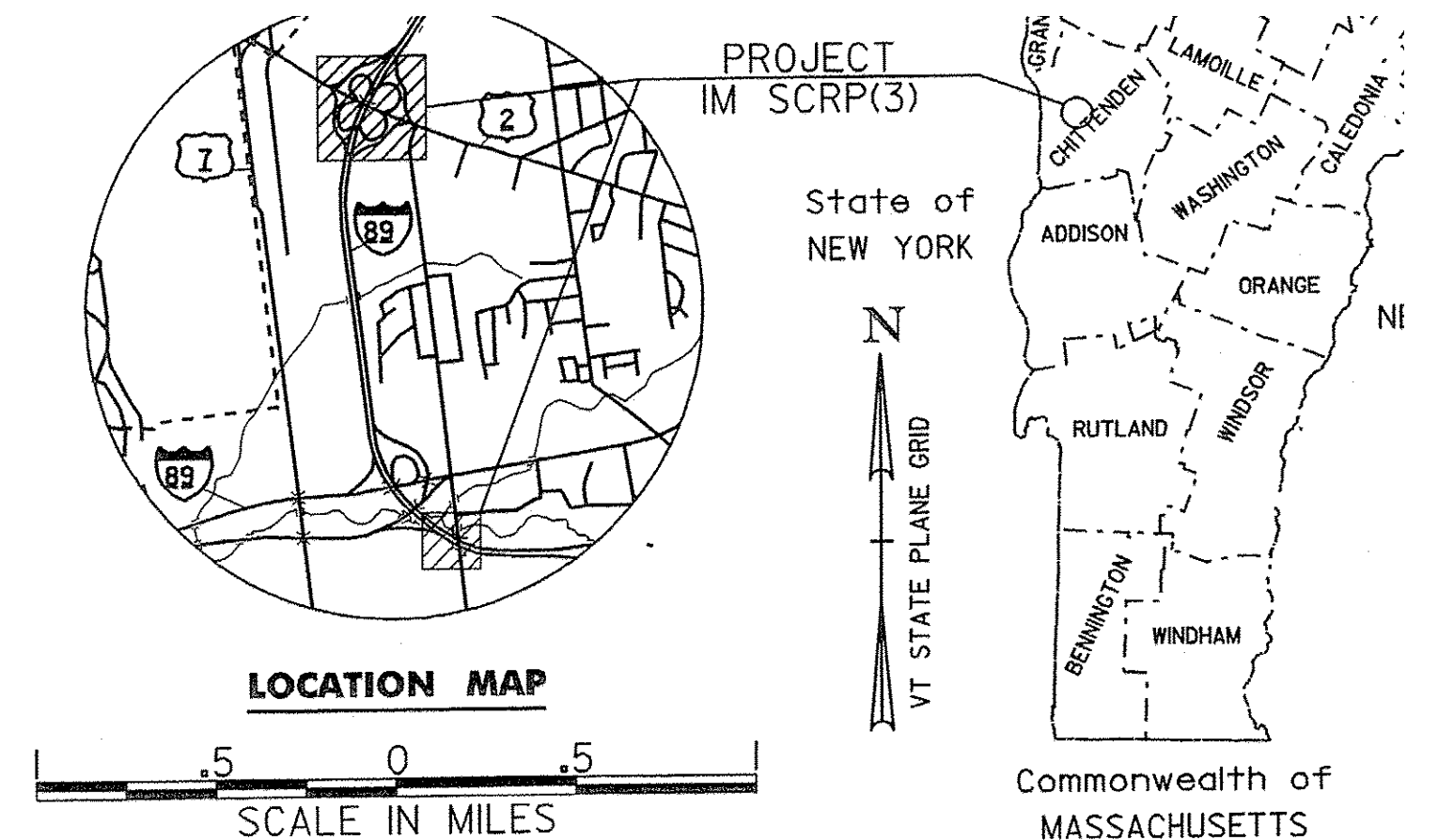

RECORD PLANS	
CONTRACTOR:	S. D. IRELAND CONC. CONST. CORP - BURLINGTON, VT
RESIDENT ENGINEER:	GREG WILCOX
CONSTRUCTION BEGAN:	APRIL 22, 2010
CONSTRUCTION COMPLETE:	JULY 13, 2011
RECORD PLANS BY:	GREG WILCOX & NICK GARBACIK
I HEREBY CERTIFY THAT ALL THE CONSTRUCTION REQUIRED BY THIS SET OF DRAWINGS HAS BEEN ACCOMPLISHED AS INDICATED HEREIN.	
BY:	<i>Greg Wilcox</i> RESIDENT ENGINEER
DATE:	August 20 th , 2012
NOTE: Any further information concerning final quantities, amounts or other details relative to this project may be found at Central Files in the electronic archives.	

**MM 87.243
BEGIN PROJECT**

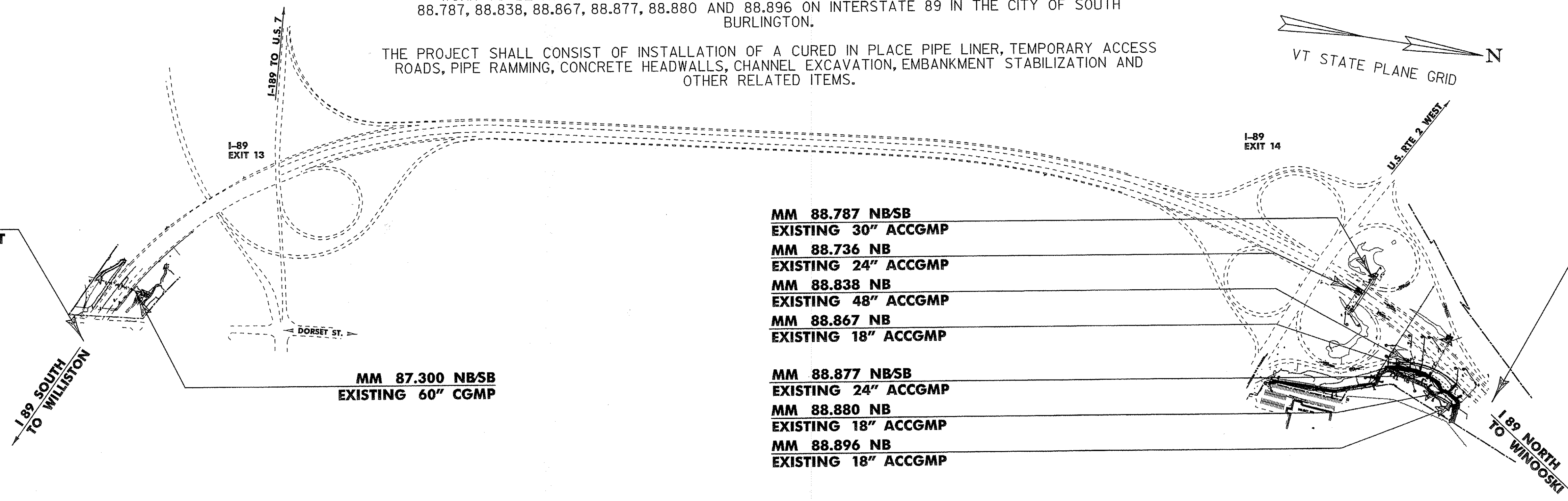

**MM 89.000
END PROJECT**

**MM 87.300 NB/SB
EXISTING 60" CGMP**

**MM 88.787 NBSB
EXISTING 30" ACCGMP**
**MM 88.736 NB
EXISTING 24" ACCGMP**
**MM 88.838 NB
EXISTING 48" ACCGMP**
**MM 88.867 NB
EXISTING 18" ACCGMP**

**MM 88.877 NBSB
EXISTING 24" ACCGMP**
**MM 88.880 NB
EXISTING 18" ACCGMP**
**MM 88.896 NB
EXISTING 18" ACCGMP**

CONVENTIONAL SYMBOLS

COUNTY LINE	
TOWN LINE	
LIMITS OF ACCESS	
POINT OF ACCESS	
FENCE LINE	
STONE WALL	
TRAVELED WAY	
GUARD RAIL	
RAILROAD	
SURVEY LINE	
CULVERT	
POWER POLE	
TELEPHONE POLE	
TREES	
CONTROL OF ACCESS	
PROPERTY LINE	
R.O.W. TAKING LINE	
SLOPE RIGHTS	
TOP OF CUT	
TOE OF SLOPE	

SURVEYED BY : L. ORVIS
SURVEYED DATE : 07/11/07

DATUM
VERTICAL NAVD88
HORIZONTAL NAD83

800 400 0 400 800
SCALE IN FEET

THESE PLANS ARE SUBJECT TO SUCH ENGINEERING CHANGES AS MAY BE REQUIRED BY THE FEDERAL HIGHWAY ADMINISTRATION OR THE DIRECTOR OF PROGRAM DEVELOPMENT.
CONSTRUCTION IS TO BE CARRIED ON IN ACCORDANCE WITH THESE PLANS AND THE STANDARD SPECIFICATIONS FOR CONSTRUCTION DATED 2006, AS APPROVED BY THE FEDERAL HIGHWAY ADMINISTRATION ON JUNE 15, 2006 FOR USE ON THIS PROJECT, INCLUDING ALL SUBSEQUENT REVISIONS AND SUCH REVISED SPECIFICATIONS AND SPECIAL PROVISIONS AS ARE INCORPORATED IN THESE PLANS.

DIRECTOR OF PROGRAM DEVELOPMENT
APPROVED: *Richard F. ...*
PROJECT MANAGER : K. UPMAL
PROJECT NAME : SOUTH BURLINGTON
PROJECT NUMBER : 1M SCRP (3)
SHEET 1 OF 69 SHEETS