

646.662 TEMPORARY 12" WHITE LINE, PAINT
 646.466 DURABLE 12" WHITE LINE, RECESSED POLYUREA
 646.466 DURABLE 12" WHITE LINE, RECESSED EPOXY PAINT
 69.773 TO 69.952 DOTTED LT
 69.952 TO 69.974 SOLID LT
 69.961 TO 69.974 SOLID LT (RAMP G)
 70.083 TO 70.115 SOLID LT
 70.083 TO 70.106 SOLID LT (RAMP H)
 70.083 TO 70.106 SOLID LT (GORE STRIPES)
 70.115 TO 70.275 DOTTED LT

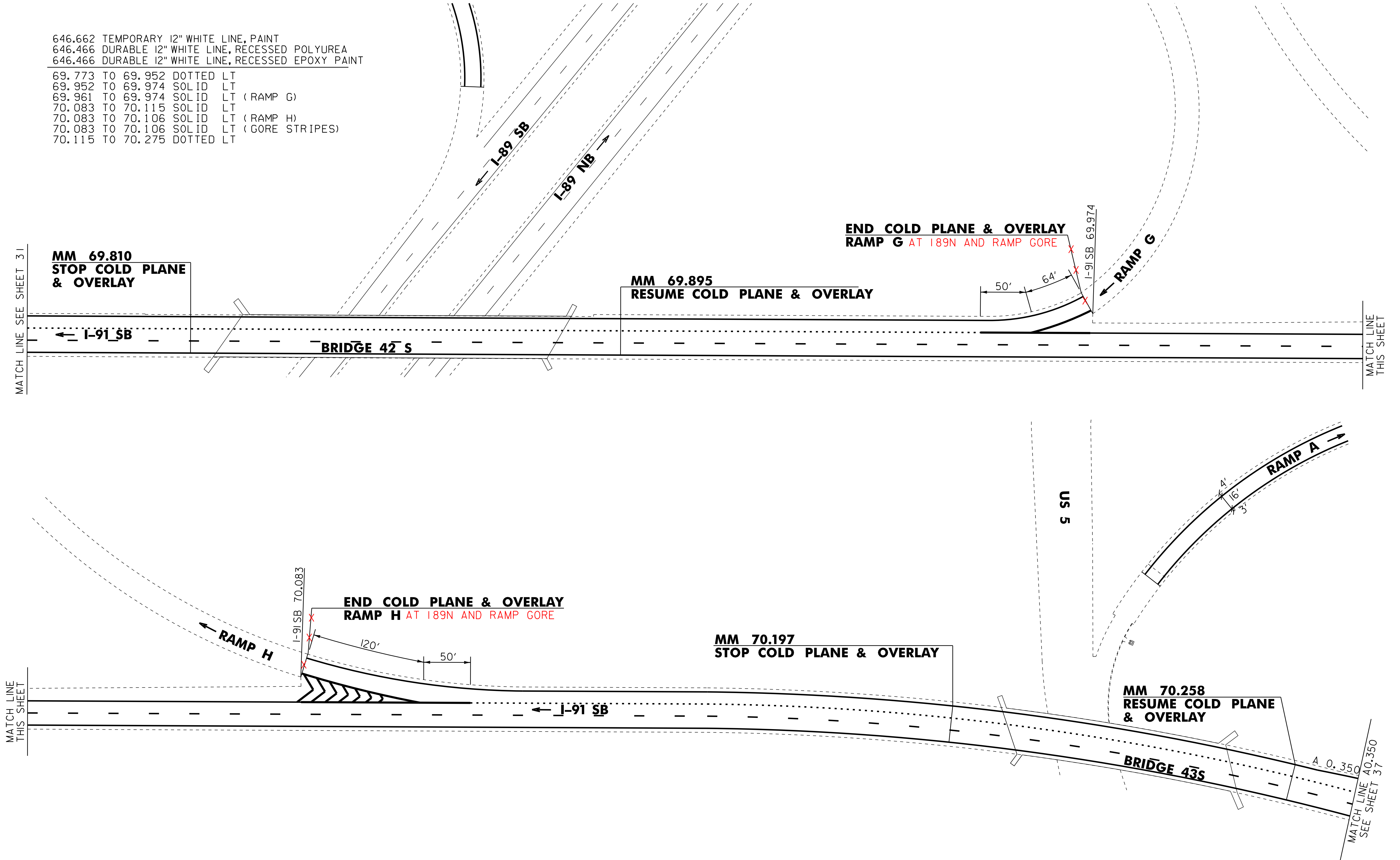

MM 69.810
 STOP COLD PLANE
 & OVERLAY

MM 69.895
 RESUME COLD PLANE & OVERLAY

END COLD PLANE & OVERLAY
 RAMP G AT I89N AND RAMP GORE

END COLD PLANE & OVERLAY
 RAMP H AT I89N AND RAMP GORE

MM 70.197
 STOP COLD PLANE & OVERLAY

MM 70.258
 RESUME COLD PLANE
 & OVERLAY

LEGEND

- R = REMOVE EXISTING
- S = SALVAGE
- R&S = REMOVE AND SALVAGE
- N = NEW
- RET = RETAIN
- B-B = BACK TO BACK
- = EXISTING GUARDRAIL
- = PROPOSED GUARDRAIL
- YL = YELLOW LINE
- WL = WHITE LINE

**EXIT 10 & 11
 WEAVE LANE DETAIL SHEET**

PROJECT NAME: HARTLAND-NORWICH
 PROJECT NUMBER: IM 091-I(59)

FILE NAME: /pave/06a202/p06a202.dgn PLOT DATE: 21-NOV-2012 11:45
 PROJECT LEADER: PTS DRAWN BY: WWG
 DESIGNED BY: NULL CHECKED BY: PTS
 IPARM FILE NAME: 06A202_34 SHEET 34 OF 60

NOT TO SCALE