

EXIT 3 - RAMP B NORTHBOUND OFF RAMP

SEE STANDARDS E-191, E-192 AND E-193
FOR PAVEMENT MARKING GUIDELINES

TEMPORARY 6" WHITE LINE, PAINT
DURABLE 6" WHITE LINE, RECESSED

110+50 TO 118+01 SOLID LT
114+79 TO 118+01 DOTTED RT
1167+56 TO 1167+99 DOTTED RT

TEMPORARY 6" YELLOW LINE, PAINT
DURABLE 6" YELLOW LINE, RECESSED

110+50 TO 113+37 SOLID RT

TEMPORARY 12" WHITE LINE, PAINT
DURABLE 12" WHITE LINE, RECESSED

113+37 TO 114+79 SOLID RT
113+37 TO 114+79 SOLID RT (GORE STRIPES)
1171+21 TO 1172+63 SOLID RT

DELINEATORS

REFER TO STANDARDS E-197 AND
E-198 FOR PLACEMENT GUIDELINES

REMOVING SIGNS

AS SHOWN TYPE A - 9
AS SHOWN TYPE B - 0

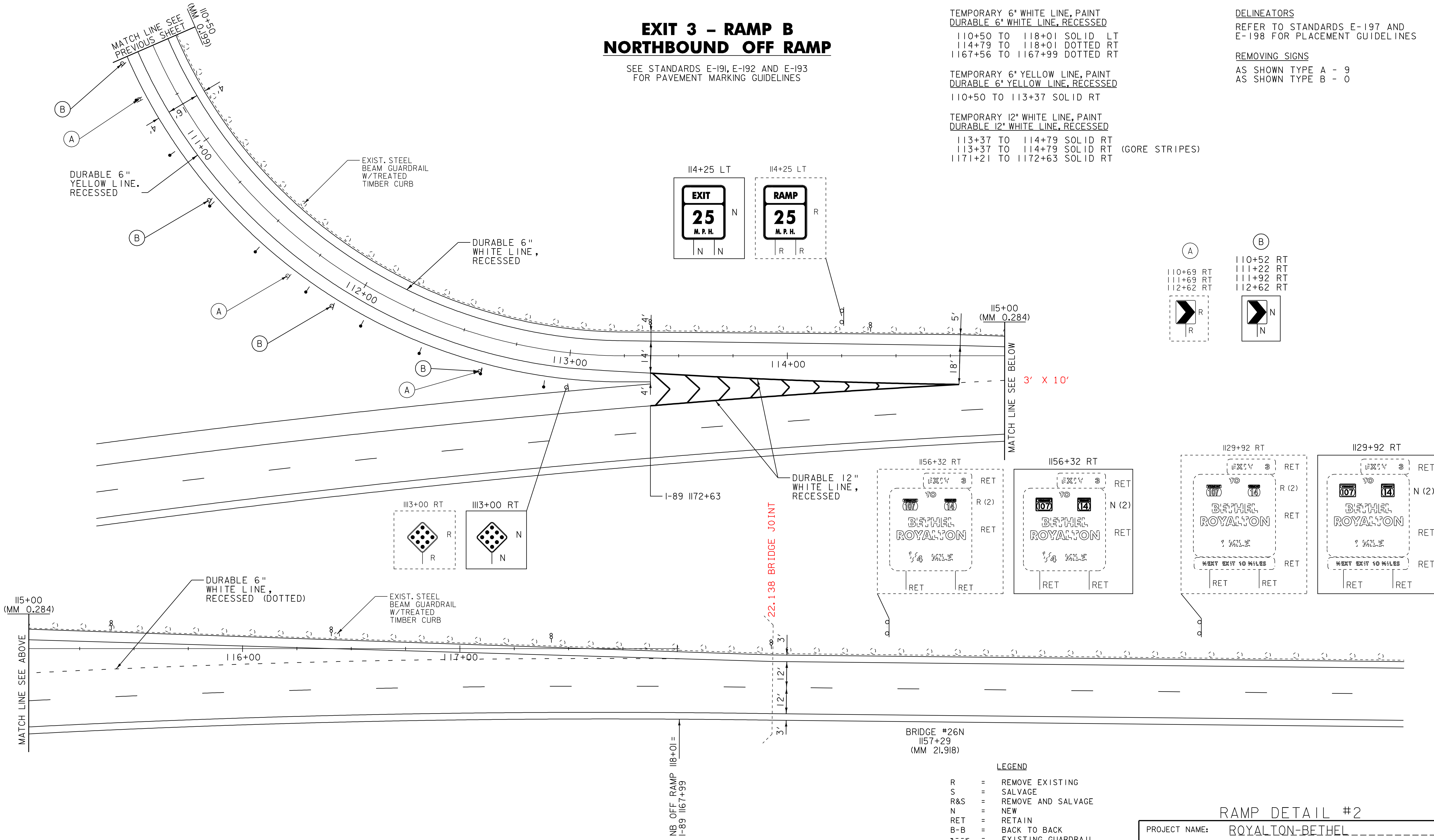

NOT TO SCALE

LEGEND

- R = REMOVE EXISTING
- S = SALVAGE
- R&S = REMOVE AND SALVAGE
- N = NEW
- RET = RETAIN
- B-B = BACK TO BACK
- = EXISTING GUARDRAIL
- - - = PROPOSED GUARDRAIL
- = TYPE I DELINEATOR, WHITE
- = TYPE I DELINEATOR, AMBER
- = TYPE II DELINEATOR, WHITE
- = TYPE III DELINEATOR, RIGHT
- = TYPE III DELINEATOR, LEFT

RAMP DETAIL #2

PROJECT NAME:	ROYALTON-BETHEL
PROJECT NUMBER:	IM 089-1(54)
FILE NAME:	p06a198.dgn
PROJECT LEADER:	PTS
DESIGNED BY:	NLL
IPARM FILE NAME:	p06a198r.d2.1
PLOT DATE:	28-JUN-2010 15:12
DRAWN BY:	MRS
CHECKED BY:	PTS
SHEET	15 OF 37