

**INTERSTATE ROUTE 89
SOUTHBOUND
MM 30.450
BEGIN PROJECT IM 089-1(22)**

SEE SHEET 35 & 36 FOR
INTERCHANGE #4 DETAILS

SEE SHEET 38 FOR
SOUTHBOUND REST AREA DETAILS

**INTERSTATE ROUTE 89
SOUTHBOUND
MM 36.933
END PROJECT IM 089-1(22)**

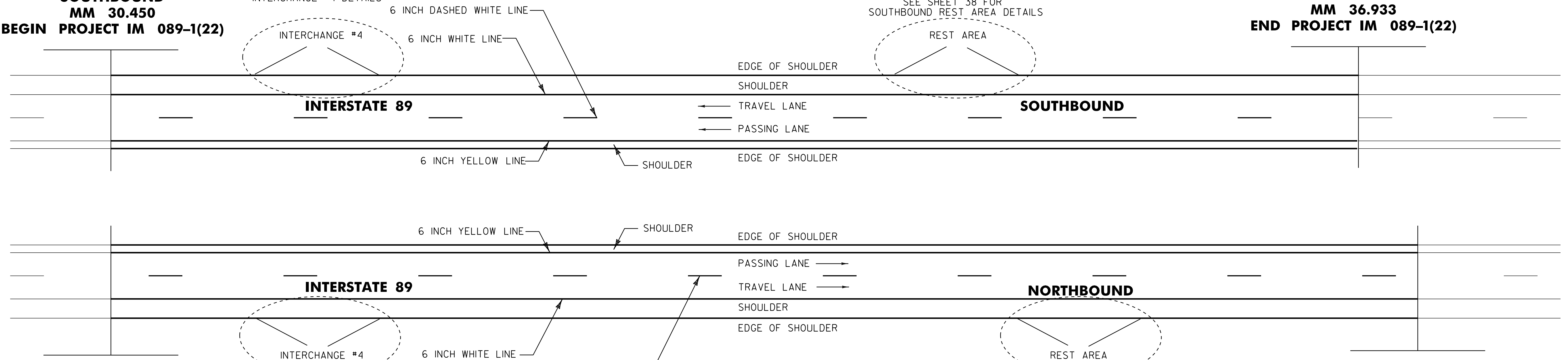

**INTERSTATE ROUTE 89
NORTHBOUND
MM 30.450
BEGIN PROJECT IM 089-1(22)**

SEE SHEETS 35 & 36 FOR
INTERCHANGE #4 DETAILS

SEE SHEET 37 FOR
NORTHBOUND REST AREA DETAIL

**INTERSTATE ROUTE 89
NORTHBOUND
MM 37.702
END PROJECT IM 089-1(22)**

604.412 REHAB. DROP INLET, CATCH BASIN OR MANHOLE, CLASS I

NORTHBOUND:
MM 33.471 LT
MM 33.471 RT
MM 33.548 LT
MM 33.548 RT
MM 33.605 LT
MM 33.605 RT
MM 33.662 LT
MM 33.662 RT
MM 37.496 RT
MM 35.720 RT
MM 35.775 LT
MM 35.775 RT
MM 35.556 LT
MM 36.559 RT
MM 36.589 RT
MM 37.583 RT
MM 37.638 RT

SOUTHBOUND:
MM 31.444 LT
MM 31.504 LT
MM 32.317 RT
MM 33.734 RT
MM 36.282 LT

NORTHBOUND:
MM 30.450 - MM 37.702 CL (DASHED)
MM 30.450 - MM 30.545 RT (SOLID)
MM 30.687 - MM 31.170 RT (SOLID)
MM 31.406 - MM 34.187 RT (SOLID)
MM 34.312 - MM 34.571 RT (SOLID)
MM 34.785 - MM 37.702 RT (SOLID)

SOUTHBOUND:
MM 30.450 - MM 36.933 CL (DASHED)
MM 30.450 - MM 30.502 LT (SOLID)
MM 30.724 - MM 31.070 LT (SOLID)
MM 31.184 - MM 33.246 LT (SOLID)
MM 33.496 - MM 33.688 LT (SOLID)
MM 33.817 - MM 36.933 LT (SOLID)

646.436 DURABLE 6 INCH YELLOW LINE, RECESSED

NORTHBOUND:
MM 30.450 - MM 37.702 LT (SOLID)

SOUTHBOUND:
MM 30.450 - MM 36.933 RT (SOLID)
646.622 TEMPORARY 6 INCH WHITE LINE, PAINT

NORTHBOUND:
MM 30.450 - MM 37.702 CL (DASHED)
MM 30.450 - MM 30.545 RT (SOLID)
MM 30.687 - MM 31.170 RT (SOLID)
MM 31.406 - MM 34.187 RT (SOLID)
MM 34.312 - MM 34.571 RT (SOLID)
MM 34.785 - MM 37.702 RT (SOLID)

SOUTHBOUND:
MM 30.450 - MM 36.933 CL (DASHED)
MM 30.450 - MM 30.502 LT (SOLID)
MM 30.724 - MM 31.070 LT (SOLID)
MM 31.184 - MM 33.246 LT (SOLID)
MM 33.496 - MM 33.688 LT (SOLID)
MM 33.817 - MM 36.933 LT (SOLID)

646.632 TEMPORARY 6 INCH YELLOW LINE, PAINT

NORTHBOUND:
MM 30.450 - MM 37.702 LT (SOLID)

SOUTHBOUND:
MM 30.450 - MM 36.933 RT (SOLID)

675.50 REMOVING SIGNS
NORTHBOUND - 34

SOUTHBOUND - 25
676.10 DELINEATOR WITH STEEL POST
REFER TO STANDARDS E-197, E-198
AND E-199 FOR PLACEMENT GUIDELINES

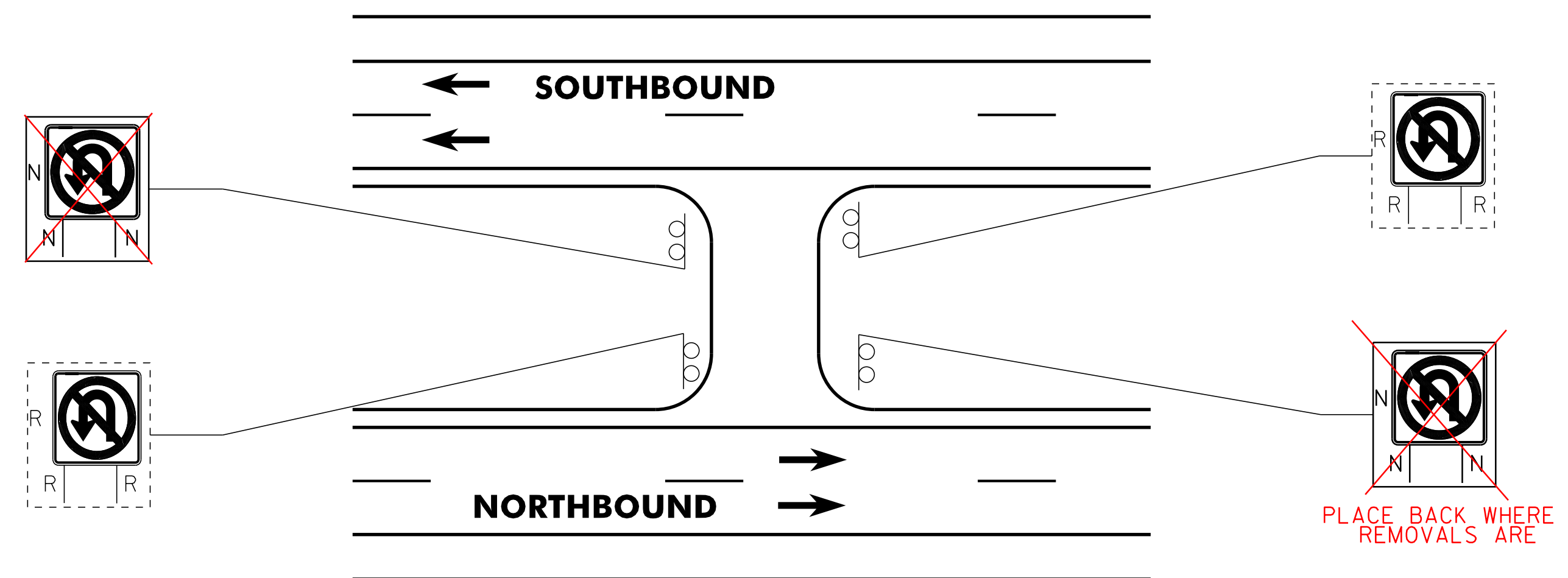

U-TURN DETAIL

N.B. MM 31.500 (33'x44')
N.B. MM 32.890 (22'x95')
N.B. MM 35.010 (20'x355')
N.B. MM 35.110 (20'x363')
N.B. MM 37.600 (34'x64')

NOTE:

1. THE CONTRACTOR SHALL INSTALL MILLED RUMBLE STRIPS WITHIN THE PROJECT LIMITS AS SHOWN ON SHEET 12 OR AS DIRECTED BY THE RESIDENT ENGINEER.

NOT TO SCALE

**PROJECT
LAYOUT
SHEET**

SIGN LEGEND
R = REMOVE
S = SALVAGE
N = NEW
RET = RETAIN
B-B = BACK TO BACK
EXISTING = - - - - -
NEW = _____

PROJECT NAME: RANDOLPH - BROOKFIELD
PROJECT NUMBER: IM 089-1(22)

FILE NAME: p99a200.dgn
PROJECT LEADER: D.E.G.
DESIGNED BY: D.W.E.
IPARM FILE: p06A048p01.i
PLOT DATE: \$DATE\$
DRAWN BY: C.A.K.
CHECKED BY: D.W.E.
SHEET 34 OF 61

FILE NAME = \$FILES\$
DATE/TIME = \$DATE\$ \$TIME\$
USER = \$NTUSER\$