

TEMPORARY 6" WHITE LINE, PAINT
 DURABLE 6" WHITE LINE, RECESSED OPTION
 D 0.048 TO D 0.428 SOLID RT
 128.546 TO 128.556 DOTTED LT

TEMPORARY 6" YELLOW LINE, PAINT
 DURABLE 6" YELLOW LINE, RECESSED OPTION
 D 0.048 TO D 0.428 SOLID LT

TEMPORARY 12" WHITE LINE, PAINT
 DURABLE 12" WHITE LINE, RECESSED OPTION
 D 0.029 TO D 0.048 SOLID LT
 D 0.029 TO D 0.048 SOLID LT (GORE STRIPES)
 128.518 TO 128.546 SOLID LT

STEEL BEAM GUARDRAIL, GALVANIZED
 MANUFACTURED TERMINAL SECTION, FLARED
 ANCHOR FOR STEEL BEAM RAIL
 REMOVAL AND DISPOSAL OF GUARDRAIL
 DELINEATOR WITH STEEL POST
 SEE ITEM DETAIL SUMMARY SHEETS

**INTERSTATE ROUTE 91 SB
 END PROJECT
 NEWBURY-ST. JOHNSBURY
 AC IM 091-2(76)
 (MM 128.556)**

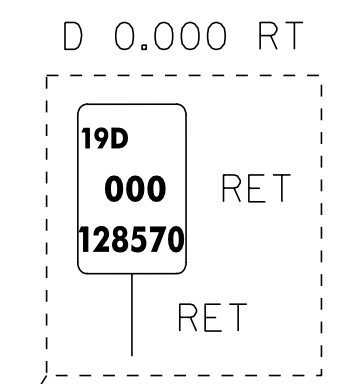
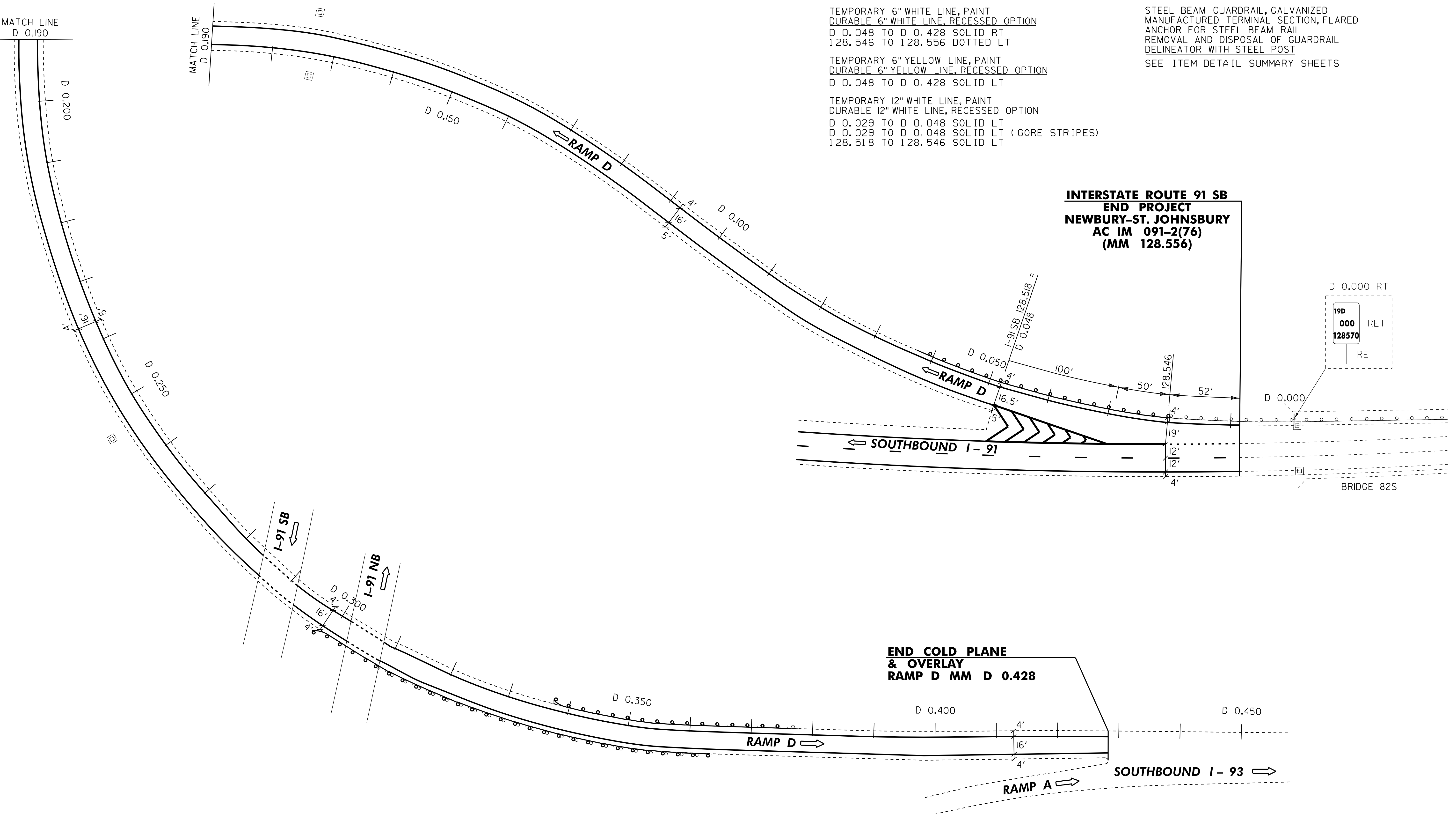

**END COLD PLANE
 & OVERLAY
 RAMP D MM D 0.428**

- LEGEND**
- = EXISTING GUARDRAIL
 - = PROPOSED GUARDRAIL
 - = DI

NOT TO SCALE

EXIT 19 OFF RAMP DETAIL SHEET

PROJECT NAME: NEWBURY-ST. JOHNSBURY	
PROJECT NUMBER: AC IM 091-2(76)	
FILE NAME: 06a046	PLOT DATE: 29-JUL-2014 16:46
PROJECT LEADER: PTS	DRAWN BY: JLS
DESIGNED BY: NLL	CHECKED BY: PTS
IPARM FILE NAME: 06A046_32	SHEET 32 OF 33