

INDEX OF SHEETS

- 1. TITLE SHEET
- 2.-3. TYPICAL SHEETS
- 4. QUANTITY SHEET
- 5. INTERCHANGE DETAIL SHEET
- 6.-7. CONSTRUCTION APPROACH SIGNING SHEETS

STANDARDS

E-100	CONSTRUCTION APPROACH SIGNS	01/02/04
E-101	CONSTRUCTION SIGN DETAILS	05/30/03
E-102	CONSTRUCTION SIGN DETAILS	06/30/03
E-102A	CONSTRUCTION SIGN DETAILS	05/01/04
E-103	MAINLINE TRAFFIC CONTROL DIVIDED HIGHWAY ONE LANE CLOSED	03/01/04
E-105	TRAFFIC CONTROL FOR CONSTRUCTION VEHICLE U-TURNS ON DIVIDED HIGHWAY	05/01/04
E-106	TRAFFIC CONTROL - MISCELLANEOUS DETAILS	03/01/04
E-107A	BREAKAWAY BARRICADE DETAILS	08/08/95
E-108	CONSTRUCTION ZONE LONGITUDINAL DROP OFFS	08/18/95
E-191	PAVEMENT MARKING DETAILS	02 / 01 / 99
E-192	PAVEMENT MARKING DETAILS	10 / 12 / 00

STATE OF VERMONT  
AGENCY OF TRANSPORTATION

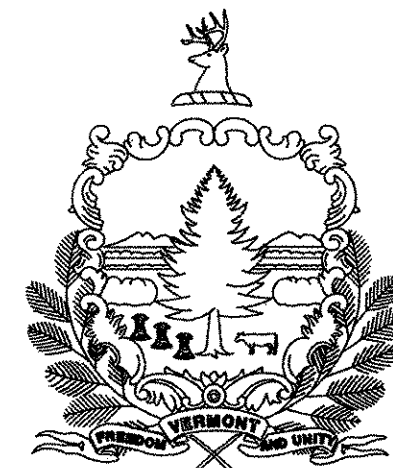

PROPOSED IMPROVEMENT

TOWNS OF WILLIAMSTOWN-NORTHFIELD  
BERLIN-MONTPELIER  
COUNTIES OF ORANGE AND WASHINGTON  
INTERSTATE ROUTE 89

BEGINNING AT MM 43.950 ON THE SOUTHBOUND LANES IN THE TOWN OF WILLIAMSTOWN  
AND EXTENDING 8.500 MILES NORTH TO MM 52.450 IN THE TOWN OF MONTPELIER

LENGTH OF PROJECT 8.500 MILES  
LENGTH OF ROADWAY 8.500 MILES

WORK TO BE PERFORMED UNDER THIS PROJECT INCLUDES THE CONSTRUCTION OF  
PREVENTATIVE MAINTENANCE TREATMENT SITES ON THE EXISTING INTERSTATE TYPICAL.

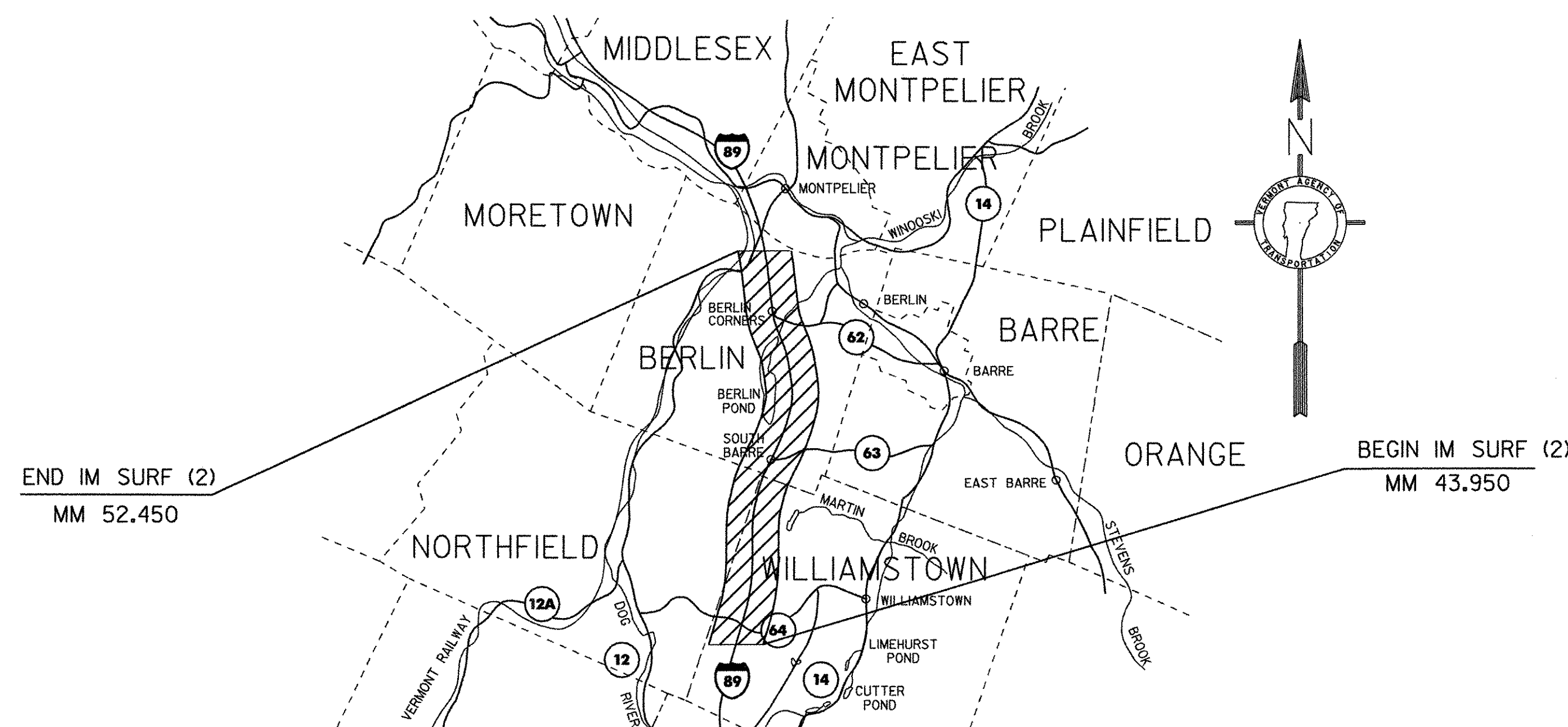
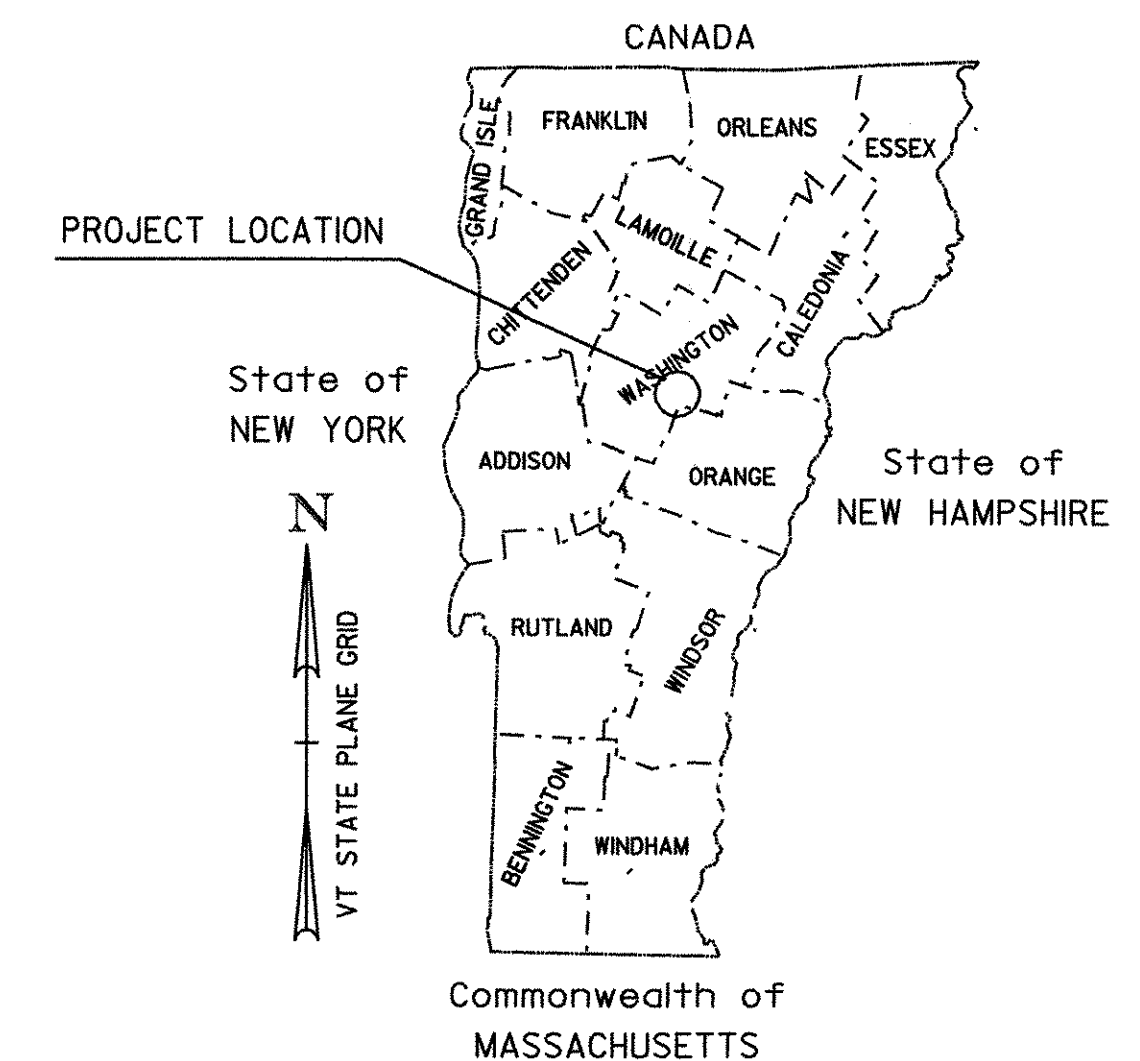

CONVENTIONAL SIGNS

COUNTY LINE	---
TOWN LINE	- - - -
LIMITS OF ACCESS	○-○-○-○
POINT OF ACCESS	X
FENCE LINE	-x-x-
STONE WALL	○○○○○○○○○○
TRAVELED WAY	---
GUARD RAIL	○-○-○-○
RAILROAD	+
SURVEY LINE	+
CULVERT	---
POWER POLE	⊕
TELEPHONE POLE	⊕
TREES	⊗
CONTROL OF ACCESS	///
PROPERTY LINE	---
R.O.W. TAKING LINE	SR
SLOPE RIGHTS	○-△
TOP OF CUT	△
TOE OF SLOPE	○

DATUM

VERTICAL	N/A
HORIZONTAL	N/A

RECORD PLANS

CONTRACTOR: PIKE INDUSTRIES, INC. - BERLIN, VT

RESIDENT ENGINEER: E.J. BLONDIN

CONSTRUCTION BEGAN: AUGUST 29, 2006

CONSTRUCTION COMPLETE: NOVEMBER 1, 2006

RECORD PLANS BY: E.J. BLONDIN & C. PIERCE

I HEREBY CERTIFY THAT ALL THE CONSTRUCTION REQUIRED BY THIS SET OF DRAWINGS HAS BEEN ACCOMPLISHED AS INDICATED HEREIN.

BY Brigitte M. Collins RESIDENT ENGINEER  
DATE October 5, 2007 for E.J. Blondin

NOTE: Any further information concerning final quantities, amounts or other details relative to this project may be found at Central Files in the electronic archives.

THESE PLANS ARE SUBJECT TO SUCH ENGINEERING CHANGES AS MAY BE REQUIRED BY THE FEDERAL HIGHWAY ADMINISTRATION OR THE DIRECTOR OF PROGRAM DEVELOPMENT. CONSTRUCTION IS TO BE CARRIED ON IN ACCORDANCE WITH THESE PLANS AND THE STANDARD SPECIFICATIONS FOR CONSTRUCTION DATED 2001, AS APPROVED BY THE FEDERAL HIGHWAY ADMINISTRATION ON JANUARY 4, 2001 FOR USE ON THIS PROJECT, INCLUDING ALL SUBSEQUENT REVISIONS AND SUCH REVISED SPECIFICATIONS AND SPECIAL PROVISIONS AS ARE INCORPORATED IN THESE PLANS.

APPROVED [Signature] DATE 6-23-06  
DIRECTOR OF PROGRAM DEVELOPMENT

DEPARTMENT OF TRANSPORTATION  
FEDERAL HIGHWAY ADMINISTRATION

APPROVED [Signature] DATE 7-12-06  
DIVISION ADMINISTRATOR

PROJECT WILLIAMSTOWN-MONTPELIER  
IM SURF (2)

SHEET 1 OF 7 SHEETS

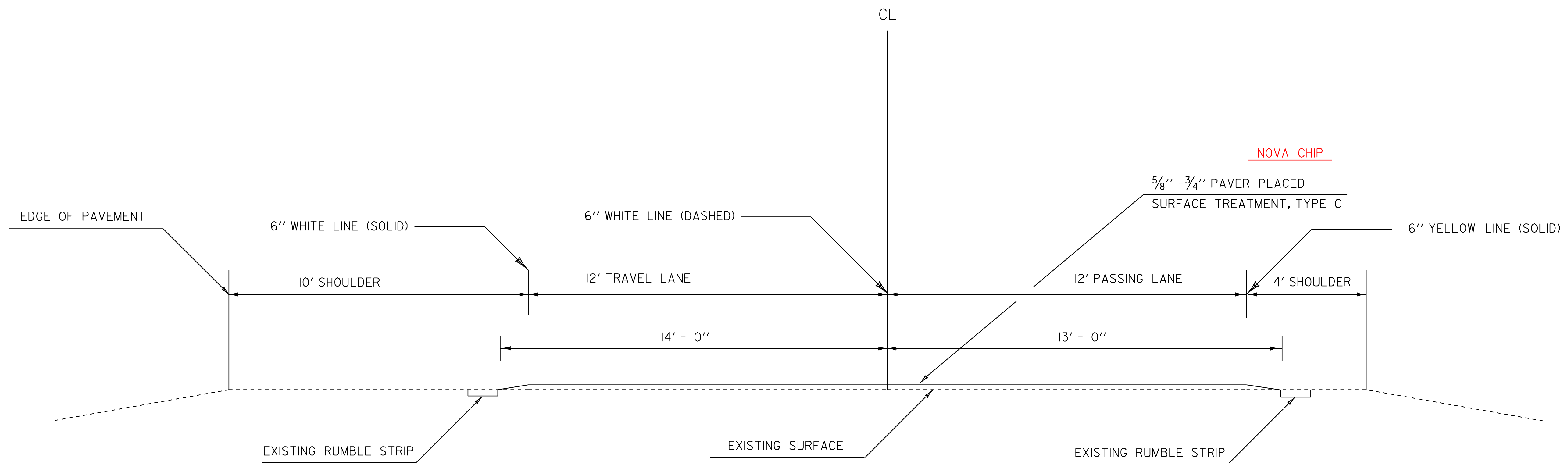

**TYPICAL SECTION**  
**I 89 SOUTHBOUND - MM 43.950 - 48.250**

NOTES:

1. ALL NECESSARY SURFACE PREPARATION (POTHOLE REPAIR, RAVELING, CRACK FILLING) SHALL BE PERFORMED PRIOR TO CONSTRUCTING THE PAVER PLACED SURFACE TREATMENT AND/OR THE QUICK SET SLURRY. ESTIMATED QUANTITIES OF ITEMS 406.25 (MOD.) AND 417.10 HAVE BEEN INCLUDED TO COVER THIS PROVISION.
2. THE PAVER PLACED SURFACE TREATMENT DETAILED ON THIS SHEET AND THE QUICK SET SLURRY DETAILED ON SHEET # 3, ALL EXISTING PAVEMENT MARKINGS SHALL BE REMOVED PRIOR TO APPLYING THE APPLICABLE TREATMENT. AN ESTIMATED QUANTITY OF 50 % REMOVAL OF EXISTING MARKINGS HAS BEEN INCLUDED TO COVER THIS PROVISION.
3. A 50' COLD PLANED WEDGE SHALL BE CONSTRUCTED AT THE PROJECT BEGIN, PROJECT END, INTERCHANGE RAMPS, AND AT ALL BEGIN/END BRIDGE APPROACHES WITHIN THE PROJECT LIMITS. THE LONGITUDINAL EDGES OF THE SURFACE TREATMENTS SHALL BE FEATHERED AS DIRECTED BY THE RESIDENT ENGINEER.

BRIDGES WITHIN THE PROJECT ARE:

BRIDGE NUMBER	36S	MM 46.920 (NO WORK REQUIRED)
BRIDGE NUMBER	37S	MM 50.000 (NO WORK REQUIRED)
BRIDGE NUMBER	38S	MM 50.290 (NO WORK REQUIRED)

REVISED 8-2-06

N.T.S.

<b>TYPICAL SECTION - PAVER PLACED SURFACE TREATMENT</b>	PROJECT NAME: WILLIAMSTOWN-MONTPELIER	PLOT DATE: 24-OCT-2007 13:3
	PROJECT NUMBER: IM SURF(2)	DRAWN BY: KAS
	FILE NAME: /pave/05a388/p05a388.dgn	CHECKED BY: KML
	DESIGNED BY: KAS	SHEET 2 OF 7

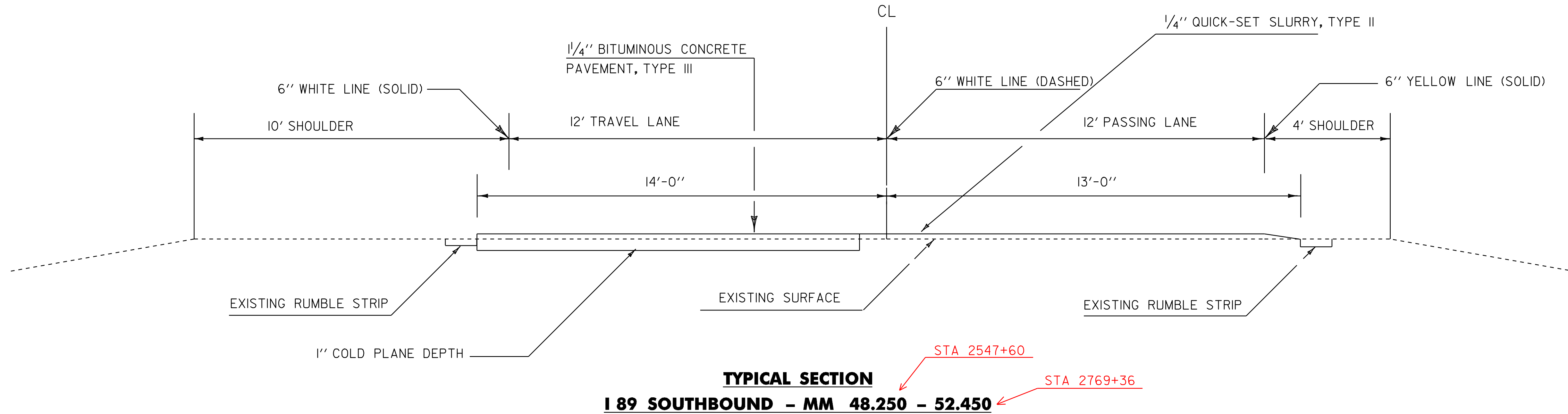

NOTES:

1. THE SINGLE PAVEMENT LIFT WEARING COURSE SHALL BE TYPE III, ITEM 406.25, AS SHOWN ON THE TYPICALS, UNLESS DIRECTED BY THE RESIDENT ENGINEER. ALL LIQUID ASPHALT USED FOR BITUMINOUS CONCRETE PAVEMENT SHALL BE PG 58-34.
2. EMULSIFIED ASPHALT SHALL BE APPLIED ON ALL COLD PLANED SURFACES AT THE RATE OF 0.025 GAL./S.Y. OR AS DIRECTED BY THE RESIDENT ENGINEER.
3. COLD PLANING SHALL BE COMPLETED ACCORDING TO TYPICAL OR AS DIRECTED BY THE RESIDENT ENGINEER.

CHANGE TO TYPE IV

REVISED 8-2-06

**TYPICAL SECTION -  
QUICK SET SLURRY,  
TYPE II**

PROJECT NAME: WILLIAMSTOWN-MONTPELIER  
PROJECT NUMBER: IM SURF(2)

FILE NAME: /pave/05a388/p05a388.dgn PLOT DATE: 24-OCT-2007 13:3  
PROJECT LEADER: WOOLAVER DRAWN BY: KAS  
DESIGNED BY: KAS CHECKED BY: KML  
p05a388+yp2.i SHEET 3 OF 7



N.T.S.

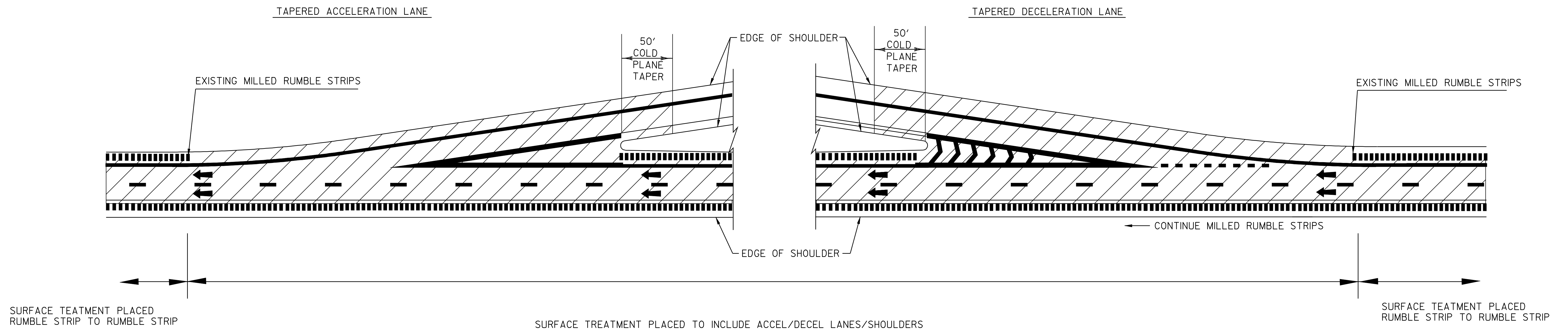
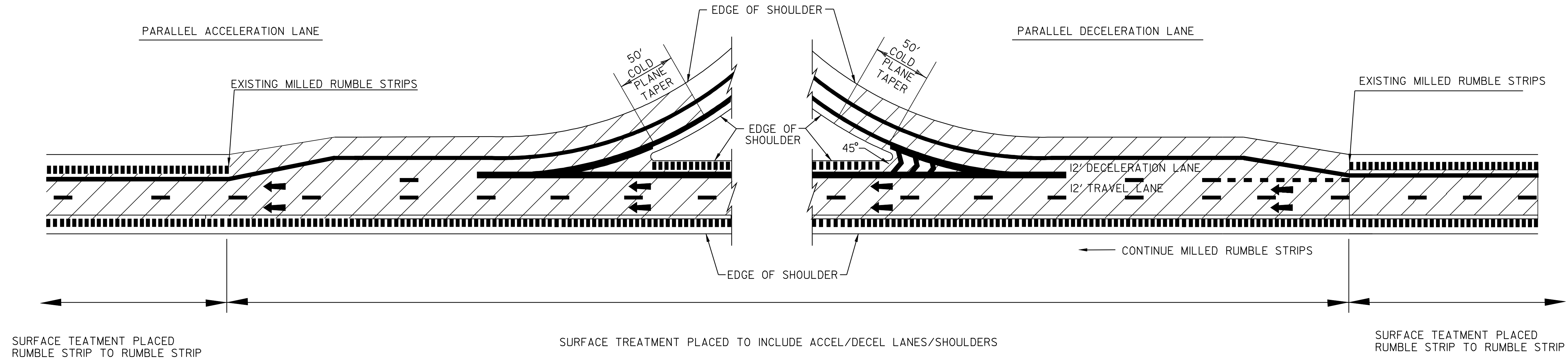

# TYPICAL INTERCHANGE CONSTRUCTION DETAILS

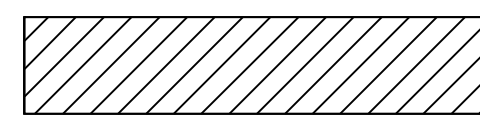

### LEGEND

-  = AREA OF PAVER PLACED SURFACE TREATMENT
-  DIRECTION OF TRAFFIC FLOW
-  MILLED RUMBLE STRIPS

### NOTES:

1. A 50' COLD PLANED WEDGE SHALL BE CONSTRUCTED AT A POINT MEASURED BACK FROM THE RAMP GORE.
2. LINE STRIPING SHOWN FOR REFERENCE ONLY.

N.T.S.

**INTERCHANGE  
DETAIL  
SHEET**

PROJECT NAME: STATEWIDE	PLOT DATE: 24-OCT-2007 13:3
PROJECT NUMBER: IM SURF(2)	DRAWN BY: KAS
FILE NAME: /pave/05a388/p05a388.dgn	CHECKED BY: KML
PROJECT LEADER: WOOLAVER	SHEET 5 OF 7
DESIGNED BY: KAS	
p05a388lay.1	

RAMP TYPICAL - SEE NEXT SHEET

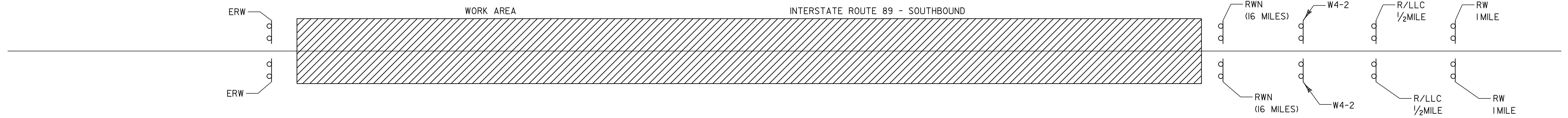

**NOTE:**

THE CONTRACTOR SHALL INCLUDE A CONSTRUCTION SIGN APPROACH PACKAGE FOR EXPECTED LANE CLOSURES AND WORKZONE SPEED REDUCTIONS IN COMPLIANCE WITH STD. E-103. PAYMENT FOR THIS PACKAGE SHALL BE INCIDENTAL TO ITEM 641.10, "TRAFFIC CONTROL".

**LEGEND**

- RW 1MILE = ROAD WORK 1MILE
- R/LLC 1/2MILE = RIGHT LANE CLOSED 1/2MILE/OR LEFT LANE
- RWN = ROAD WORK NEXT (X MILES)
- ERW = END ROAD WORK
- SRWA = SIDE ROAD WORK AHEAD
- SRW 500 = SIDE ROAD WORK 500 FT
- ////// = WORK AREA

SEE STD E-100 AND E-103 FOR SIGN PLACEMENT.

**NOT TO SCALE**

**CONSTRUCTION  
APPROACH  
SIGNING  
SHEET #1**

PROJECT NAME:	WILLIAMSTOWN-MONTPELIER
PROJECT NUMBER:	1M SURF (2)
FILE NAME:	/pave/05a388/p05a388.dgn
PROJECT LEADER:	M. WOOLAVER
DESIGNED BY:	KAS
p05a388+cl1	
PLOT DATE:	24-OCT-2007 13:3
DRAWN BY:	KAS
CHECKED BY:	KML
SHEET	6 OF 7

# CONSTRUCTION APPROACH SIGNING DETAIL - INTERCHANGES

SEE STANDARD E-100 FOR ADDITIONAL SIGN PLACEMENT

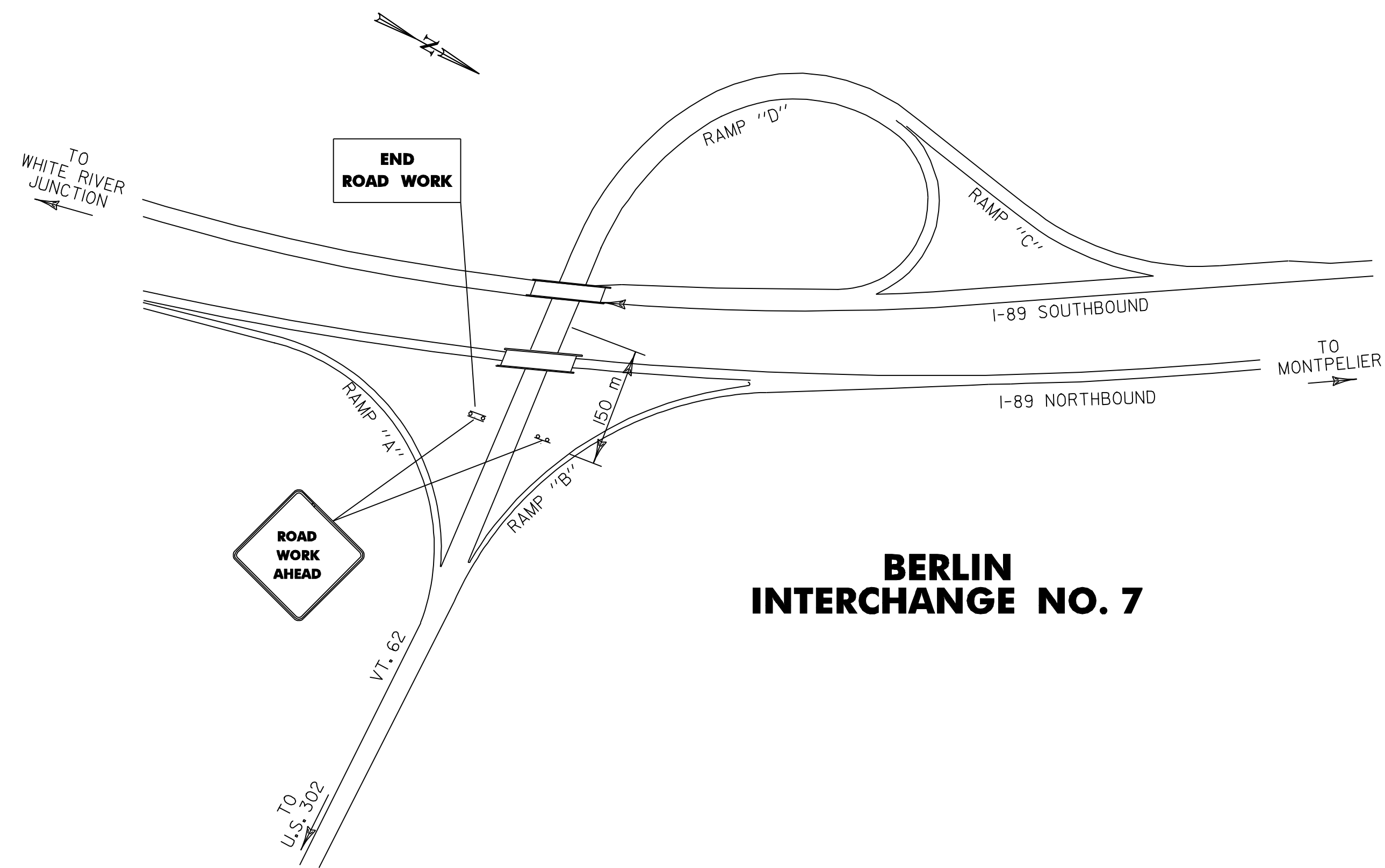

## SOUTH BARRE INTERCHANGE NO. 6

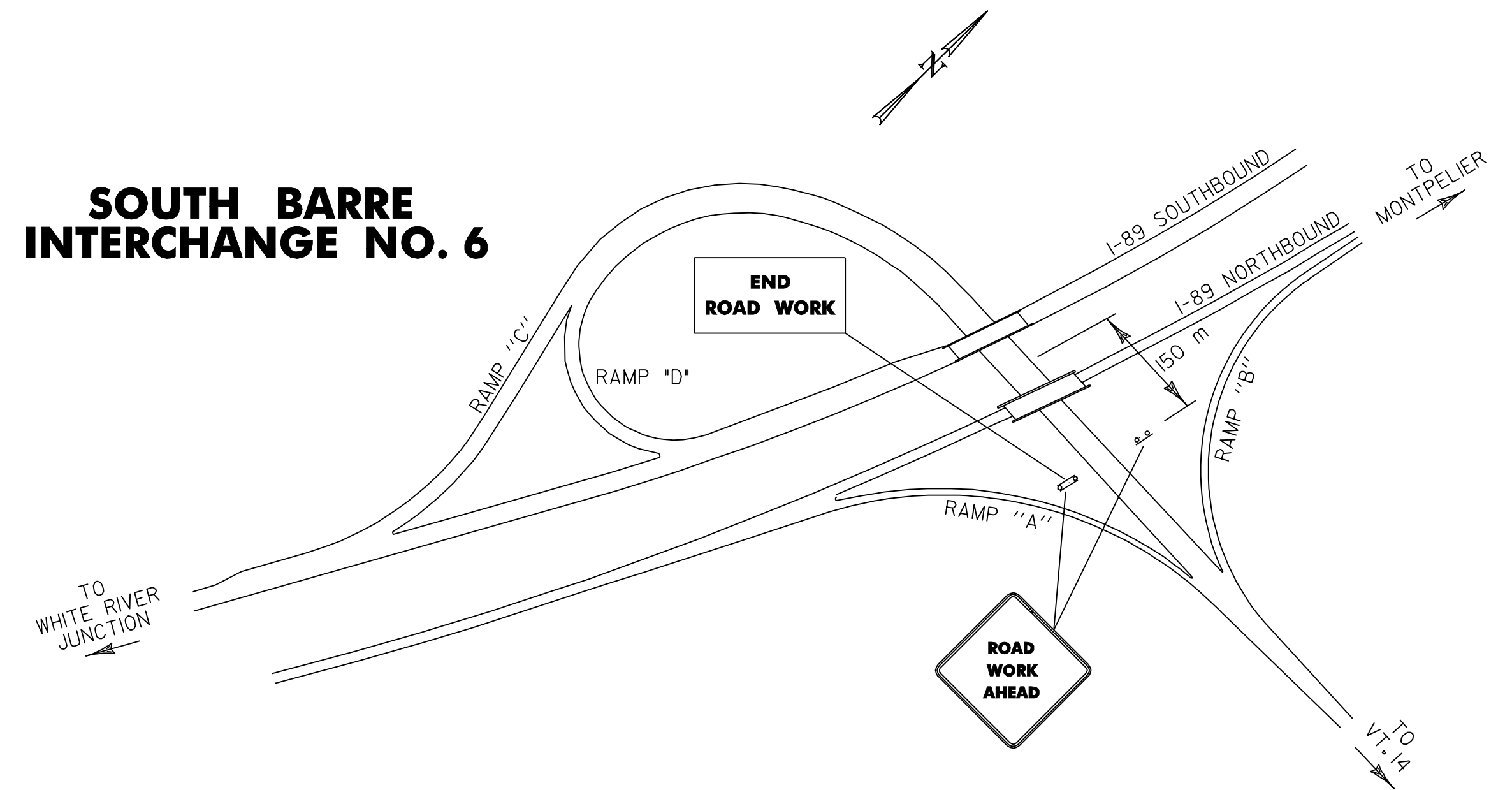

N.T.S.

**CONSTRUCTION  
APPROACH  
SIGNING  
SHEET #2**

PROJECT NAME: WILLIAMSTOWN-MONTPELIER  
PROJECT NUMBER: IM SURF (2)

FILE NAME: /pave/05a388/p05a388.dgn  
PROJECT LEADER: M WOOLAVER  
DESIGNED BY: KAS  
p05a388tc2.1

PLOT DATE: 24-OCT-2007 13:3  
DRAWN BY: KAS  
CHECKED BY: KML  
SHEET 7 OF 7