

RAMP TYPICAL - SEE NEXT SHEET

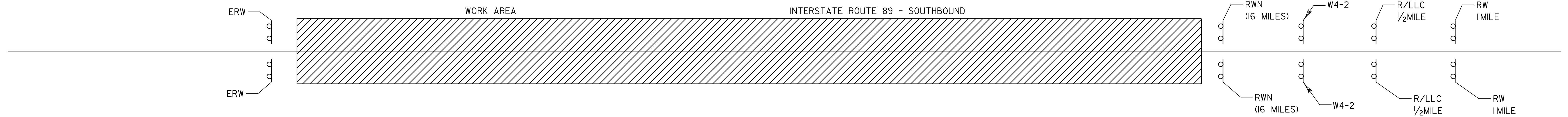

NOTE:

THE CONTRACTOR SHALL INCLUDE A CONSTRUCTION SIGN APPROACH PACKAGE FOR EXPECTED LANE CLOSURES AND WORKZONE SPEED REDUCTIONS IN COMPLIANCE WITH STD. E-103. PAYMENT FOR THIS PACKAGE SHALL BE INCIDENTAL TO ITEM 641.10, "TRAFFIC CONTROL".

LEGEND

- RW 1MILE = ROAD WORK 1MILE
- R/LLC 1/2MILE = RIGHT LANE CLOSED 1/2MILE/OR LEFT LANE
- RWN = ROAD WORK NEXT (X MILES)
- ERW = END ROAD WORK
- SRWA = SIDE ROAD WORK AHEAD
- SRW 500 = SIDE ROAD WORK 500 FT
- ////// = WORK AREA

SEE STD E-100 AND E-103 FOR SIGN PLACEMENT.

NOT TO SCALE

**CONSTRUCTION
APPROACH
SIGNING
SHEET #1**

PROJECT NAME:	WILLIAMSTOWN-MONTPELIER
PROJECT NUMBER:	1M SURF (2)
FILE NAME:	/pave/05a388/p05a388.dgn
PROJECT LEADER:	M. WOOLAVER
DESIGNED BY:	KAS
p05a388+cl1	
PLOT DATE:	24-OCT-2007 13:3
DRAWN BY:	KAS
CHECKED BY:	KML
SHEET	6 OF 7