

CONCRETE MEDIAN BARRIER (MOD - CAST IN PLACE)
1007+00 - 1013+00 CL

REMOVAL AND DISPOSAL OF GUARDRAIL (MOD - CONCRETE MEDIAN BARRIER)
1007+00 - 1013+00 CL

LANDSCAPING BED
1007+00 - 1010+14 RT
1012+00 - 1013+00 RT

REMOVE EXISTING DROP INLET
1008+05 LT
1011+53 LT

CHAIN-LINK FENCE (6')
156.0' 1007+00, 123.0' RT - 1009+00, 138.0' RT 1012+65 92.0' +/-
1007+00, 47.0' LT - 1010+37, 53.5' LT - 1011+00, 117.4' LT
1009+00 53.0'

REHABING DI, CB, OR MH CLASS I
1008+05, 53' RT
1011+53, 53' RT

I-89 CURVE #9 DATA
DELTA= 23° 11' 27" LT
D = 2° 25' 22"
R = 2365.00 FT.
T = 485.26 FT.
L = 957.24 FT.
E = 49.27 FT.

RELAYING PIPE CULVERTS (MOD. - LINING CULVERT, 24")
1008+05 RT & LT
1011+53 RT & LT

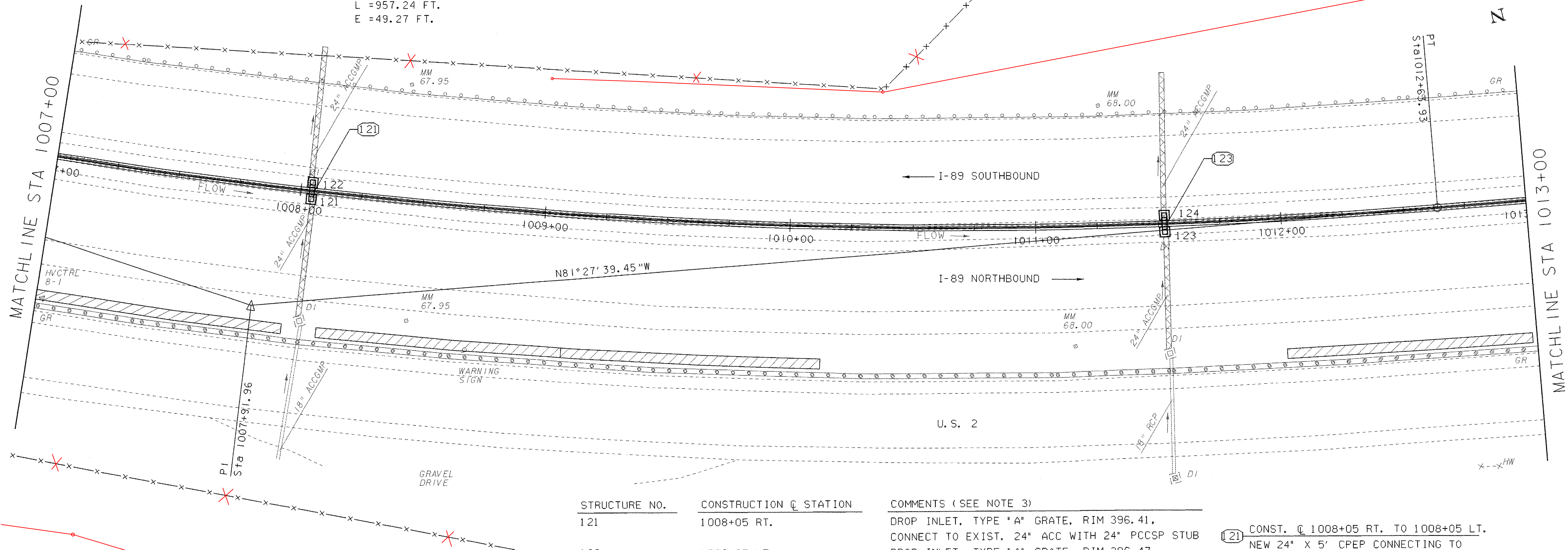

STRUCTURE NO.	CONSTRUCTION C STATION	COMMENTS (SEE NOTE 3)
121	1008+05 RT.	DROP INLET, TYPE "A" GRATE, RIM 396.41, CONNECT TO EXIST. 24" ACC WITH 24" PCCSP STUB
122	1008+05 LT.	DROP INLET, TYPE "A" GRATE, RIM 396.47, CONNECT TO EXIST. 24" ACC WITH 24" PCCSP STUB
123	1011+53 RT.	CONNECT TO EXIST. 6" UNDERDRAIN
124	1011+53 LT.	DROP INLET, TYPE "A" GRATE, RIM 394.84, CONNECT TO EXIST. 24" RCP WITH 24" RCP STUB
		DROP INLET, TYPE "A" GRATE, RIM 395.28
		CONNECT TO EXIST. 24" ACC WITH 24" PCCSP STUB
		CONNECT TO EXIST. 6" UNDERDRAIN

- (121) CONST. C 1008+05 RT. TO 1008+05 LT.
NEW 24" X 5' CPEP CONNECTING TO NEW DI'S AT 1008+05 RT, LT.
- (123) CONST. C 1011+53 RT. TO 1011+53 LT.
NEW 24" X 5' CPEP CONNECTING TO NEW DI'S AT 1011+53 RT, LT.

NOTES

1. ALL EXISTING STORM DRAINAGE PIPES AND STRUCTURES ARE SHOWN BASED ON PREVIOUS DESIGN PLANS. NO AS-BUILT INFORMATION WAS AVAILABLE, AND NO SURVEY WAS POSSIBLE DUE TO THEIR LOCATIONS UNDER THE EXISTING CONCRETE MEDIAN BARRIER.
2. FOR DETAILS OF LANDSCAPING BEDS, PLANT LISTS AND PLANTING DETAILS, SEE LANDSCAPING DETAIL SHEETS. BEDS ARE DESIGNED AS A 100' TYPICAL PATTERN WHICH WILL BE REPEATED FOR LONGER BEDS.
3. TYPE OF STUB REQUIRED TO CONNECT TO EXISTING STORM DRAIN PIPE IS ASSUMED FOR ALL LOCATIONS. THERE MAY BE LOCATIONS WHERE A STUB IS NOT REQUIRED, STUBS WILL BE USED AS DIRECTED BY THE ENGINEER.
4. FOR DETAILS OF UNDERDRAIN CONNECTION AND CLEAN OUT SEE MISC. DRAINAGE DETAILS 2.
5. ALL REHABING OF DI, CB, OR MH CLASS I ARE LOCATED BETWEEN I-89 NORTHBOUND AND U.S. 2.

LEGEND

- CULVERT LINING
- LANDSCAPING BED
- CONCRETE MEDIAN BARRIER
- DROP INLET
- CATCH BASIN

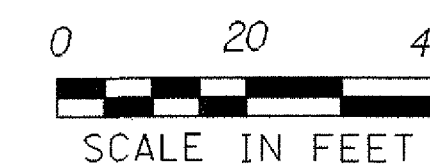

STA 1007+00 - STA 1013+00

PROJECT NAME: WATERBURY - BOLTON
PROJECT NUMBER: IM 089 - 2(37)

FILE NAME: d05a110bdr.dgn
PROJECT LEADER: A.J. BOMBARDIER
DESIGNED BY: J. L. SCHULTZ
LAYOUT SHEET 10

PLOT DATE: 29-MAR-2006
DRAWN BY: J. L. SCHULTZ
CHECKED BY:
SHEET 27 OF 80