

CONCRETE MEDIAN BARRIER (MOD - CAST IN PLACE)  
1001+00 - 1007+00 CL

REMOVAL AND DISPOSAL OF GUARDRAIL (MOD - CONCRETE MEDIAN BARRIER)  
1001+00 - 1007+00 CL

CHAIN-LINK FENCE (6')  
1005+44, ~~124.0'~~ RT - 1007+00, ~~123.0'~~ RT  
137.0' 156.0'

REMOVE EXISTING DROP INLET  
1003+59 LT

LANDSCAPING BED  
1001+00 - 1007+00 RT

REHABING DI, CB, OR MH CLASS I  
1002+12, 52' RT

RELAYING PIPE CULVERTS (MOD. - LINING CULVERT, 18")  
1002+17 RT - LT  
1003+59 RT & LT

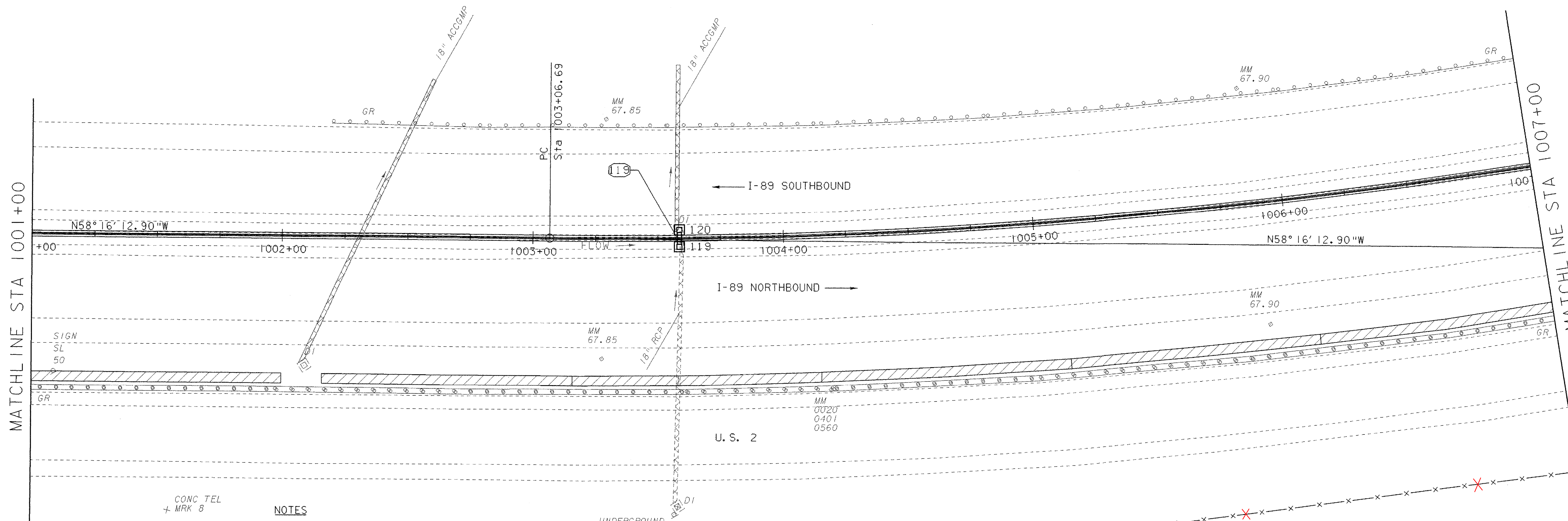
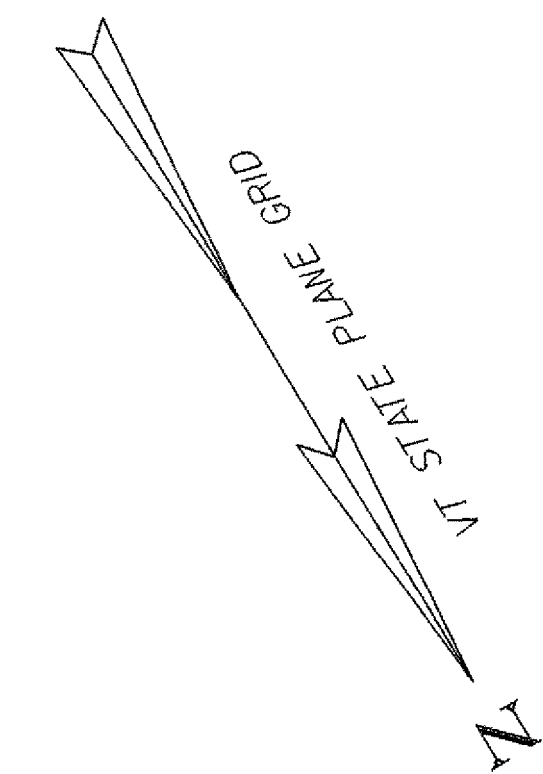

CONC TEL  
+ MRK 8

NOTES

1. ALL EXISTING STORM DRAINAGE PIPES AND STRUCTURES ARE SHOWN BASED ON PREVIOUS DESIGN PLANS. NO AS-BUILT INFORMATION WAS AVAILABLE, AND NO SURVEY WAS POSSIBLE DUE TO THEIR LOCATIONS UNDER THE EXISTING CONCRETE MEDIAN BARRIER.
2. FOR DETAILS OF LANDSCAPING BEDS, PLANT LISTS AND PLANTING DETAILS, SEE LANDSCAPING DETAIL SHEETS. BEDS ARE DESIGNED AS A 100' TYPICAL PATTERN WHICH WILL BE REPEATED FOR LONGER BEDS.
3. TYPE OF STUB REQUIRED TO CONNECT TO EXISTING STORM DRAIN PIPE IS ASSUMED FOR ALL LOCATIONS. THERE MAY BE LOCATIONS WHERE A STUB IS NOT REQUIRED. STUBS WILL BE USED AS DIRECTED BY THE ENGINEER.
4. FOR DETAILS OF UNDERDRAIN CONNECTION AND CLEAN OUT SEE MISC. DRAINAGE DETAILS 2.
5. ALL REHABING OF DI, CB, OR MH CLASS I ARE LOCATED BETWEEN I-89 NORTHBOUND AND U.S. 2.

STRUCTURE NO.	CONSTRUCTION @ STATION	COMMENTS (SEE NOTE 3)
119	1003+59 RT.	DROP INLET, TYPE "A" GRATE, RIM 398.88, CONNECT TO EXIST. 18" ACC WITH 18" PCCSP STUB
120	1003+59 LT.	DROP INLET, TYPE "A" GRATE, RIM 398.43, CONNECT TO EXIST. 18" ACC WITH 18" PCCSP STUB
		CONNECT TO EXIST. 6" UNDERDRAIN

CONST. @ 1003+59 RT. TO 1003+59 LT.  
NEW 18" X 5' CPEP CONNECTING TO  
NEW DI'S AT 1003+59 RT, LT.

LEGEND

CULVERT LINING	
LANDSCAPING BED	
CONCRETE MEDIAN BARRIER	
DROP INLET	
CATCH BASIN	

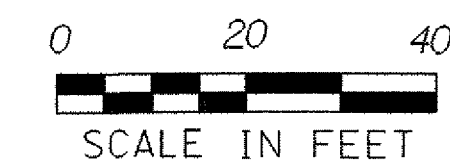

STA 1001+00 - STA 1007+00

PROJECT NAME: WATERBURY - BOLTON	PLOT DATE: 29-MAR-2006
PROJECT NUMBER: IM 089 - 2(37)	DRAWN BY: J. L. SCHULTZ
FILE NAME: d05a110bdr.dgn	CHECKED BY:
PROJECT LEADER: A.J. BOMBARDIER	SHEET 25 OF 80
DESIGNED BY: J. L. SCHULTZ	
<b>LAYOUT SHEET 9</b>	