

CONCRETE MEDIAN BARRIER (MOD - CAST IN PLACE)
995+00 - 1001+00 CL

REMOVAL AND DISPOSAL OF GUARDRAIL (MOD - CONCRETE MEDIAN BARRIER)
995+00 - 1001+00 CL

REMOVE EXISTING DROP INLET
999+11 LT

LANDSCAPING BED
995+00 - 996+00 RT
997+00 - 998+00 RT

RELAYING PIPE CULVERTS (MOD. - LINING CULVERT, 18")
999+12 RT

REHABING DI, CB, OR MH CLASS I
999+38, 53' RT - STRUCTURE IN GOOD CONDITION, NOT REHABED

RELAYING PIPE CULVERTS (MOD. - LINING CULVERT, 24")
999+11 LT

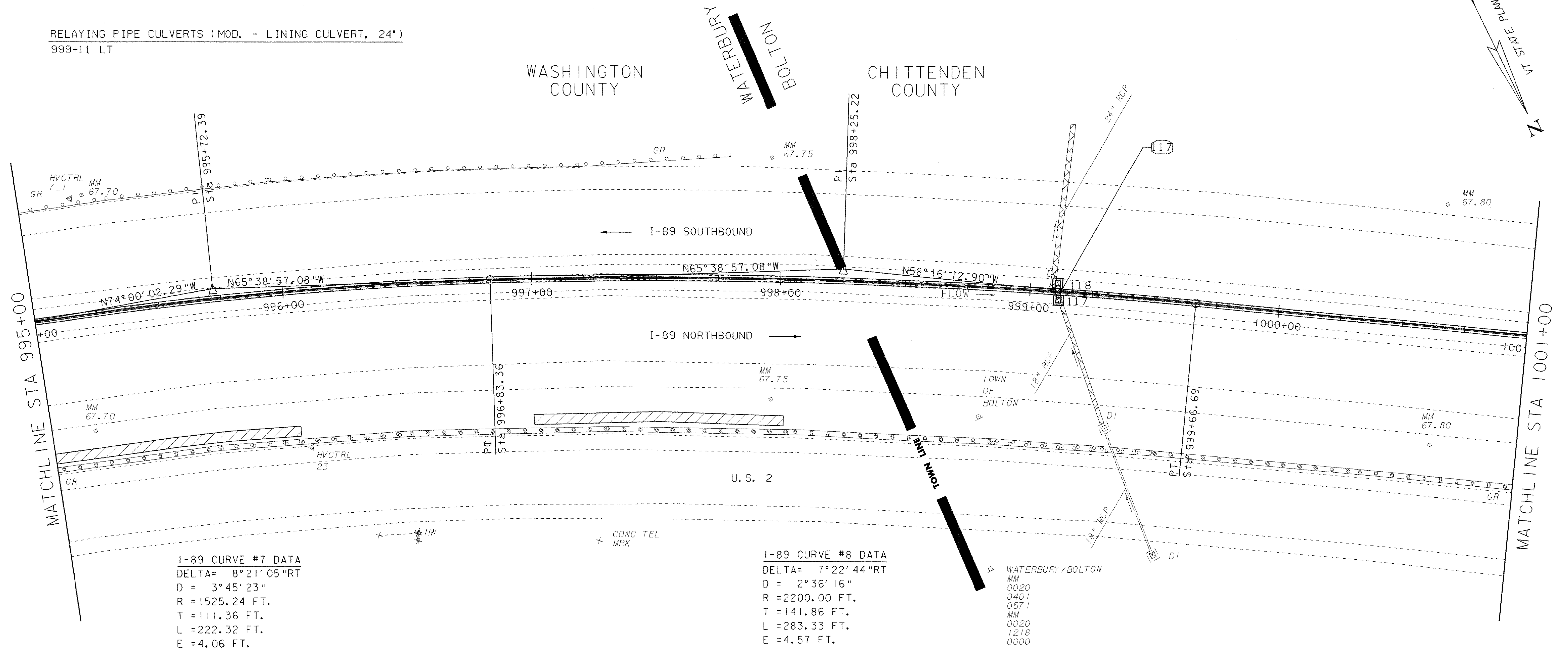

I-89 CURVE #7 DATA
DELTA= 8°21'05"RT
D = 3°45'23"
R = 1525.24 FT.
T = 111.36 FT.
L = 222.32 FT.
E = 4.06 FT.

I-89 CURVE #8 DATA
DELTA= 7°22'44"RT
D = 2°36'16"
R = 2200.00 FT.
T = 141.86 FT.
L = 283.33 FT.
E = 4.57 FT.

WATERBURY/BOLTON
MM
0020
0401
0571
MM
0020
1218
0000

STRUCTURE NO.	CONSTRUCTION @ STATION	COMMENTS (SEE NOTE 3)
117	999+12 RT.	DROP INLET, TYPE "A" GRATE, RIM 403.34, CONNECT TO EXIST. 18" RCP WITH 18" RCP STUB
118	999+11 LT.	DROP INLET, TYPE "A" GRATE, RIM 403.42, CONNECT TO EXIST. 24" RCP WITH 24" RCP STUB CONNECT TO EXIST. 6" UNDERDRAIN

117 CONST. @ 999+12 RT. TO 999+11 LT.
NEW 24" X 5' CPEP CONNECTING TO
NEW DI'S AT 999+12 RT, 999+11 LT.

NOTES

- ALL EXISTING STORM DRAINAGE PIPES AND STRUCTURES ARE SHOWN BASED ON PREVIOUS DESIGN PLANS. NO AS-BUILT INFORMATION WAS AVAILABLE, AND NO SURVEY WAS POSSIBLE DUE TO THEIR LOCATIONS UNDER THE EXISTING CONCRETE MEDIAN BARRIER.
- FOR DETAILS OF LANDSCAPING BEDS, PLANT LISTS AND PLANTING DETAILS, SEE LANDSCAPING DETAIL SHEETS. BEDS ARE DESIGNED AS A 100' TYPICAL PATTERN WHICH WILL BE REPEATED FOR LONGER BEDS.
- TYPE OF STUB REQUIRED TO CONNECT TO EXISTING STORM DRAIN PIPE IS ASSUMED FOR ALL LOCATIONS. THERE MAY BE LOCATIONS WHERE A STUB IS NOT REQUIRED. STUBS WILL BE USED AS DIRECTED BY THE ENGINEER.
- FOR DETAILS OF UNDERDRAIN CONNECTION AND CLEAN OUT SEE MISC. DRAINAGE DETAILS 2.
- ALL REHABING OF DI, CB, OR MH CLASS I ARE LOCATED BETWEEN I-89 NORTHBOUND AND U.S. 2.

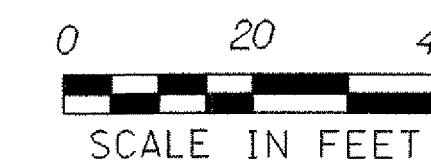

LEGEND

CULVERT LINING	
LANDSCAPING BED	
CONCRETE MEDIAN BARRIER	
DROP INLET	
CATCH BASIN	

STA 995+00 - STA 1001+00

PROJECT NAME: WATERBURY - BOLTON
PROJECT NUMBER: IM 089 - 2(37)

FILE NAME: d05a110bdr.dgn
PROJECT LEADER: A.J. BOMBARDIER
DESIGNED BY: J. L. SCHULTZ
LAYOUT SHEET 8

PLOT DATE: 29-MAR-2006
DRAWN BY: J. L. SCHULTZ
CHECKED BY:
SHEET 23 OF 80