

SEE ITEM DETAIL SHEETS AND RAMP LAYOUTS FOR LOCATIONS OF GUARDRAIL

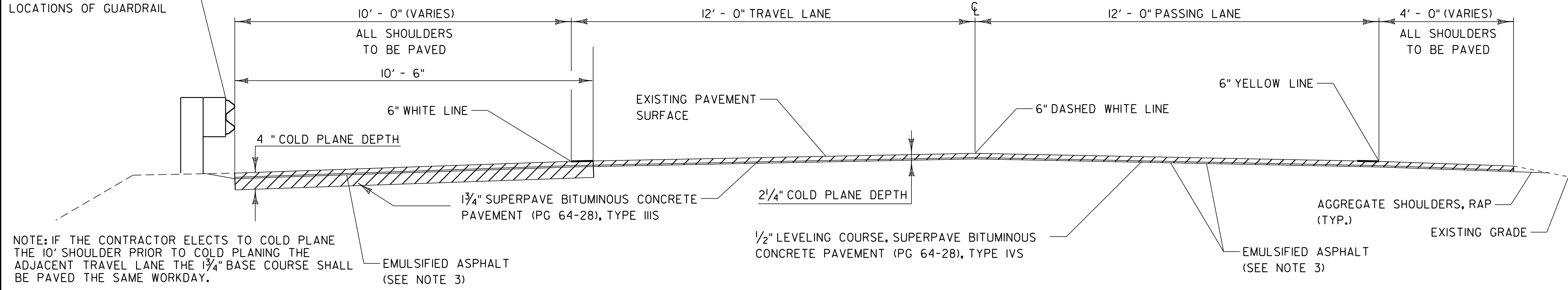

NOTE: IF THE CONTRACTOR ELECTS TO COLD PLANE THE 10' SHOULDER PRIOR TO COLD PLANING THE ADJACENT TRAVEL LANE THE 1 3/4" BASE COURSE SHALL BE PAVED THE SAME WORKDAY.
IF THE CONTRACTOR CHOOSES TO COLD PLANE THE 4" ON THE 10' SHOULDER IN TWO PASSES, PAYMENT FOR COLD PLANING WILL ONLY BE MADE FOR THE FIRST PASS.

FINAL GRADING OF THE EXPOSED SHOULDER SUBBASE MATERIAL SHALL BE COMPLETED AS DIRECTED BY THE RESIDENT ENGINEER. AN ESTIMATED QUANTITY OF 608.15 POWER GRADER RENTAL HAS BEEN INCLUDED TO COMPLETE THIS GRADING.

(SOUTHBOUND BARREL SHOWN; MIRROR IMAGE FOR NORTHBOUND BARREL)
DURING THE CONSTRUCTION OF SO. BURLINGTON AC IM CULV(9) BETWEEN MM 87.35 AND MM 88.30 NB AND SB THE TRAVEL AND PASSING LANES WERE SHIMMED WITH 1" - 1 1/2" OF PAVEMENT. THE 10 FT SHOULDERS WERE SHIMMED WITH 1" - 1 1/2" OF PAVEMENT AT THE EDGE LINE TO 6" - 8" OF PAVEMENT AT THE OUTSIDE EDGE OF SHOULDER. THE CONTRACTOR SHALL ADJUST THE DEPTH OF COLD PLANING ACCORDINGLY TO ACHIEVE THE ORIGINAL FINISHED GRADE. NO EXTRA PAYMENT WILL BE GIVEN FOR THIS WORK. IT WILL BE CONSIDERED INCIDENTAL TO ITEM 210.10 COLD PLANING BITUMINOUS PAVEMENT.

MAINLINE TYPICAL SECTION

SEE ITEM DETAIL SHEETS AND RAMP LAYOUTS FOR LOCATIONS OF GUARDRAIL

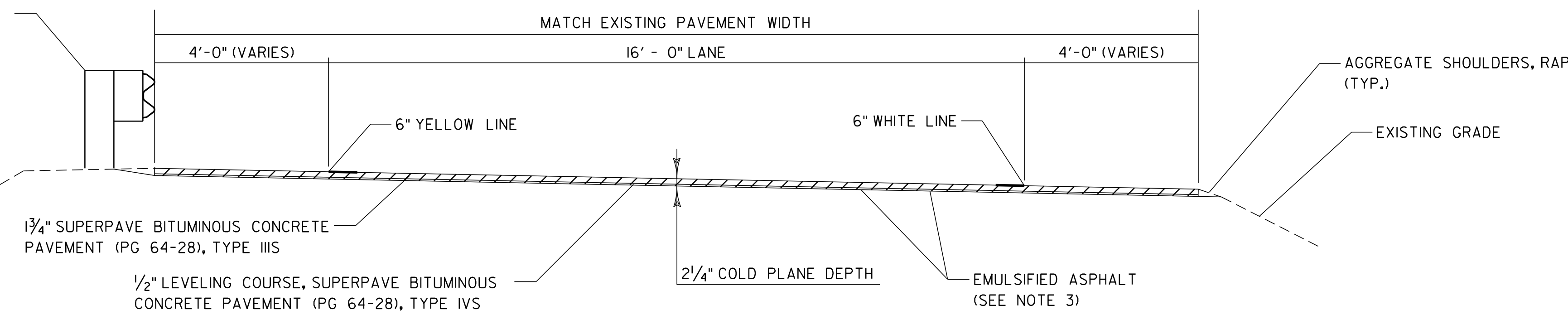

RAMP TYPICAL SECTION

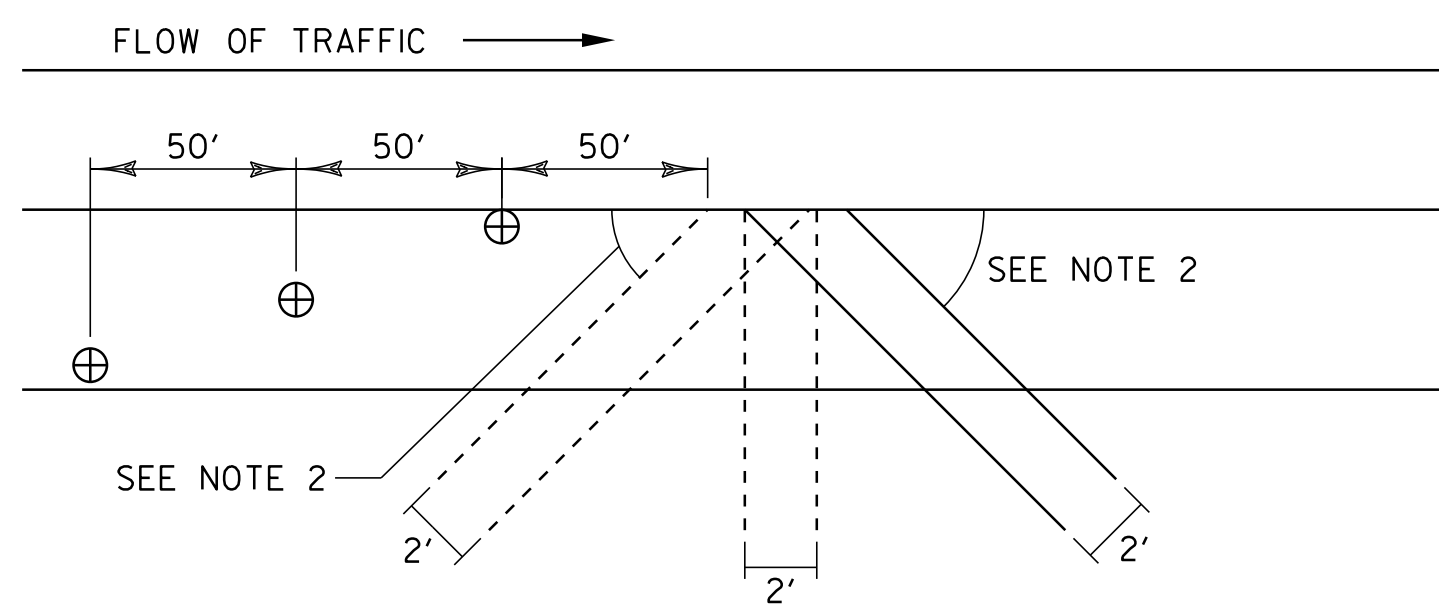
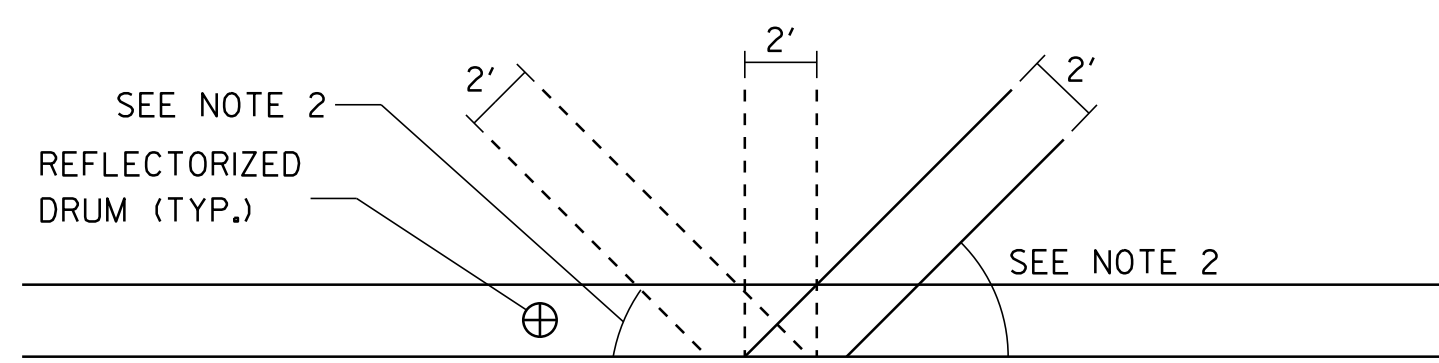

BLEEDER DETAIL

BLEEDER DETAIL NOTES:

- BLEEDERS ARE TO BE CUT WHILE COLD PLANING, AT LOCATIONS SPECIFIED BY THE RESIDENT ENGINEER.
- ANGLE BLEEDERS TO BEST ACCEPT WATER FLOW.
- CUT ALL BLEEDERS TO THE DEPTH OF COLD PLANING AND GRADE TO DRAIN. PAYMENT INCIDENTAL TO ITEM 210.10, "COLD PLANING BITUMINOUS PAVEMENT".
- BLEEDERS ARE TO BE FILLED DURING PAVING WITH ITEM 490.30, "SUPERPAVE BITUMINOUS CONCRETE PAVEMENT (PG 64-28)," OR AS DESIGNATED BY THE RESIDENT ENGINEER.
- REFLECTORIZED DRUMS MUST BE PLACED AS SHOWN TO WARN MOTORISTS OF THE GAP IN THE SHOULDER.
- BLEEDERS ARE NOT REQUIRED IF THE COLD PLANED AREAS ARE PAVED BACK THE SAME DAY.

SEEDING FORMULA RURAL AREAS

% WT.	LBS./A.	NAME	PUR %	GERM %
37.5	22.5	CREEPING RED FESCUE	98	85
37.5	22.5	TALL FESCUE	95	90
5.0	3.0	RED TOP	95	90
15.0	9.0	BIRDSFOOT TREFOIL	98	85
5.0	3.0	ANNUAL RYEGRASS	95	85
100.0	60.0			

GENERAL NOTES

- SEED MIXTURE: SHALL NOT HAVE A WEED CONTENT EXCEEDING 0.40% BY WEIGHT AND SHALL BE FREE OF ALL NOXIOUS SEED.
- SEED: TO BE APPLIED PER SEEDING FORMULAS OR AS DIRECTED BY THE ENGINEER.
- FERTILIZER: FORMULA 10-20-10, TO BE USED WITH SEED, APPLIED AT THE RATE OF 500 LBS./ACRE. (HYDRO SEEDERS MAY USE 19-19-19 FORMULA).
- AGRICULTURAL LIMESTONE: TO BE APPLIED AT THE RATE OF 2 TONS/ACRE, OR AS DIRECTED BY THE ENGINEER.
- HAY MULCH: TO BE PLACED ON EARTH SLOPES AT THE RATE OF 2 TONS/ACRE, OR AS DIRECTED BY THE ENGINEER.
- TOPSOIL: TO BE USED WITH SEED AS INDICATED ON THE PLANS, OR AS DIRECTED BY THE ENGINEER.

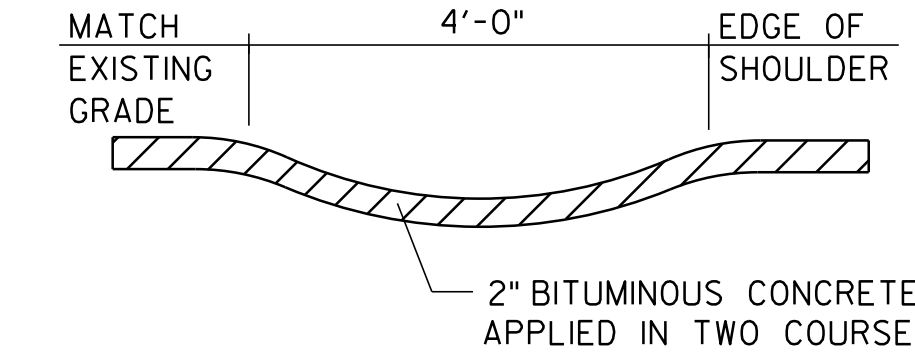

BITUMINOUS CONCRETE GUTTER DETAIL (ITEM 616.47)

BITUMINOUS CONCRETE GUTTER LOCATIONS

NORTHBOUND STA. 4620+23 RT	EXIT 13 STA. 9+82 LT RAMP D	EXIT 14 STA. 9+15 RT RAMP B	EXIT 14 STA. 9+26 RT RAMP E
NORTHBOUND STA. 4681+80 RT	EXIT 14 STA. 1+55 - 10+00 RT RAMP A	EXIT 14 STA. 3+49 RT RAMP D	EXIT 14 STA. 1+63 RT RAMP F
NORTHBOUND STA. 4775+81 RT	EXIT 14 STA. 1+55 RT RAMP A	EXIT 14 STA. 5+16 RT RAMP D	EXIT 14 STA. 3+15 RT RAMP F
NORTHBOUND STA. 4783+23 RT	EXIT 14 STA. 5+25 RT RAMP A	EXIT 14 STA. 6+91 RT RAMP D	EXIT 14 STA. 4+63 RT RAMP F
NORTHBOUND STA. 4799+09 RT	EXIT 14 STA. 6+25 RT RAMP A	EXIT 14 STA. 8+59 RT RAMP D	EXIT 14 STA. 9+50 RT RAMP G
EXIT 13 STA. 1+00 RT RAMP C	EXIT 14 STA. 12+50 RT RAMP A	EXIT 14 STA. 5+16 - 10+00 RT RAMP D	EXIT 14 STA. 2+75 RT RAMP G
EXIT 13 STA. 2+46 RT RAMP C	EXIT 14 STA. 2+76 RT RAMP B	EXIT 14 STA. 1+50 RT RAMP E	EXIT 14 STA. 3+75 - 7+50 LT RAMP G
EXIT 13 STA. 4+54 RT RAMP C	EXIT 14 STA. 4+42 RT RAMP B	EXIT 14 STA. 2+89 RT RAMP E	EXIT 14 STA. 8+25 RT RAMP G
EXIT 13 STA. 7+24 RT RAMP C	EXIT 14 STA. 6+01 RT RAMP B	EXIT 14 STA. 4+51 RT RAMP E	EXIT 14 STA. 9+40 RT RAMP G
EXIT 13 STA. 4+22 LT RAMP D	EXIT 14 STA. 7+57 RT RAMP B	EXIT 14 STA. 6+08 RT RAMP E	EXIT 15 STA. 3+50 - STA. 4+50 LT RAMP B
EXIT 13 STA. 7+19 LT RAMP D	EXIT 14 STA. 4+42 - 6+68 LT RAMP B	EXIT 14 STA. 7+66 RT RAMP E	EXIT 16 STA. 12+70 LT RAMP A

NOTES:

- COLD PLANING TO BE COMPLETED ACCORDING TO THE TYPICAL SECTION OR AS NOTED OTHERWISE ON THE PLANS. A FULL DEPTH BUTT JOINT SHALL BE CONSTRUCTED AT THE PROJECT BEGINNING/END AND AT ALL RAMP APPROACHES AS DENOTED ON THE PROJECT PLANS OR AS OTHERWISE DIRECTED BY THE RESIDENT ENGINEER.
- THE CONTRACTOR SHALL USE CAUTION WHEN COLD PLANING AND PAVING OPERATIONS OCCUR ADJACENT TO EXISTING DROP INLETS, CATCH BASINS OR SCUPPERS. ANY DAMAGE WHICH OCCURS TO THESE DRAINAGE STRUCTURES OR CLEANING OF DEBRIS REQUIRED AS A RESULT OF THESE OPERATIONS SHALL BE THE RESPONSIBILITY OF THE CONTRACTOR AND SHALL BE REPAIRED OR CLEANED BY THE CONTRACTOR AT THE CONTRACTORS EXPENSE IN ACCORDANCE WITH SUBSECTION 104.07.
- EMULSIFIED ASPHALT SHALL BE APPLIED ON ALL EXISTING PAVEMENT SURFACES, ON ALL COLD PLANED SURFACES AND BETWEEN ALL COURSES OF PAVEMENT AT A RATE OF 0.025 GAL / SY OR AS DIRECTED BY THE RESIDENT ENGINEER.
- SUPERPAVE BITUMINOUS CONCRETE PAVEMENT TOLERANCE = +/- 1/4 INCH (TOTAL PAVEMENT THICKNESS EXCLUDING LEVELING).
- ALL EDGES OF PAVEMENT SHALL BE BACKED UP FULL HEIGHT WITH COLD PLANE GRINDINGS AS DIRECTED BY THE RESIDENT ENGINEER AND WILL BE PAID FOR UNDER ITEM 402.13, "AGGREGATE SHOULDERS, RAP".
- ITEMS 604.40, "CHANGING ELEVATION OF DROP INLETS, CATCH BASINS, OR MANHOLES" AND ITEM 604.42, "REHAB. DROP INLETS, CATCH BASINS, OR MANHOLES, CLASS 1", ARE ESTIMATED QUANTITIES AND SHALL BE PERFORMED AT LOCATIONS INDICATED ON THE LAYOUT SHEETS AND AS DIRECTED BY THE RESIDENT ENGINEER. ALL DROP INLETS AND CATCH BASINS SHALL BE RAISED OR REHABILITATED SUCH THAT THE NEW GRATE ELEVATION IS LEVEL WITH THE SURROUNDING TERRAIN.
- ITEM 616.35 "TREATED TIMBER CURB" AND ITEM 616.41 "REMOVAL OF EXISTING CURB" HAVE BEEN INCLUDED TO REMOVE AND REPLACE EXISTING CURBING AS CALLED FOR IN THE PLANS OR AS DIRECTED BY THE RESIDENT ENGINEER.
- ESTIMATED QUANTITIES OF ITEM 608.25, "ALL PURPOSE EXCAVATOR RENTAL, TYPE 1", 608.37, "TRUCK RENTAL", AND 608.40, "LOADER RENTAL, TYPE 1" HAVE BEEN INCLUDED FOR THE PROVISION OF CONSTRUCTING GUARDRAIL END SECTIONS WITH DITCHING MATERIAL. IF SUFFICIENT DITCHING MATERIAL IS NOT AVAILABLE, ITEM 203.30, "EARTH BORROW" SHALL BE USED. AN ESTIMATED QUANTITY FOR EARTH BORROW IS INCLUDED IN THE QUANTITIES FOR THIS PURPOSE. THE GUARDRAIL END SECTIONS SHALL BE CAPPED WITH AN ESTIMATED 3-INCH DEPTH OF "AGGREGATE SHOULDERS, RAP" UNLESS OTHERWISE DIRECTED BY THE RESIDENT ENGINEER. THE QUANTITIES INCLUDED REFLECT 5 TONS OF ITEM 402.13, "AGGREGATE SHOULDERS, RAP" FOR EACH GUARDRAIL TERMINAL.
- BITUMINOUS CONCRETE PAVEMENT WORK WHICH COULD INVOLVE SOME HAND-WORK (SUCH AS DRIVEWAYS AND AROUND DROP INLETS, ETC.) SHALL BE PAID FOR AT THE CONTRACT UNIT PRICE FOR ITEM 616.47, "BITUMINOUS CONCRETE GUTTERS AND TRAFFIC ISLANDS".
- AREAS ADJACENT TO THE SHOULDER, WHERE EXISTING GUARDRAIL IS BEING RETAINED, THAT HAVE BUILT UP EXCESS MATERIAL ARE TO BE GRADED IN ORDER TO ALLOW THE SHOULDER TO DRAIN. PAYMENT IS TO BE INCLUDED UNDER ITEM 203.40, "SHOULDER BERM REMOVAL". THE PLAN QUANTITY REPRESENTS BERM REMOVAL FOR 80% OF THE RETAINED GUARDRAIL LENGTH.
- ALL DELINEATORS WITHIN THE PROJECT AREA ARE TO BE REPLACED. THESE ARE TO BE PAID FOR UNDER ITEM 676.10, "DELINEATOR WITH STEEL POST". REMOVAL OF EXISTING DELINEATORS IS TO BE PAID FOR UNDER ITEM 676.12, "REMOVAL OF EXISTING DELINEATOR".
- QUANTITIES HAVE BEEN INCLUDED FOR REMOVAL OF THE EXISTING AND PLACEMENT OF NEW SIDEWALK AT THE LOCATIONS OF THE DETECTABLE WARNING SURFACES. THIS WORK IS TO BE PAID FOR UNDER ITEMS 203.16, "SOLID ROCK EXCAVATION" AND 618.10, "PORTLAND CEMENT CONCRETE SIDEWALK, 5 INCH". QUANTITIES INCLUDE REPLACEMENT OF 5' OF THE EXISTING SIDEWALK AT LOCATIONS INDICATED ON THE INTERCHANGE LAYOUT SHEETS.
- ITEM 601.0915, "18" CPEP", HAS BEEN INCLUDED TO BE USED IN CONJUNCTION WITH STANDARD DRAWING B-17 TO FACILITATE DRAINAGE UNDER THE PROPOSED U-TURNS.
- YIELDING MARKER POSTS ARE TO BE PLACED AS INDICATED OR AS DIRECTED BY THE ENGINEER.

PROJECT TYPICAL SHEET

PROJECT NAME:	SO. BURLINGTON - COLCHESTER	
PROJECT NUMBER:	IM 089-3(60)	
FILE NAME:	p05a012.dgn	PLOT DATE: \$\$\$\$\$\$DATE\$\$\$\$
PROJECT LEADER:	EPD	DRAWN BY: JAR/SJB
DESIGNED BY:	JDA	CHECKED BY: EPD
PLOT FILE:	p05a012typ.i	SHEET 8 OF 91

DETAILS ARE NOT TO SCALE