

**INSET DETAIL**  
NOT TO SCALE

**TRAFFIC CONTROL PLAN FOR I-89 EXIT 12 RAMP C**

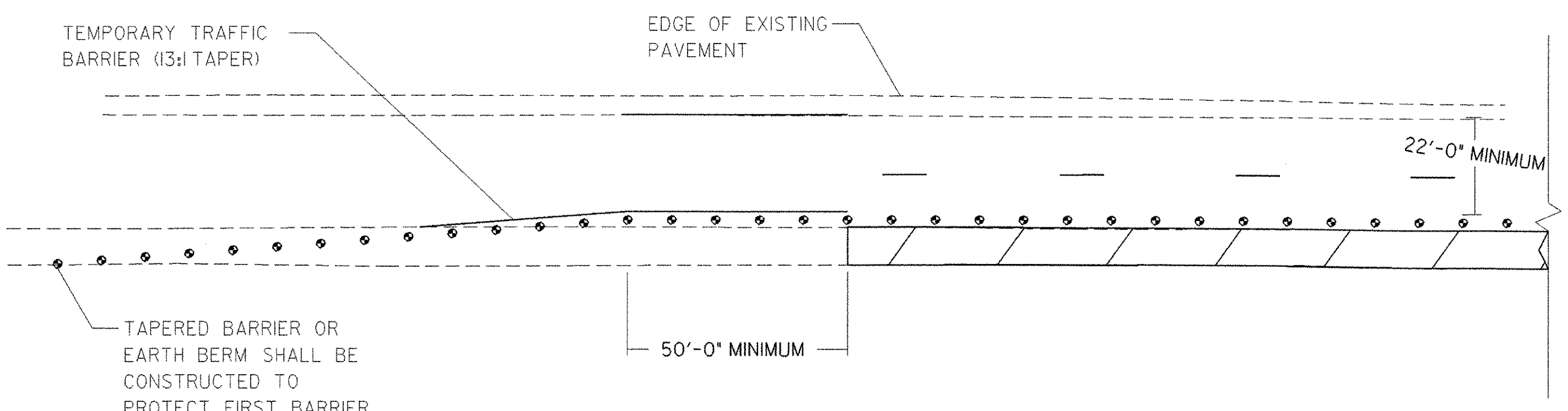

**BEGINNING OF DECELERATION LANE**

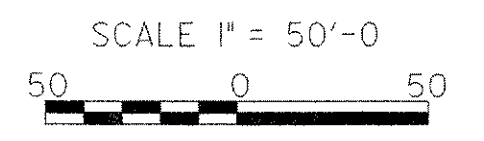
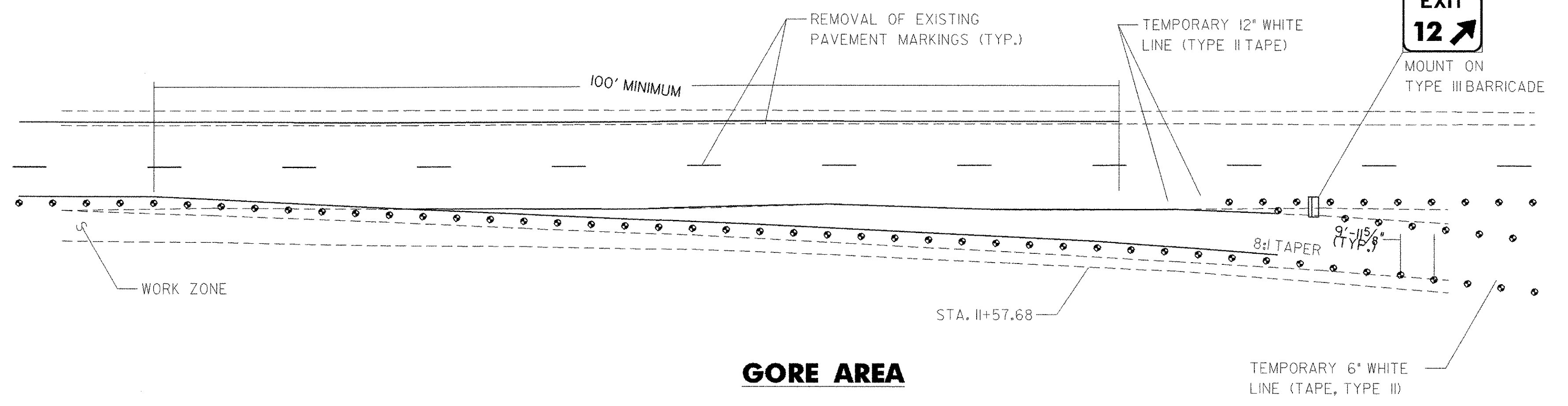
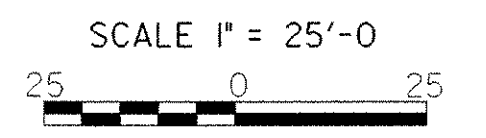

**GORE AREA**

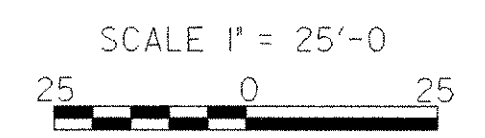

- LEGEND**
- EDGE OF PAVEMENT
  - REFLECTIVE PLASTIC DRUMS
  - PAVEMENT MARKING REMOVAL
  - TRAFFIC FLOW
  - ▨ CONSTRUCTION AREA
  - ▬ TEMPORARY TRAFFIC BARRIER

- NOTES**
1. EXIT SIGN SHALL BE MOUNTED A MINIMUM OF THREE-FOOT ABOVE THE GROUND AND HIGH ENOUGH TO BE SEEN ABOVE CHANNELIZING DEVICES.
  2. ALL DISTANCES ARE DESIRABLE MINIMUMS. FIELD CONDITIONS SHALL CONTROL THE ACTUAL PLACEMENT.
  3. SEE VTRANS STANDARDS E-103 AND E-106 FOR ADDITIONAL TRAFFIC CONTROL DETAILS, INCLUDING BARREL PLACEMENT AND TAPER LENGTHS.
  4. SEE I-89 MAINLINE PLANS FOR MAINLINE TRAFFIC CONTROL PLANS AND DETAILS.
  5. REFLECTIVE PLASTIC DRUMS ARE TO BE PAID FOR INCIDENTAL TO ITEM 64110, "TRAFFIC CONTROL".
  6. REMOVAL OF EXISTING AND PLACEMENT OF NEW TEMPORARY ARROW PAVEMENT MARKINGS MAY BE NECESSARY, AS DETERMINED BY THE RESIDENT ENGINEER. PAYMENT FOR SUCH SHALL BE INCLUDED UNDER ITEM 64110, "TRAFFIC CONTROL".

6. PAYMENT FOR TEMPORARY 6" WHITE AND 6" YELLOW LINES ON THE MAINLINE ARE INCLUDED AS PART OF THE MAINLINE PLANS. TEMPORARY LINES ON THE RAMP ARE PAID FOR UNDER THIS PROJECT. SEE QUANTITY SHEET FOR ITEM NUMBERS.
7. LOCATION OF TEMPORARY TRAFFIC BARRIERS AND ENERGY ABSORPTION ATTENUATORS SHALL BE PLACED AS SHOWN ON THIS SHEET, IN CONJUNCTION WITH APPLICABLE VAOT STANDARD DRAWINGS AND AT THE DISCRETION OF THE RESIDENT ENGINEER. ATTENUATORS AND BARRIER ENDS SHALL BE ADJUSTED AS NECESSARY AND WITH APPROVAL OF THE RESIDENT ENGINEER.
8. ENERGY ABSORPTION ATTENUATORS WILL BE PLACED AS SHOWN ON THIS SHEET AND PAID FOR UNDER ITEM 62156, "ENERGY ABSORPTION ATTENUATOR". THE ATTENUATORS SHALL MEET REQUIREMENTS OF THE 2002 AASHTO ROADSIDE DESIGN GUIDELINE.

**DATUM**

VERTICAL	N/A
HORIZONTAL	N/A

PROJECT NAME:	WILLISTON	
PROJECT NUMBER:	IM 089-2(35)	
FILE NAME:	I8800F4TC01.dgn	PLOT DATE: 17-MAY-2005
PROJECT LEADER:	EPD	DRAWN BY: JDA / PGJ
DESIGNED BY:	JDA	CHECKED BY: EPD
TRAFFIC CONTROL SHEET		SHEET 68 OF 76