

- NOTES**
- LOCATION OF EXISTING STRIPING ON VT ROUTE 2A SHOWN IS APPROXIMATE. ALL CONFLICTING EXISTING MARKINGS SHALL BE REMOVED BY GRINDING OR BURNING. REMOVAL OF EXISTING MARKINGS SHALL BE PAID FOR UNDER ITEM 646.85, "REMOVAL OF EXISTING PAVEMENT MARKINGS".
  - TEMPORARY LINES, SYMBOLS AND LETTERS ARE TO BE USED AT THE SAME LOCATIONS AS DURABLE LINES. SEE QUANTITY SHEETS FOR ITEM NUMBERS USED FOR PAYMENT OF ALL LINE TYPES.
  - PLACEMENT OF RELOCATED SIGNS SHALL FOLLOW VTRANS AND 2003 MUTCD STANDARDS. SIGNS ON THIS SHEET ARE NOT DRAWN TO SCALE.
  - NEW DELINEATORS WITH REFLECTORS SHALL BE PLACED ALONG BOTH SIDES OF THE RAMP. REFLECTORS ON LEFT SIDE SHALL BE YELLOW WITH RED ON BACK. ON THE RIGHT SIDE THE REFLECTORS SHALL BE SILVER WITH RED ON THE BACK. SEE VTRANS STANDARDS E-197 AND E-198 FOR PLACEMENT AND DETAILS OF DELINEATORS. TO BE PAID FOR UNDER ITEM 676.10, "DELINEATORS WITH STEEL POSTS".
  - NEW "RAMP TRAFFIC STOPPED AHEAD" SIGN SHALL INCLUDE DUAL ALTERNATING FLASHING BEACONS ON TOP OF THE SIGN. SEE VTRANS STANDARD E-106 FOR DETAILS ON ATTACHING BEACONS.
  - SEE SIGN ACTUATION NOTES AND DETAILS SHEET FOR INFORMATION ON THE CONDUIT AND LOOP FOR THE SIGN ACTUATION. LOOP DETECTORS ARE PAID UNDER ITEM 678.22, "VEHICLE LOOP DETECTOR".

**DURABLE 6" WHITE LINE (MOD.)**

STA. 3+00.00, 0.00 LT - STA. 8+22.20, 0.00 LT (MODIFIED)  
 STA. 3+00.00, 0.00 RT - STA. 20+90.59, 67.81 RT  
 STA. 8+22.20, 0.00 LT - STA. 10+91.14, 10.34 LT (DASHED)  
 STA. 15+56.19, 24.00 LT - STA. 20+66.38, 24.00 LT  
 STA. 17+82.48, 12.00 LT - STA. 20+66.38, 12.00 LT

**DURABLE 12" WHITE LINE (MOD.)**

STA. 10+94.14, 10.34 LT - STA. 15+14.56, 53.11 LT  
 STA. 10+94.14, 10.34 LT - STA. 15+17.27, 32.76 LT  
 STA. 11+64.61, 14.27 LT - STA. 15+17.27, 53.11 LT (GORE AREA)  
**DURABLE 4" WHITE LINE (MOD.)**  
 STA. 14+75.00, 0.00 LT - STA. 17+82.48, 12.00 LT (DASHED)

**DURABLE 6" YELLOW LINE (MOD.)**

STA. 15+35.36, 33.65 LT - STA. 21+04.39, 67.34 LT  
**DURABLE 24" STOP BAR**  
 STA. 20+67.38, 36.00 LT - STA. 20+67.38, 12.51 RT  
 STA. 21+09.11, 128.68 LT - STA. 21+31.48, 127.06 LT

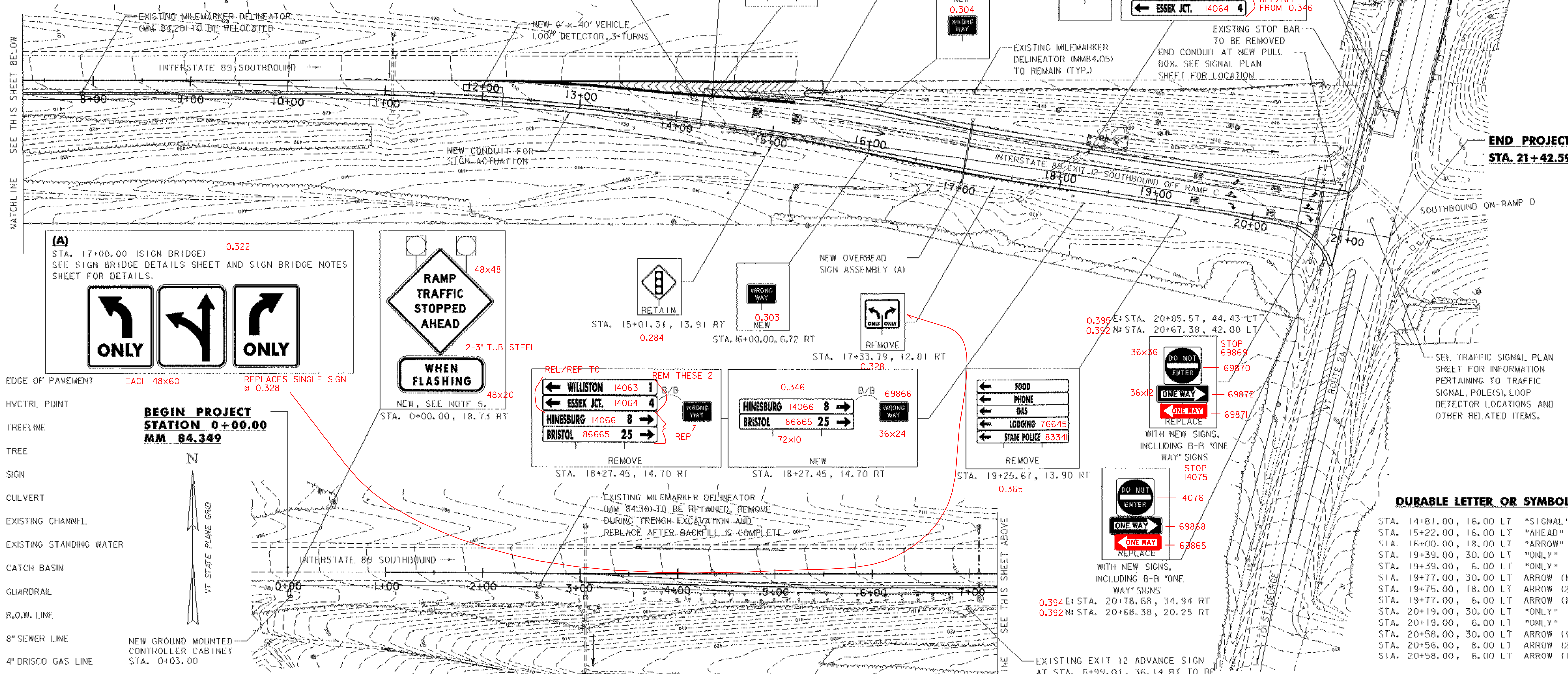

**(A)**  
 STA. 17+00.00 (SIGN BRIDGE) 0.322  
 SEE SIGN BRIDGE DETAILS SHEET AND SIGN BRIDGE NOTES SHEET FOR DETAILS.

**RAMP TRAFFIC STOPPED AHEAD** 48x48  
 2-3" TUB STEEL  
**WHEN FLASHING** 48x20  
 NEW, SEE MUTCD 5.  
 STA. 0+00.00, 18.73 RT

REL/REP TO  
 ← WILLISTON 14063 1  
 ← ESSEX JCT. 14064 4  
 ← HINESBURG 14066 8  
 ← BRISTOL 86665 25 →  
 REMOVE  
 STA. 18+27.45, 14.70 RT

0.346  
 ← HINESBURG 14066 8 →  
 ← BRISTOL 86665 25 →  
 NEW  
 STA. 18+27.45, 14.70 RT

REMOVE  
 ← FOOD  
 ← PHONE  
 ← GAS  
 ← LODGING 76645  
 ← STATE POLICE 8334  
 STA. 19+25.67, 13.90 RT

36x36 STOP 69869  
 36x12 ONE WAY 69872  
 36x12 ONE WAY 69871  
 WITH NEW SIGNS, INCLUDING B-R "ONE WAY" SIGNS  
 STOP 14075  
 14076  
 69868  
 69865  
 WITH NEW SIGNS, INCLUDING B-R "ONE WAY" SIGNS

- LEGEND**
- EDGE OF PAVEMENT? EACH 48x60
  - HYCTRL POINT
  - TREELINE
  - TREE
  - SIGN
  - CULVERT
  - EXISTING CHANNEL
  - EXISTING STANDING WATER
  - CATCH BASIN
  - GUARDRAIL
  - R.O.W. LINE
  - 8" SEWER LINE
  - 4" DRISCO GAS LINE
  - STONE FILL
  - TOE OF SLOPE

**ITEM 678.16 - FLASHING BEACON - GROUND MOUNTED (MOD. - ACTUATED SIGN) MAJOR EQUIPMENT LIST**

FLASHING BEACONS	2
GROUND MOUNTED CONTROLLER CABINET	1
POWER DROP STANCHION	1
ALL OTHER MISCELLANEOUS HARDWARE NECESSARY TO COMPLETE INSTALLATION	

**DURABLE LETTER OR SYMBOL**

STA. 14+81.00, 16.00 LT	"SIGNAL"
STA. 15+22.00, 16.00 LT	"AHEAD"
STA. 16+00.00, 18.00 LT	"ARROW"
STA. 19+39.00, 30.00 LT	"ONLY"
STA. 19+39.00, 6.00 LT	"ONLY"
STA. 19+77.00, 30.00 LT	ARROW (1)
STA. 19+75.00, 18.00 LT	ARROW (2)
STA. 19+77.00, 6.00 LT	ARROW (1)
STA. 20+19.00, 30.00 LT	"ONLY"
STA. 20+19.00, 6.00 LT	"ONLY"
STA. 20+58.00, 30.00 LT	ARROW (1)
STA. 20+56.00, 8.00 LT	ARROW (2)
STA. 20+58.00, 6.00 LT	ARROW (1)

PROJECT NAME: I-89 EXIT 12 SB OFF RAMP  
 PROJECT NUMBER: IM 089-2(35)  
 FILE NAME: p04014.dgn  
 PROJECT LEADER: EPI2  
 DESIGNED BY: JDA  
 SIGNS & PAVEMENT MARKINGS SHEET

PLOT DATE: 17-MAY-2005  
 DRAWN BY: JDA / PGJ  
 CHECKED BY: EPD  
 SHEET 54 OF 76

