

**SANITARY SEWER SYSTEM**

**STRUCTURES**

- MH2 STA. 205+68  
NEW 4' ID PRECAST MANHOLE
- MH3 STA. 208+37  
NEW 4' ID PRECAST MANHOLE
- MH4 STA. 210+48.47  
NEW 4' ID PRECAST MANHOLE
- MH5 STA. 212+73.74  
NEW 4' ID PRECAST MANHOLE
- MH6 STA. 215+58.60  
NEW 4' ID PRECAST MANHOLE
- PS3 STA. 216+94 = STA. 300+27  
NEW PUMP STATION

**PIPES**

- P2 STA. 205+68 - STA. 208+37  
NEW 8" x 269' SDR 35 PVC SEWER
- P3 STA. 208+37 - STA. 210+48.47  
NEW 8" x 211' SDR 35 PVC SEWER
- P4 STA. 210+48.47 - STA. 212+73.74  
NEW 8" x 225' SDR 35 PVC SEWER
- P5 STA. 212+73.74 - STA. 215+58.60  
NEW 8" x 285' SDR 35 PVC SEWER
- P6 STA. 215+58.60 - STA. 216+94  
NEW 8" x 136' SDR 35 PVC SEWER

INSTALLED GEOPIERS AT  
MH#5 PS - 3  
212+74 TO 216+94

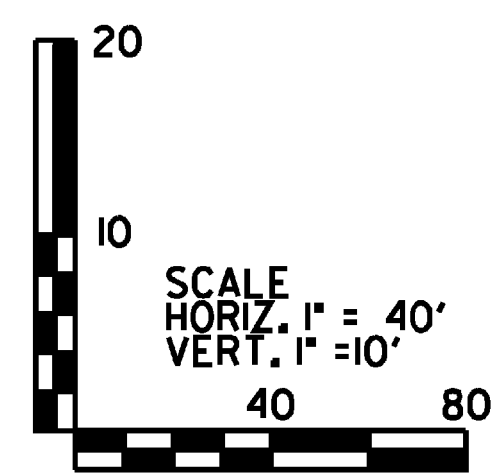
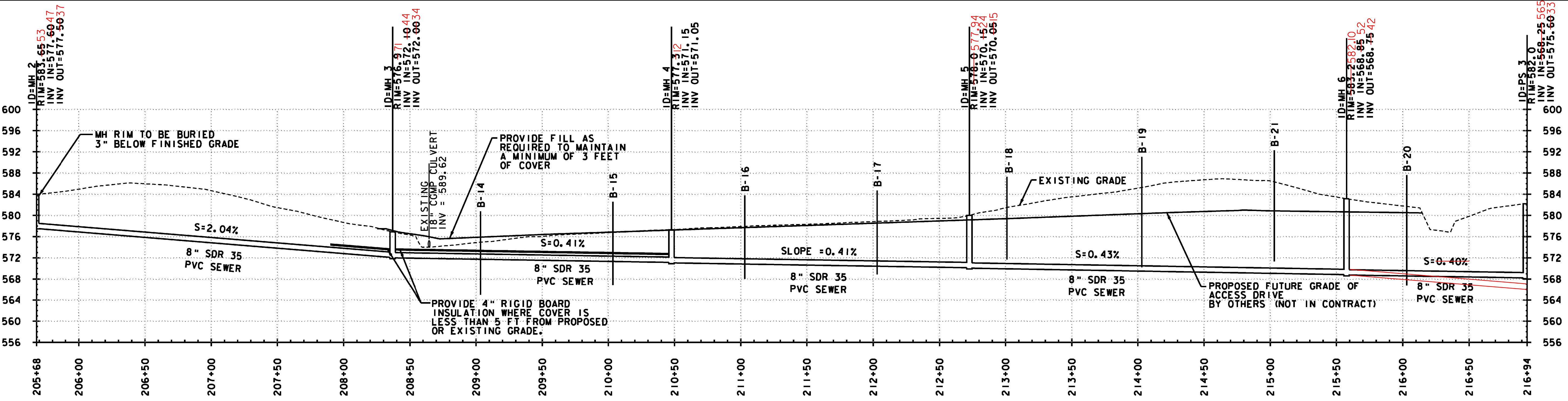
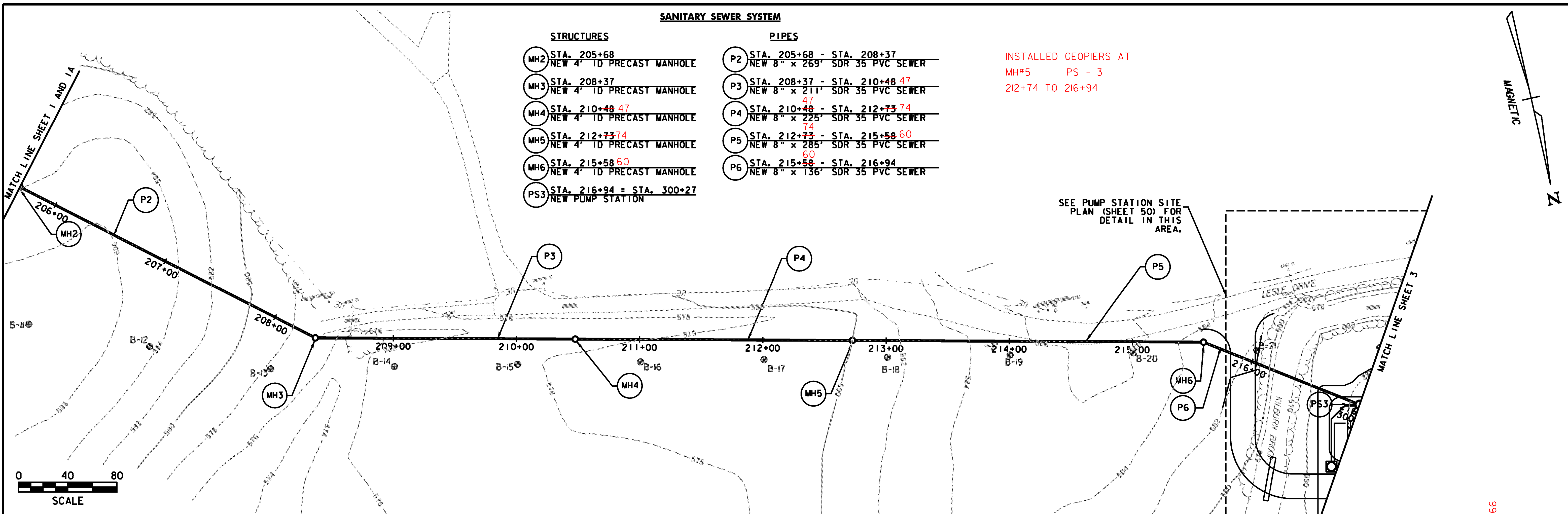

PROJECT NAME:	HARTFORD REST AREAS
PROJECT NUMBER:	IM BLDG(10)
FILE NAME:	...plot files\04\026\pl-t\l.dgn
PLOT DATE:	5/19/2008
PROJECT LEADER:	JTM
DRAWN BY:	PZA
DESIGNED BY:	MEHP
CHECKED BY:	JTM
PLAN & PROFILE SHEET 2	SHEET 38 OF 70