

**SANITARY SEWER SYSTEM**

**STRUCTURES**

- PS2 STA. 200+00  
NEW PUMP STATION
- VV2 STA. 200+11  
NEW VALVE VAULT
- MH1 STA. 203+14 = STA. 106+88  
NEW 4' ID PRECAST MANHOLE
- MH2 STA. 205+68  
NEW 4' ID PRECAST MANHOLE

**PIPES**

- FM5 STA. 200+00 - STA. 200+11  
TWO (2) NEW 2" x 11" DRTI HDPE SANITARY FORCE MAINS
- FM6 STA. 200+11 - STA. 203+14  
NEW 2" x 303' DRTI HDPE SANITARY FORCE MAIN
- PI STA. 203+14 - STA. 205+68  
NEW 8" x 254' SDR 35 PVC SEWER

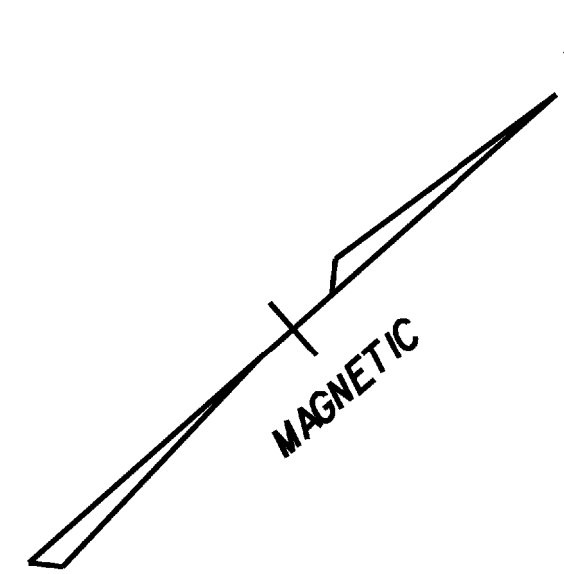

SEE PUMP STATION SITE PLAN (SHEET 50) FOR DETAIL IN THIS AREA.

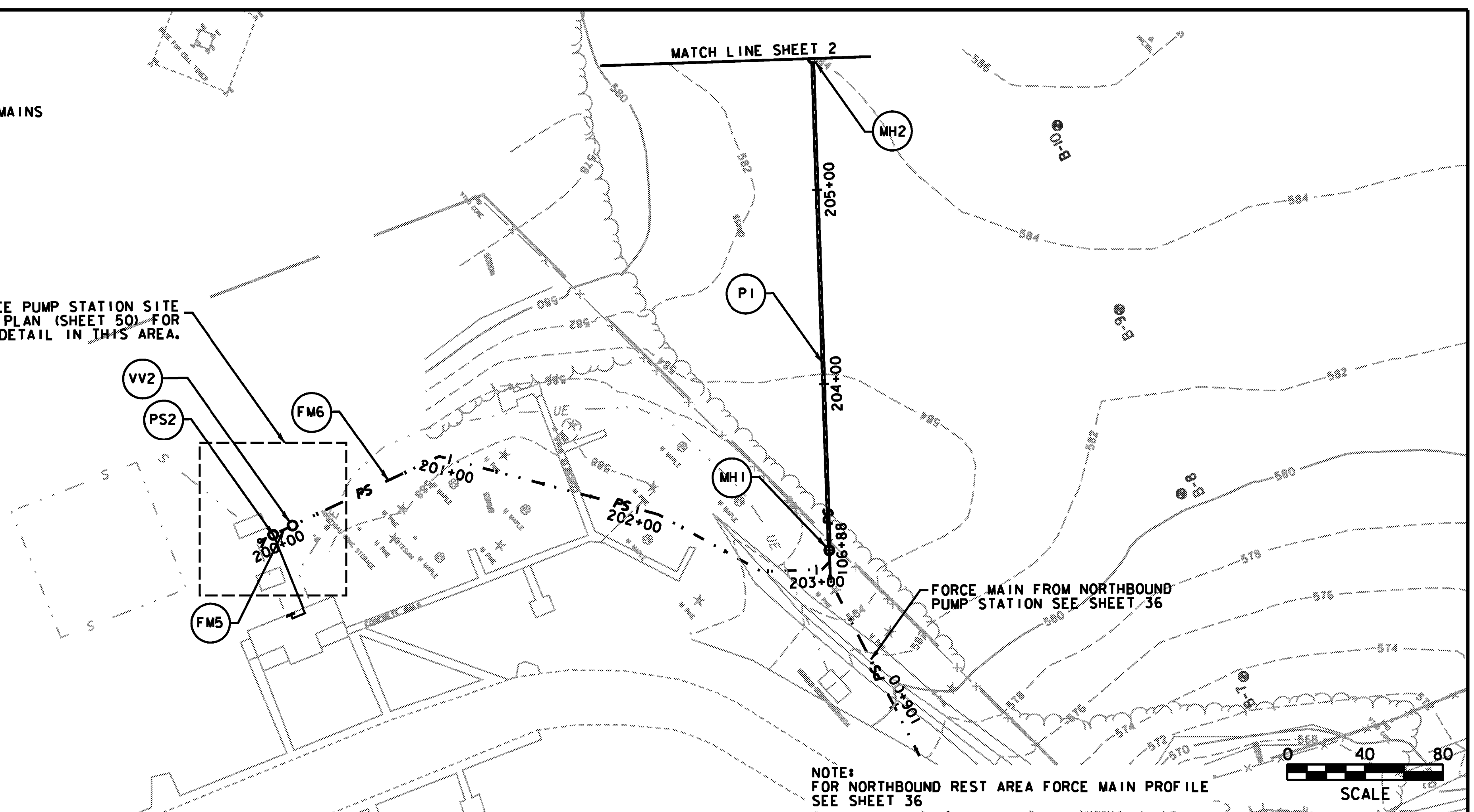

NOTE:  
FOR NORTHBOUND REST AREA FORCE MAIN PROFILE  
SEE SHEET 36

SCALE 0 40 80

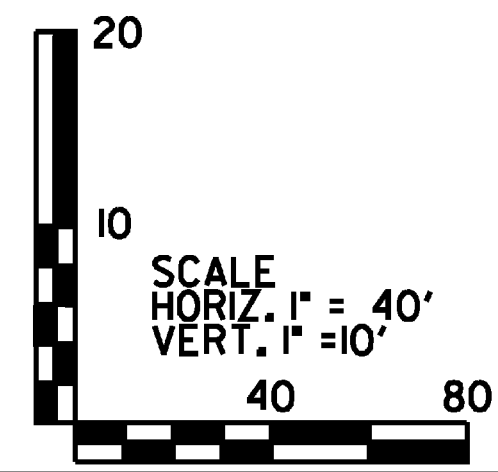
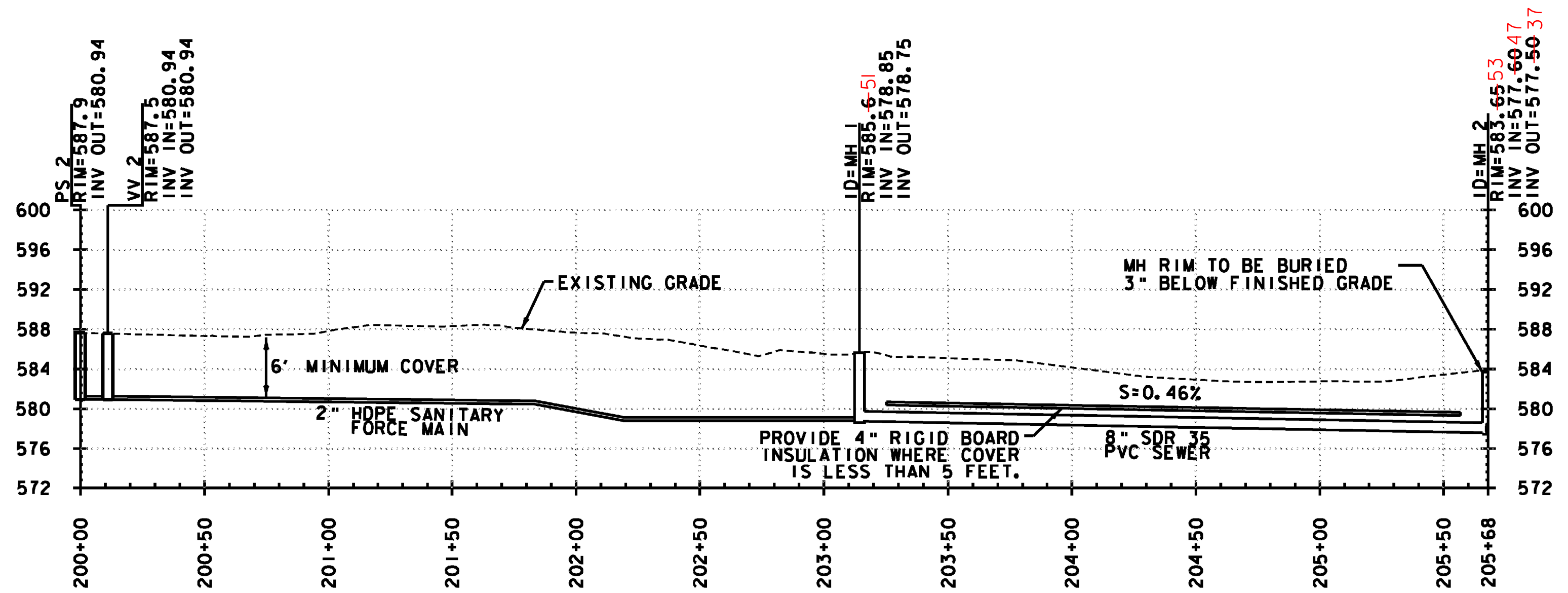

PROJECT NAME: HARTFORD REST AREAS	
PROJECT NUMBER: IM BLDG(10)	
FILE NAME: ... \plot files\04026plt-utl.dgn	PLOT DATE: 5/19/2008
PROJECT LEADER: JTM	DRAWN BY: PZA
DESIGNED BY: MEHP	CHECKED BY: JTM
PLAN & PROFILE SHEET 1A	SHEET 37 OF 70