

COLD PLANING-BIT.PAVEMENT

RAMP "C" 63+50 ~ 64+00

8" UNDERDRAIN CARRIER PIPE

RAMP "C" 59+56 LT ~ 60+51 LT

NEW 8" x 98" UNDERDRAIN CARRIER PIPE

W/F.B. @ 59+56 LT

STONE FILL, TYPE I

RAMP "C" 60+51 LT ~ 1' WIDE BY 3' LONG

CHAIN LINK FENCE

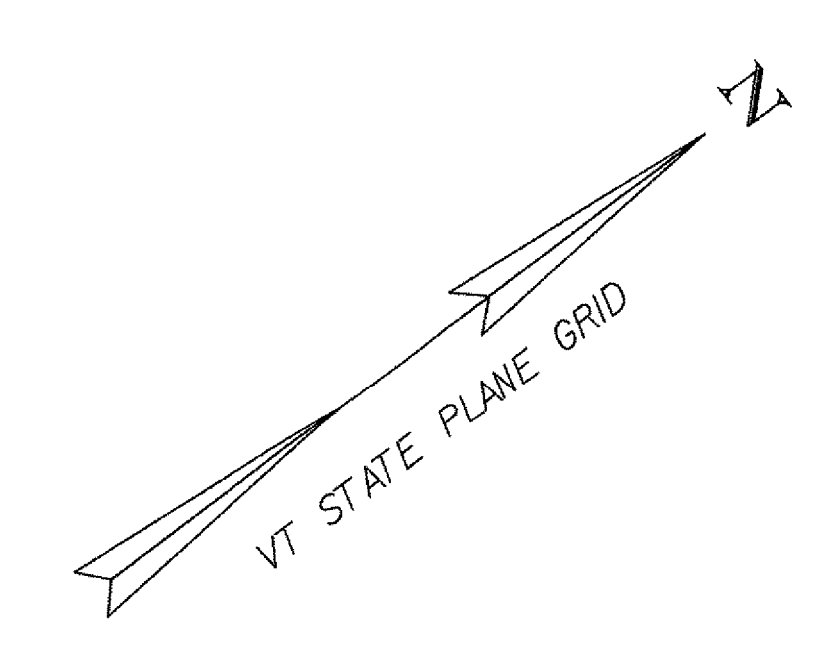

POT RAMP "C" STA 62+62.50 =
1-89 STA 2120+42.90 (58.02 LT)
END PROJECT
BEGIN APPROACH

BM #8
RR SPIKE SET IN
ROOT OF M. MAPLE
ELEV. = 257.97

POC RAMP "C" STA 64+00.00 =
1-89 STA 2121+80.32 (53.74 LT)
END APPROACH

CURVE DATA

$\Delta = 2^\circ 43' 16.55''$
 $D = 3^\circ 48' 34.42''$
 $R = 1504.00'$
 $T = 35.72'$
 $L = 71.43'$
 $E = 0.42'$

BANK = MATCH EXISTNG

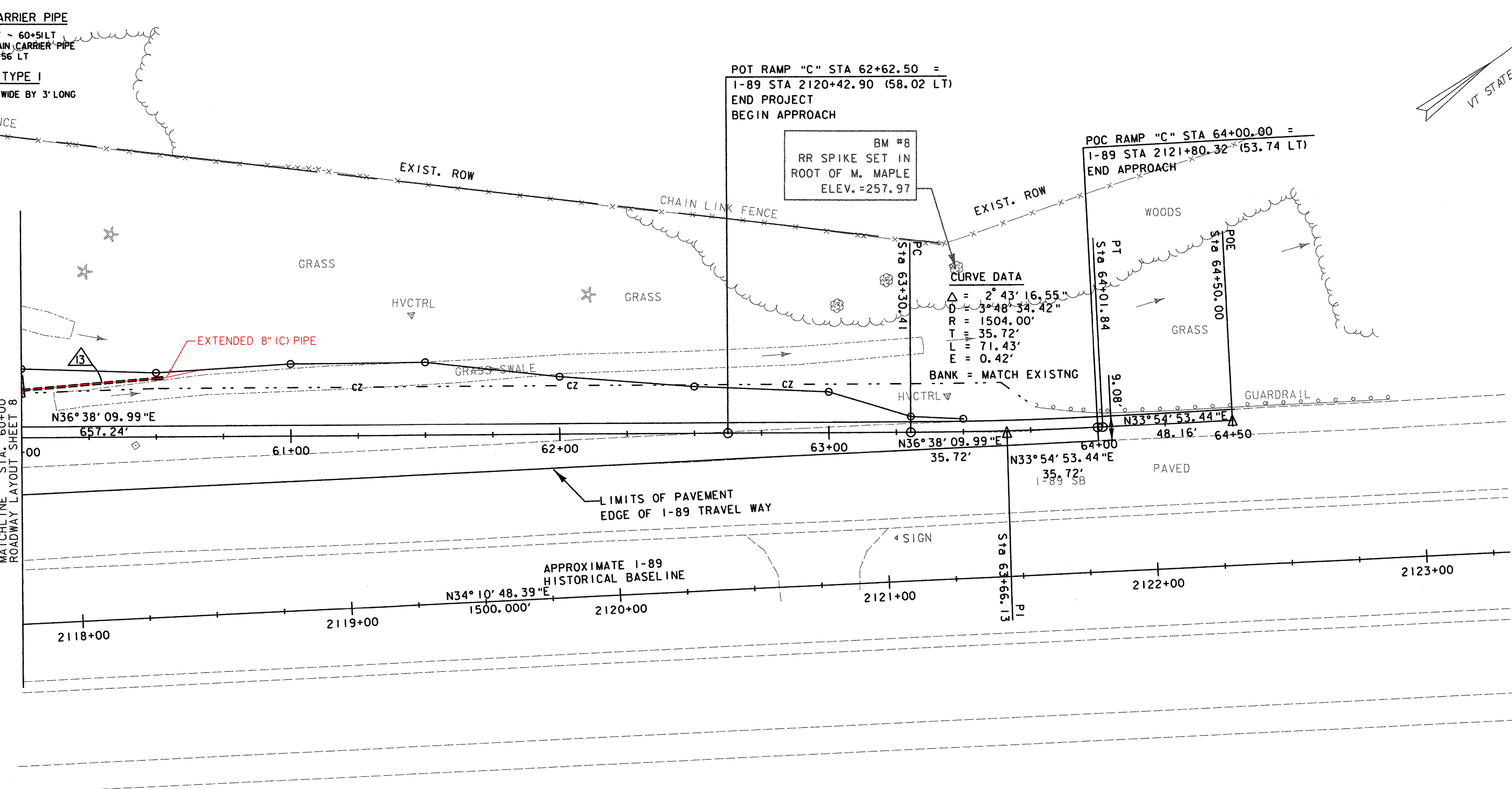

MATCHLINE STA. 60+00
ROADWAY LAYOUT SHEET 8

N36°38'09.99"E 657.24'
61+00 62+00 63+00 64+00
N36°38'09.99"E 35.72'
N33°54'53.44"E 48.16'
N33°54'53.44"E 35.72'
1-89 SB
2118+00 2119+00 2120+00 2121+00 2122+00 2123+00
N34°10'48.39"E 1500.000'

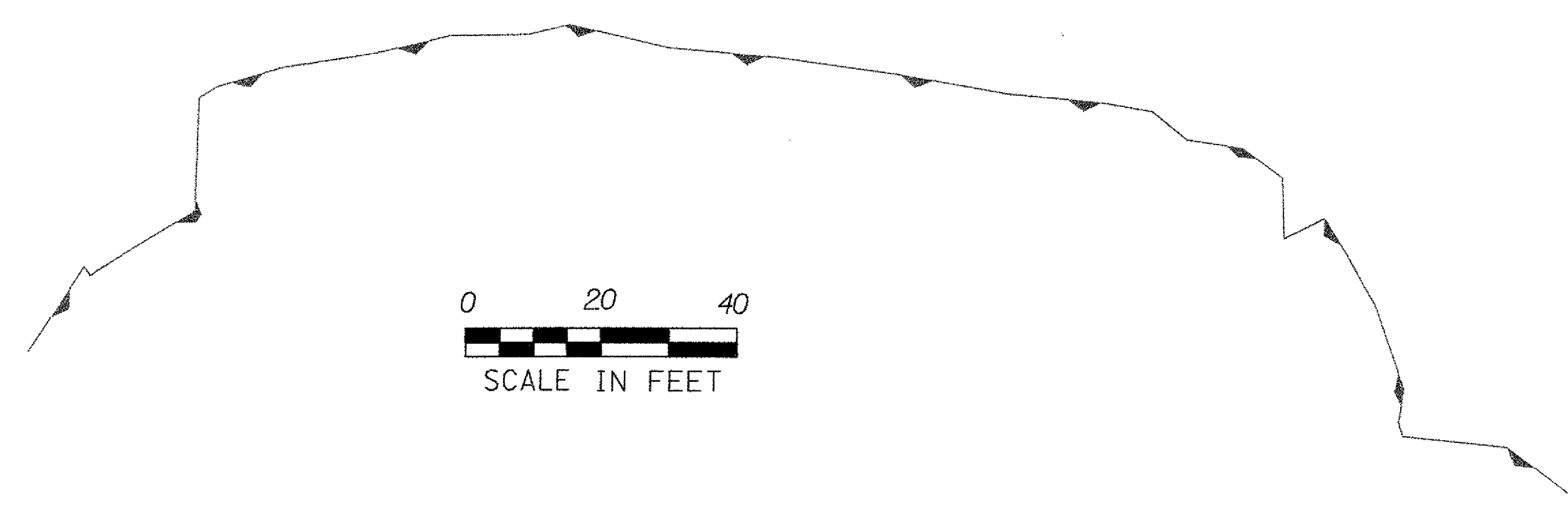

0 20 40
SCALE IN FEET

ROADWAY LAYOUT SHEET 9

PROJECT NAME:	SOUTH BURLINGTON	PLOT DATE:	5/5/2006
PROJECT NUMBER:	IM 089-3(37)	DRAWN BY:	P.MILEWSKI
FILE NAME:	z03al78bdr.dgn	CHECKED BY:	K.ISHIKURA
PROJECT LEADER:	KEN UPMAL	SHEET 21	OF 99
DESIGNED BY:	E.ATKINS/P.MILEWSKI		

DATUM
VERTICAL NAVD 88
HORIZONTAL NAD 83 (1996)