

**GENERAL NOTES**

1. THE EXISTING CONDITIONS BASE PLAN WAS DEVELOPED FROM TOPOGRAPHICAL ON-THE-GROUND SURVEY PERFORMED BY THE VERMONT AGENCY OF TRANSPORTATION ALONG THE ENTIRETY OF RAMP 'C', THE ENTIRETY OF RAMP 'D', AND ROUTE 2 FROM APPROX. STA. 15+09 TO APPROX. STA. 26+90. THE ON-THE-GROUND SURVEY WAS SUPPLEMENTED WITH AN ELECTRONIC DRAWING FILE CONTAINING AN AERIAL SURVEY PREPARED BY THE UNIVERSITY OF VERMONT WHERE TOPOGRAPHICAL ON-THE-GROUND SURVEY WAS NOT PERFORMED. TOPOGRAPHICAL FIELD CHECK SURVEY WAS PERFORMED BY GREEN INTERNATIONAL AFFILIATES, INC. ON 11/21/2005. THE LOCATIONS OF ALL TOPOGRAPHICAL FEATURES SHOWN ON THE EXISTING CONDITIONS BASE PLAN, EXCEPT WHERE SURVEYED BY THE VERMONT AGENCY OF TRANSPORTATION, SHOULD BE CONSIDERED APPROXIMATE.
2. UNDERGROUND UTILITIES SHOWN HEREIN WERE COMPILED FROM INFORMATION OF RECORD AND FIELD OBSERVATIONS. THE EXISTENCE OR LOCATION OF THE UTILITIES ARE NOT WARRANTED TO BE EXACT. THE CONTRACTOR SHALL FIELD VERIFY THE LOCATIONS OF A UTILITY AT THE DISCRETION OF THE ENGINEER. PAYMENT TO BE MADE UNDER TRENCH EXCAVATION OF EARTH. IF FIELD CONDITIONS ARE DIFFERENT THAN SHOWN ON THE PLANS, THE ENGINEER SHALL BE NOTIFIED.
3. THE CONTRACTOR IS RESPONSIBLE FOR PROTECTING ALL EXISTING UTILITIES THAT ARE TO REMAIN DURING CONSTRUCTION.

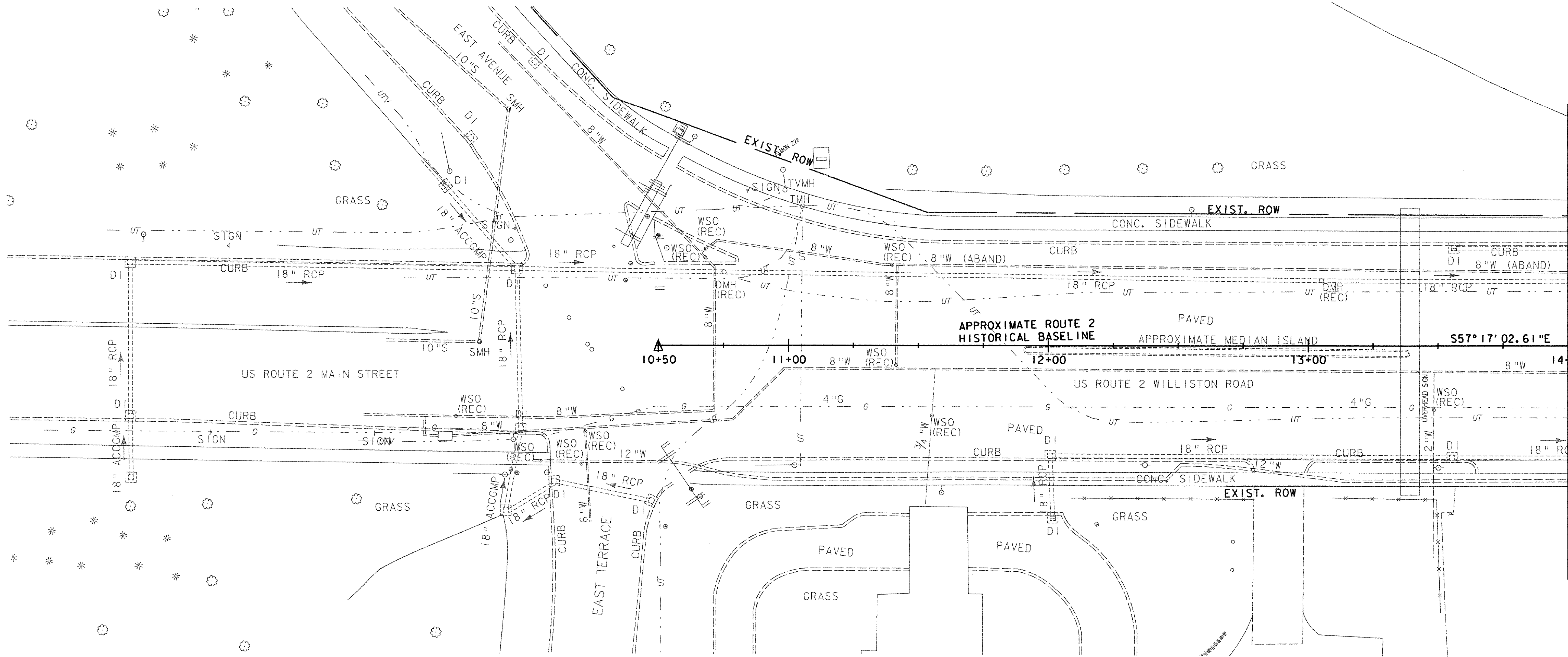
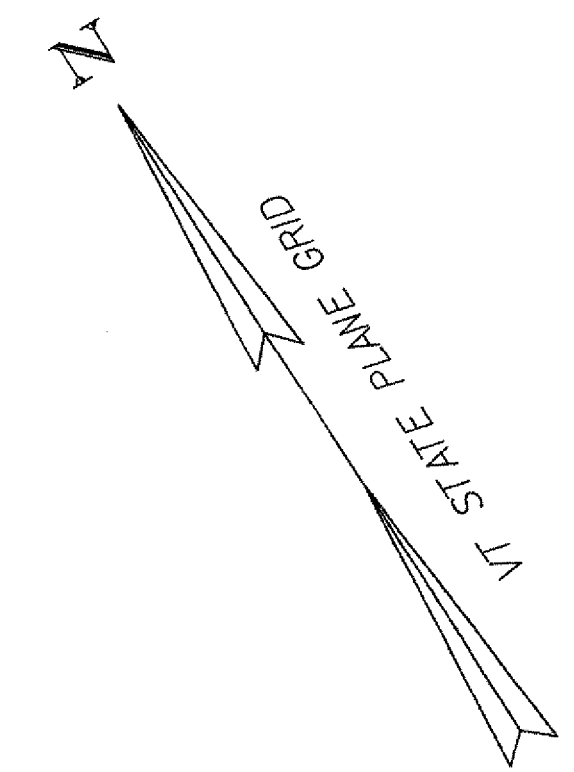

MATCHLINE STA. 14+00  
ROADWAY LAYOUT SHEET 2

SIGNALS \ LIGHTING  
AS BUILTS

PULL BOXES - CONCRETE

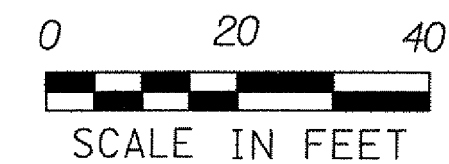

**ROADWAY LAYOUT SHEET 1**

<b>DATUM</b>	
VERTICAL	NAVD 88
HORIZONTAL	NAD 83 (1996)

PROJECT NAME: SOUTH BURLINGTON	
PROJECT NUMBER: IM 089-3(37)	
FILE NAME: z03ql78bdr.dgn	PLOT DATE: 5/5/2006
PROJECT LEADER: KEN UPMAL	DRAWN BY: P.MILEWSKI
DESIGNED BY: E.ATKINS/P.MILEWSKI	CHECKED BY: K.ISHIKURA
	SHEET 13 OF 99