

SEE STANDARD E-100, E-100A AND E-103 FOR SIGN PLACEMENT.  
 THE COST OF PROVIDING, INSTALLING AND MAINTAINING CONSTRUCTION APPROACH  
 SIGNING IS INCLUDED IN ITEM 641.10, TRAFFIC CONTROL.

**NOTES:**

1. THE CONTRACTOR SHALL SUSPEND ALL INROAD WORK ON FRIDAY AFTERNOONS BEGINNING AT 12:00 P.M. (NOON). THE CONTRACTOR SHALL NOT RESUME WORK, NOR REDUCE THE NUMBER OF TRAVEL LANES, UNTIL THE START OF DAY ON SATURDAY.
2. ALL RAMP COLD PLANING AND PAVING OPERATIONS, AT INTERCHANGES 1, 2 AND 3 SHALL BE DONE AT NIGHT, BETWEEN THE HOURS OF 8:00 P.M. AND 5:00 A.M. INCLUSIVELY.
3. THE CONTRACTOR SHALL SUBMIT A TRAFFIC CONTROL PLAN FOR APPROVAL PRIOR TO THE START OF CONSTRUCTION. THE COST OF PREPARING THIS PLAN (AND MAKING CHANGES IF NECESSARY) SHALL BE CONSIDERED INCIDENTAL TO ITEM 641.10, TRAFFIC CONTROL.
4. THE STATE OF VERMONT HAS A PLANNED BRIDGE REHABILITATION PROJECT FOR BRIDGES 3N AND 3S WHICH WILL SPAN OVER A PERIOD OF THREE CONSTRUCTION SEASONS (2006 THRU 2008). THE CONTRACTOR SHALL COORDINATE CONSTRUCTION ACTIVITIES WITH THE CONTRACTOR OF THE BRIDGE PROJECT AND SHALL COORDINATE THE PLACEMENT OF SIGN PACKAGES TO AVOID CONFLICTS AND CONFUSION.
5. THE CONTRACTOR IS REQUIRED TO OBTAIN PERMITTING FROM THE MASSACHUSETTS STATE DEPARTMENT OF TRANSPORTATION FOR THE PLACEMENT OF AN MUTCD COMPLIANT CONSTRUCTION WARNING SIGN PACKAGE AND FOR THE PLACEMENT OF PORTABLE CHANGEABLE MESSAGE SIGNS WITHIN THE STATE OF MASSACHUSETTS. THE CONTACT PERSON FOR THIS WORK SHALL BE:  
 TOM WALKER  
 NORTHFIELD MASSACHUSETTS HIGHWAY DEPT.  
 TEL. (413) 498-5117  
 DIG SAFE SHALL BE NOTIFIED PRIOR TO THE INSTALLATION OF ANY SIGNS IN MASSACHUSETTS AT TEL. (888) 344-7233.
6. DURING CONSTRUCTION IT WILL BE NECESSARY FOR THE CONTRACTOR TO MAINTAIN ONE-LANE TRAFFIC FOR EXTENDED PERIODS OF TIME IN NO CASE SHALL THE PAVED WIDTH FOR THIS ONE-LANE TRAFFIC, INCLUDING SHOULDERS, BE REDUCED TO LESS THAN 15 FEET. THIS PAVED WIDTH SHALL REMAIN FREE OF OBSTRUCTIONS AND OBSTACLES AT ALL TIMES.
7. THE CONTRACTOR SHALL POSITION A PORTABLE CHANGEABLE MESSAGE BOARD PRIOR TO VERMONT, I-91 INTERCHANGE #4 (PUTNEY), WARNING SOUTHBOUND MOTORISTS OF THE COLD PLANED SURFACE AND REDUCED ROADWAY WIDTHS AHEAD. THE MESSAGE TO BE DISPLAYED SHALL BE SUBMITTED TO THE RESIDENT ENGINEER IN ADVANCE FOR APPROVAL. THE COST OF PROVIDING THIS MESSAGE BOARD SHALL BE PAID UNDER ITEM 641.15, PORTABLE CHANGEABLE MESSAGE SIGN. THE CONTRACTOR SHALL ALSO INSTALL AND MAINTAIN THE APPROPRIATE CONSTRUCTION SIGNING WHICH WARNS THE TRAVELING PUBLIC OF THE ROUGH ROADWAY SURFACE.
8. THE CONTRACTOR SHALL INCLUDE A CONSTRUCTION SIGN PACKAGE FOR EXPECTED LANE CLOSURES AND WORK ZONE SPEED REDUCTIONS IN COMPLIANCE WITH STANDARD E-103. PAYMENT FOR PROVIDING THIS PACKAGE SHALL BE INCIDENTAL TO ITEM 641.10, TRAFFIC CONTROL.
9. FOUR (4) PORTABLE CHANGEABLE MESSAGE SIGNS WILL BE PROVIDED FOR USE ALONG THIS PROJECT. THE PLACEMENT OF THESE MESSAGE SIGNS AS WELL AS THEIR MESSAGE WILL BE APPROVED BY THE RESIDENT ENGINEER. THIS QUANTITY IS PAID FOR AS ITEM 641.15, PORTABLE CHANGEABLE MESSAGE SIGN.

TOWN/STATE HIGHWAY NAME	ROAD WORK AHEAD	ROAD WORK 1 MILE	END ROAD WORK	ROAD WORK 1/2 MILE	ROAD WORK NEXT 1/2 MILES	ROAD WORK NEXT 7 MILES	ROAD WORK NEXT 8 3/4 MILES	ROAD WORK NEXT 11 1/2 MILES	RAMP PAVING AHEAD
I-91 SOUTHBOUND									
BEGINNING OF PROJECT		2		2	2				
EXIT 1 INTERCHANGE	4		2						2
STATION 367+50						2			
EXIT 2 INTERCHANGE	2		2						2
STATION 475+00							2		
EXIT 3 INTERCHANGE	2		2						2
STATION 600+00								2	
END OF PROJECT			2						
TOTAL	8	2	8	2	2	2	2	2	6

**LEGEND**

- RW 1 MILE = ROAD WORK 1 MILE
- RW 1/2 MILE = ROAD WORK 1/2 MILE
- RWA = ROAD WORK AHEAD
- RWN = ROAD WORK NEXT XX MILES
- ERW = END ROAD WORK
- RPA = RAMP PAVING AHEAD
- = TRAFFIC FLOW ARROWS

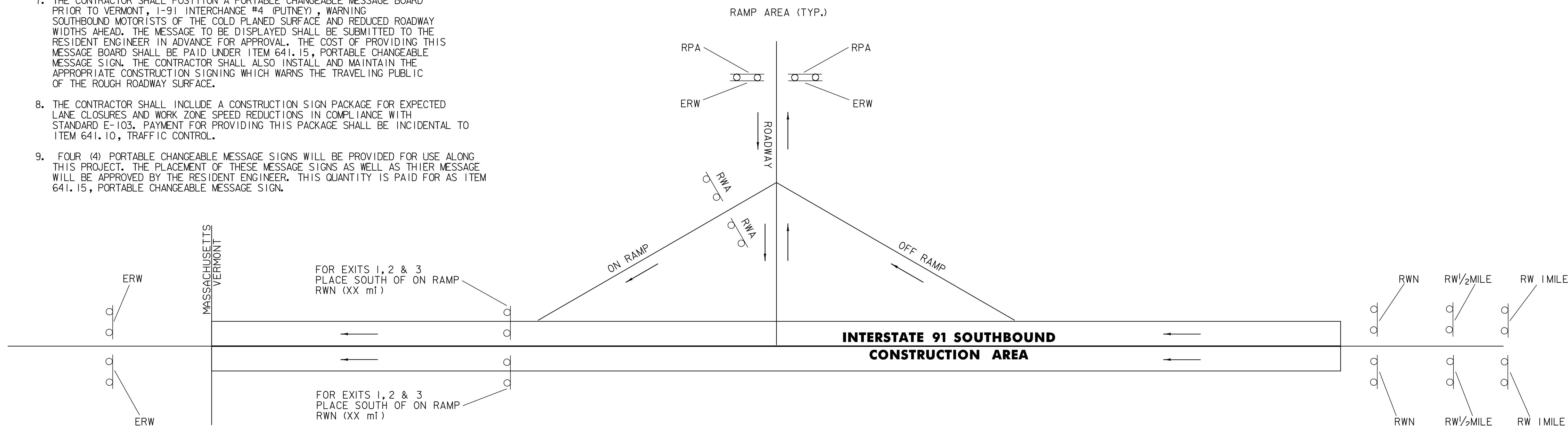

NOT TO SCALE

<b>CONSTRUCTION APPROACH SIGNING</b>	PROJECT NAME: GUILFORD-BRATTLEBORO	PLOT DATE: 22-JAN-2009 13:4
	PROJECT NUMBER: AC IM 091-1(54)	DRAWN BY: MRS
	FILE NAME: 05A014cs54.1	CHECKED BY: NLL
	PROJECT LEADER: CRB DESIGNED BY: CLD CLD REF. NO. 05-0387	SHEET 69 OF 69

<b>DATUM</b>	
VERTICAL	N/A
HORIZONTAL	N/A