

TEMPORARY AND DURABLE 6" WHITE LINE
 ON RAMP 0+00 TO 5+50 SOLID RT (RAMP C)
 OFF RAMP 7+50 TO 11+88 SOLID RT (RAMP D)
 OFF RAMP 12+00 TO 14+02 SOLID RT (RAMP C/D)
 ON RAMP 12+00 TO 14+02 SOLID LT (RAMP C/D)
 I-91 472+50 TO 475+07 DASHED LT

TEMPORARY AND DURABLE 6" YELLOW LINE
 ON RAMP 0+00 TO 5+50 SOLID LT (RAMP C)
 OFF RAMP 7+50 TO 11+88 SOLID LT (RAMP D)
 OFF RAMP 12+00 TO 14+02 SOLID LT (RAMP C/D)
 ON RAMP 12+00 TO 14+02 SOLID RT (RAMP C/D)

TEMPORARY AND DURABLE 12" WHITE LINE
 ON RAMP 5+50 TO 6+24 SOLID LT (RAMP C)
 I-91 475+07 TO 476+32 SOLID LT

REMOVAL AND DISP. GUARDRAIL
 I-91 472+50 TO 473+93 LT

STEEL BEAM GUARDRAIL (GALV.) (MOD.-8' POSTS)
 I-91 472+50 TO 473+93 LT

DELINEATORS
 REFER TO STANDARDS E-197, E-198
 AND E-199 FOR PLACEMENT GUIDELINES

REHABING OF DI, CB OR MH
 ON RAMP 5+00 RT (RAMP C) CLASS **HI I**
 OFF RAMP 13+49 LT (RAMP C/D) CLASS **HHI I**

BITUMINOUS CONCRETE GUTTERS AND TRAFFIC ISLANDS
 ON RAMP 2+55 RT (PAVE ONLY) (RAMP C)
 ON RAMP 3+92 RT (PAVE ONLY) (RAMP C)
 ON RAMP 13+40 RT (PAVE ONLY) (RAMP C/D)
PAINTED CURB
 STA 13+46 TO 13+76 LT & RT
REMOVING SIGNS
 AS SHOWN - 6

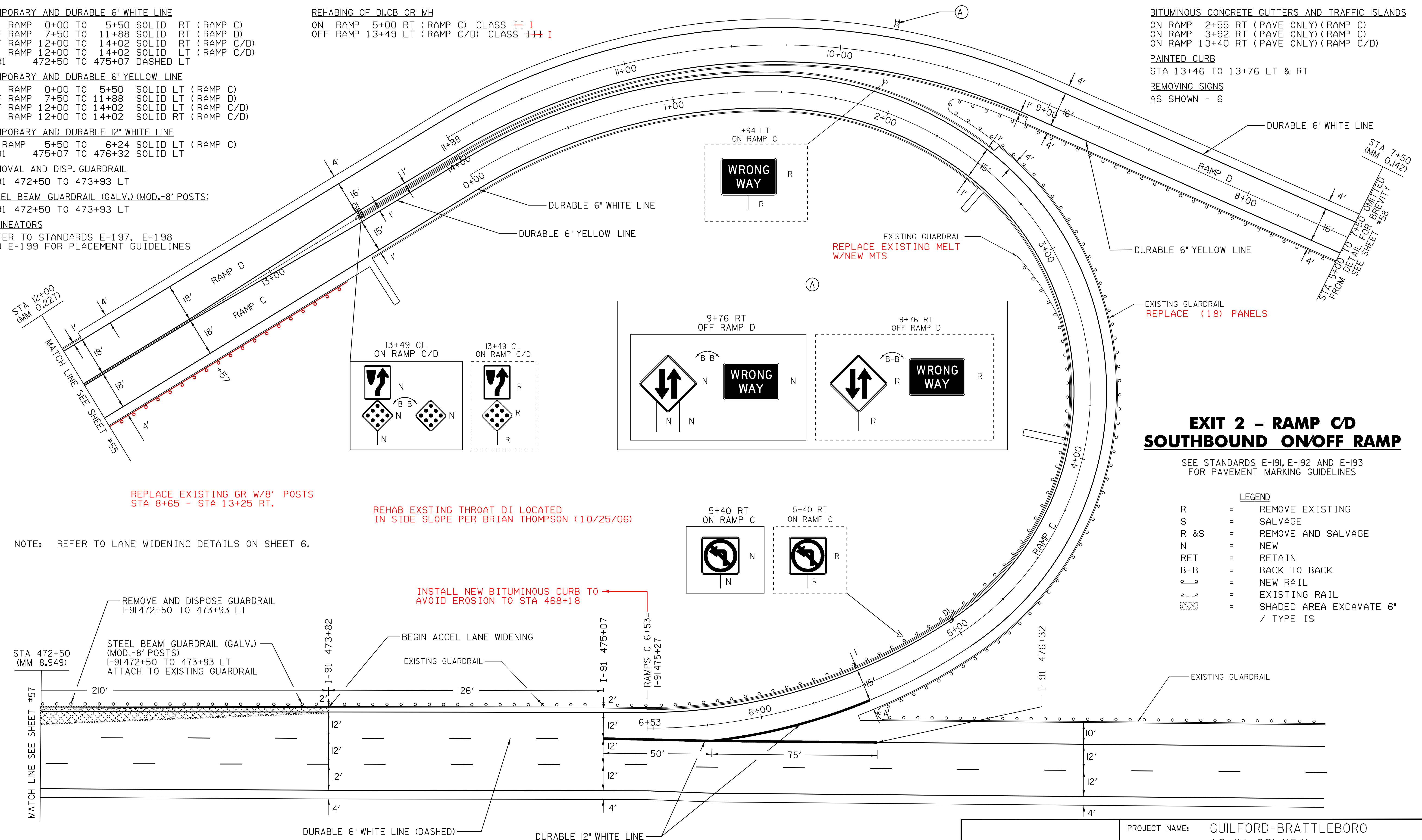

REPLACE EXISTING GR W/8' POSTS
 STA 8+65 - STA 13+25 RT.

REHAB EXSTING THROAT DI LOCATED
 IN SIDE SLOPE PER BRIAN THOMPSON (10/25/06)

EXISTING GUARDRAIL
 REPLACE EXISTING MELT
 W/NEW MTS

EXISTING GUARDRAIL
 REPLACE (18) PANELS

**EXIT 2 - RAMP CD
 SOUTHBOUND ONOFF RAMP**

SEE STANDARDS E-191, E-192 AND E-193
 FOR PAVEMENT MARKING GUIDELINES

LEGEND

R	=	REMOVE EXISTING
S	=	SALVAGE
R & S	=	REMOVE AND SALVAGE
N	=	NEW
RET	=	RETAIN
B-B	=	BACK TO BACK
	=	NEW RAIL
	=	EXISTING RAIL
	=	SHADED AREA EXCAVATE 6" / TYPE IS

NOTE: REFER TO LANE WIDENING DETAILS ON SHEET 6.

INSTALL NEW BITUMINOUS CURB TO
 AVOID EROSION TO STA 468+18

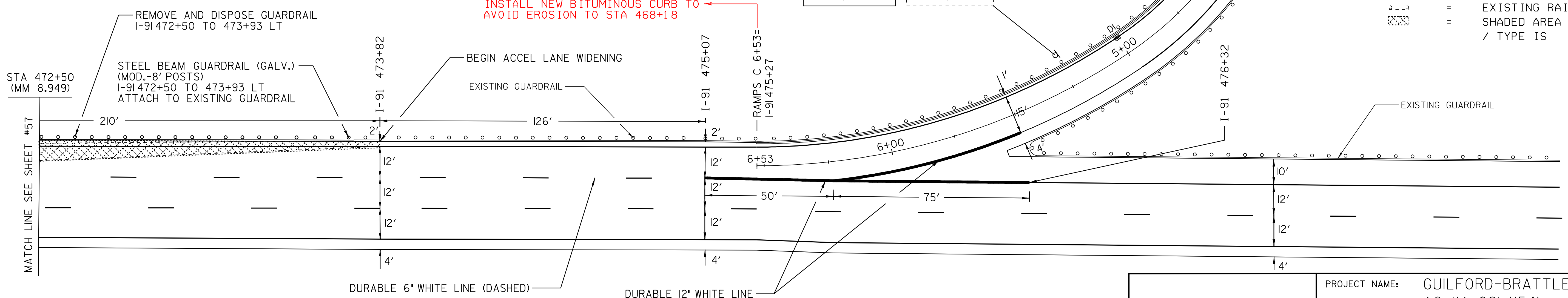

DATUM

VERTICAL	_____
HORIZONTAL	_____

NOT TO SCALE

RAMP DETAIL #10	PROJECT NAME: GUILFORD-BRATTLEBORO	FILE NAME: 05A014r.d10.1	PLOT DATE: 22-JAN-2009 13:4
	PROJECT NUMBER: AC IM 091-1(54)	PROJECT LEADER: CRB	DRAWN BY: MRS
		DESIGNED BY: CLD	CHECKED BY: NLL
		CLD REF. NO. 05-0387	SHEET 56 OF 69