

TEMPORARY AND DURABLE 6" WHITE LINE
 OFF RAMP 1+05 TO 3+00 SOLID RT (RAMP B)
 I-91 402+07 TO 404+82 DASHED LT
 I-91 404+82 TO 410+57 DOTTED LT

TEMPORARY AND DURABLE 6" YELLOW LINE
 OFF RAMP 1+05 TO 3+00 SOLID LT (RAMP B)

TEMPORARY AND DURABLE 12" WHITE LINE
 OFF RAMP 0+56 TO 1+05 SOLID RT
 I-91 401+07 TO 402+07 SOLID LT
 GORE STRIPES 401+07 TO 401+57 SOLID LT

BITUMINOUS CONCRETE GUTTERS AND TRAFFIC ISLANDS
 OFF RAMP 1+83 RT (PAVE ONLY) (RAMP B)

DELINEATORS
 REFER TO STANDARDS E-197, E-198
 AND E-199 FOR PLACEMENT GUIDELINES

EXIT 1 - RAMP B SOUTHBOUND OFF RAMP

SEE STANDARDS E-191, E-192 AND E-193
 FOR PAVEMENT MARKING GUIDELINES

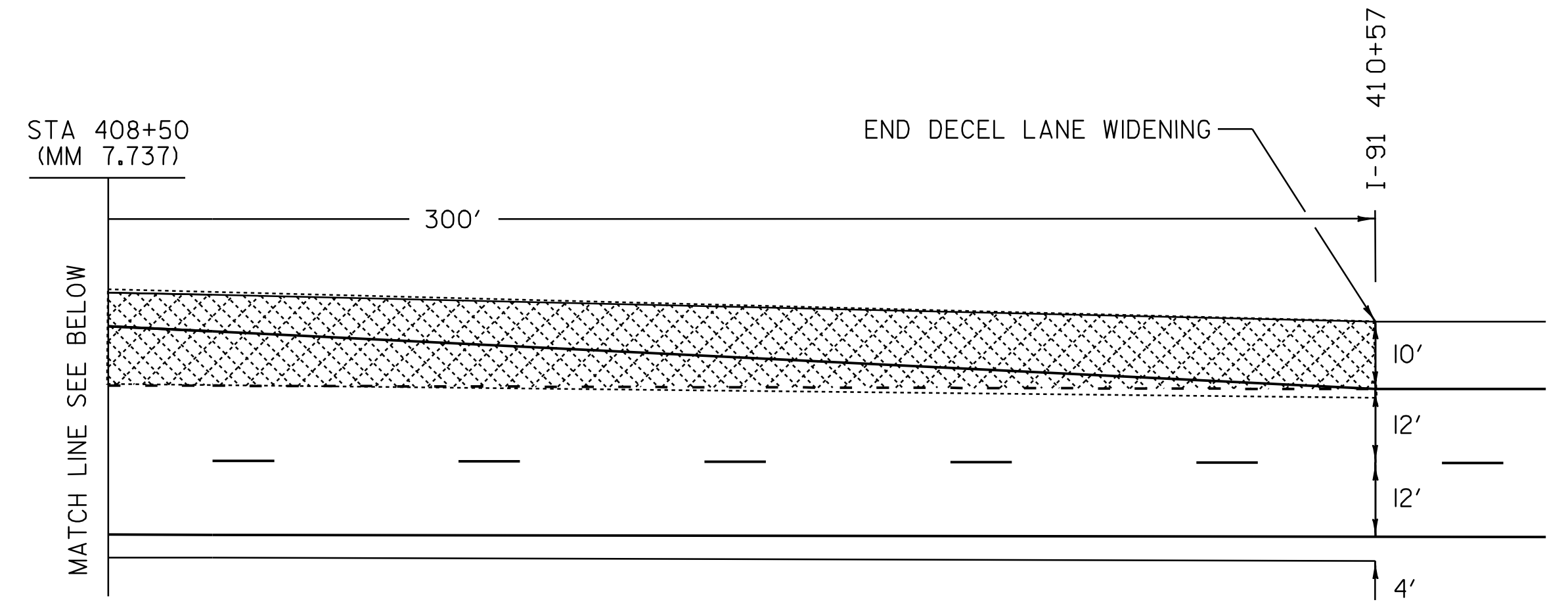

NOTE: REFER TO LANE WIDENING DETAILS ON SHEET 6.

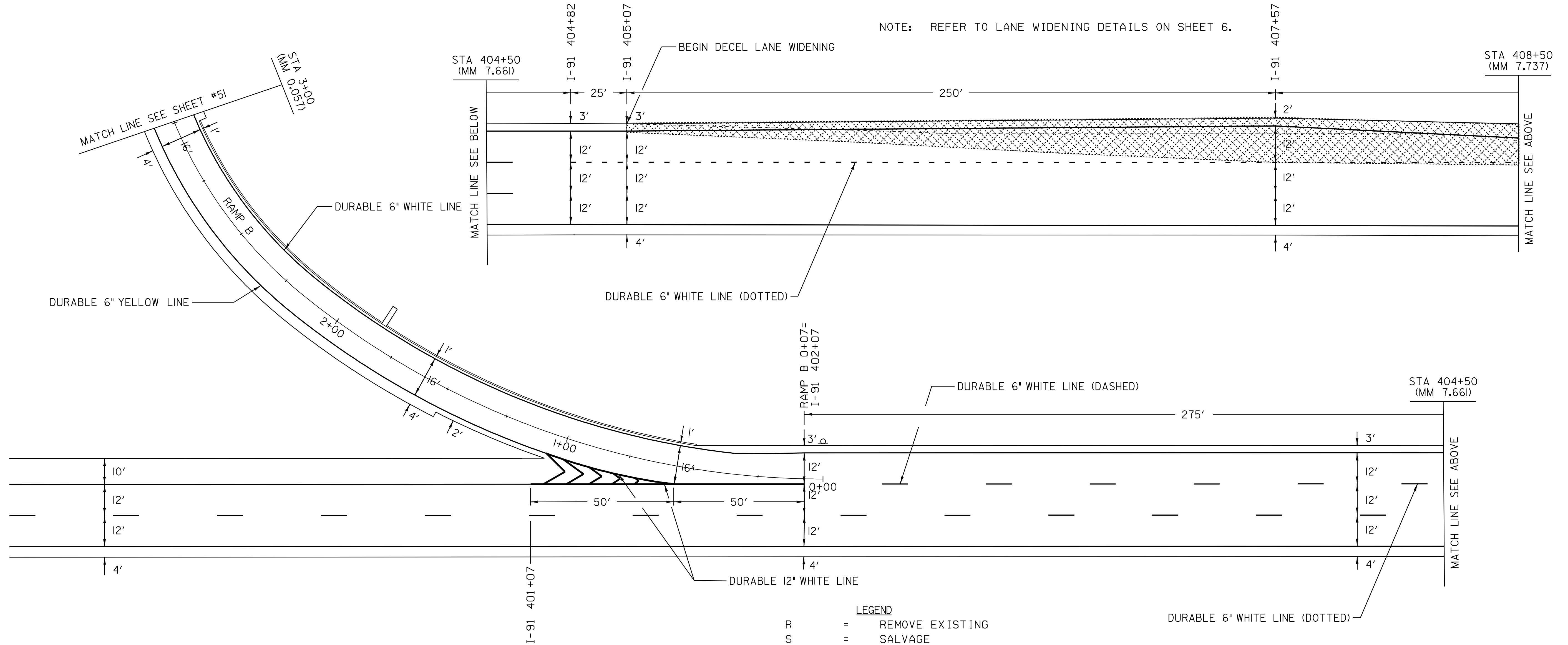

DATUM

VERTICAL	_____
HORIZONTAL	_____

NOT TO SCALE

LEGEND

R	= REMOVE EXISTING
S	= SALVAGE
R & S	= REMOVE AND SALVAGE
N	= NEW
RET	= RETAIN
B-B	= BACK TO BACK
—	= NEW RAIL
- - -	= EXISTING RAIL
▨	= SHADED AREA EXCAVATE 6" / TYPE IS

RAMP DETAIL #7	PROJECT NAME: GUILFORD-BRATTLEBORO
	PROJECT NUMBER: AC IM 091-I(54)
	FILE NAME: 05A014rd07.1
	CLD REF. NO. 05-0387
	PLOT DATE: 22-JAN-2009 13:4
	DRAWN BY: MRS
	CHECKED BY: NLL
	SHEET 53 OF 69