

EXIT 3 - RAMP C NORTHBOUND OFF RAMP

SEE STANDARDS E-191, E-192 AND E-193
FOR PAVEMENT MARKING GUIDELINES

TEMPORARY AND DURABLE 6" WHITE LINE			
OFF RAMP C	1+15 TO 6+61	SOLID	LT
I-91	598+90 TO 602+79	DASHED	RT
I-91	592+00 TO 598+90	DOTTED	RT
TEMPORARY AND DURABLE 6" YELLOW LINE			
OFF RAMP C	1+15 TO 6+61	SOLID	RT
TEMPORARY AND DURABLE 12" WHITE LINE			
ON RAMP C	6+61 TO 8+80	SOLID	RT
GORE STRIPE	6+61 TO 8+80	SOLID	RT
I-91	602+79 TO 604+99	SOLID	RT
REHABING DI, CB OR MH			
OFF RAMP C - 4+54 LT, CLASS III			
OFF RAMP C - 6+05 LT, CLASS I			
OFF RAMP C - 7+55 LT, CLASS I			
OFF RAMP C - 9+04 LT, CLASS I			
BITUMINOUS CONCRETE GUTTERS AND TRAFFIC ISLANDS			
OFF RAMP C - 1+79 LT (PAVE ONLY)			
OFF RAMP C - 3+01 LT (PAVE ONLY)			

REMOVAL & DISP. OF GUARDRAIL			
STA	592+18	TO	600+59 RT
OFF RAMP C	3+60	TO	3+85 LT
STEEL BEAM GUARDRAIL (GALV.)			
OFF RAMP C	3+72.5	TO	3+85 LT
STEEL BEAM GUARDRAIL (GALV.) (MOD.-8' POST)			
STA	592+55.5	TO	600+59 RT
			601+47
TRAILING END TERMINAL (TET)			
OFF RAMP C	3+60	TO	3+72.5 LT
MANUFACTURED TERMINAL SECTION (MTS)			
STA	592+18	TO	592+55.5 RT (FLARED)
DELINEATORS			
REFER TO STANDARDS E-197, E-198, AND E-199 FOR PLACEMENT GUIDELINES			

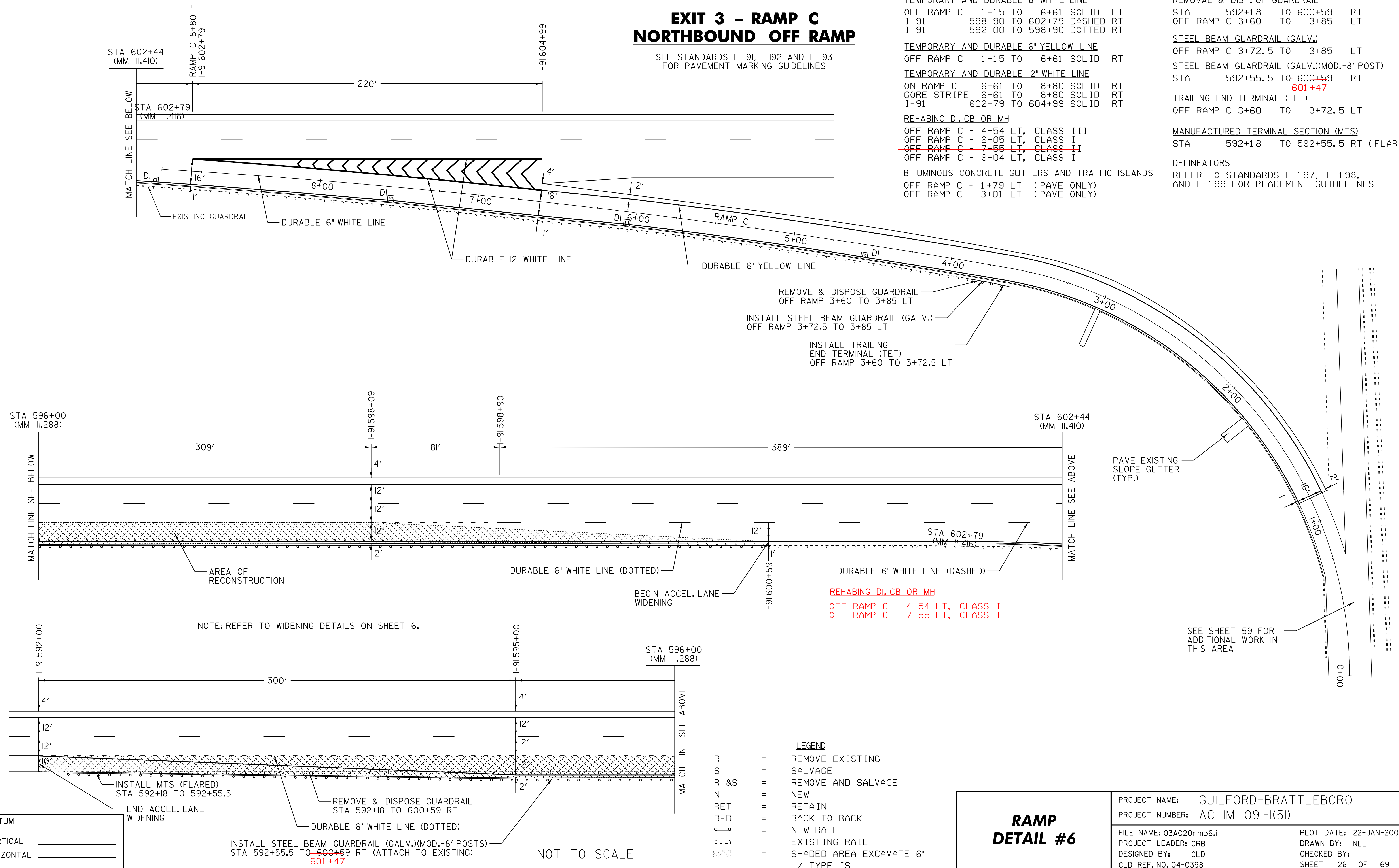

REMOVE & DISPOSE GUARDRAIL
OFF RAMP 3+60 TO 3+85 LT

INSTALL STEEL BEAM GUARDRAIL (GALV.)
OFF RAMP 3+72.5 TO 3+85 LT

INSTALL TRAILING
END TERMINAL (TET)
OFF RAMP 3+60 TO 3+72.5 LT

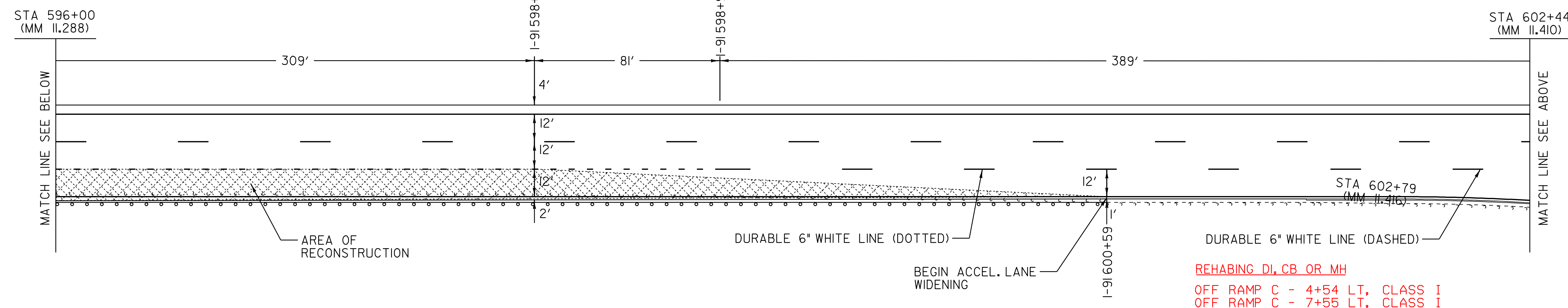

NOTE: REFER TO WIDENING DETAILS ON SHEET 6.

REHABING DI, CB OR MH
OFF RAMP C - 4+54 LT, CLASS I
OFF RAMP C - 7+55 LT, CLASS I

SEE SHEET 59 FOR
ADDITIONAL WORK IN
THIS AREA

LEGEND

R	=	REMOVE EXISTING
S	=	SALVAGE
R & S	=	REMOVE AND SALVAGE
N	=	NEW
RET	=	RETAIN
B-B	=	BACK TO BACK
—	=	NEW RAIL
—	=	EXISTING RAIL
▨	=	SHADED AREA EXCAVATE 6"
/	=	TYPE IS

RAMP DETAIL #6	PROJECT NAME: GUILFORD-BRATTLEBORO	PLOT DATE: 22-JAN-2009 13:3
	PROJECT NUMBER: AC IM 091-1(51)	DRAWN BY: NLL
	FILE NAME: 03A020rmp6.1	CHECKED BY:
	PROJECT LEADER: CRB	CLD REF. NO. 04-0398
	DESIGNED BY: CLD	SHEET 26 OF 69

DATUM

VERTICAL _____

HORIZONTAL _____

INSTALL STEEL BEAM GUARDRAIL (GALV.) (MOD.-8' POSTS)
STA 592+55.5 TO ~~600+59~~ RT (ATTACH TO EXISTING)
601+47

REMOVE & DISPOSE GUARDRAIL
STA 592+18 TO 600+59 RT

DURABLE 6" WHITE LINE (DOTTED)

END ACCEL. LANE WIDENING

INSTALL MTS (FLARED)
STA 592+18 TO 592+55.5

NOT TO SCALE