

**TEMPORARY AND DURABLE 6" WHITE LINE**  
 ON RAMP A 0+00 TO 0+40 SOLID RT ( ISLAND)  
 OFF RAMP B 0+00 TO 11+00 SOLID LT  
 ON RAMP A 0+13 TO 11+00 SOLID RT

**TEMPORARY AND DURABLE 6" YELLOW LINE**  
 ON RAMP A 0+04 TO 0+40 SOLID RT ( ISLAND)  
 ON RAMP A 0+04 TO 11+00 SOLID LT  
 OFF RAMP B 0+04 TO 11+00 SOLID LT

**TEMPORARY AND DURABLE 24" STOP BAR**  
 OFF RAMP B 0+04 LT

**TEMPORARY AND DURABLE LETTER OR SYMBOL**  
 OFF RAMP B 0+12 LT - " STOP" OFF RAMP  
 ON RAMP A 0+26 TO 0+38 RT - YIELD MARKINGS (5)  
 OFF RAMP B 2+88 LT - WRONG WAY ARROW  
 OFF RAMP B 6+04 LT - "AHEAD"  
 OFF RAMP B 6+44 LT - " STOP"

**TEMPORARY AND DURABLE 12" WHITE LINE**  
 ON RAMP A 0+40 TO 0+52 SOLID RT  
 ON RAMP A 0+40 TO 0+52 SOLID RT

## EXIT 2 - RAMPS A & B NORTHBOUND ON & OFF RAMPS

SEE STANDARDS E-191, E-192 AND E-193  
 FOR PAVEMENT MARKING GUIDELINES

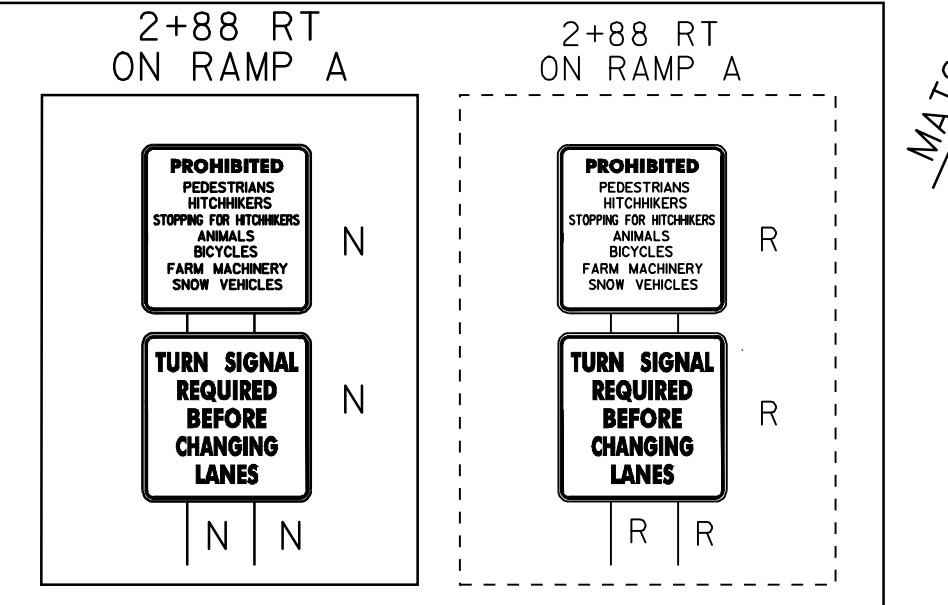
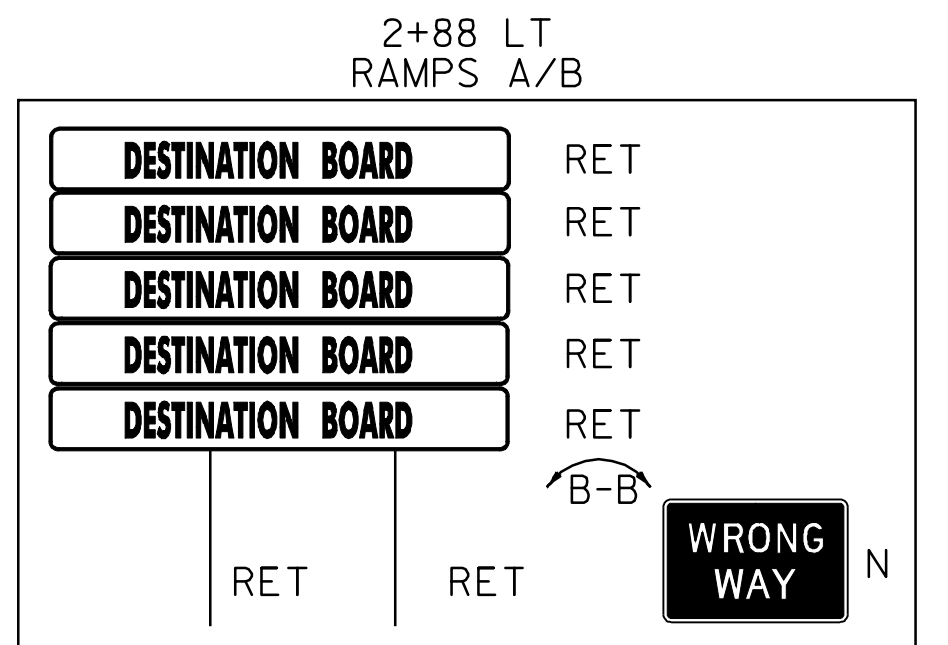
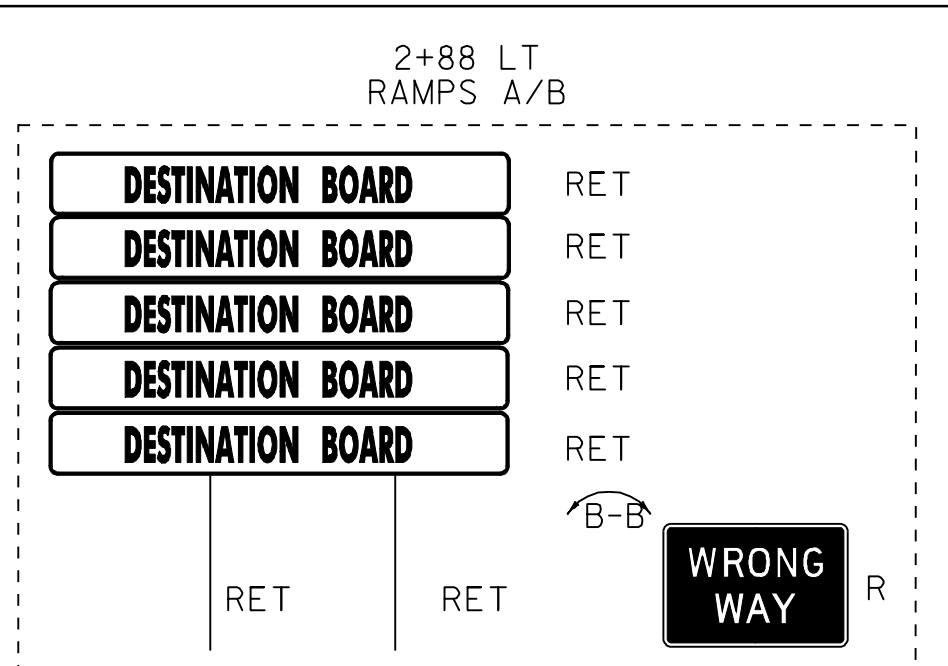
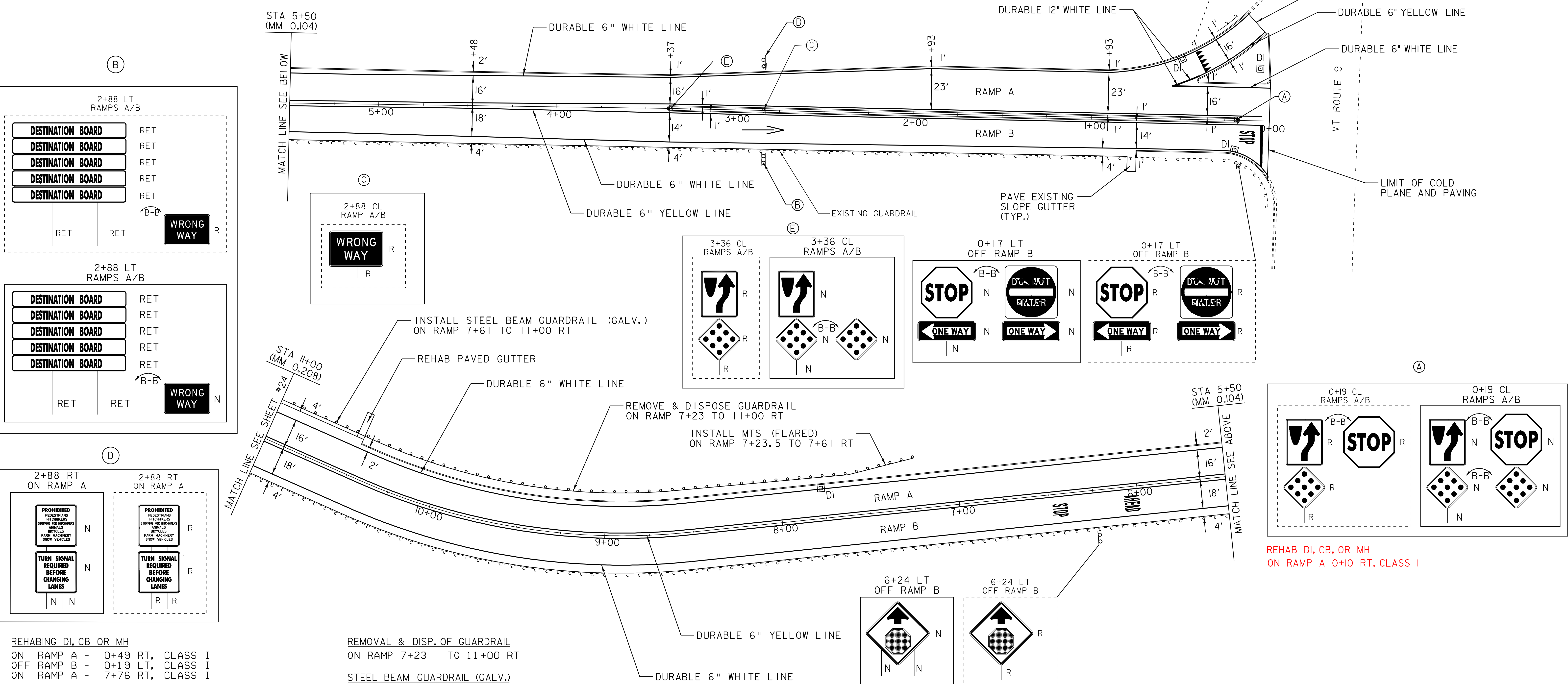

**REHABING DI, CB OR MH**  
 ON RAMP A - 0+49 RT, CLASS I  
 OFF RAMP B - 0+19 LT, CLASS I  
 ON RAMP A - 7+76 RT, CLASS I

**BITUMINOUS CONCRETE GUTTERS AND TRAFFIC ISLANDS**  
 OFF RAMP B - 0+77 LT (PAVE ONLY)  
 ON RAMP A - 10+51 RT (REHAB)

**PAINTED CURB**  
 ON RAMP A 0+00 TO 0+31 RT  
 ON RAMP A 0+13 TO 0+43 RT  
 OFF RAMP B 0+13 TO 0+43 LT  
 ON RAMP A 3+05 TO 3+35 RT  
 OFF RAMP B 3+05 TO 3+35 LT

**REMOVAL & DISP. OF GUARDRAIL**  
 ON RAMP 7+23 TO 11+00 RT

**STEEL BEAM GUARDRAIL (GALV.)**  
 ON RAMP 7+61 TO 11+00 RT

**MANUFACTURED TERMINAL SECTION (MTS)**  
 ON RAMP 7+23.5 TO 7+61 RT (FLARED)

**DELINEATORS**  
 REFER TO STANDARDS E-197, E-198,  
 AND E-199 FOR PLACEMENT GUIDELINES

**REMOVING SIGNS**  
 AS SHOWN - 14

**LEGEND**

R	= REMOVE EXISTING
S	= SALVAGE
R & S	= REMOVE AND SALVAGE
N	= NEW
RET	= RETAIN
B-B	= BACK TO BACK
—	= NEW RAIL
—	= EXISTING RAIL

**RAMP  
 DETAIL #3**

PROJECT NAME:	GUILFORD-BRATTLEBORO
PROJECT NUMBER:	AC IM 091-1(51)
FILE NAME:	03A020rmp3.1
PROJECT LEADER:	CRB
DESIGNED BY:	CLD
CLD REF. NO.	04-0398
PLOT DATE:	22-JAN-2009 13:3
DRAWN BY:	JCS
CHECKED BY:	NLL
SHEET	23 OF 69

NOT TO SCALE