

TEMPORARY AND DURABLE 6" WHITE LINE
 OFF RAMP E 0+00 TO 0+17 SOLID RT (ISLAND)
 OFF RAMP E 0+00 TO 9+13 SOLID LT
 I-91 383+12 TO 385+54 DOTTED RT

TEMPORARY AND DURABLE 6" YELLOW LINE
 OFF RAMP E 0+00 TO 0+17 SOLID LT
 OFF RAMP E 0+28 TO 9+14 SOLID RT

TEMPORARY AND DURABLE 12" WHITE LINE
 OFF RAMP E 0+17 TO 0+27 SOLID LT
 OFF RAMP E 0+17 TO 0+27 SOLID LT
 OFF RAMP E 9+14 TO 10+53 SOLID RT
 GORE STRIPES 9+14 TO 10+53 SOLID RT
 I-91 385+54 TO 386+94 SOLID LT

TEMPORARY AND DURABLE LETTER OR SYMBOL
 OFF RAMP E 0+14 LT - "STOP"
 OFF RAMP E 0+30 RT - "STOP"
 OFF RAMP E 2+58 CL - WRONG WAY ARROW
 OFF RAMP E 7+12 CL - "AHEAD"
 OFF RAMP E 7+52 CL - "STOP"

TEMPORARY AND DURABLE 24" STOP BAR
 OFF RAMP E 0+02 TO 0+06 LT
 OFF RAMP E 0+12 TO 0+25 RT

REHABING DI, CB OR MH
 OFF RAMP E - 0+40 RT, CLASS I

BITUMINOUS CONCRETE GUTTERS AND TRAFFIC ISLANDS
 OFF RAMP E 1+52 RT (PAVE ONLY)
 OFF RAMP E 2+52 RT (PAVE ONLY)
 OFF RAMP E 3+52 RT (PAVE ONLY)
 OFF RAMP E 4+63 RT (PAVE ONLY)

REMOVAL & DISP. OF GUARDRAIL
 OFF RAMP E 0+20 TO 0+45 LT
 OFF RAMP E 1+13 TO 5+39 RT

STEEL BEAM GUARDRAIL (GALV.)
 OFF RAMP E 0+32.5 TO 0+45 LT
 OFF RAMP E 1+26 TO 5+01 RT

TRAILING END TERMINAL (TET)
 OFF RAMP E 0+20 TO 0+32.5 LT
 OFF RAMP E 1+13.5 TO 1+26 RT

MANUFACTURED TERMINAL SECTION (MTS)
 OFF RAMP 5+01 TO 5+38.5 RT (FLARED)

DELINEATORS
 REFER TO STANDARDS E-197, E-198, AND E-199 FOR PLACEMENT GUIDELINES

REMOVING SIGNS
 AS SHOWN - 11

EXIT 1 - RAMP E NORTHBOUND OFF RAMP

SEE STANDARDS E-191, E-192 AND E-193 FOR PAVEMENT MARKING GUIDELINES

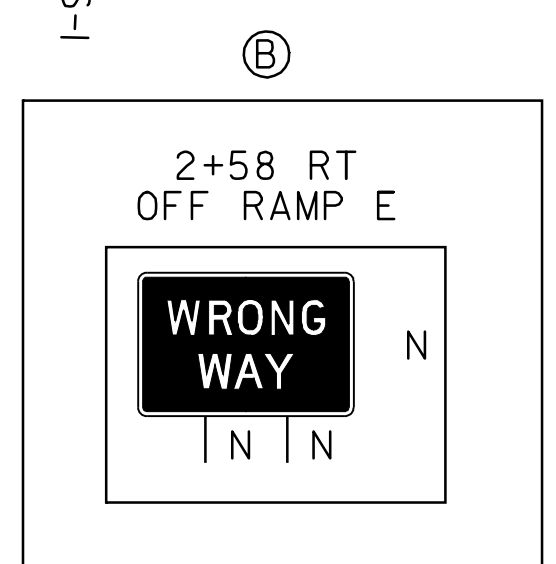
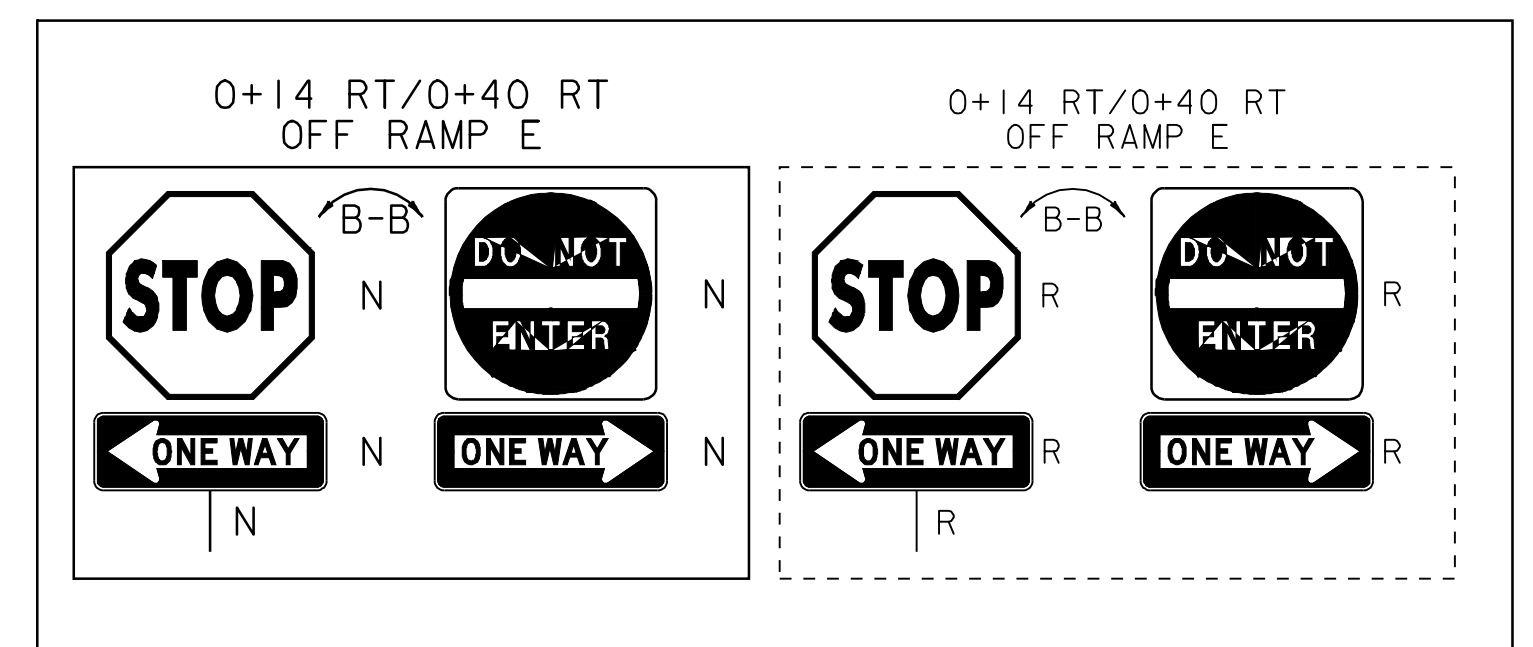
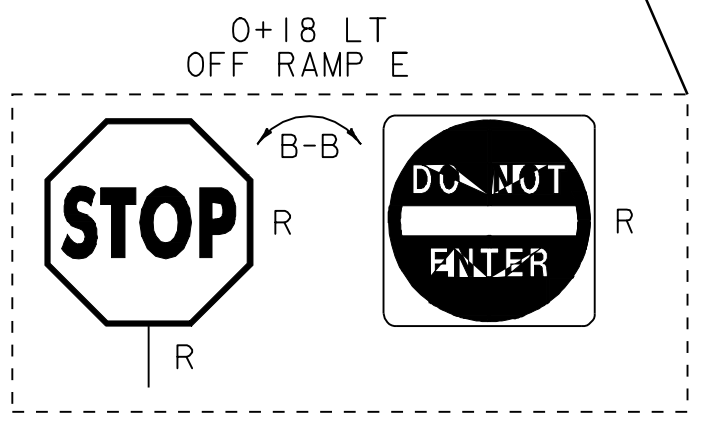
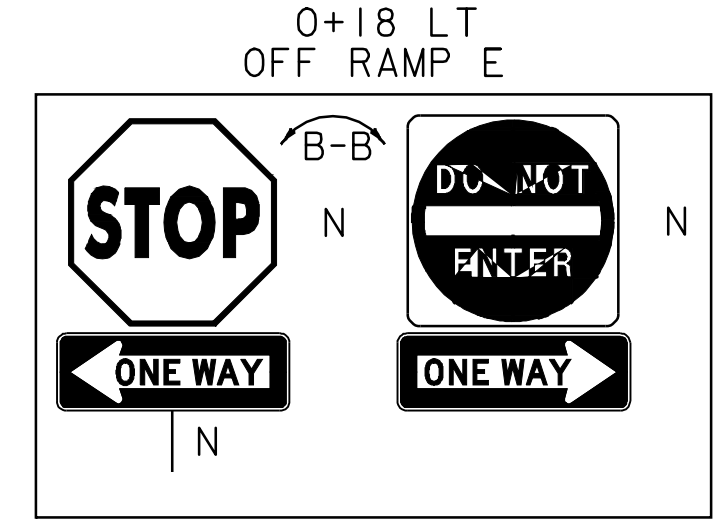
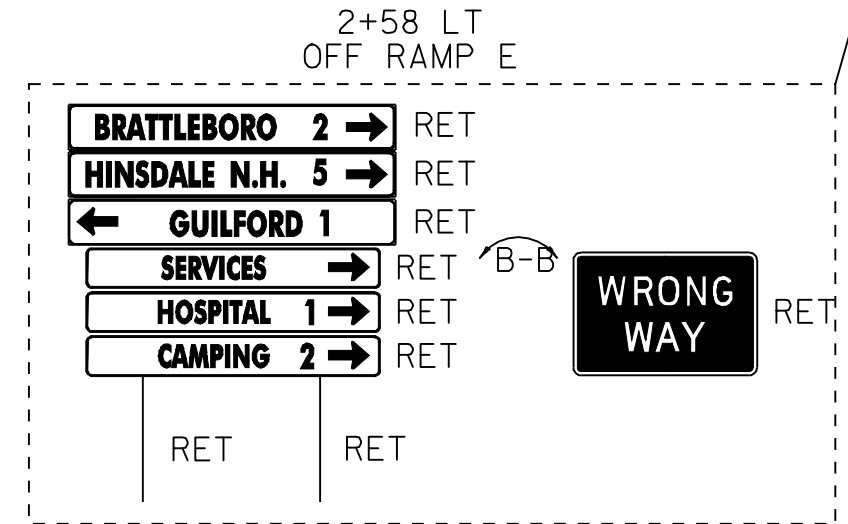
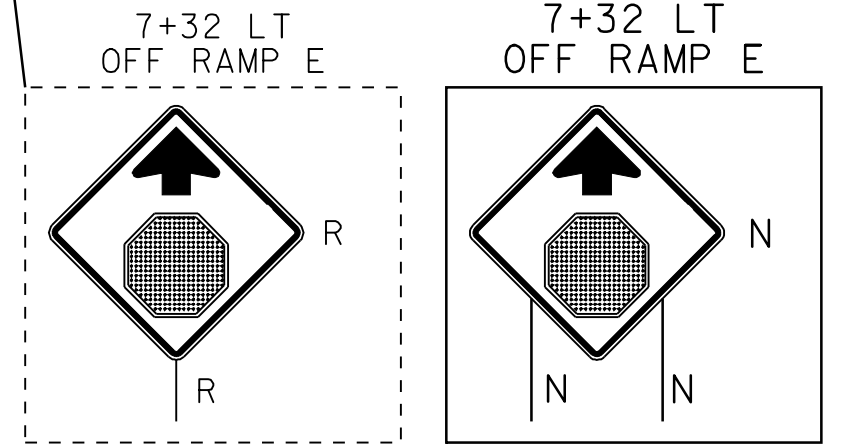
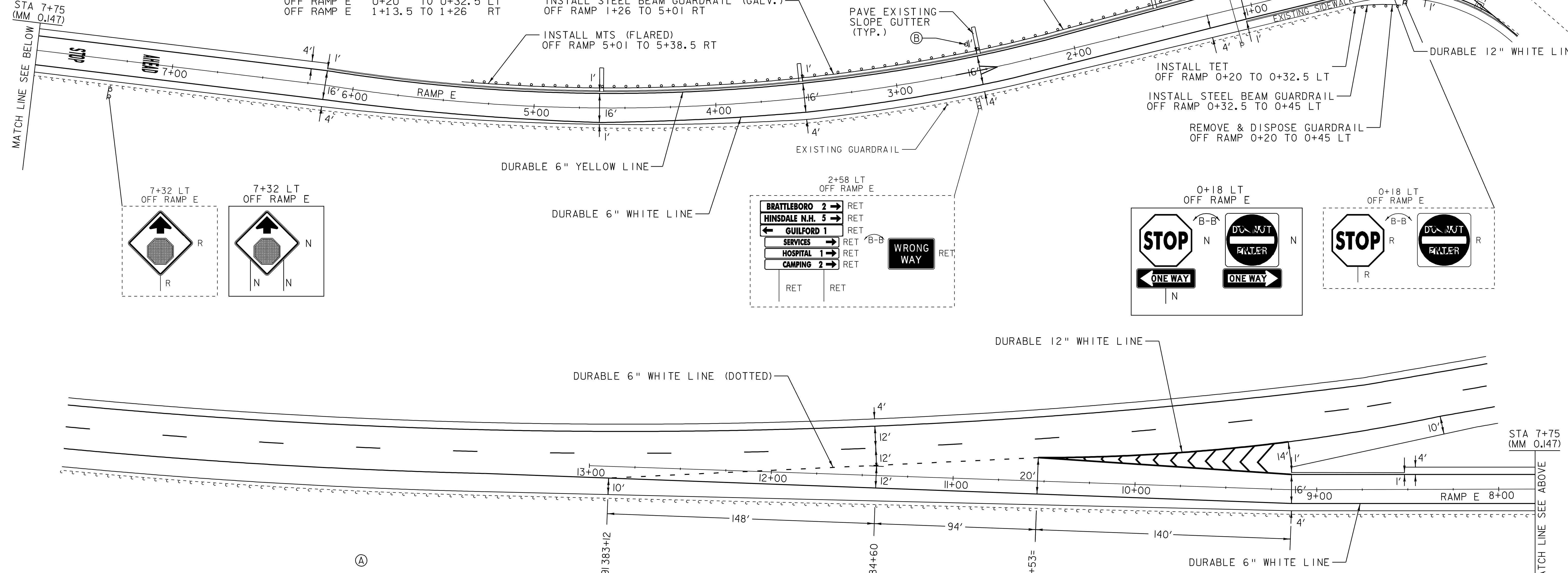

- LEGEND**
- R = REMOVE EXISTING
 - S = SALVAGE
 - R & S = REMOVE AND SALVAGE
 - N = NEW
 - RET = RETAIN
 - B-B = BACK TO BACK
 - = NEW RAIL
 - = EXISTING RAIL

RAMP DETAIL #1	PROJECT NAME: GUILFORD-BRATTLEBORO	PLOT DATE: 22-JAN-2009 13:3
	PROJECT NUMBER: AC IM 091-K(51)	DRAWN BY: JCS
	FILE NAME: 03A020rmp1.i	CHECKED BY: NLL
	PROJECT LEADER: CRB	CLD REF. NO. 04-0398

DATUM _____
 VERTICAL _____
 HORIZONTAL _____

NOT TO SCALE