

NOTES:
 1. THIS EPSC PLAN IS INTENDED TO BE A DYNAMIC PLAN. AS CONDITIONS CHANGE, THE EPSC PLAN WILL BE AMENDED AS NECESSARY AS EROSION CONTROL INSPECTORS DICTATE.

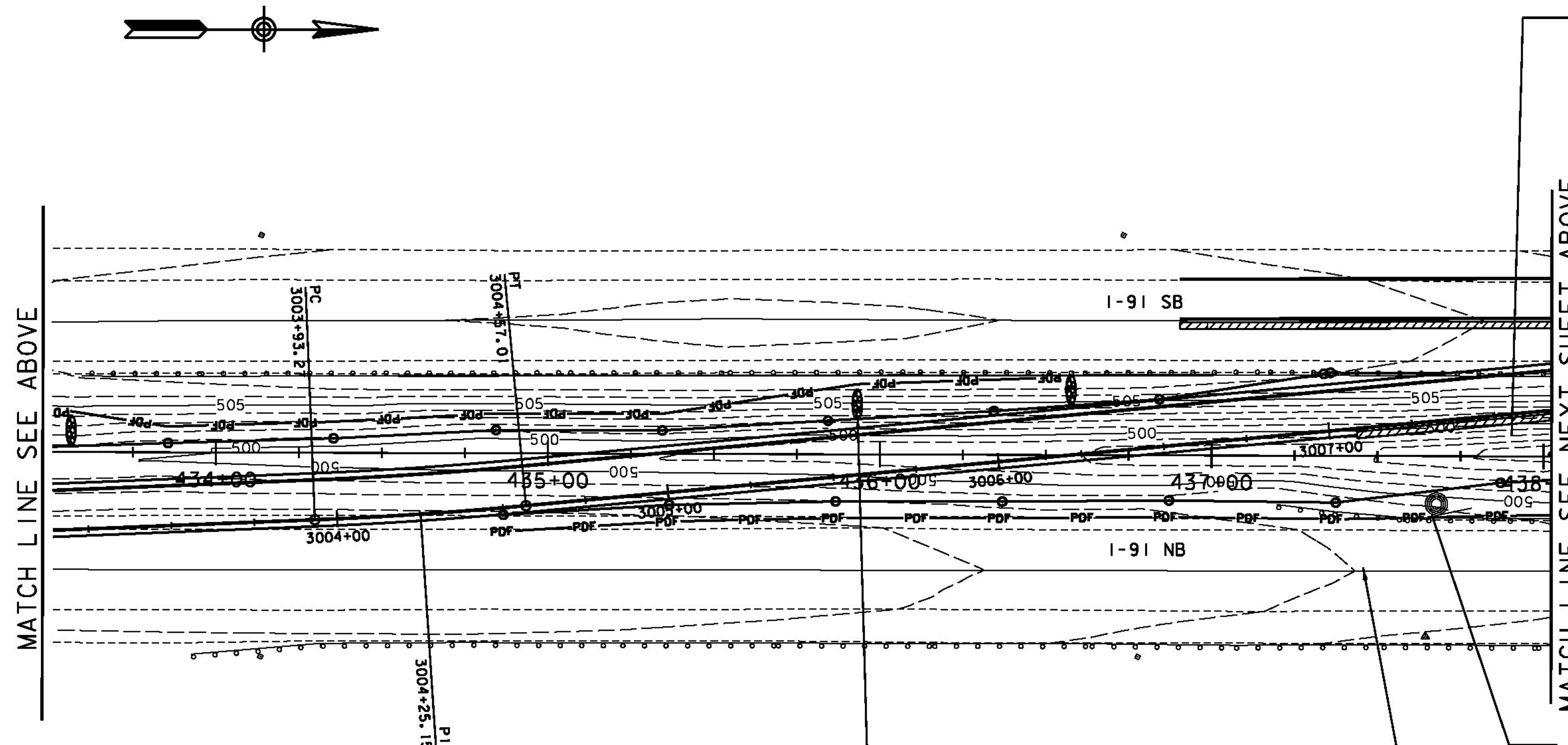
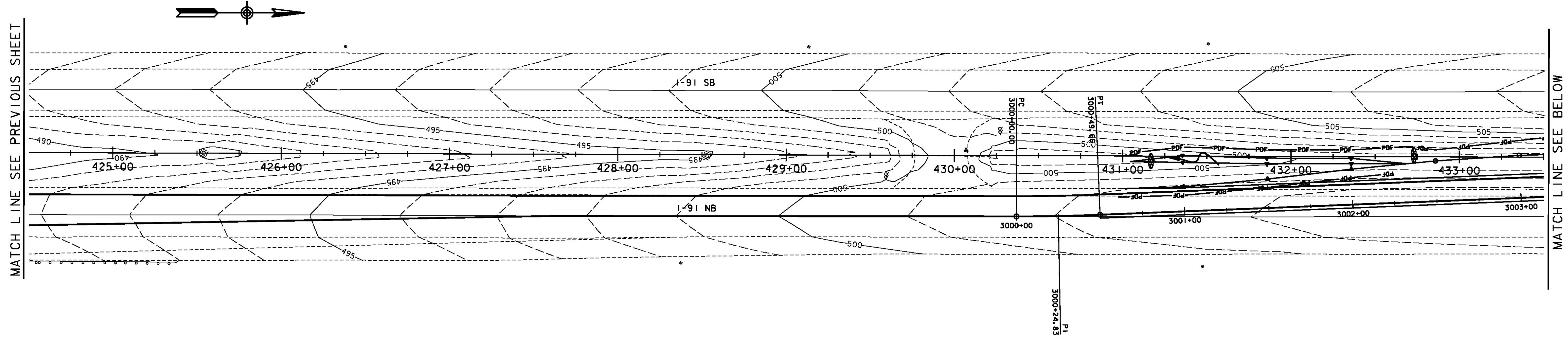

STABILIZE EXPOSED SLOPES ASSOCIATED WITH CROSSOVER CONSTRUCTION WITH WOOD CHIP MULCH OR TEMPORARY SEEDING IF THE SEASON ALLOWS

PROPOSED STONE CHECK DAM (TYP)

PROPOSED TEMPORARY CHANNEL MATTING (NORTH AMERICAN GREEN SC 150 BN OR APPROVED EQUAL (TYP))

REFER TO SHEET 11 FOR EPSC MEASURES TO BE IMPLEMENTED DURING BRIDGE 5N CONSTRUCTION

LEGEND

- DIRECTION OF TRAVEL
- BRIDGE CONSTRUCTION ZONE
- SILT FENCE
- CONCRETE BARRIER
- STONE AND BLOCK DROP INLET PROTECTION
- ROLLED EROSION CONTROL PRODUCT SIDE SLOPE
- PIPE INLET PROTECTION
- BARRIER FENCE (WITHIN 100 FT OF WATER RESOURCE)
- PROJECT DEMARCATION FENCE
- STONE CHECK DAM

AS BUILT RECORD PLANS

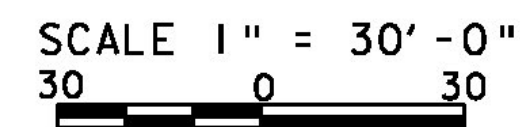

**RFC WORK PACKAGE #1C
03/18/2011**

BECK & BELLUCCI, INC. TYLIN INTERNATIONAL

PROJECT NAME: I-91 BRIDGE IMPROVEMENTS	
PROJECT NUMBER: BRATTLEBORO AC IM 091-I(50)	
FILE NAME: EPSC 10.DGN	PLOT DATE: 3/18/2011
PROJECT LEADER: Brian W. Clogston P.E.	DRAWN BY: Brian Waehler
DESIGNED BY: Brian Waehler P.E.	CHECKED BY: John St. John
EPSC PLAN PHASE I - TEMPORARY CONDITIONS SHEET 10 OF 20	