

SECTION THRU ABUTMENT DIAPHRAGM

DIMENSIONS NORMAL TO ABUTMENT UNLESS OTHERWISE NOTED
 * DIMENSION ALONG CENTERLINE OF BEAM

NOTES:

- SHEAR KEY DETAIL IS TO BE INSTALLED AT THE ABUTMENTS AND PIERS BETWEEN BEAMS 1 & 2 AND BEAMS 3 & 4.
- A401 & A402 BARS TO BE PLACED IN CONCRETE PADS AT ABUTMENTS. MAX SPACING SHALL BE 6" AND BARS SHALL BE CENTERED ON CENTERLINE OF BEARING.

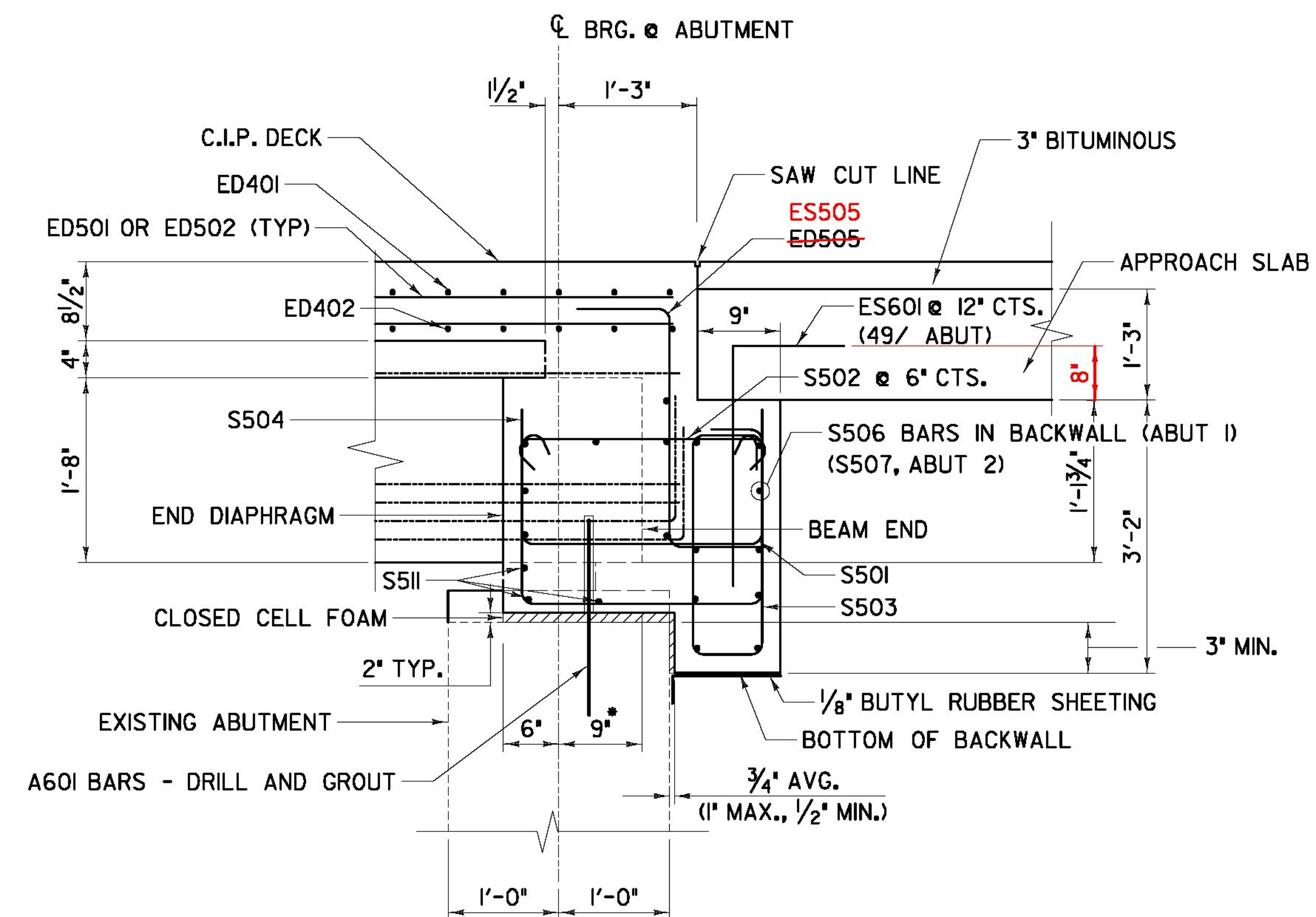

SECTION THRU ABUTMENT DIAPHRAGM AT SHEAR KEY

DIMENSIONS NORMAL TO ABUTMENT UNLESS OTHERWISE NOTED
 * DIMENSION ALONG CENTERLINE OF BEAM

AS BUILT
 RECORD PLANS

PROJECT NAME: BRATTLEBORO

PROJECT NUMBER: IM 091-1(50)

BECK & BELLUCCI, INC.

TYLIN INTERNATIONAL

FILE NAME: ZB-100-BR5-403.dgn

PLOT DATE: 5/15/2013

PROJECT LEADER: Phillip E. Kendall P.E.

DRAWN BY: W. Roberts

DESIGNED BY: Richard Bollinger P.E.

CHECKED BY: J. E. Krajewski

ABUTMENT DIAPHRAGM DETAILS

SHEET ZB-100-BR5-403