

BRIDGE 5N SUPERSTRUCTURE LAYOUT PLAN

SCALE: 1/16" = 1'-0"

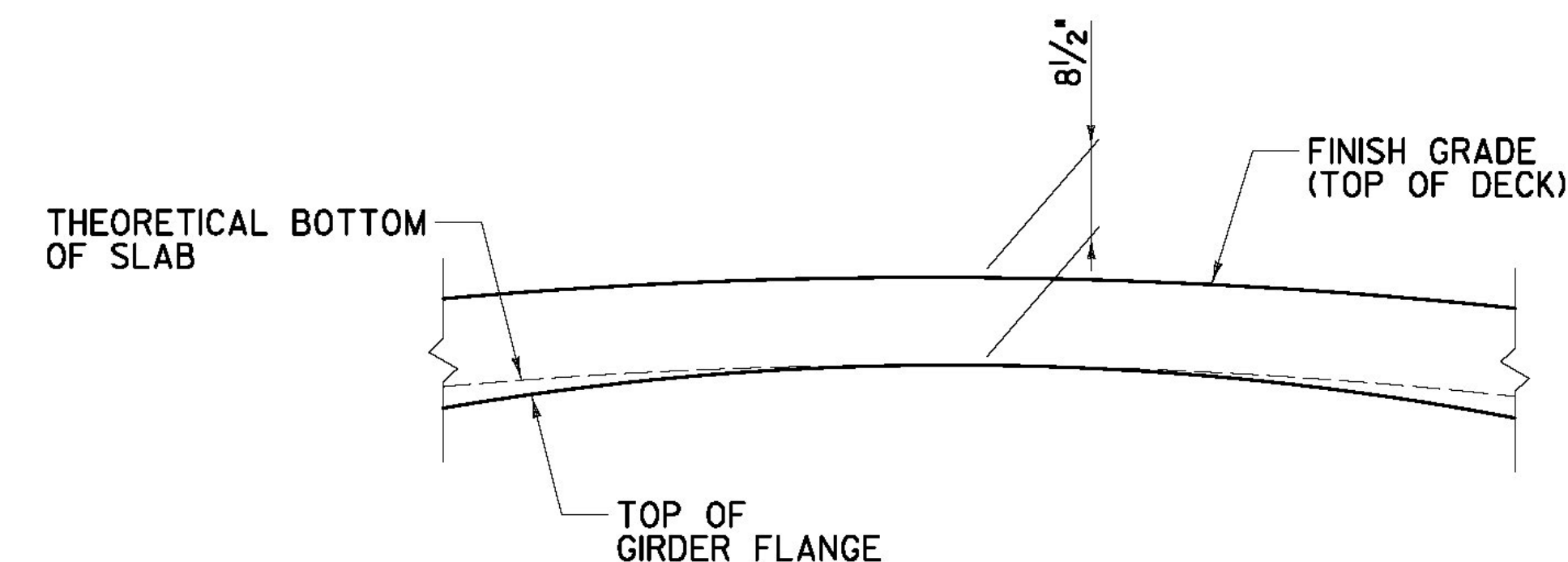

B.O.S. LOCATION DIAGRAM - ELEVATION

N.T.S.

THEORETICAL BOTTOM OF SLAB ELEVATIONS, PRIOR TO CASTING DECK

|          |            | SPAN 1              |        |        |        | SPAN 2         |                |        |        |        | SPAN 3         |                |        |        |        |                     |
|----------|------------|---------------------|--------|--------|--------|----------------|----------------|--------|--------|--------|----------------|----------------|--------|--------|--------|---------------------|
|          |            | CL BRG. ABUT. NO. 1 | 0.25 L | 0.50 L | 0.75 L | CL BRG. PIER 1 | CL BRG. PIER 1 | 0.25 L | 0.50 L | 0.75 L | CL BRG. PIER 2 | CL BRG. PIER 2 | 0.25 L | 0.50 L | 0.75 L | CL BRG. ABUT. NO. 2 |
| GIRDER 1 | LEFT EDGE  | 495.21              | 495.00 | 494.76 | 494.50 | 494.22         | 494.16         | 493.93 | 493.67 | 493.40 | 493.10         | 493.03         | 492.80 | 492.56 | 492.29 | 492.02              |
|          | RIGHT EDGE | 495.85              | 495.64 | 495.40 | 495.14 | 494.86         | 494.81         | 494.58 | 494.32 | 494.05 | 493.75         | 493.69         | 493.46 | 493.22 | 492.95 | 492.68              |
| GIRDER 2 | LEFT EDGE  | 495.91              | 495.70 | 495.47 | 495.21 | 494.93         | 494.87         | 494.64 | 494.39 | 494.11 | 493.82         | 493.76         | 493.52 | 493.28 | 493.02 | 492.75              |
|          | RIGHT EDGE | 496.55              | 496.34 | 496.11 | 495.85 | 495.57         | 495.52         | 495.29 | 495.04 | 494.76 | 494.47         | 494.41         | 494.18 | 493.94 | 493.68 | 493.41              |
| GIRDER 3 | LEFT EDGE  | 496.61              | 496.40 | 496.17 | 495.91 | 495.63         | 495.58         | 495.35 | 495.10 | 494.83 | 494.53         | 494.48         | 494.24 | 494.00 | 493.74 | 493.47              |
|          | RIGHT EDGE | 497.25              | 497.04 | 496.81 | 496.55 | 496.28         | 496.23         | 496.00 | 495.75 | 495.48 | 495.18         | 495.13         | 494.90 | 494.66 | 494.40 | 494.13              |
| GIRDER 4 | LEFT EDGE  | 497.31              | 497.10 | 496.87 | 496.62 | 496.34         | 496.29         | 496.07 | 495.82 | 495.54 | 495.25         | 495.20         | 494.97 | 494.73 | 494.47 | 494.20              |
|          | RIGHT EDGE | 497.95              | 497.74 | 497.51 | 497.26 | 496.98         | 496.94         | 496.71 | 496.46 | 496.19 | 495.90         | 495.85         | 495.62 | 495.38 | 495.13 | 494.86              |

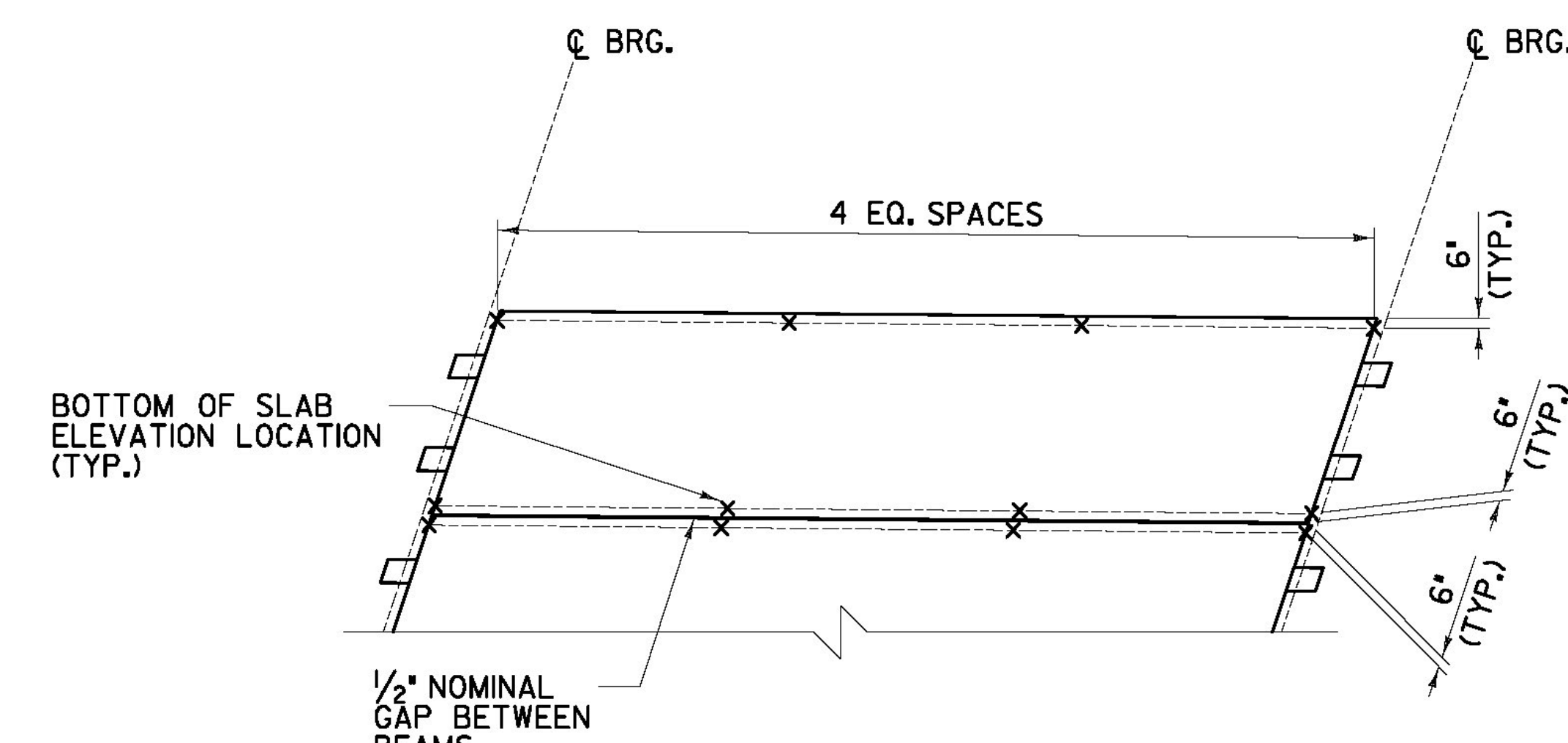

B.O.S. LOCATION DIAGRAM - PLAN

N.T.S.

OVERHANG LENGTHS, MEASURED NORMAL TO THE EDGE OF ADJACENT GIRDER, BETWEEN C.B.R.G.'S

|                | SPAN 1 - 1/4 POINT VALUES |        |         |         | SPAN 2 - 1/4 POINT VALUES |                |        |         |         | SPAN 3 - 1/4 POINT VALUES |                |         |         |         |                     |
|----------------|---------------------------|--------|---------|---------|---------------------------|----------------|--------|---------|---------|---------------------------|----------------|---------|---------|---------|---------------------|
|                | CL BRG. ABUT. NO. 1       | 0.25 L | 0.50 L  | 0.75 L  | CL BRG. PIER 1            | CL BRG. PIER 1 | 0.25 L | 0.50 L  | 0.75 L  | CL BRG. PIER 2            | CL BRG. PIER 2 | 0.25 L  | 0.50 L  | 0.75 L  | CL BRG. ABUT. NO. 2 |
| LEFT OVERHANG  | 5 1/16"                   | 5/8"   | 5/8"    | 5 1/16" | 6 7/8"                    | 5 5/8"         | 5/8"   | 5/8"    | 5 3/4"  | 6 15/16"                  | 5 1/16"        | 5 5/16" | 5 3/8"  | 5 7/8"  | 6 7/8"              |
| RIGHT OVERHANG | 5 5/16"                   | 6 1/2" | 7 3/16" | 7 5/16" | 6 15/16"                  | 5 5/16"        | 6 1/2" | 7 3/16" | 7 5/16" | 6 7/8"                    | 5 1/4"         | 6 5/16" | 6 5/16" | 7 1/16" | 6 15/16"            |

NOTES:

1. MINIMUM DECK THICKNESS SHALL BE 8 1/2", REGARDLESS OF ACTUAL GIRDER CAMBER.

| REVISION # | DESCRIPTION | DATE     |
|------------|-------------|----------|
| REVISION 1 | NEW SHEET   | 09/21/11 |

RFC PLANS - WORK PACKAGE #7  
BRIDGE 5N  
SEPTEMBER 21, 2011

PROJECT NAME: BRATTLEBORO  
PROJECT NUMBER: IM 091-(K50)

AS BUILT  
RECORD PLANS

BECK & BELLUCCI, INC.

TYLIN INTERNATIONAL

FILE NAME: ZB-100-BR5-402A.dgn  
PROJECT LEADER: Brian W. Clogston P.E.  
DESIGNED BY: Josh Olund P.E.  
5N SUPERSTRUCTURE GEOMETRY

PLOT DATE: 9/21/2011  
DRAWN BY: S. A. Morgan  
CHECKED BY: J. E. Krajewski  
SHEET ZB-100-BR5-402A