

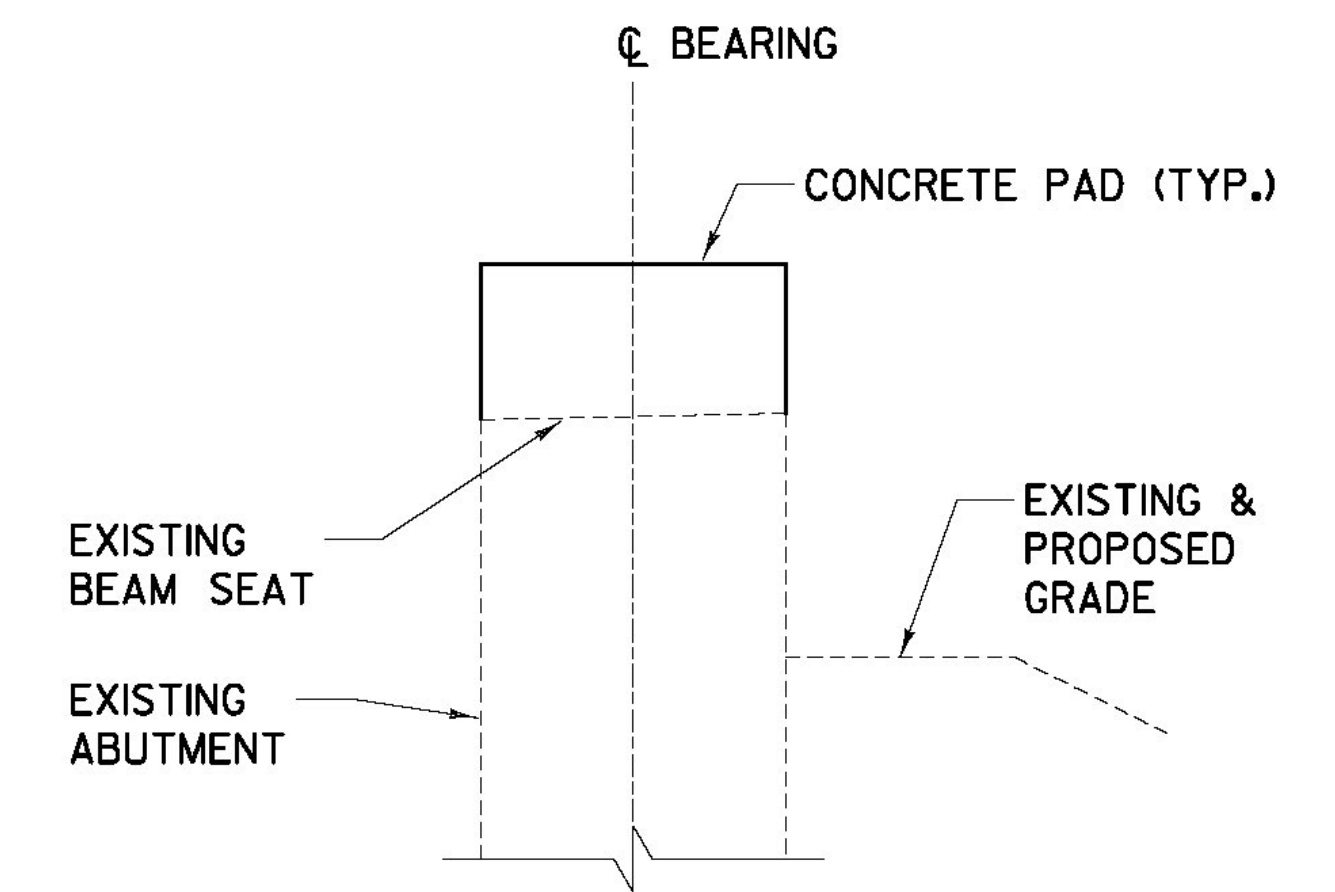

	STATION	OFFSET	E	N
WORK POINT 4	342+00.46	0.00	1,620,803.81	125,639.34
WINGWALL 3-WORK POINT 1 (WW3-WP1)	342+06.47	19.65 LT	1,620,783.87	125,634.41
WINGWALL 3-WORK POINT 2 (WW3-WP2)	342+15.03	19.65 LT	1,620,779.50	125,641.70
WINGWALL 4-WORK POINT 1 (WW4-WP1)	341+90.17	25.65 RT	1,620,831.15	125,643.53
WINGWALL 4-WORK POINT 2 (WW4-WP2)	342+11.97	25.65 RT	1,620,819.89	125,662.43

NOTES:
1. SEE 'ABUTMENT #1 PLAN & ELEVATION' SHEET FOR NOTES.

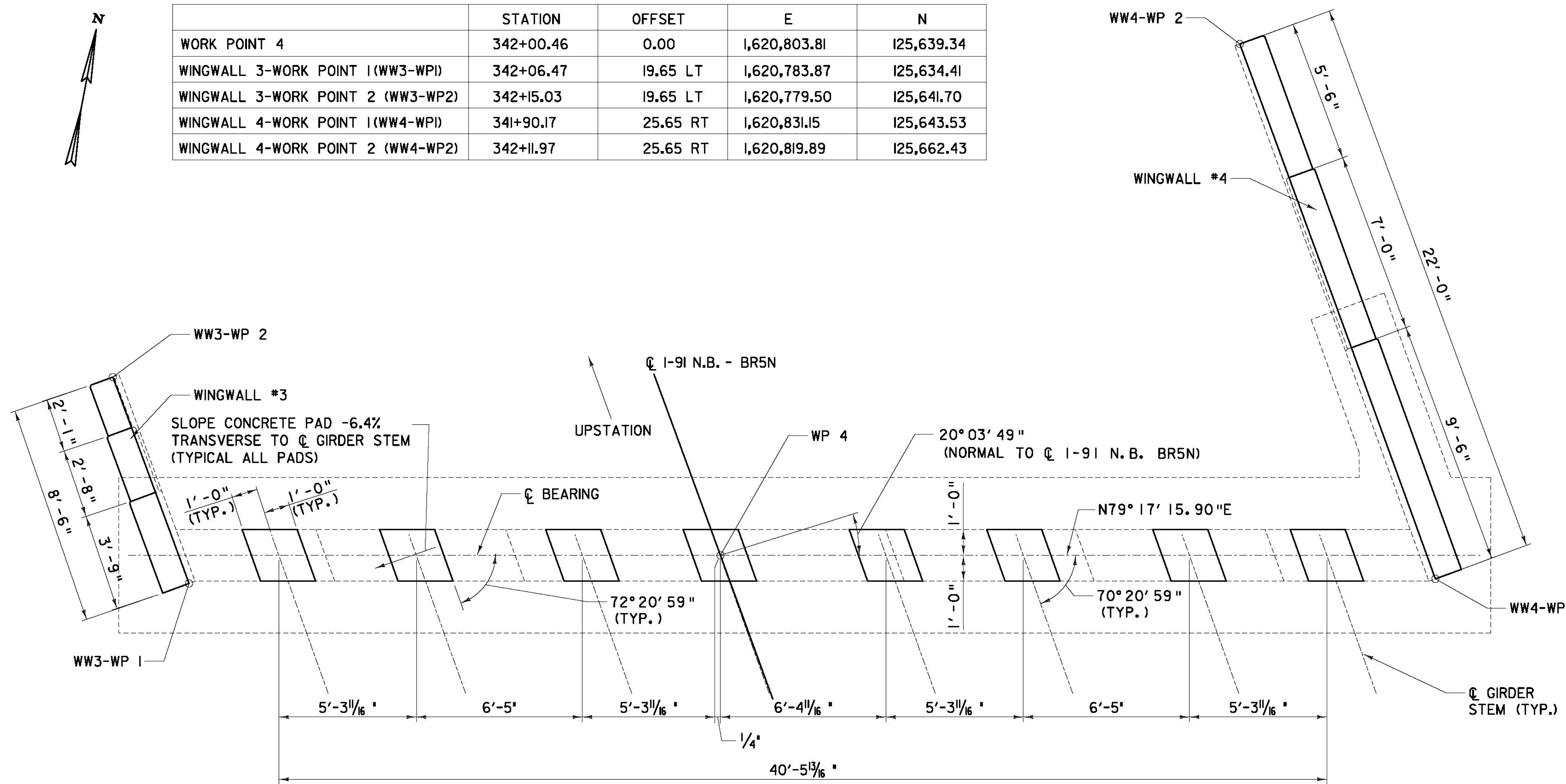

ABUTMENT #2 PLAN
SCALE: 3/8" = 1'-0"

SECTION A-A
SCALE: 3/4" = 1'-0"

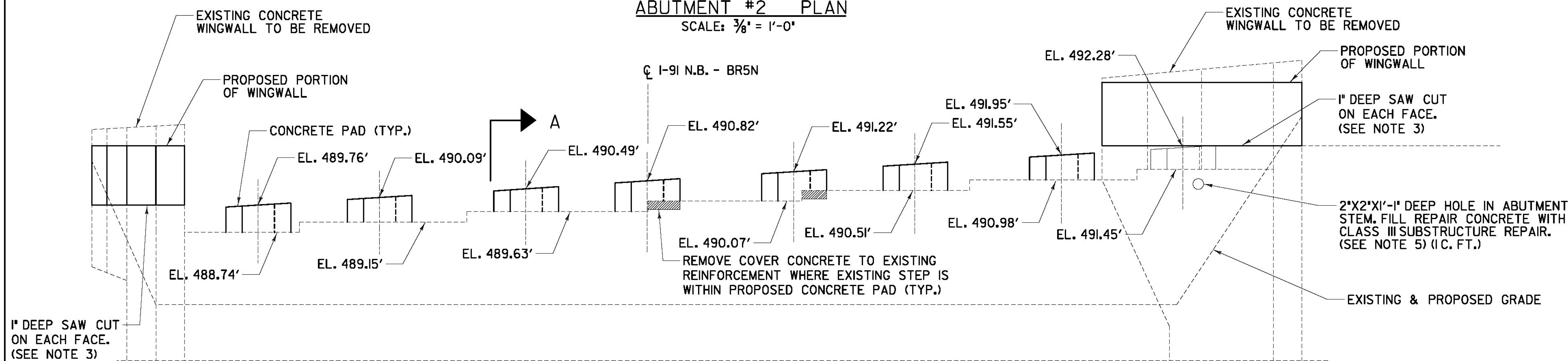

1" DEEP SAW CUT ON EACH FACE. (SEE NOTE 3)

NOTE:
EXISTING ABUTMENT PILES NOT SHOWN FOR CLARITY.

ABUTMENT #2 ELEVATION
SCALE: 3/8" = 1'-0"

AS BUILT
RECORD PLANS

RFC PLANS - WORK PACKAGE #7
BRIDGE 5N
SEPTEMBER 21, 2011

BECK & BELLUCCI, INC.

TYLIN INTERNATIONAL

PROJECT NAME: BRATTLEBORO

PROJECT NUMBER: IM 091-(K50)

FILE NAME: ZB-100-BR5-303.dgn

PROJECT LEADER: Brian W. Clogston P.E.

DESIGNED BY: RICHARD BOLLINGER P.E.

ABUTMENT #2 PLAN & ELEVATION

PLOT DATE: 9/21/2011

DRAWN BY: S. A. Morgan

CHECKED BY: J. E. Krajewski

SHEET ZB-100-BR5-303