

ONE - GIRDER - 207G3B

FOR FIELD SPLICE STANDARD DETAILS SEE DRAWINGS X201 & X202.
 FOR GIRDER STANDARD DETAILS SEE DRAWING X205.
 FOR CAMBER & FLANGE DIAGRAMS SEE DRAWING C202.
 FOR GENERAL NOTES SEE DRAWING G01.
 T2 DENOTES MATERIAL SUBJECT TO CHARPY V-NOTCH TESTING.

JOB NO.		DRAWING NO.		REV.
479		207		△
ROW INFO	SHOP	BILL OF MATERIAL		
PAGE LINE	MARK	QTY	MATERIAL	REMARKS
	207G3B	1	GIRDER	
203	L	1	wa	PL 5/8x93
203	Q	1	wb	PL 5/8x93
204	A	1	tw	PL 2x15 1/2
204	J	1	tb	PL 1 1/2x15 1/2
201	R	1	ba	PL 2x18
201	Q	1	bc	PL 2x18
202	C	1	bb	PL 1 1/2x18
208	E	6	x205a	PL 1 1/2x7 1/4
208	Q	6	x205af	PL 1 1/2x7 1/4
208	E	6	x205n	PL 1 1/2x7 1/4

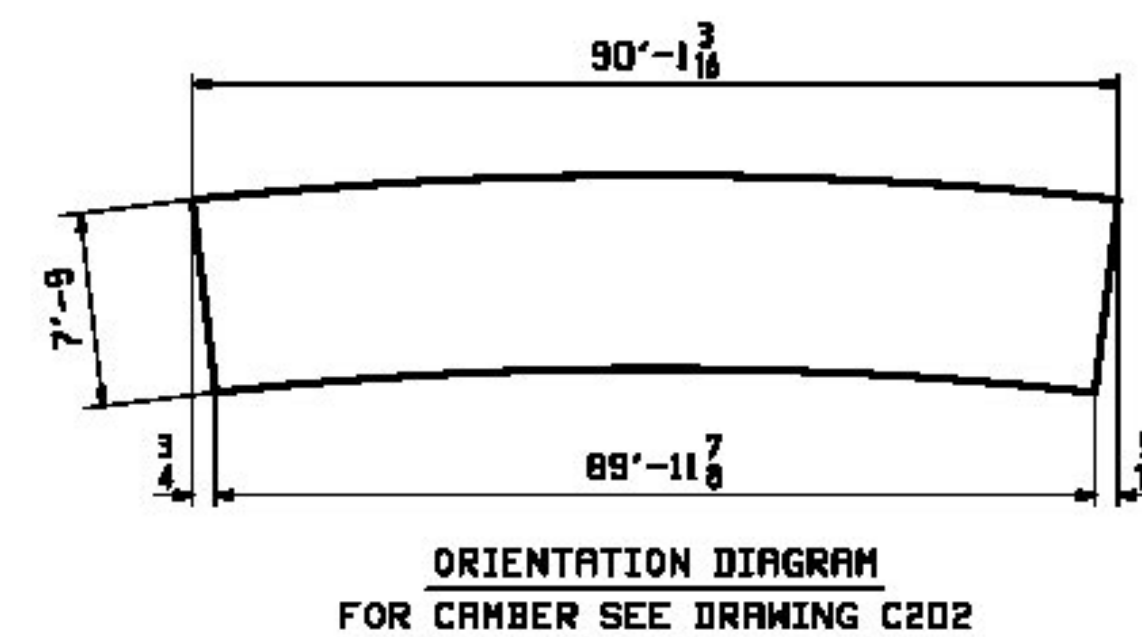
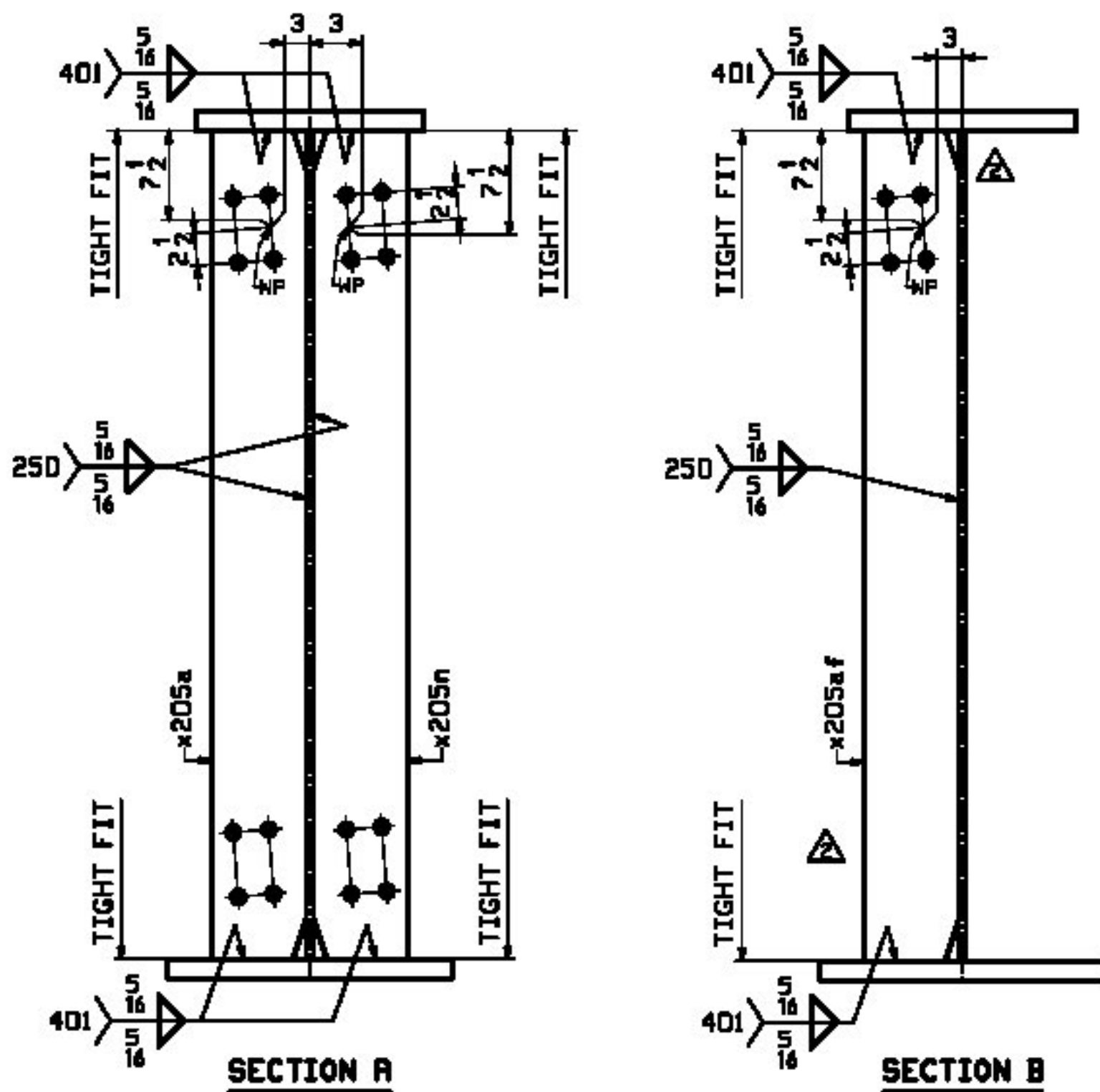

No Exception Taken
 Make Correction as Noted
 Submit Specified Item
 Revise and Resubmit as Noted
 Rejected

T-Y-L INTERNATIONAL

Checking is for general compliance with the design concept of the project and general compliance with the information given in the contract documents only. Any action shown is not an approval and is subject to the requirements of the plans and specifications. Any action shown on a specific item shall not indicate the checking of an assembly of which the item is a component. Contractor is solely responsible for: dimensions which shall be confirmed and correlated at the job site, fabrication processes, techniques of construction, safety precautions, and coordination of its work with that of all other trades and the satisfactory performance of its work.

Reviewed By: *[Signature]* Date: May 29, 2012

5/10/2012	REV. UTILITY STIFF'S SECTION B (EXTRA TFC-303400)	JTB	TJB				
11/17/10	ADD BTM FLG SPLICE, PL bb	KC	ML				
0							
REV.	DATE	REMARKS	DMN	CHK	APVL	SHOP	
MATERIAL:	M270-S0W (UN)	SURFACE PREP. & PAINT:	SEE DWG G01	HOLES:	15 1/16" φ	SHOP BOLTS:	NONE
DESCRIPTION: GIRDER - 207G3B							
CASCO BAY STEEL STRUCTURES, INC. 1 WALLACE AVE. SOUTH PORTLAND, ME 04106 PHONE (207) 780-6722 FAX. (207) 780-6726							
STRUCTURE: I-91 BRIDGE 6S OVER WHITESTONE BROOK & WILLIAMS STREET COUNTY OF MINDHAM				DRAWN:	JTB	DATE:	07/11
LOCATION: Town of Brattleboro, VT.				CHKD:	TJB	DATE:	07/23
PROJ NO. IM 091-1(SD)				JOB NO.	479	DWG NO.	207
CUSTOMER: BECK & BELLUCCI						REV.	△