

ONE - GIRDER - 208G4B

FOR FIELD SPLICE STANDARD DETAILS SEE DRAWINGS X201 & X202.
 FOR GIRDER STANDARD DETAILS SEE DRAWING X205.
 FOR CAMBER & FLANGE DIAGRAMS SEE DRAWING C202.
 FOR GENERAL NOTES SEE DRAWING GNI.
 T2 DENOTES MATERIAL SUBJECT TO CHARPY V-NOTCH TESTING.

JOB NO.		DRAWING NO.		REV.
479		208		△
ROW INFO	SHOP	BILL OF MATERIAL		
MARK	QTY	MARK	MATERIAL	LENGTH
208G4B	1		GIRDER	FT
				INCHES
REMARKS	MT	PROCUREMENT NOTES		
		3825		
203 L	1	wa	PL 5/8x93	47 5/8
203 Q	1	wb	PL 5/8x93	42 2/8
204 A	1	tw	PL 2x15 1/2	68 2/8
204 J	1	tb	PL 1 1/2x15 1/2	21 10 5/8
201 R	1	bw	PL 2x18	26 2/8
201 Q	1	bc	PL 2x18	42 0
202 C	1	bb	PL 1 1/2x18	21 9
208 Q	6	x205av	PL 1 1/2x7 1/4	7 9
208 E	6	x205n	PL 1 1/2x7 1/4	7 9

T-Y-LININTERNATIONAL

No Exception Taken
 Make Correction as Noted
 Submit Specified Item
 Revise and Resubmit as Noted
 Rejected

Checking is for general compliance with the design concept of the project and general compliance with the information given in the contract documents only. Any action shown is not an approval and is subject to the requirements of the plans and specifications. Any action shown on a specific item shall not indicate the checking of an assembly of which the item is a component. Contractor is solely responsible for dimensions which shall be confirmed and correlated at the job site, fabrication processes, techniques of construction, safety precautions, and coordination of its work with that of all other trades and the satisfactory performance of its work.

Reviewed By: *[Signature]* Date: 11/28/11

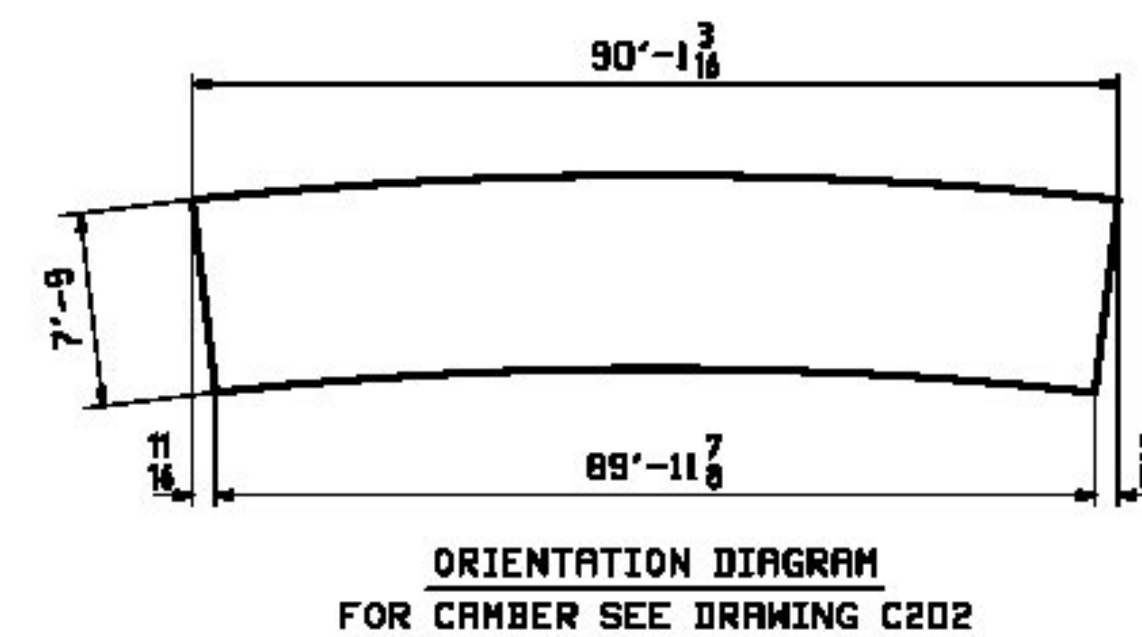
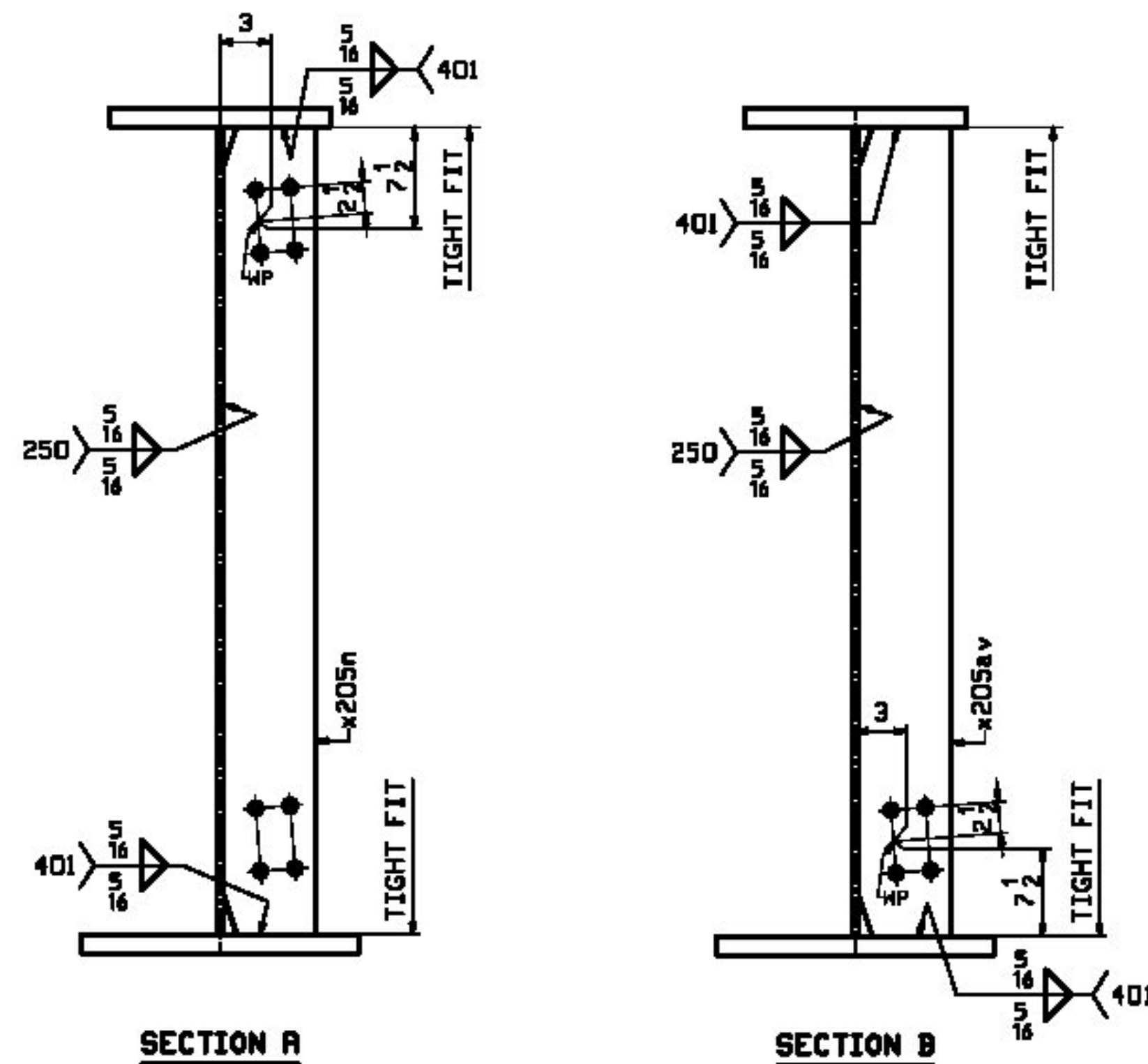

REV.	DATE	REMARKS	DMN	CHK	APVL	SHOP
0	11/17/11	ADD BTM FLG SPLICE, PL bw	KC	ML		
MATERIAL:		SURFACE PREP. & PAINT:		HOLES:		SHOP BOLTS:
M270-S0W (UN)		SEE DWG GNI		15 1/16 φ		NONE
DESCRIPTION: GIRDER - 208G4B						
CASCO BAY STEEL STRUCTURES, INC.						
1 WALLACE AVE.			PHONE (207) 780-6722		TENSOR	
SOUTH PORTLAND, ME 04106			FAX (207) 780-6726		STRUCTURE	
I-91 BRIDGE 6S OVER WHITESTONE				DRAWN:		DATE:
BROOK & WILLIAMS STREET				JTB		07/11
COUNTY OF MINDHAM				CHKD:		DATE:
				TJB		07/23
LOCATION: Town of Brattleboro, VT.				JOB NO.		DWG NO.
PROJ NO. IM 091-1(SD)				479		208
CUSTOMER: BECK & BELLUCI						REV. △