

US 5

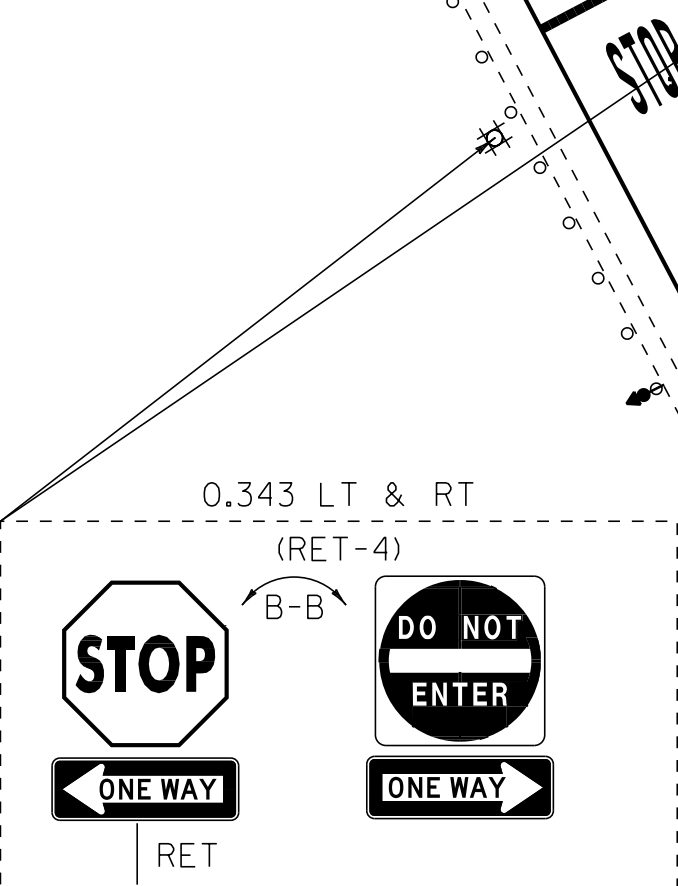

EXIT 7 - RAMP C & G NORTHBOUND OFF RAMP

SEE STANDARDS E-191, E-192 AND E-193
FOR PAVEMENT MARKING GUIDELINES

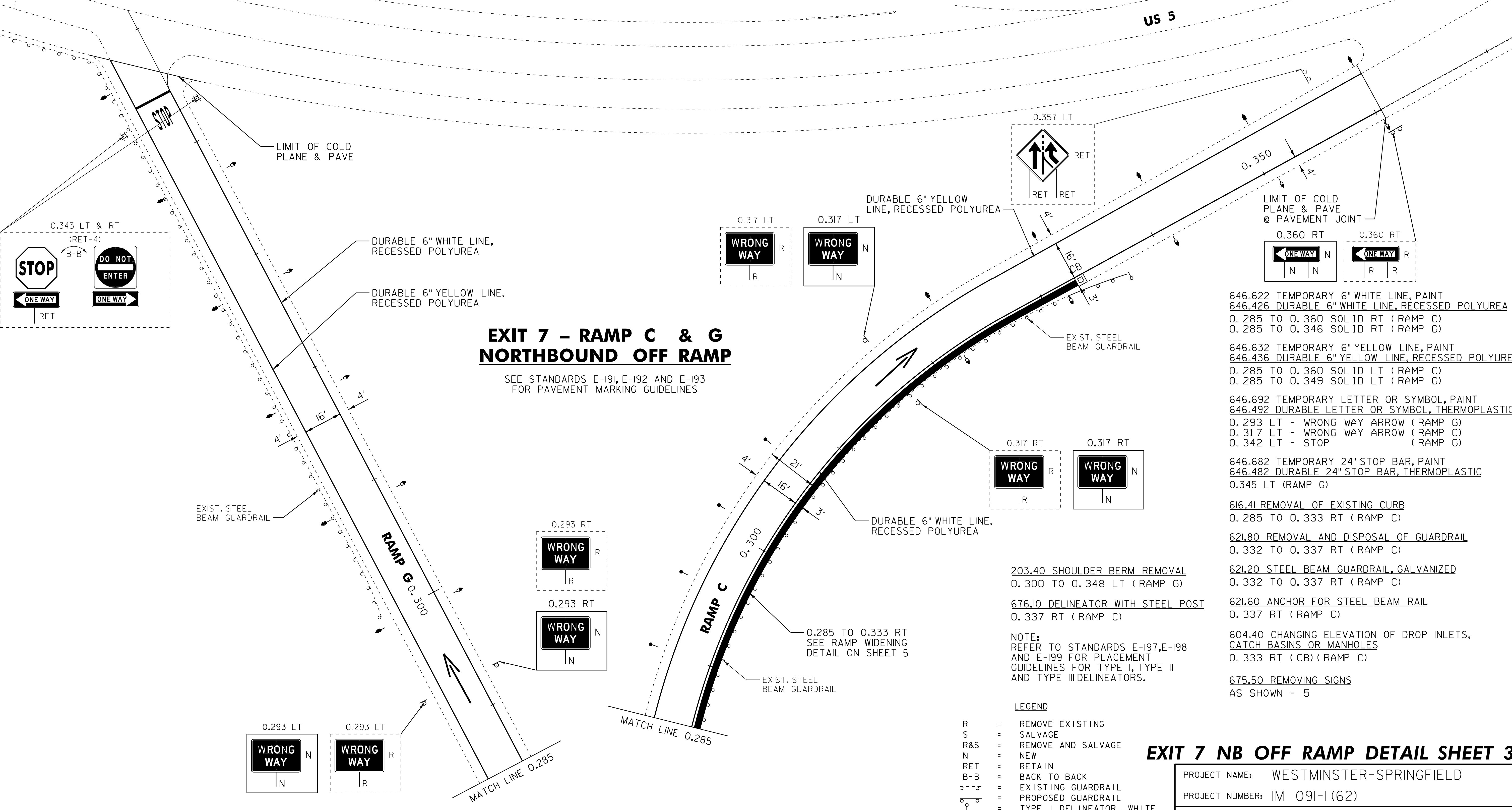

- 646.622 TEMPORARY 6" WHITE LINE, PAINT
- 646.426 DURABLE 6" WHITE LINE, RECESSED POLYUREA
- 0.285 TO 0.360 SOLID RT (RAMP C)
- 0.285 TO 0.346 SOLID RT (RAMP G)
- 646.632 TEMPORARY 6" YELLOW LINE, PAINT
- 646.436 DURABLE 6" YELLOW LINE, RECESSED POLYUREA
- 0.285 TO 0.360 SOLID LT (RAMP C)
- 0.285 TO 0.349 SOLID LT (RAMP G)
- 646.692 TEMPORARY LETTER OR SYMBOL, PAINT
- 646.492 DURABLE LETTER OR SYMBOL, THERMOPLASTIC
- 0.293 LT - WRONG WAY ARROW (RAMP G)
- 0.317 LT - WRONG WAY ARROW (RAMP C)
- 0.342 LT - STOP (RAMP G)
- 646.682 TEMPORARY 24" STOP BAR, PAINT
- 646.482 DURABLE 24" STOP BAR, THERMOPLASTIC
- 0.345 LT (RAMP G)
- 616.41 REMOVAL OF EXISTING CURB
- 0.285 TO 0.333 RT (RAMP C)
- 621.80 REMOVAL AND DISPOSAL OF GUARDRAIL
- 0.332 TO 0.337 RT (RAMP C)
- 621.20 STEEL BEAM GUARDRAIL, GALVANIZED
- 0.332 TO 0.337 RT (RAMP C)
- 621.60 ANCHOR FOR STEEL BEAM RAIL
- 0.337 RT (RAMP C)
- 604.40 CHANGING ELEVATION OF DROP INLETS,
CATCH BASINS OR MANHOLES
- 0.333 RT (CB) (RAMP C)
- 675.50 REMOVING SIGNS
AS SHOWN - 5

- 203.40 SHOULDER BERM REMOVAL
- 0.300 TO 0.348 LT (RAMP G)
- 676.10 DELINEATOR WITH STEEL POST
- 0.337 RT (RAMP C)

NOTE:
REFER TO STANDARDS E-197, E-198
AND E-199 FOR PLACEMENT
GUIDELINES FOR TYPE I, TYPE II
AND TYPE III DELINEATORS.

LEGEND

R	= REMOVE EXISTING
S	= SALVAGE
R&S	= REMOVE AND SALVAGE
N	= NEW
RET	= RETAIN
B-B	= BACK TO BACK
---	= EXISTING GUARDRAIL
---	= PROPOSED GUARDRAIL
o	= TYPE I DELINEATOR, WHITE
o	= TYPE I DELINEATOR, AMBER
o	= TYPE II DELINEATOR, WHITE
o	= TYPE III DELINEATOR, RIGHT
o	= TYPE III DELINEATOR, LEFT

EXIT 7 NB OFF RAMP DETAIL SHEET 3

PROJECT NAME: WESTMINSTER-SPRINGFIELD	PLOT DATE: 17-JAN-2013 12:44
PROJECT NUMBER: IM 091-1(62)	DRAWN BY: MRS
FILE NAME: /pave/01a014/pa014	CHECKED BY: PTS
PROJECT LEADER: PTS	DESIGNED BY: NULL
IPARM FILE NAME: 01a014_31	SHEET 31 OF 43

NOT TO SCALE