

646.622 TEMPORARY 6" WHITE LINE, PAINT
 646.426 DURABLE 6" WHITE LINE, RECESSED POLYUREA
 0.200 TO 0.410 SOLID

646.632 TEMPORARY 6" YELLOW LINE, PAINT
 646.436 DURABLE 6" YELLOW LINE, RECESSED POLYUREA
 0.200 TO 0.410 SOLID LT

646.692 TEMPORARY LETTER OR SYMBOL, PAINT
 646.492 DURABLE LETTER OR SYMBOL, THERMOPLASTIC
 0.303 LT - "STOP"
 0.311 LT - "AHEAD"

EXIT 6 - RAMP A NORTHBOUND OFF RAMP

SEE STANDARDS E-191, E-192 AND E-193
 FOR PAVEMENT MARKING GUIDELINES

616.41 SHOULDER BERM REMOVAL
 0.296 TO 0.345 RT

616.41 REMOVAL OF EXISTING CURB
 0.345 TO 0.410 RT

621.80 REMOVAL AND DISPOSAL OF GUARDRAIL
 0.296 TO 0.303 RT
 0.393 TO 0.410 LT

621.20 STEEL BEAM GUARDRAIL, GALVANIZED
 0.400 TO 0.410 LT

621.50 MANUFACTURED TERMINAL SECTION, FLARED
 0.296 TO 0.303 RT
 0.393 TO 0.400 LT

613.10 STONE FILL, TYPE I
 0.391 RT

675.50 REMOVING SIGNS
 AS SHOWN - 17

675.60 ERECTING SALVAGED SIGNS
 AS SHOWN - 14

676.10 DELINEATOR WITH STEEL POST
 0.296 RT
 0.393 LT
 NOTE:
 REFER TO STANDARDS E-197, E-198
 AND E-199 FOR PLACEMENT
 GUIDELINES FOR TYPE I, TYPE II
 AND TYPE III DELINEATORS.

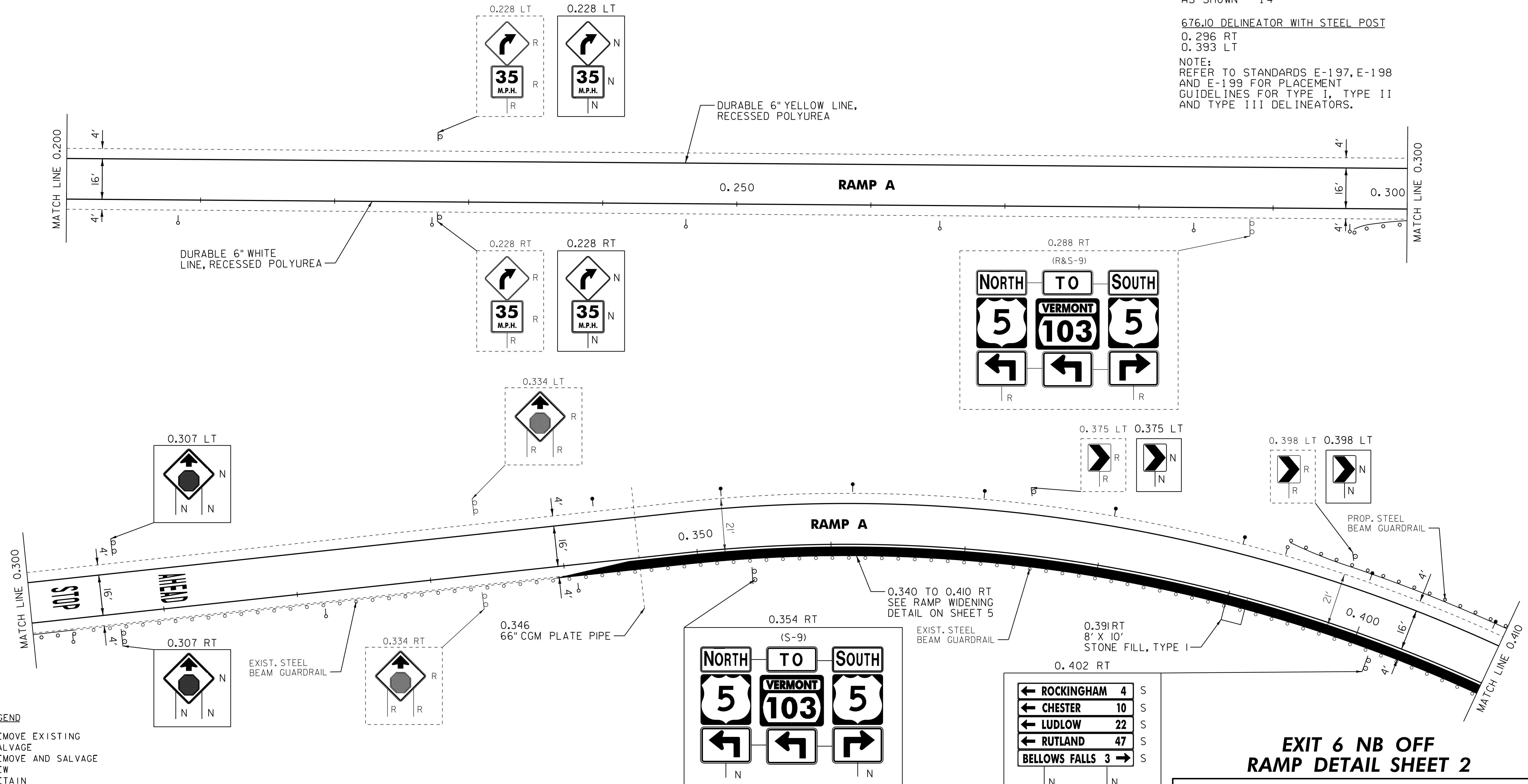

- LEGEND**
- R = REMOVE EXISTING
 - S = SALVAGE
 - R&S = REMOVE AND SALVAGE
 - N = NEW
 - RET = RETAIN
 - B-B = BACK TO BACK
 - = EXISTING GUARDRAIL
 - - - = PROPOSED GUARDRAIL
 - = TYPE I DELINEATOR, WHITE
 - = TYPE I DELINEATOR, AMBER
 - ◻ = TYPE II DELINEATOR, WHITE
 - ◻ = TYPE III DELINEATOR, RIGHT
 - ◻ = TYPE III DELINEATOR, LEFT

NOT TO SCALE

0.354 RT (S-9)

NORTH	TO	SOUTH
5	VERMONT	5
←	103	→
←		→

0.402 RT

←	ROCKINGHAM	4	S
←	CHESTER	10	S
←	LUDLOW	22	S
←	RUTLAND	47	S
	BELLOWS FALLS	3	→

EXIT 6 NB OFF RAMP DETAIL SHEET 2

PROJECT NAME: WESTMINSTER-SPRINGFIELD
 PROJECT NUMBER: IM 091-1(62)

FILE NAME: /pave/01a014/pa014
 PROJECT LEADER: PTS
 DESIGNED BY: NLL
 IPARM FILE NAME: 01a014_21

PLOT DATE: 17-JAN-2013 12:43
 DRAWN BY: MRS
 CHECKED BY: PTS
 SHEET 21 OF 43