

NOTES:

1. EXIT SIGN SHALL BE MOUNTED A MINIMUM OF 0.900 m ABOVE THE GROUND AND HIGH ENOUGH TO BE SEEN ABOVE CHANNELIZING DEVICES.
2. ALL DISTANCES ARE DESIRABLE MINIMUMS FIELD CONDITIONS SHALL CONTROL THE ACTUAL PLACEMENT.
3. THE PAVEMENT WIDENING SHALL BE CONSTRUCTED USING TWO 70 mm LIFTS OF TYPE IIS BASE COURSE AND ONE 35 mm LIFT OF TYPE IIIS WEARING COURSE. THE FIRST BASE COURSE SHALL BE PLACED TO MATCH THE ELEVATION OF THE ADJOINING SURFACE OF THE I-91NB TRAVEL LANE.
4. EMULSIFIED ASPHALT SHALL BE APPLIED ON ALL EXISTING PAVEMENT SURFACES AND BETWEEN ALL COURSES OF PAVEMENT AT THE RATE OF 0.12 L/m² OR AS DIRECTED BY THE RESIDENT ENGINEER.
5. THE I-91NB TRAVEL LANE SHALL BE CLOSED TO TRAVEL IN THE AREA OF THE DECELERATION LANE CONSTRUCTION.
6. EXISTING DECELERATION LANE AND SHOULDER PAVEMENT SHALL BE REMOVED UNDER ITEM 203.28, EXCAVATION OF SURFACES AND PAVEMENTS. ALL OTHER EXCAVATION ASSOCIATED WITH THE PAVEMENT WIDENING SHALL BE PERFORMED UNDER ITEM 203.15, COMMON EXCAVATION.
7. REFER TO STD. B-5 FOR CONSTRUCTING AN EMBANKMENT ON A EARTH SLOPE.
8. FINE GRADING HAS BEEN ADDED FOR WORK IN THE AREA OF THE DECEL LANE.

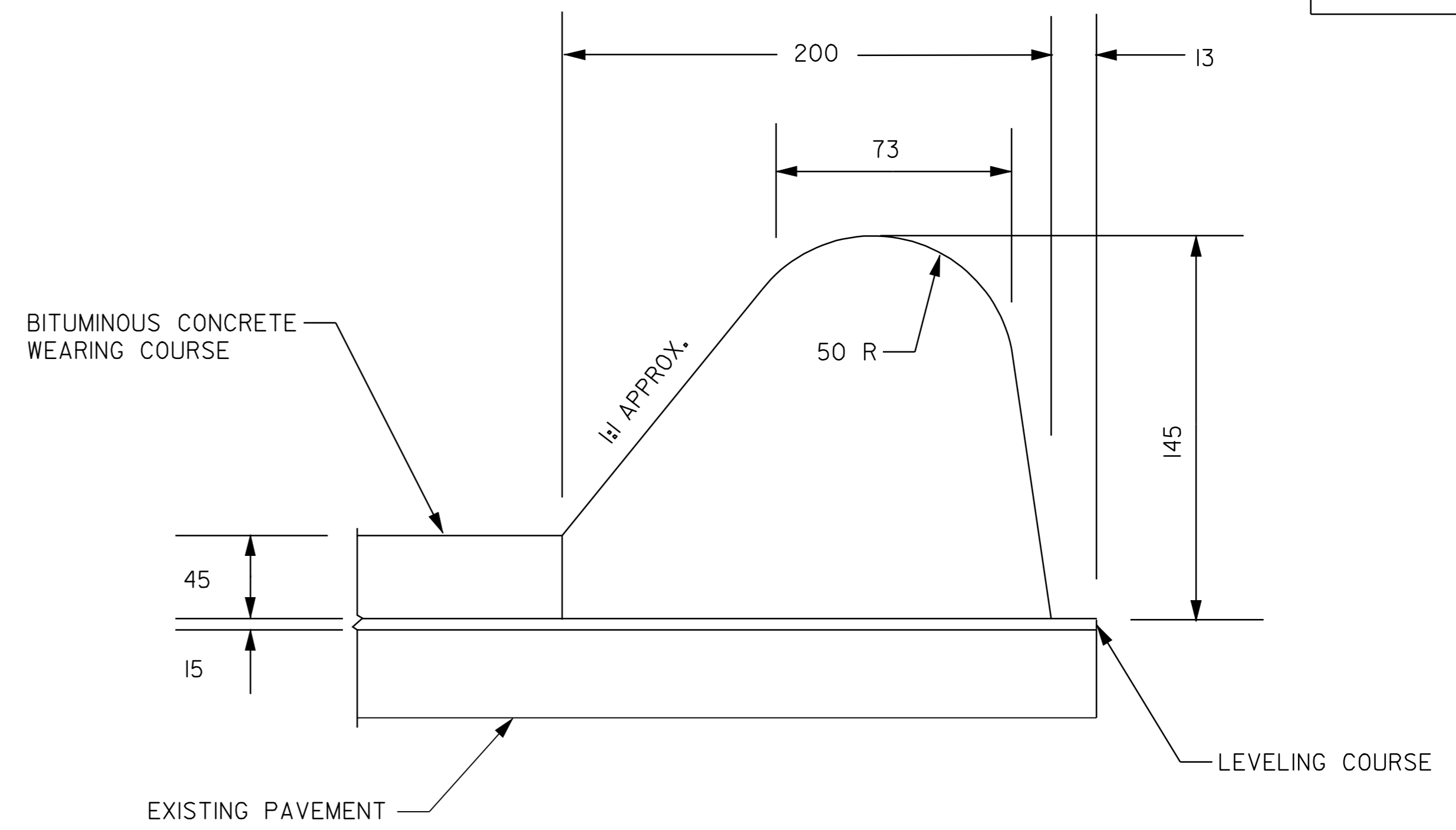

DETAIL FOR BITUMINOUS CONCRETE CURB TYPE B

Sta. 45+556 TO 45+826

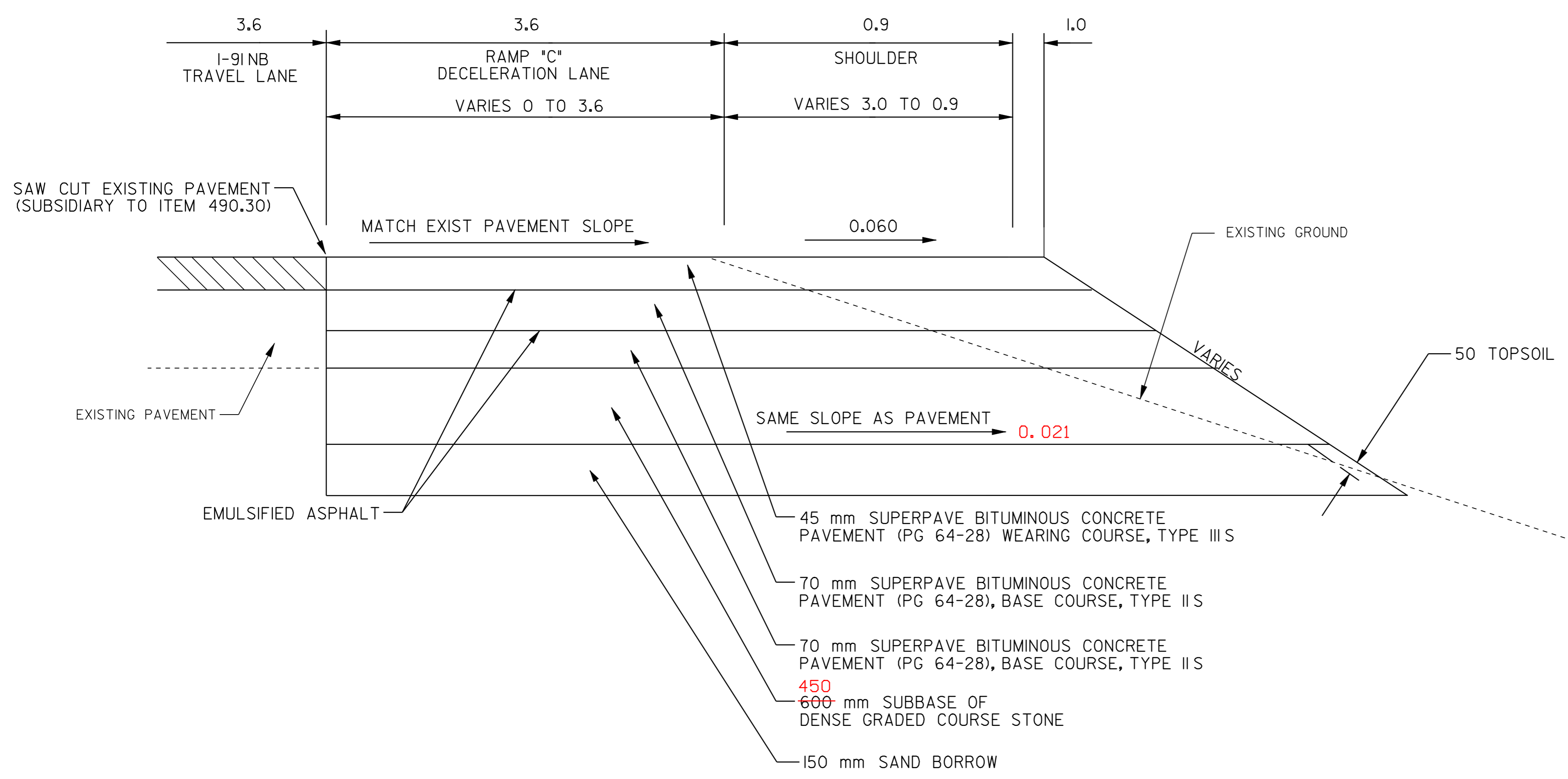

PAVEMENT WIDENING DETAIL

NOTE: ALL DIMENSIONS IN METERS EXCEPT AS INDICATED

DETAIL SHEET	PROJECT NAME: BRATTLEBORO - WESTMINSTER	
	PROJECT NUMBER: IM 091-(41)	
	FILE NAME: /pave/01a008/pa008.dgn	PLOT DATE: 06-APR-2005 11:55
	PROJECT LEADER: WRH	DRAWN BY: JAC
DESIGNED BY:	CHECKED BY: PIS	
IPARM NAME: pa008ds.i	SHEET 19 OF 24	