

INDEX OF SHEETS

1	TITLE SHEET	
2	QUANTITY SHEET	
3	INTERSTATE TYPICAL PAVEMENT MARKINGS	
4	INTERSTATE TYPICAL PAVEMENT MARKINGS	
5	RAMP AND GORE TRAFFIC CONTROL PLAN	
6-10	INTERCHANGE MARKING SUMMARY SHEETS	
11-12	DURABLE MARKING SUMMARY SHEETS	

STANDARDS

E-100	CONSTRUCTION APPROACH SIGNS	01-06-97
E-101	CONSTRUCTION SIGN DETAILS	03-10-97
E-102	CONSTRUCTION SIGN DETAILS	08-08-95
E-102A	CONSTRUCTION SIGN DETAILS	08-08-95
E-103	MAINLINE TRAFFIC CONTROL DIVIDED HIGHWAY ONE LANE CLOSED	09-23-98
E-106	TRAFFIC CONTROL MISCELLANEOUS DETAILS	08-08-95
E-107	DELINEATION, BARRICADES AND DETOURS FOR CONSTRUCTION AREAS	08-08-95
E-107A	BREAKAWAY BARRICADE DETAILS	08-08-95
E-112	TRAFFIC CONTROL FOR TYPICAL MOVING MAINTENANCE OPERATIONS	01-23-97
E-191	PAVEMENT MARKING DETAILS	02-01-99

STATE OF VERMONT  
 AGENCY OF TRANSPORTATION

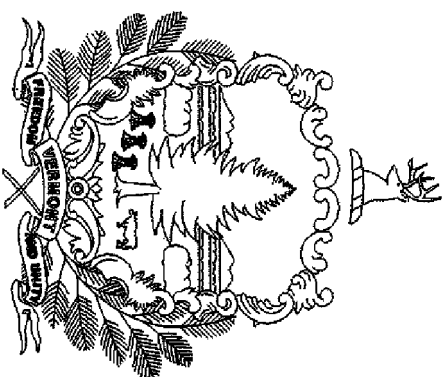

PROPOSED IMPROVEMENT

**PROJECT LOCATIONS:**  
 130,256 MILES INTERSTATE 89 FROM NEW HAMPSHIRE BORDER TO CANADIAN BORDER  
 177,432 MILES INTERSTATE 91 FROM MASSACHUSETTS BORDER TO CANADIAN BORDER  
 1,488 MILES INTERSTATE 189 FROM INTERSTATE 89 TO US 7

NOTE: AREAS DESIGNATED BELOW  
 WILL NOT BE PAINTED WITH THIS PROJECT:

- I-89  
 SB & NB MM 0.00 ~ MM 22.00 PARTIAL--SEE SHEET 12 OF 12
- NB MM 47.20 ~ MM 53.04 IM 089-1(2)
- NB MM 53.54 ~ MM 54.91 IM 089-2(26)
- NB MM 64.50 ~ MM 66.87 IM 089-2(26)
- NB MM 91.88 ~ MM 98.00 REPAIR
- NB MM 106.9 ~ MM 114.10
- NB MM 120.79 ~ MM 133.25 IM 089-2(26)
- SB MM 36.90 ~ MM 53.00
- SB MM 53.83 ~ MM 53.91 IM 089-2(26)
- SB MM 54.73 ~ MM 55.30 IM 089-2(26)
- SB MM 64.61 ~ MM 66.77 IM 089-2(26)
- SB MM 79.00 ~ MM 86.96 THERMO REAPPLICATION
- SB MM 91.88 ~ MM 98.00
- SB MM 106.83 ~ MM 114.10
- SB MM 117.85 ~ MM 130.24  
 FOR RAMP TREATMENTS, SEE SHEET 6 OF 12
- I-91  
 NB & SB MM 0.00 ~ MM 11.913
- NB MM 33.01 ~ MM 34.08 IM 091-1(38)
- NB MM 73.59 ~ MM 92.49
- NB MM 127.87 ~ MM 150.10
- SB MM 33.02 ~ MM 34.05B MM 35.59 ~ MM 57.35 IM 091-1(38)
- SB MM 76.45 ~ MM 98.44
- SB MM 110.43 ~ MM 137.19
- SB MM 150.70 ~ MM 155.97 PARTIAL THERMO REPAIR
- SB MM 162.00 ~ MM 172.50

NOTE: AREAS BELOW WILL BE MARKED WITH DURABLE MARKINGS  
 -I-89 SB MM 79.00 ~ MM 86.95 REAPPLICATION  
 -I-89 NB MM 91.88 ~ MM 98.00 PARTIAL THERMO REPAIR(EST)  
 -I-91 SB & NB MM 0.00 ~ 11.913 YELLOW EDGE LINES  
 -I-91 SB MM 133.20 ~ 137.18 REAPPLICATION OVER 4"  
 -I-91 SB MM 150.70 ~ MM 155.97 PARTIAL THERMO REPAIR(EST).  
 -I-91 SB MM 162.00 ~ MM 172.50 40 MIL SPRAY CAT II WP  
 FOR DURABLE RAMP MARKINGS SEE SHEET 11 OF 12

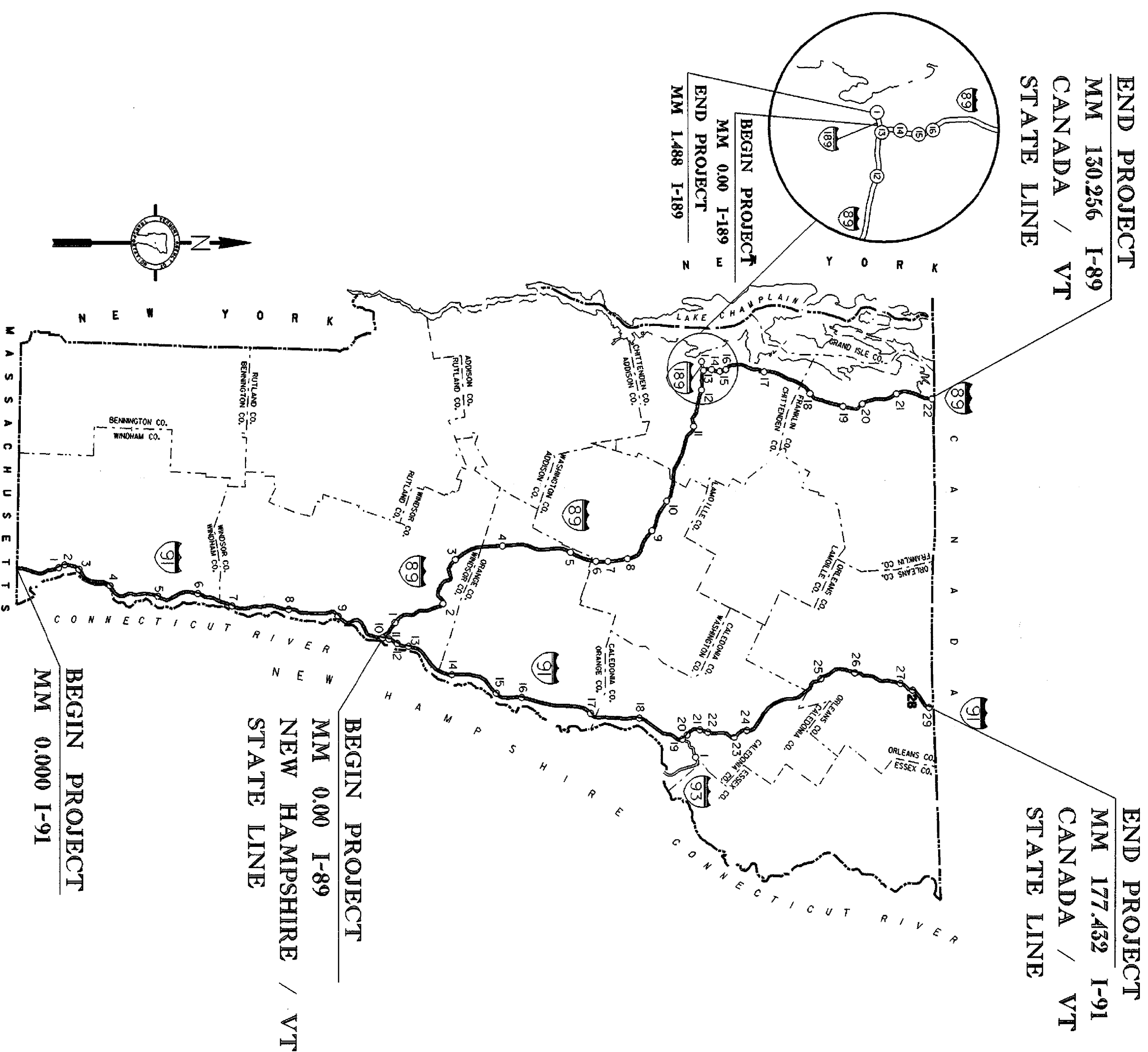

CONTRACT PLANS

THESE PLANS DO NOT REFLECT CHANGES MADE  
 ON THE PROJECT AS "RECORD PLANS" WOULD.

PROPOSED IMPROVEMENT  
 INTERSTATE SYSTEM  
 PAVEMENT MARKING

DESCRIPTION OF WORK:  
 PAVEMENT MARKINGS, INCLUDING APPLICATION OF CENTERLINE,  
 EDGE LINES, GORE MARKINGS, DASHED AND DOTTED LINES AT  
 ACCELERATION AND DECELERATION LANES, STOP BARS, LETTERS  
 OR SYMBOLS, CROSSWALK MARKING W/DIAGONAL LINES ON RAMPS,  
 AND 4" LINES AT PARKING STALLS IN REST AREAS.

THESE PLANS ARE SUBJECT TO SUCH  
 ENGINEERING CHANGES AS MAY BE REQUIRED  
 BY THE FEDERAL HIGHWAY ADMINISTRATION  
 OR THE CHIEF ENGINEER.  
 CONSTRUCTION IS TO BE CARRIED ON IN  
 ACCORDANCE WITH THESE PLANS AND THE  
 STANDARD SPECIFICATIONS FOR  
 CONSTRUCTION DATED 1990, AS APPROVED  
 BY THE FEDERAL HIGHWAY ADMINISTRATION  
 ON MARCH 15, 1990 FOR USE ON THIS PROJECT,  
 INCLUDING ALL SUBSEQUENT REVISIONS AND  
 SUCH REVISED SPECIFICATIONS AND SPECIAL  
 PROVISIONS AS ARE INCORPORATED IN THESE  
 PLANS.

APPROVED	DATE
<i>[Signature]</i>	4/1/01
DIRECTOR OF PROJECT DEVELOPMENT	
DEPARTMENT OF TRANSPORTATION	
FEDERAL HIGHWAY ADMINISTRATION	
APPROVED	DATE
<i>[Signature]</i>	5-4-01
DIVISION ADMINISTRATOR	
STATEWIDE INTERSTATE PAVEMENT MARKING CONTRACT IMG MARK (00)	
SHEET 1 OF 12 SHEETS	



# INTERSTATE TYPICAL PAVEMENT MARKINGS

## PAVEMENT MARKING DETAILS BORDER CROSSING I-189 @ US 7

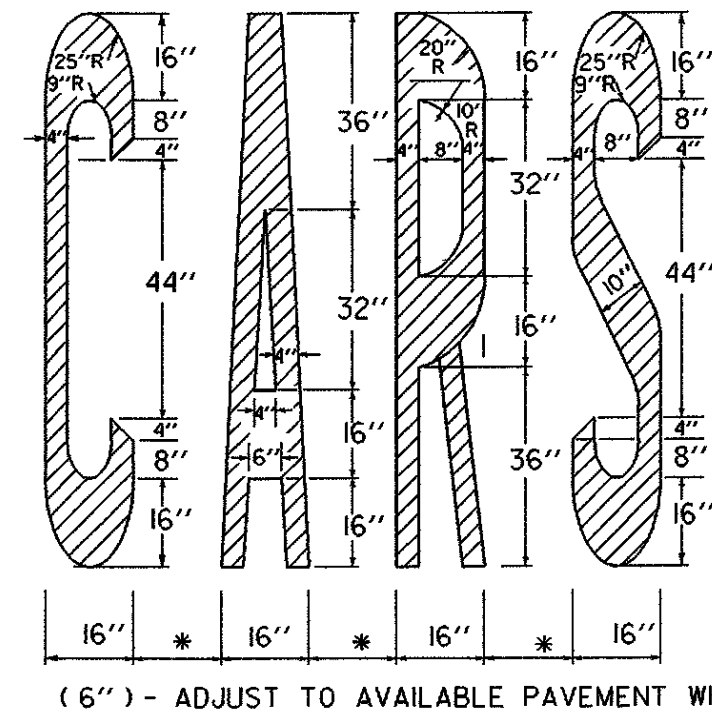

(6") - ADJUST TO AVAILABLE PAVEMENT WIDTH

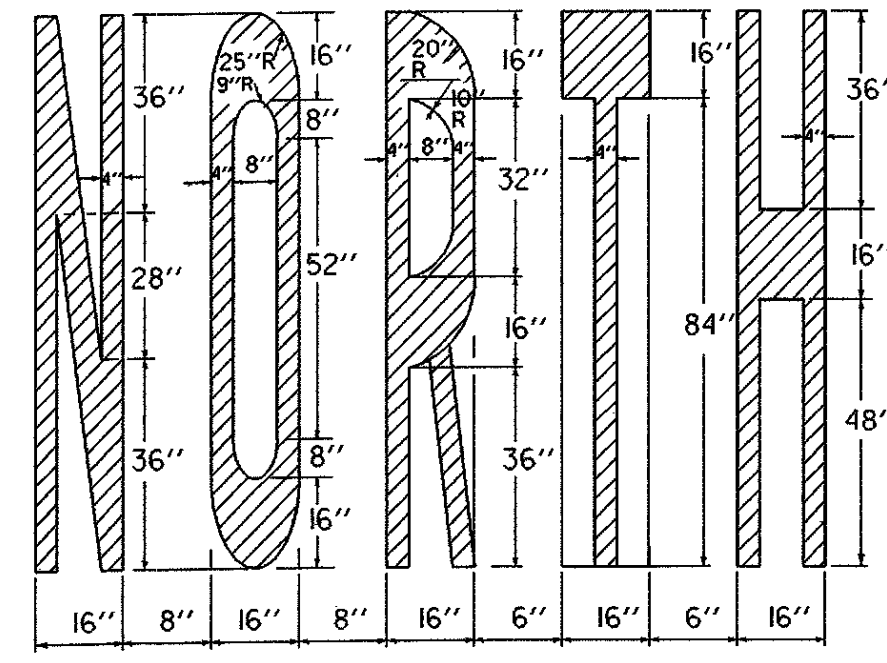

ADJUST TO AVAILABLE PAVEMENT WIDTH

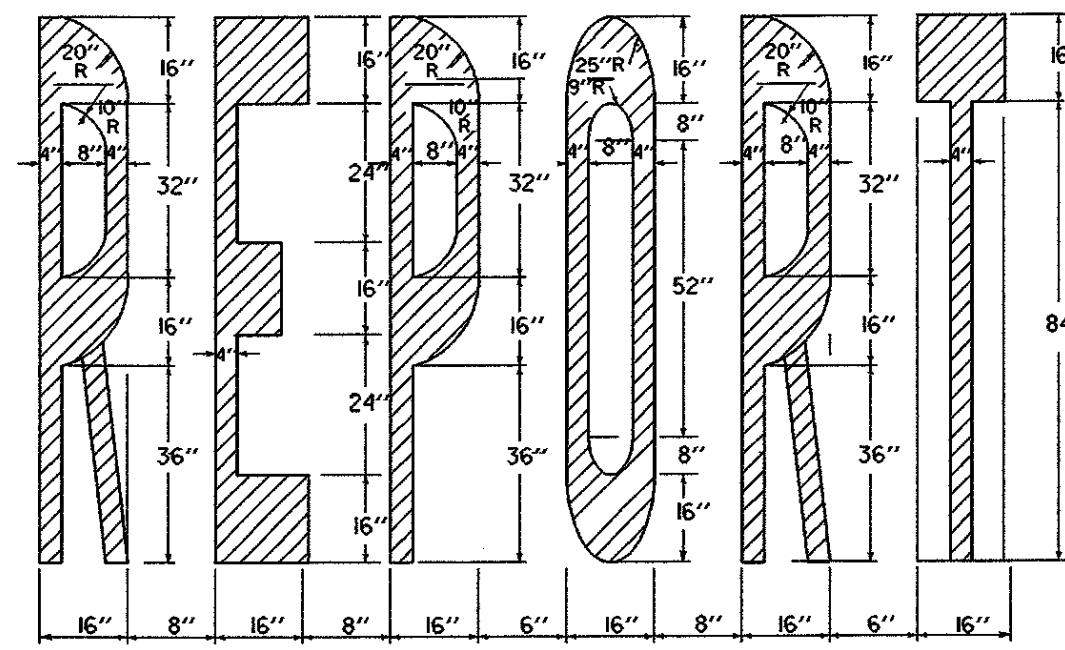

ADJUST TO AVAILABLE PAVEMENT WIDTH

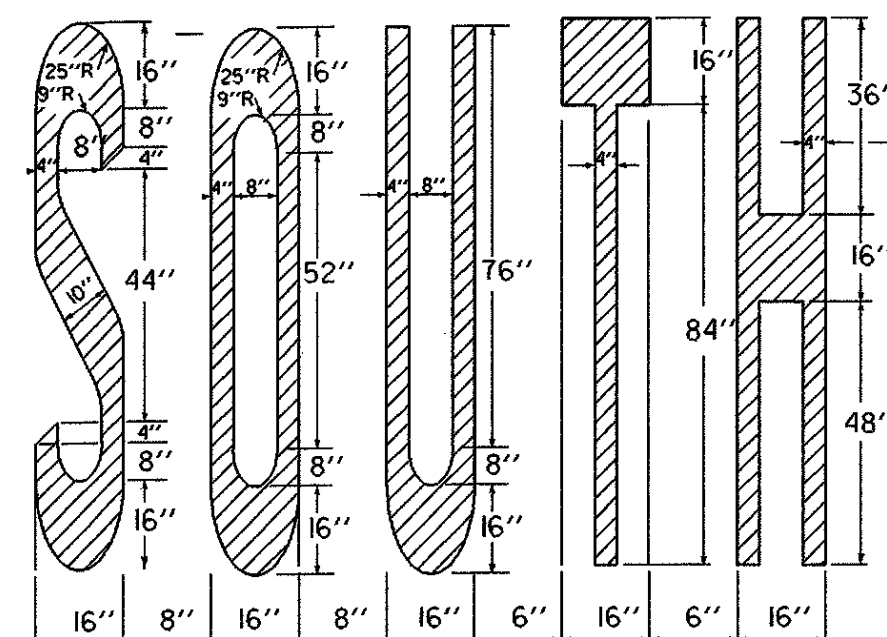

ADJUST TO AVAILABLE PAVEMENT WIDTH

## PAVEMENT MARKING LINE DETAILS

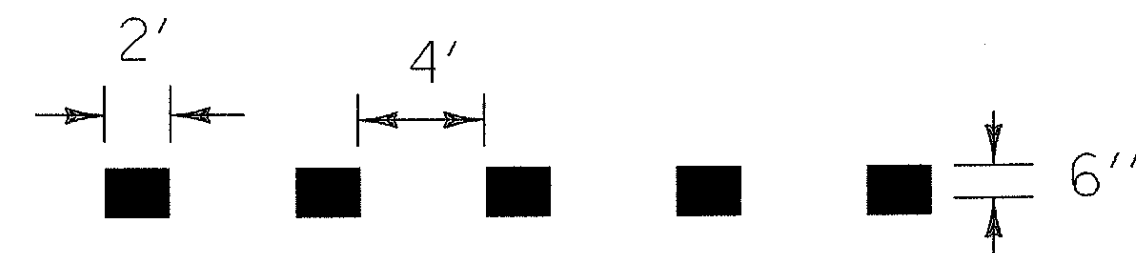

DOTTED LINE (WHITE)



SOLID LINE (WHITE OR YELLOW)



CHANNELIZING LINE (WHITE)

## TYPICAL MAINLINE MARKING PLAN

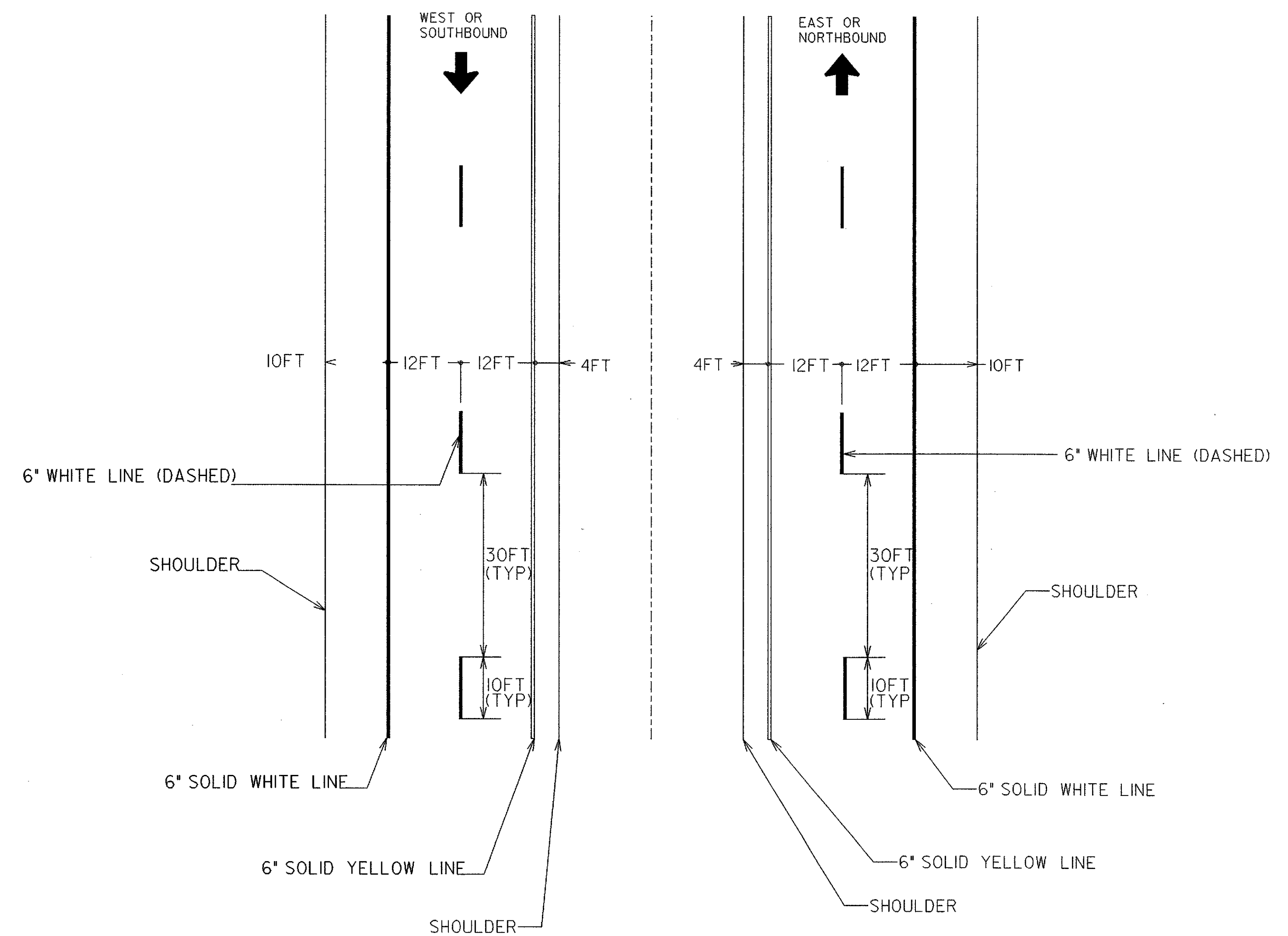

### LEGEND

- 6" WHITE LINES
- 6" YELLOW LINES

- 12" CHANNELIZATION LINES
- DIRECTION OF TRAFFIC FLOW

NOT TO SCALE

pave/misc/mark003.i

pave/99k318/mark100.dgn

PROJECT STATEWIDE INTERSTATE PAVEMENT MARKING CONTRACT - IMG MARK (199)

SHEET 3 OF 12 SHEETS

# INTERSTATE TYPICAL PAVEMENT MARKINGS

## PARALLEL ACCELERATION LANE

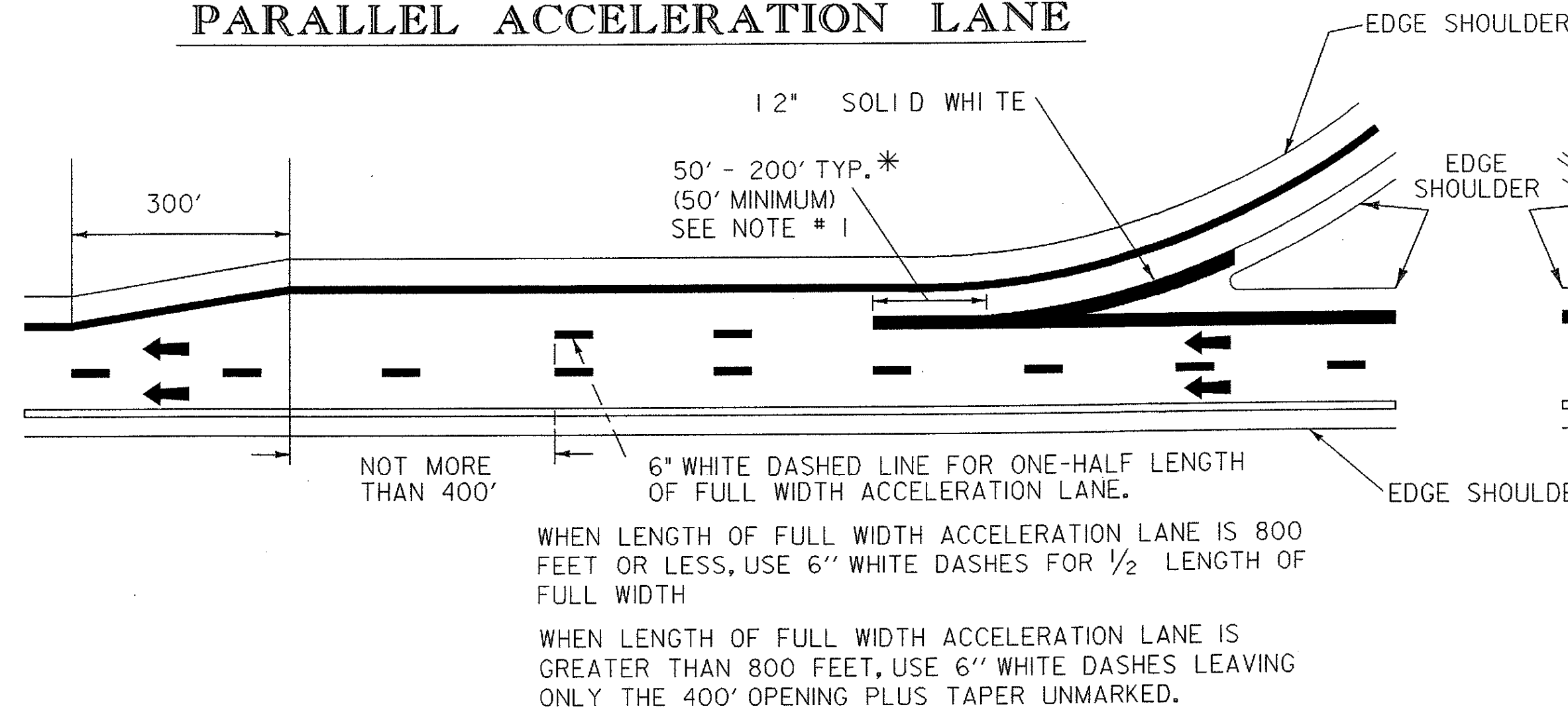

NOTE: EDGE LINES TO BE PAINTED TO THE CONNECTION OF THE EDGE LINE (OR TRAVEL LANE WHERE THERE IS NO EDGE LINE) ON THE CROSS ROAD AT THE RAMP TERMINALS. STOP BARS AND WORD MARKINGS ARE NOT INCLUDED.

## PARALLEL DECELERATION LANE

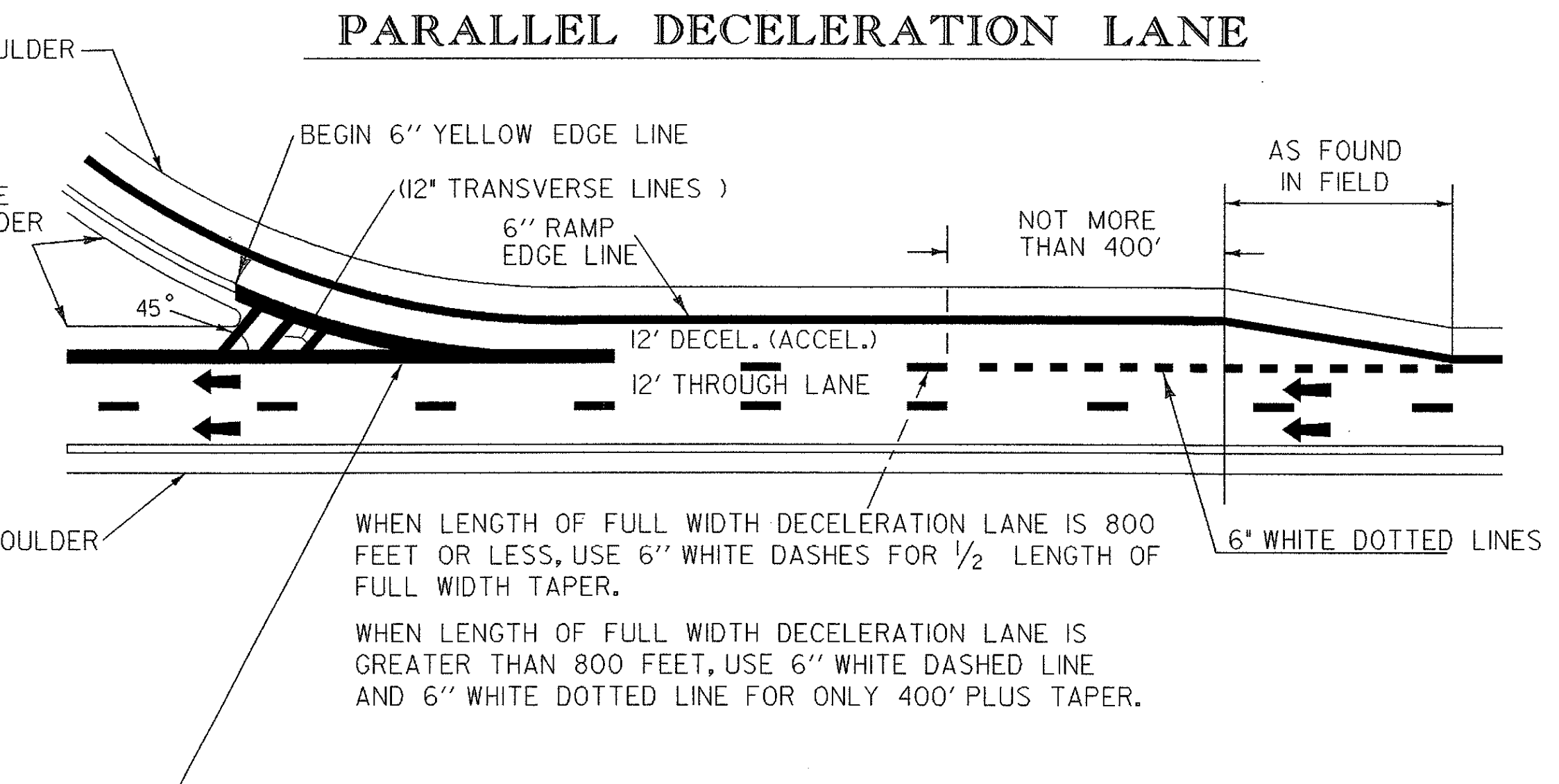

NOTE  
ACTUAL LOCATION OF 12" GORE MARKING TRANSITION CURVE MUST BE OFFSET FROM THE THEORETICAL RAMP EXTENSION LINE TO PROVIDE A VISUALLY SMOOTH RAMP ENTRANCE.

### NOTES

- 1) MATCH EXISTING DIMENSIONS UNLESS NONE ARE PRESENT
- 2) TRANSVERSE LINES SHALL CONSIST OF 12" WHITE LINES SPACED 14'-0" C-C AND SET AT 45° TO MAIN LINE EDGE LINES. THESE MARKINGS SHALL BE USED TO INCREASE VISIBILITY DUE TO DIFFICULT VERTICAL OR HORIZONTAL ALIGNMENT, AS DIRECTED BY THE RESIDENT ENGINEER.
- 3) DASH PATTERNS WILL BE MODIFIED IN THE FIELD TO OVERLAY EXISTING DASHES WHERE PRESENT.
- 4) 12" WHITE TRANSVERSE LINES WILL SUPERCEDE 8" WHITE LINES

## TAPERED ACCELERATION LANE

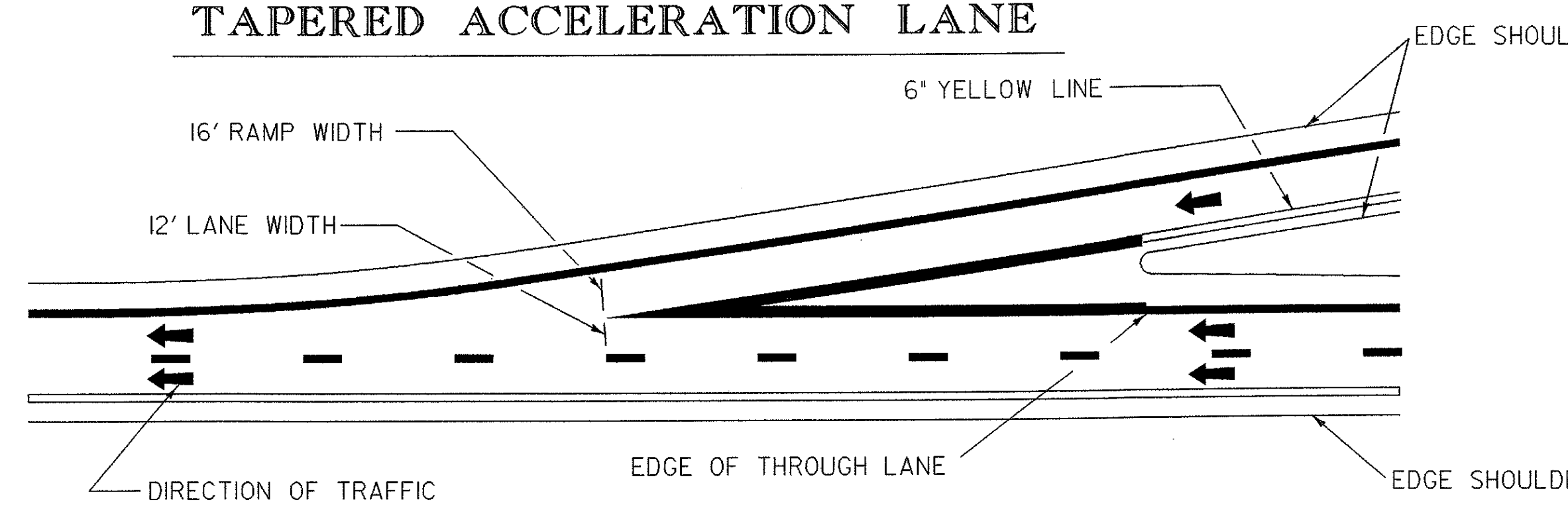

## TYPICAL TWO-WAY RAMP CENTERLINE MARKING



## TAPERED DECELERATION LANE

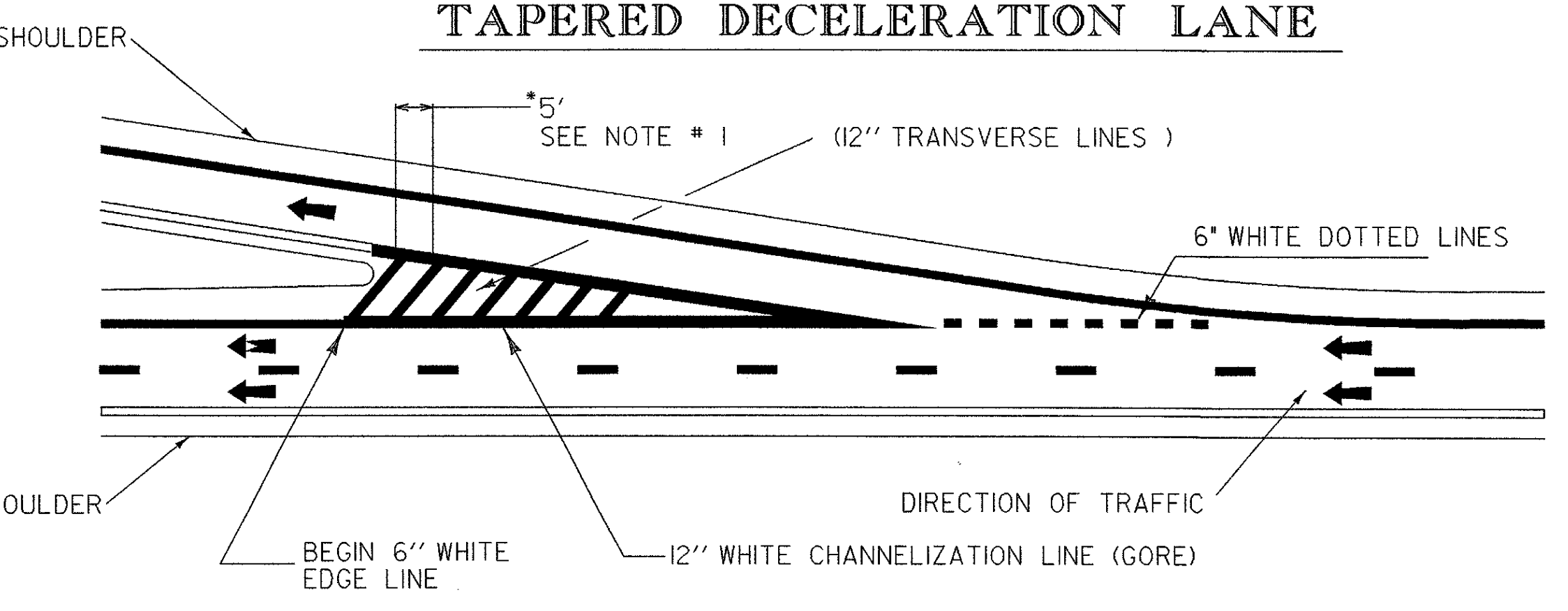

### LEGEND

- 6" WHITE LINES
- 6" YELLOW LINES
- 12" CHANNELIZATION LINES
- DIRECTION OF TRAFFIC FLOW

AS PER STANDARD E-191

NOT TO SCALE

pave/99k318/mark100.dgn

PROJECT	STATEWIDE INTERSTATE PAVEMENT MARKING CONTRACT IMG MARK (199)
SHEET	4 OF 12 SHEETS

pave/99k318/mark004.l

# RAMP AND GORE TRAFFIC CONTROL PLAN

## MAINLINE LANE CLOSURE AT AN EXIT RAMP

THIS DETAIL SHALL BE USED WHEN THE WORK ZONE BEGINS AT THE GORE OR THE MAINLINE LANE CLOSURE DRUM PLACEMENT INTERFERES WITH THE EXIT RAMP.

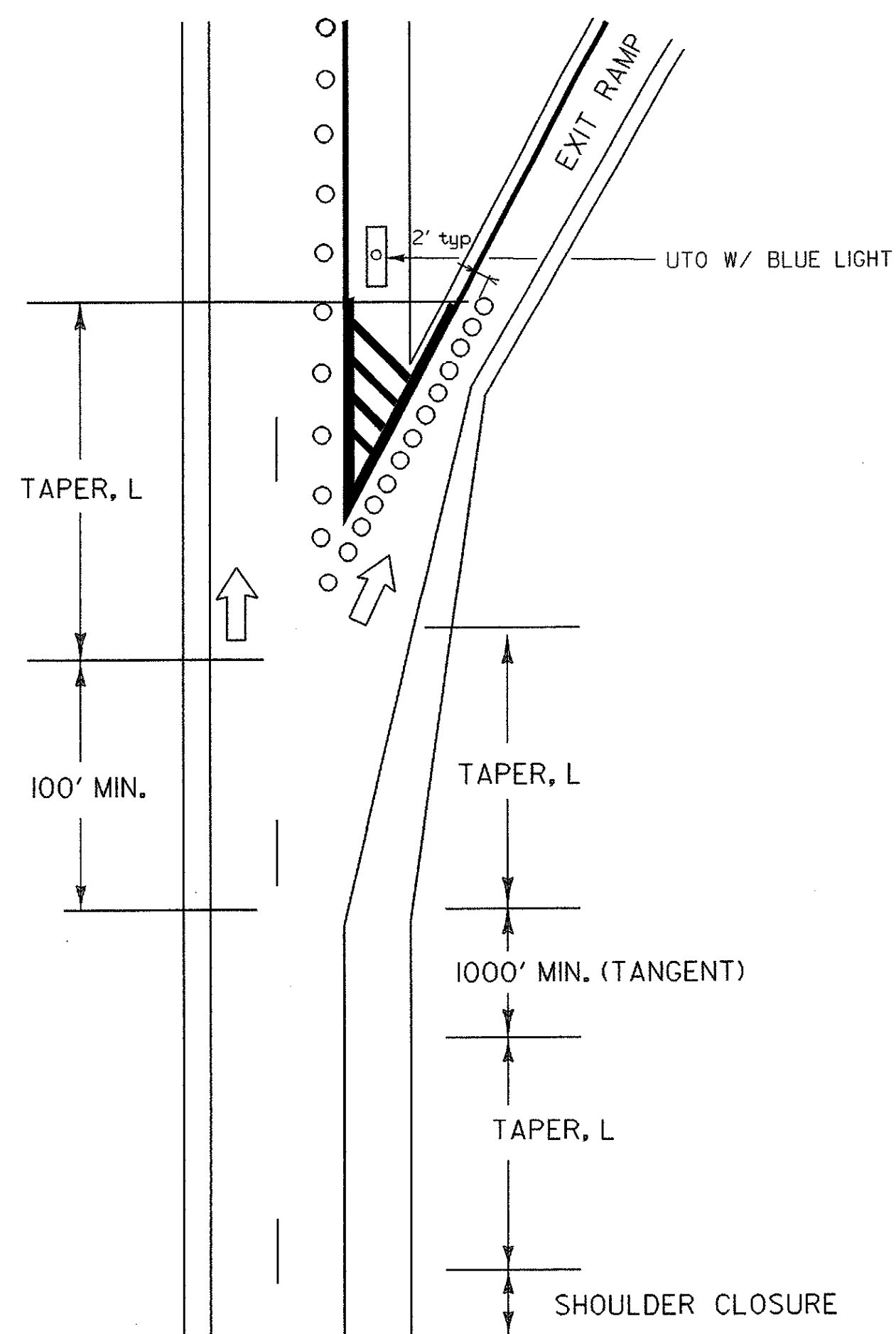

## MAINLINE LANE CLOSURE AT AN ENTRANCE RAMP

THIS DETAIL SHALL BE USED WHEN THE WORK ZONE BEGINS AT THE END OF THE ACCELERATION LANE OR THE MAINLINE LANE CLOSURE DRUM PLACEMENT INTERFERES WITH THE ON-RAMP TRAFFIC.

IF THE LENGTH OF THE ACCELERATION LANE IS NOT ADEQUATE, THE YIELD SIGN SHALL BE REPLACED WITH A STOP SIGN. IF A STOP SIGN IS USED, IT SHOULD BE ACCOMPANIED BY A STOP BAR.

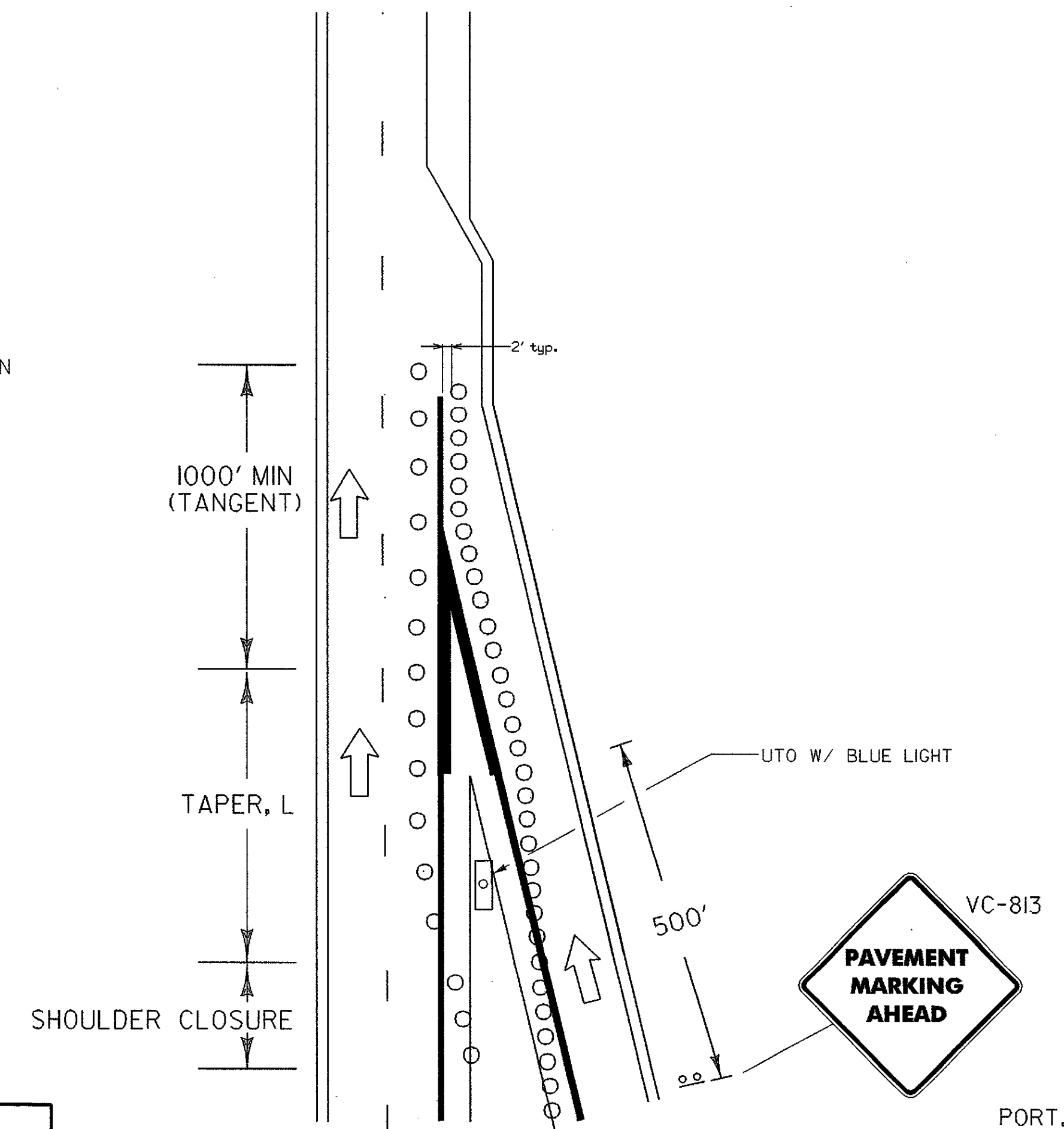

### NOTES:

1. ALL SIGNS SHALL BE PORTABLE.
2. CHANNELIZING DEVICES SHALL BE PLACED AS FOLLOWS:  
TAPERS - DEVICES SHALL BE SPACED A MAXIMUM OF 'S' (THE SPEED LIMIT IN FEET) APART.  
TANGENT - DEVICES SHALL BE PLACED 2 X 'S' (THE SPEED LIMIT IN FEET) APART.
3. ALL DISTANCES ARE DESIRABLE MINIMUMS, FIELD CONDITIONS SHALL CONTROL THE ACTUAL PLACEMENT.
4. TAPER RATES ARE BASED ON THE POSTED MAINLINE AND EXIT SPEEDS.
5. LANE CLOSURES AND TAPER LENGTHS, L, AS DETAILED ON STANDARD E-103.
6. ALL SIGNING AND DELINEATION DEVICES, AS DETAILED ON THIS SHEET, AND AS REQUIRED BY THE RESIDENT ENGINEER, SHALL BE PAID UNDER ITEM 641.10 TRAFFIC CONTRL.
7. MAINLINE TRAFFIC CONTROL PLAN SHALL BE TREATED AS A MOBILE OPERATION AND SHALL BE IN CONFORMANCE WITH VAOT STANDARD E-112 TRAFFIC CONTROL FOR TYPICAL MOVING MAINTENANCE OPERATIONS.

### NOTES:

1. WHEN MARKING EQUIPMENT IS WORKING AT OR NEAR EXIT OR ENTRANCE RAMPS, UNIFORMED TRAFFIC CONTROL OFFICERS SHOULD BE USED TO ASSIST IN CONTROLLING TRAFFIC.
2. ALL SIGNS SHALL BE PLACED BEFORE ANY WORK BEGINS OR EQUIPMENT IS PUT ON THE ROADWAY. SIGNS SHALL BE COVERED OR REMOVED WHEN NOT APPLICABLE.
3. PORTABLE SIGNS SHALL BE KEPT LEVEL WHEN PLACED ON THE EDGE OF ROADWAY AND ALL VEGETATION THAT INTERFERES WITH VISIBILITY OF THE SIGNS SHALL BE REMOVED. PAYMENT SUBSIDIARY TO OTHER ITEMS.
4. WARNING LIGHTS SHALL NOT BE USED ON CHANNELIZING DEVICES.
5. THE NUMBER OF CHANNELIZING DEVICES, TYPE III BARRICADES AND OTHER TRAFFIC CONTROL DEVICES SHOWN ON THIS SHEET ARE FOR ILLUSTRATIVE PURPOSES ONLY. THE ACTUAL NUMBER REQUIRED ARE TO BE DETERMINED BASED ON INDIVIDUAL DETOUR CONDITIONS (TAPERS, LENGTH OF DETOUR CURVE, ETC.).

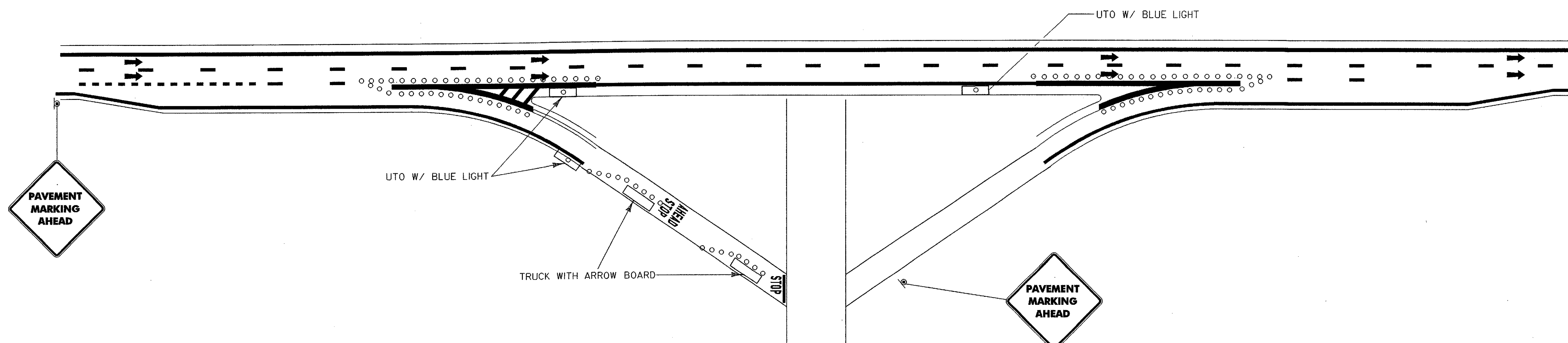

### LEGEND

- REFL. 28" CONES
- ↑ INDICATES TRAFFIC FLOW
- ⊠ FLASHING ARROW PANEL
- TYPE III BARRICADES
- ⊞ TYPE III BARRICADES (MOD.)
- (500) - DENOTES DISTANCE FROM BEGIN MERGE TAPER
- ⊞ - TRUCK/TRAILER MOUNTED ATTENUATOR (OPTIONAL)

NOT TO SCALE

pave/99k318/mark100.dgn/mark005.1

PROJECT STATEWIDE INTERSTATE PAVEMENT MARKING CONTRACT IMG MARK (199)

SHEET 5 OF 12 SHEETS

## SUMMARY BY INTERCHANGE OF QUANTITIES & MATERIALS

TOWN	ROUTE	MM	EXIT	DIR	ROADWAY TYPE	WHITE LINE	MTL	YELLOW LINE	MTL	12" WHITE	MTL	LETTER & SYM.	MTL	STOP BAR	MTL	REM	4" WHITE	CROSS WALK	REMARKS
QUECHEE	I-89	3.70	1	NB	RAMP	2242	P	2079	P	854	P	9	TP	13	TP	-	-	-	STOP(1) AHEAD(1) STOP (1T*)
				SB	RAMP	2793	P	1699	P	916	P	-	T*	-	-	-	-	-	-
SHARON	I-89	8.90		NB	REST AREA					550									NO MARKING IN 2001 RECONSTRUCTION
SHARON		8.90		SB	REST AREA	1061	P	1174	P	550	P	2	P	-	-	-	199	-	HC (2)
SHARON	I-89	13.40	2	NB	RAMP	1886	P	1886	P	1199	P	13	P	50	P	-	-	-	STOP(2) AHEAD(1)
				SB	RAMP	1673	P	1673	P	994	P	13	P	49	P	-	-	-	-
ROYALTON	I-89	22.10	3	NB	RAMP	3126	P	2864	P	1242	P	9	P	-	T*	-	-	-	STOP(1) AHEAD(1) STOP(T*)
				SB	RAMP	2406	P	2406	P	756	P	9	P	-	T*	-	-	-	-
RANDOLPH	I-89	29.65		SB	WEIGH STA	919	P	617	P	1130	P	-	P	-	P	-	-	-	
RANDOLPH	I-89	30.90	4	NB	RAMP	2871	P	2637	P	1311	P	-	T	-	T*	-	-	-	SEE DURABLE SUMMARY
				SB	RAMP	1300	P	1300	P	863	P	-	T*	-	T*	-	-	-	-
RANDOLPH		34.50		NB	REST AREA	2659	P	2410	P	734	P	7	P	-	-	-	402	-	YIELD(1) HC(2)
RANDOLPH		33.60		SB	REST AREA	2299	P	2459	P	1362	P	9	P	-	-	-	308	-	YIELD(1) HC(4)
WILLIAMSTOWN	I-89	43.00	5	NB	RAMP	1707	TP	1484	P	668	P	5	TP	-	T*	-	-	-	YIELD(1) YIELD(1T*) STOP(1T*) AHEAD(1T*)
NORTHFIELD				SB	RAMP	-	T*	-	T*	-	T*	-	T*	-	T*	-	-	-	STOP(2T*) AHEAD(1T*) YIELD(1T*)
SO. BARRE	I-89	46.90	6	NB	RAMP	1692	P	1534	P	1872	P	15	TP	-	T*	-	-	-	YIELD(2) AHEAD(1)
				SB	RAMP	-	T*	-	T*	-	T*	-	T*	-	T*	-	-	-	-
BERLIN	I-89	50.30	7	NB	RAMP														PROJECT IM089-1(12)
				SB	RAMP		T*	-	T*	-	T*	-	T*	-	T*	-	-	-	-
MONTPELIER	I-89	52.90	8	NB	RAMP	1727	P	1297	P	1275	P	-	T*	-	T*	-	-	-	NB OFF (RAMP A) W/PROJECT IM089-1(21)
				SB	RAMP	1590	P	1590	P	718	P	-	T*	-	T*	-	-	-	-
MIDDLESEX	I-89	58.70	9	NB	RAMP	1302	TP	748	TP	734	TP	14	TP	32	TP	-	-	-	STOP(1) AHEAD(1) YIELD(1) STOP(2TE)
				SB	RAMP	1585	TP	965	TP	1333	TP	5	TP	32	TP	-	-	-	-
WATERBURY	I-89	63.80	10	NB	RAMP	3098	TP	2597	TP	359	P	-	T	-	T*	-	-	-	SEE DURABLE SUMMARY
				SB	RAMP	2294	TP	2158	TP	656	TP	-	T*	-	T*	-	-	-	-
WATERBURY	I-89	65.80		NB	PARKING AREA														CLOSED FOR IM-089-2(26) (TWO YEARS)
				SB	PARKING AREA														
RICHMOND	I-89	78.50	11	NB	RAMP	3598	TP	3504	TP	771	TP	18	TP	18	TP	-	-	-	STOP(2) AHEAD(1) YIELD(1)
				SB	RAMP	2189	TP	1216	TP	693	TP	38	TP	38	TP	-	-	-	-
WILLISTON	I-89	82.20		NB	REST AREA					761	P								NO MARKING IN 2001*RECONSTRUCTION
				SB	REST AREA		T*		T*		T*		T*						
	I-89	84.00	12	NB	RAMP	2012	P	1761	P	605	P	10	TP	50	P				ONLY(2) ARROW RT(1) ARROW LT (1)
				SB	RAMP	-	T*	-	T*	-	T*	-	T*	-	T*				STOP(3) AHEAD(1)

### LEGEND

T= TO BE MARKED WITH DURABLE  
 P= TO BE PAINTED  
 TP= TO BE PAINTED OVER OLD DURABLE  
 T\*= DURABLE--NOT TO BE MARKED  
 TE= DURABLE EXPERIMENTAL NOT TO BE MARKED

PROJECT: <b>INTERSTATE PAVING MARKING CONTRACT</b>	PROJECT NO. : <b>IMG MARK(101)</b>
DESIGN FILE NAME: /pave/00k284/mark101.dgn IPARM FILE NAME: markms1.l SURVEYED BY: SQUAD LEADER: WOOLAVER	PLOT DATE: 06-APR-2001 SURVEY DATE: DRAWN BY: SHEET: 6 OF 12

DATUM  
 VERTICAL \_\_\_\_\_  
 HORIZONTAL \_\_\_\_\_

## SUMMARY BY INTERCHANGE OF QUANTITIES & MATERIALS

TOWN	ROUTE	MM	EXIT	DIR	ROADWAY TYPE	WHITE LINE	MTL	YELLOW LINE	MTL	12" WHITE	MTL	LETTER & SYM.	MTL	STOP BAR	MTL	REM	4" WHITE	CROSS WALK	REMARKS	
SO. BURLING	I-189	87.40	13	NB	RAMP	2880	P	2720	P	1000	P	-	T	-	T	-	-	-	SEE SUMMARY OF DURABLE MARKINGS	
				SB	RAMP	2122	P	1970	P	2740	P	-	T	-	T	-	-	-	-	SEE SUMMARY OF DURABLE MARKINGS
BURLINGTON	I-89	88.70	14	NB	RAMP	4235	P	3868	P	1118	P	-	P	-	P	-	-	-	SEE SUMMARY OF DURABLE MARKINGS	
				SB	RAMP	-	T*	-	T*	-	T*	-	-	-	-	-	-	-	-	SEE SUMMARY OF DURABLE MARKINGS
WINOOSKI	I-89	90.50	15	NB	RAMP	1341	P	621	P	798	P	25	TP	40	TP	-	-	-	SIGNAL(1) AHEAD(1) STOP(1) ONLY(2) ARROWS LT(2)	
				SB	RAMP	1058	P	558	P	302	P	5	P	-	-	-	-	-	-	YIELD(1)
WINOOSKI	I-89	91.50	16	NB	RAMP	966	P	834	P	746	P	-	T*	34	P	-	-	-		
				SB	RAMP	1607	P	1607	P	845	P	14	TP	34	P	-	-	-	-	SIGNAL(1)TE) AHEAD(1)TE) ONLY(2) SINGLE ARROW RT(2) DOUBLE ARROW(2)
COLCHESTER	I-89	95.50		NB	WEIGH STA.	-	T*	-	T*	-	T*	-	T*	-	T*	-	-	-		
				SB	WEIGH STA.	-	T*	-	T*	-	T*	-	T*	-	T*	-	T*	-	-	-
COLCHESTER		97.90	17	NB	RAMP	3138	P	2989	P	352	P	18	P	25	P	-	-	-	STOP(2) AHEAD(1) YIELD(1)	
				SB	RAMP	2359	P	2107	P	360	P	28	P	39	P	-	-	-	-	STOP(2) AHEAD(2) YIELD(2)
GEORGIA	I-89	106.6	18	NB	RAMP	1778	P	1670	P	572	P	13	P	34	P	-	-	-	STOP(2) AHEAD(1)	
				SB	RAMP	2167	P	1946	P	526	P	13	P	32	P	-	-	-	-	STOP(2) AHEAD(1)
GEORGIA	I-89	110.2		NB	REST AREA	-	T*	-	T*	-	T*	-	T*	-	T*	-	-	-		
FAIRFAX	I-89	111.0		SB	REST AREA	-	T*	-	T*	-	T*	-	T*	-	T*	-	-	-		
ST. ALBANS(SO)	I-89	113.7	19	NB	RAMP	-	-	-	-	-	-	-	-	-	-	-	-	-	PROJECT IM089-3(27)	
				SB	RAMP	-	-	-	-	-	-	-	-	-	-	-	-	-	-	PROJECT IM089-3(27)
ST. ALBANS(NO)	I-89	117.6	20	NB	RAMP	1575	P	1389	P	1559	P	13	P	46	P	-	-	-	STOP(2) AHEAD(1)	
				SB	RAMP	3395	P	1558	P	1243	P	13	P	23	P	-	-	-	-	STOP(2) AHEAD(1)
SWANTON	I-89	123.4	21	NB	RAMP	1114	P	1128	P	825	P	13	P	64	P	-	-	-	STOP(2) AHEAD(1)	
				SB	RAMP	1352	P	1312	P	-	T*	13	P	69	P	-	-	-	-	STOP(2) AHEAD(1)
HIGHGATE	I-89	129.9	22	NB	RAMP	1624	P	1458	P	567	P	17	P	65	P	-	-	-	STOP(3) AHEAD(1)	
				SB	RAMP	782	TP	778	P	-	T*	13	P	26	P	-	-	-	-	STOP(2) AHEAD(1)
HIGHGATE	I-89	130.0		SB	REST AREA	731	P	651	P	493	P	-	P	-	P	-	-	-		
				NB	BORDER STA.	-	-	-	-	-	-	-	-	-	-	-	-	-	-	PROJECT IM089-3(34)
				SB	BORDER STA.	-	-	-	-	-	-	-	-	-	-	-	-	-	-	PROJECT IM089-3(34)
GUILFORD	I-91	0.20		IN	WLCM. CTR.	-	T*	-	T*	-	T*	-	T*	-	T*	-	-	-		
				OUT	WLCM. CTR.	-	T*	-	T*	-	T*	-	T*	-	T*	-	T*	-	-	-
BRATTLEBORO	I-91	7.5	1	NB	RAMP	-	T*	-	T*	-	T*	-	T*	-	T*	-	-	-		
				SB	RAMP	-	T*	-	T*	-	T*	-	T*	-	TP	-	-	-	-	
BRATTLEBORO	I-91	9.1	2	NB	RAMP	-	T*	-	T*	-	T*	-	T*	-	T*	-	-	-		
				SB	RAMP	-	T*	-	T*	-	T*	-	T*	-	T*	-	T*	-	-	-
BRATTLEBORO	I-91	11.6	3	NB	RAMP	-	T*	-	T*	-	T*	-	T*	-	T*	-	-	-		

### LEGEND

T= TO BE MARKED WITH DURABLE  
 P= TO BE PAINTED  
 TP= TO BE PAINTED OVER OLD DURABLE  
 T\*= DURABLE--NOT TO BE MARKED  
 TE= DURABLE EXPERIMENTAL NOT TO BE MARKED

PROJECT: <b>INTERSTATE PAVING MARKING CONTRACT</b>	PROJECT NO.: <b>IMG MARK(101)</b>
DESIGN FILE NAME: /pave/00k284/mark101.dgn IPARM FILE NAME: markms2.1	PLOT DATE: 06-APR-2001 SURVEY DATE: DRAWN BY: SQUAD LEADER: WOOLAVER
SHEET: 7 OF 12	

DATUM  
 VERTICAL \_\_\_\_\_  
 HORIZONTAL \_\_\_\_\_

## SUMMARY BY INTERCHANGE OF QUANTITIES & MATERIALS

TOWN	ROUTE	MM	EXIT	DIR	ROADWAY TYPE	WHITE LINE	MTL	YELLOW LINE	MTL	12" WHITE	MTL	LETTER & SYM.	MTL	STOP BAR	MTL	REM	4" WHITE	CROSS WALK	REMARKS
BRATTLEBORO	I-91	11.6	3	SB	RAMP	-	T*	-	T*	-	T*	-	T*	-	T*	-	-		
PUTNEY	I-91	18.2	4	NB	RAMP	953	P	793	P	797	P	13	P	30	P	-	-		STOP(2) AHEAD(1)
	I-91			SB	RAMP	1329	P	1143	P	934	P	13	P	42	P				STOP(2) AHEAD(1)
PUTNEY	I-91	20.4		NB	PRKIG AREA	1316	P	1316	P	832	P	-	P	-	P	170	500		REMOVE LANE LINE INSTALL TRUCK PKG RT.
	I-91	22.0		SB	WEIGH STA.	1344	P	505	P	1041	P								
	I-91	23.2		NB	REST AREA	316	P	451	P	455	P	2	P	-	P	-	572		HC(2)
WESTMINSTER	I-91	23.8		SB	REST AREA	412	P	430	P	564	P								
WESTMINSTER	I-91	28.6	5	NB	RAMP	2400	P	2138	P	608	P	17	P	67	P				STOP(3) AHEAD(1)
				SB	RAMP	1262	P	1102	P	820	P	13	P	50	P				STOP(2) AHEAD(1)
ROCKINGHAM	I-91	35.2	6	NB	RAMP	3000	P	2928	P	1060	P	48	P	25	P				STOP(2) YIELD(4) AHEAD(2) ONLY(2) ARROW(2)
				SB	RAMP	2961	P	2811	P	533	P	18	P	25	P	-	-		STOP(2) AHEAD(1) YIELD(1)
SPRINGFIELD	I-91	39.2		NB	REST AREA	1589	P	1058	P	994	P	4	P	24	P		168		STOP(1)
		39.3		SB	REST AREA		T*		T*		T*		T*		T*				
SPRINGFIELD	I-91	41.7	7	NB	RAMP	2968	P	2993	P	494	P	29	TP	-	T*	-	-		YIELD(3) AHEAD(2) STOP(1T*)
				SB	RAMP		T*		T*		T*		T*		T*				SEE SUMMARY OF DURABLE MARKINGS
WEATHERSFIELD	I-91	51.4	8	NB	RAMP	1765	P	1597	P	845	P	17	T	65	P	-	-		STOP(3) AHEAD(1)
				SB	RAMP		T*		T*		T*		T*		T*				
HARTLAND	I-91	60.5	9	NB	RAMP	1763	P	1615	P	795	P	18	P	36	P	-	-		STOP(2) AHEAD(1) YIELD(1)
				SB	RAMP	2322	P	2178	P	737	P	18	P	48	P	-	-		STOP(2) AHEAD(1) YIELD(1)
HARTFORD	I-91	68.4		NB	REST AREA	1061	P	1346	P	550	P	7	P	-	P	-	65		YIELD(1) HC(2)
HARTFORD		68.5		SB	REST AREA														NO MARKINGS 2001 RECONSTRUCTION
HARTFORD/WRJ	I-91	69.8	10	NB	RAMP	8352	P	7810	P	1324	P	30	P	-	P	-	-		YIELD(4) AHEAD(2)
				SB	RAMP	4396	P	3796	P	1332	P	-	P	-	P	-	-		
HARTFORD	I-91	70.2	11	NB	RAMP	1451	P	1182	P	1075	P	4	P	32	TP				STOP(1)
				SB	RAMP	3578	P	3374	P	1250	P	18	P	34	TP				STOP(2) AHEAD(1) YIELD(1)
HARTFORD	I-91	72.0	12	NB	RAMP	2009	P	1964	P	1453	P	13	P	27	P	-	-		STOP(2) AHEAD(1)
				SB	RAMP	1981	P	1780	P	1674	P	13	P	32	P	-	-		STOP(2) AHEAD(1)
NORWICH	I-91	74.9	13	NB	RAMP	-	T*	-	T*	-	T*	-	T*	-	T*	-	-		SIGNAL(1T*0) AHEAD(1T*) YIELD(1T*)
				SB	RAMP	1772	P	1578	P	713	P	11	P	26	P	-	-		SIGNAL(1) AHEAD(1)
THETFORD	I-91	84.2	14	NB	RAMP	-	T*	-	T*	-	T*	-	T*	-	T*	-	-		
				SB	RAMP	160	P	80	P	-	T*	4	T	34	T	-	-		STOP(1T*)
FAIRLEE	I-91	91.5	15	NB	RAMP	-	T*	-	T*	-	T*	-	T*	-	T*	-	-		STOP(2T*) AHEAD(1T*)
				SB	RAMP		T*		T	-	T*	-	T*		T	-	-		SEE SUMMARY OF DURABLE MARKINGS
BRADFORD	I-91	97.7	16	NB	RAMP	2550	P	2401	P	724	P	23	P	35	P	-	-		STOP(2) AHEAD(1) YIELD(2)
				SB	RAMP	110	P	80	P	-	T*	4	P	41	TP	-	-		STOP(1) STOP(1T*) AHEAD(1T*)

### LEGEND

T= TO BE MARKED WITH DURABLE  
 P= TO BE PAINTED  
 TP= TO BE PAINTED OVER OLD DURABLE  
 T\*= DURABLE--NOT TO BE MARKED  
 TE= DURABLE EXPERIMENTAL NOT TO BE MARKED

PROJECT: <b>INTERSTATE PAVING MARKING CONTRACT</b>	PROJECT NO.: <b>IMG MARK(101)</b>
DESIGN FILE NAME: /pave/00k284/mark101.dgn IPARM FILE NAME: markms3.1	PLOT DATE: 06-APR-2001 SURVEY DATE: DRAWN BY: SQUAD LEADER: WOOLLAVER
SHEET: 8 OF 12	

DATUM  
 VERTICAL \_\_\_\_\_  
 HORIZONTAL \_\_\_\_\_

## SUMMARY BY INTERCHANGE OF QUANTITIES & MATERIALS

TOWN	ROUTE	MM	EXIT	DIR	ROADWAY TYPE	WHITE LINE	MTL	YELLOW LINE	MTL	12" WHITE	MTL	LETTER & SYM.	MTL	STOP BAR	MTL	REM	4" WHITE	CROSS WALK	REMARKS
BRADFORD	I-91	100.1		NB	REST AREA	712	P	699	P	652	P	2	P	-	P		351		HC(2)
BRADFORD	I-91	100.2		SB	REST AREA	699	P	650	P	592*	P	2	P	28*	P		540		HC(2) *INCLUDES QUANT. FOR HC MARKING
NEWBURY	I-91	110.4	17	NB	RAMP	1671	P	1500	P	831	P	13	P	38	P	25			STOP(2) AHEAD(1) REMOVE YIELD
				SB	RAMP	954	P	938	P	390	P	18	P	64	P				STOP(2) AHEAD(1) YIELD(1)
				SB	RAMP		-		-		-		T*		T*				
RYEGATE	I-91	113.4		NB	REST AREA	2027	P	1800	P	1120	P	5	P	-	P				YIELD(1)
	I-91	115.4		SB	REST AREA		T*		T*		T*		T		T		2505		SEE SUMMARY OF DURABLE MARKINGS
BARNET	I-91	120.4	18	NB	RAMP	1935	P	1914	P	888	P	13	P	46	P				STOP(2) AHEAD(1)
				SB	RAMP		T*		T*		T*		T		T*	55			RELOCATE STOP(T) AHEAD(T) TO SIGN LOCATION
BARNET	I-91	121.8			SCENIC VIEW	616	P	464	P	781	P	-	P	-	P				
I-93 WATERFORD	I-91	128.1	19	NB	RAMP		T*		T*		T*		T*		T*				
				SB	RAMP		T*		T*		T*		T*		T*				
ST. JOHNSBURY	I-91	128.9	20	NB	RAMP		T*		T*		T*	26	TP	73	TP				STOP(4) AHEAD(2)
				SB	RAMP		T*		T*		T*		TE		T				
ST. JOHNSBURY	I-91	130.6	21	NB	RAMP		T*		T*		T*		T		T*				SEE DURABLE MARKING SUMMARY
	I-91	130.6	21	SB	RAMP		T		T*		T*		T		T				SEE DURABLE MARKINGS SUMMARY
	I-91	132.5	22	SB	RAMP		T		T		T		T		T				SEE DURABLE MARKINGS SUMMARY
	I-91	132.5	22	NB	RAMP		T*		T*		T*		T		T				SEE DURABLE MARKINGS SUMMARY
LYNDON	I-91	137.1	23	NB	RAMP	1291	P	406	P	898	P	13	T	39	TP			40P	STOP(2) AHEAD(1) XWALK 40
	I-91	137.1	23	NB	RAMP		T*		T*		T*		T			55			STOP(1T) AHEAD(1T) RELOCATE TO SIGN LOCATION
				SB	RAMP	1522	P	1258	P	363	P	13	P	41	P				STOP(1) AHEAD(1) YIELD(1T*)
LYNDON	I-91	140.1	24	NB	RAMP		P		P		P		P		P				PROJECT IM-091-1( )
				SB	RAMP	2231	P	2010	P	591	P	13	P	34	P	30			STOP(2) AHEAD(1) REMOVE YIELD(1)
LYNDON	I-91	140.8		SB	REST AREA	1004	P	1230	P	966	P	7	P	-	P		474		YIELD(10) HC(2)
WHEELLOCK	I-91	142.9		NB	SCENIC VIEW		P		P		P	-	-	-	P				PROJECT IM-091-1( )
GLOVER	I-91	154.0		NB	SCENIC VIEW		P		P		P	-	-	-	P				PROJECT IM-091-1( )
BARTON	I-91	155.9	25	NB	RAMP	1378	P	1378	P	596	P	13	P	50	P				STOP(2) AHEAD(1) NB ON WITH IM-091-1( )
			25	SB	RAMP	810	P	640	P	345	P	13	P	40	P				STOP(2) AHEAD(1)
ORLEANS	I-91	161.6	26	NB	RAMP	2382	P	2184	P	1434	P	18	P	20	P				STOP(2) AHEAD(1) YIELD(1)
				SB	RAMP	2556	P	2124	P	1072	P	22	P	66	P				STOP(3) AHEAD(1) YIELD(1)
COVENTRY	I-91	166.8		NB	REST AREA	1834	P	1618	P	2464	P	5	P	-	P				YIELD(1)
COVENTRY					REST AREA	1992	P	2008	P	1536	P	5	P	-	P				YIELD(1) HC(2T*)
NEWPORT	I-91	170.1	27	NB	RAMP	2838	P	2509	P	640	P	18	P	20	P				STOP(2) AHEAD(1) YIELD(1)
				SB	RAMP	2472	P	2102	P	1118	P	23	P	26	P				STOP(2) AHEAD(1) YIELD(2)
DERBY	I-91	172.5	28	NB	RAMP	2182	P	1980	P	818	P	22	P	46	P				STOP(3) AHEAD(1) YIELD(1)

### LEGEND

T= TO BE MARKED WITH DURABLE  
 P= TO BE PAINTED  
 TP= TO BE PAINTED OVER OLD DURABLE  
 T\*= DURABLE--NOT TO BE MARKED  
 TE= DURABLE EXPERIMENTAL NOT TO BE MARKED

PROJECT: <b>INTERSTATE PAVING MARKING CONTRACT</b>	PROJECT NO.: <b>IMG MARK(101)</b>
DESIGN FILE NAME: /pave/00k284/mark101.dgn IPARM FILE NAME: markms4.i SURVEYED BY: SQUAD LEADER: WOOLLAVER	PLOT DATE: 10-APR-2001 SURVEY DATE: DRAWN BY: SHEET: 9 OF 12

DATUM  
 VERTICAL \_\_\_\_\_  
 HORIZONTAL \_\_\_\_\_

## SUMMARY BY INTERCHANGE OF QUANTITIES & MATERIALS

TOWN	ROUTE	MM	EXIT	DIR	ROADWAY TYPE	WHITE LINE	MTL	YELLOW LINE	MTL	12" WHITE	MTL	LETTER & SYM.	MTL	STOP BAR	MTL	REM	4" WHITE	CROSS WALK	REMARKS
DERBY	I-91	172.5		SB	RAMP	2678	P	2486	P	895	P	18	P	33	P				STOP(2) AHEAD(1) YIELD(1)
DERBY	I-91	176.4		SB	REST AREA	2035	P	1590	P	1914	P	2	P	48*	P		864		HC(2) * INCLUDES QUANT FOR HC MARKINGS
DERBY	I-91	177.2	29	NB	RAMP	2313	P	2200	P	1049	P	18	P	22	P				STOP(2) AHEAD(1) YIELD(1)
			29	SB	RAMP	1949	P	1145	P	466	P	4	P	16	P				STOP(1)
DERBY	I-91	177.3			BORDER STA.		P		P		P	45	P	-	P				STOP(6) AHEAD(2) CARS(1) REPORT(1) ARROW(1)
S. BURLINGTON	I-189	ML			MAINLINE	18401	P	14784	P	-	-	22	T						SIGNAL(2) AHEAD(2)
	I-189	0.2	1			1974	P	1754	P	478	P	22	P						
S. BURLINGTON	DORSET	ST	1	NB	RAMP	430	T	120	T	247	T	26	T	55	T			56	ONLY(4) ARROW LT(4) UP(2) DOUBLE RT(2)
S. BURLINGTON	@US7		2	SB	RAMP	140	TAPE	300	TAPE	385	TAPE	48	TAPE	26	TAPE			46 T	YIELD(1T) ONLY(3T) SOUTH(1T) NORTH(1T) US7(2)
																			ARROWS LT(3T)
																			SB. ARROWS RT(22) DOUBLE LT(3T)

LEGEND

T= TO BE MARKED WITH DURABLE  
 P= TO BE PAINTED  
 TP= TO BE PAINTED OVER OLD DURABLE  
 T\*= DURABLE--NOT TO BE MARKED  
 TE= DURABLE EXPERIMENTAL NOT TO BE MARKED

PROJECT: <b>INTERSTATE PAVING MARKING CONTRACT</b>	PROJECT NO.: <b>IMG MARK(101)</b>
DESIGN FILE NAME: /pave/00k284/mark101.dgn IPARM FILE NAME: mark005.i	PLOT DATE: 06-APR-2001 SURVEY DATE: SURVEYED BY: SQUAD LEADER: WOOLAVER
	DRAWN BY: SHEET: 10 OF 12

DATUM  
 VERTICAL \_\_\_\_\_  
 HORIZONTAL \_\_\_\_\_

## SUMMARY OF DURABLE MARKINGS TO BE INSTALLED

TOWN	ROUTE	MM	MM EXIT	DIR	ROADWAY TYPE	6" DUR. WHITELINE	MTL	6" DUR. YEL. LINE	MTL	12" DUR. WHITELINE	MTL	DUR LET & SYMB.	MTL	DUR. STOP BAR	MTL	REMOVAL	4" WHITE	CROSS WALK	REMARKS
WILLISTON	I-89	84.00	12	SB	RAMPS							44	T	75	T				SIGNAL(2T) AHEAD(2T) ARROWS LT(3T) ONLY(4T) ARROW RT(3T)
WINOOSKI	I-89	91.50	16	NB	RAMPS							53	T						ONLY(9T) SIGNAL(1T) AHEAD(1T) ARROWS L(3T) ARROWS RT(3T)
MAINLINE	I-89	91.38	98.00	NB	MAINLINE	5000	T												THERMO REPAIR
MAINLINE	I-89	79.00	89.96	SB	MAINLINE	52 536	T	42 029	T	-	-	-	-	-	-	-	-	-	
RANDOLPH	I-89	30.90	4	NB	RAMP	-	-	-	-	-	-	4	T						STOP(1T) STOP(1T*) AHEAD(1T*)
WATERBURY	I-89	63.80	10	NB	RAMP	-	-	-	-	-	-	4	T						ARROWS(4T) ALL OTHER TE OR T*
SO. BURLINTN	I-89	87.40	13	SB	RAMP							15	T						YIELD(2T) AHEAD(1T)
BURLINGTON	I-89	88.70	14	N/S	RAMP							61	T						YIELD(6T) AHEAD(4T) SIGNAL(2)
MAINLINE	I-91	0.00	11.91	N/S	MAINLINE	-	-	125 770	T	-	-	-	-	-	-	-	-	-	
MAINLINE	I-91	133.2	137.1	SB	MAINLINE	26 268	T	21 014	T	-	-	-	-	-	-	-	-	-	
MNL INE REPAIR	I-91	150.7	155.9	SB	MAINLINE	6 875	T	5 500	T	-	-	-	-	-	-	-	-	-	SELECTED REAPPLICATION EST. QUANT.
40MIL SPRAY	I-91	162.0	172.5	SB	MAINLINE	89 166	T	71 333	T										40 MIL SPRAY CAT II EXPERIMENT. FEATURE
SPRINGFIELD	I-91	41.7	7	SB	RAMP	-	T	-	T	-	-	5	T	-	-	-	-	-	YIELD(1T) STOP(2T*) AHEAD(1T*) YIELD(1T*)
FAIRLEE	I-91	91.5	15	SB	RAMP	210	T	110	T	-	-	-	-	28	T				
RYEGATE	I-91	115.4		SB	REST AREA	-	-	-	-	-	-	5	T	-	-	-	-	-	HC(2T*) YIELD(1T)
BARNET	I-91	120.4	18	SB	RAMP	-	-	-	-	-	-	9	T	-	-	-	-	-	RELOCATE STOP AHEAD TO SIGN LOCATION
ST. JOHNSBURY	I-91	130.6	21	NB	RAMP							13	T						STOP(2T) AHEAD(1T)
ST. JOHNSBURY	I-91	130.6	21	SB	RAMP	1 325	T	-	-	-	-	13	T	16	T	-	-	-	STOP(2) AHEAD(1T)
ST. JOHNSBURY	I-91	132.5	22	NB	RAMP	260	T	-	-	-	-	-	-	54	T	-	-	-	
				SB	RAMP	180	T	180	T	-	-	13	T	62	T	-	-	-	STOP(2T) AHEAD(T)
LYNDON	I-91	137.1	23	NB	RAMP							9	T					40T	RELOC. STOP(1T) AHEAD(1T) TO SIGN LOCATION
S. BURLINGTON	I-189			SB	MAINLINE	-	-	-	-	-	-	22	T	-	-	-	-	-	SIGNAL(2T) AHEAD(2T)
S. BURLINGTON	I-189	@US7		SB	RAMP M/L	140	TAPE	300	TAPE	250	TAPE	-	TAPE	26	TAPE			46	YIELD(1T) ONLY(3T) SOUTH(1T) NORTH(1T) US7(2T) ARROWS(2T)
																			NOTE: DOUBLE ARROWS PAID AS TWO EACH
S. BURLINGTON	I-189	@DORSET ST.		SB	RAMP	430	T	120	T	247	T	26	T	55	T			55 T	ONLY(4T) ARROWS LT(4T) UP(2T) DOUBLE RT(2T)
																			NOTE: DOUBLE ARROWS PAID AS TWO EACH

### LEGEND

T= TO BE MARKED WITH DURABLE  
 P= TO BE PAINTED  
 TP= TO BE PAINTED OVER OLD DURABLE  
 T\*= DURABLE--NOT TO BE MARKED  
 TE= DURABLE EXPERIMENTAL NOT TO BE MARKED

DATUM  
 VERTICAL \_\_\_\_\_  
 HORIZONTAL \_\_\_\_\_

PROJECT: <b>INTERSTATE PAVING MARKING CONTRACT</b>	PROJECT NO.: <b>IMG MARK(101)</b>
DESIGN FILE NAME: /pave/00k284/mark101.dgn IPARM FILE NAME: markms6.1	PLOT DATE: 12-APR-2001 SURVEY DATE: DRAWN BY: SQUAD LEADER: WOOLAVER
SHEET: 11 OF 12	

## SUMMARY MARKINGS BY PROJECT AC-IM-IR-089-1(8)

TOWN	ROUTE	MM	MM EXIT	DIR	ROADWAY TYPE	6" DUR. WHITELINE	MTL	6" DUR. YEL. LINE	MTL	12" DUR. WHITELINE	MTL	DUR LET & SYMB.	MTL	DUR. STOP BAR	MTL	REMOVAL	4" WHITE	CROSS WALK	REMARKS	
<b>PROJECT AC IM IR 089-1(8) DURABLES NOT TO BE MARKED WITH THIS CONTRACT</b>																				
HARTFORD	I-89	1.10	BR6	NB	BRIDGE	1 793	T	1 434	T											NOTE: CLOSE COORDINATION WITH THE RESIDENT ENGINEER WILL BE NECESSARY AS A LANE CLOSURE WILL OCCUR TO ALLOW LEDGE REMOVAL AT SOME TIME DURING THE PERIOD OF THIS CONTRACT.
	I-89	1.10	BR6	SB	BRIDGE	1 780	T	1 424	T											
SHARON	I-89	13.4	BR15	NB	BRIDGE	1 756	T	1 405	T											
SHARON	I-89	13.4	BR15	SB	BRIDGE	1 758	T	1 406	T											
	I-89	13.9	BR16	NB	BRIDGE	3 420	T	2 340	T											
	I-89	13.9	BR16	SB	BRIDGE	3 420	T	2 340	T											
	I-89	14.5	BR17	NB	BRIDGE	3 420	T	2 340	T											
	I-89	14.5	BR17	S	BRIDGE	3 420	T	2 340	T											
	I-89	14.65	BR18	NB	BRIDGE	3 420	T	2 340	T											
	I-89	14.65	BR18	SB	BRIDGE	3 420	T	2 340	T											

LEGEND

- T= TO BE MARKED WITH DURABLE
- P= TO BE PAINTED
- TP= TO BE PAINTED OVER OLD DURABLE
- T\*= DURABLE--NOT TO BE MARKED
- TE= DURABLE EXPERIMENTAL NOT TO BE MARKED

DATUM  
 VERTICAL \_\_\_\_\_  
 HORIZONTAL \_\_\_\_\_

PROJECT: <b>INTERSTATE PAVING MARKING CONTRACT</b>	PROJECT NO. : <b>IMG MARK(101)</b>
DESIGN FILE NAME: /pave/00k284/mark101.dgn IPARM FILE NAME: markms7.i SURVEYED BY: SQUAD LEADER: WOOLAVER	PLOT DATE: 06-APR-2001 SURVEY DATE: DRAWN BY: SHEET: 12 OF 12