

INDEX OF SHEETS	
SHEET 1	TITLE PAGE
2-4	TYPICAL SECTIONS
5-6	R.O.W. DETAIL SHEETS
7-12	R.O.W. LAYOUT SHEETS
13-17	PROFILE SHEETS

STATE OF VERMONT AGENCY OF TRANSPORTATION



PROPOSED IMPROVEMENT TOWN OF WILLISTON COUNTY OF CHITTENDEN CHITTENDEN COUNTY CIRCUMFERENTIAL HIGHWAY VERMONT ROUTE 289

BEGINNING AT A POINT APPROXIMATELY 0.108 MILES SOUTHERLY
OF ROUTE 2 THEODORE ROOSEVELT HIGHWAY AND
EXTENDING SOUTHERLY 0.551 MILES
LENGTH OF ROADWAY 2647.28 FT = 0.501 MILE
LENGTH OF BRIDGE 259.72 FT = 0.049 MILE
LENGTH OF PROJECT 2907.00 FT = 0.551 MILE

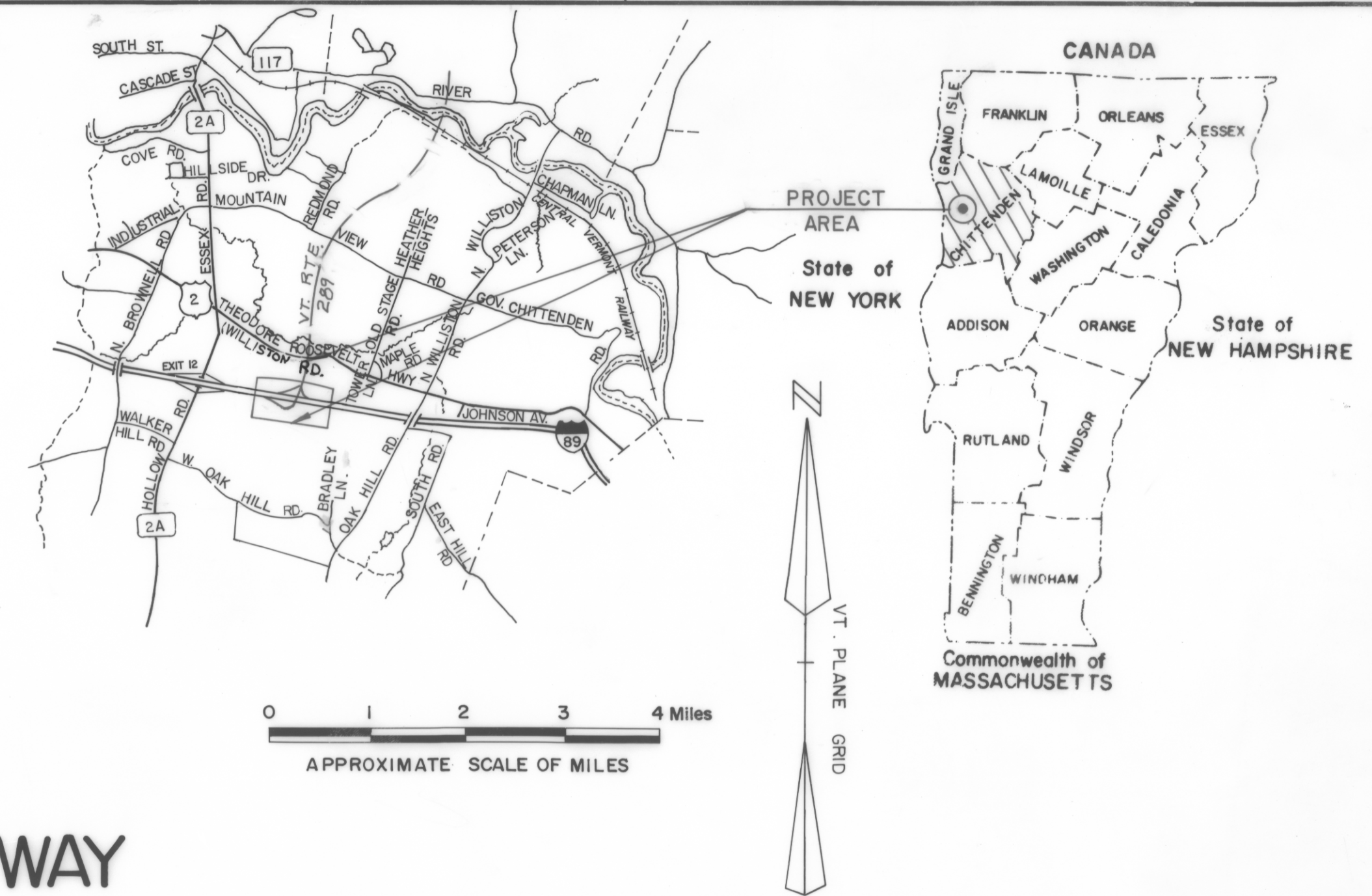

TRAFFIC DATA	
1984	ADT
2004	ADT 16000
1984	DHV
2004	DHV 1500
	T 5%
	V 50 MPH

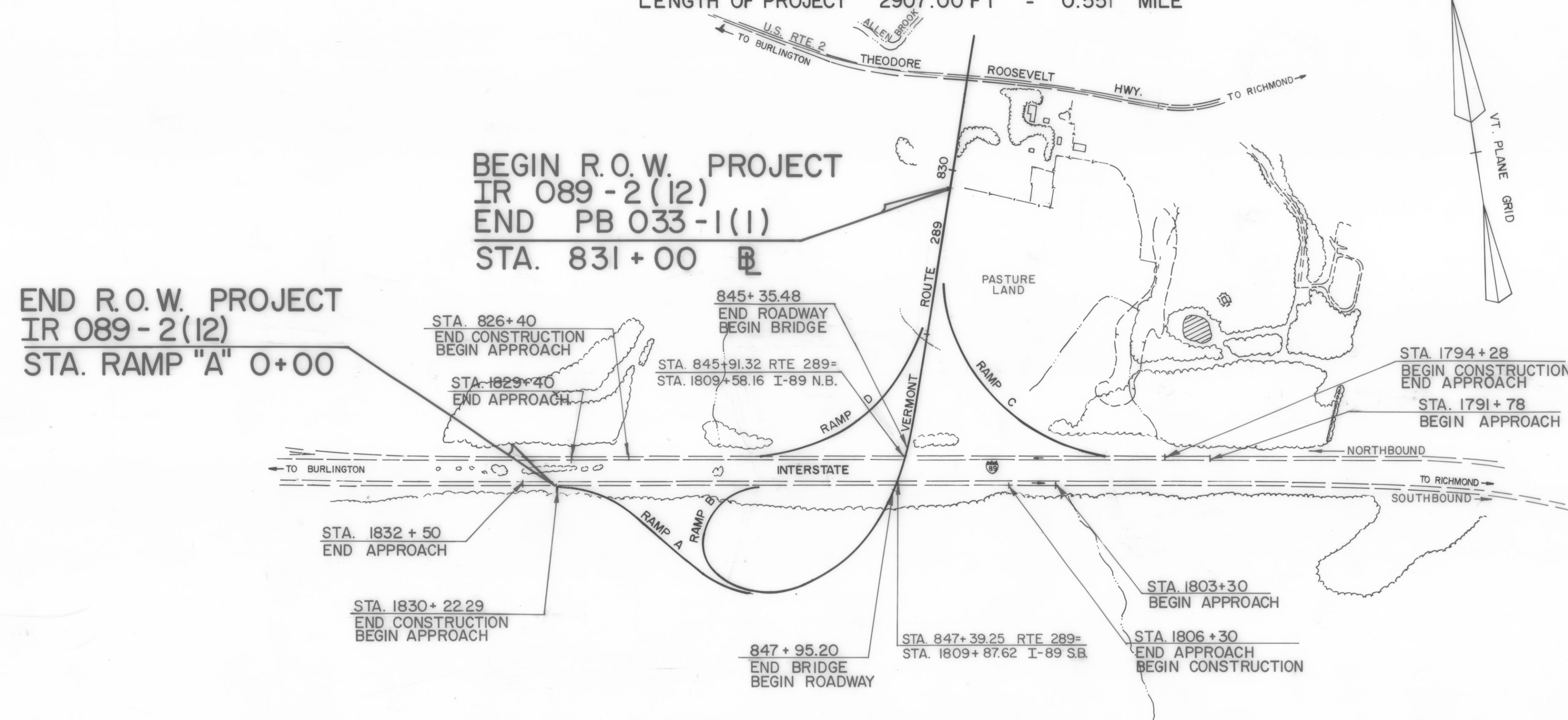

R. O. W. PLANS

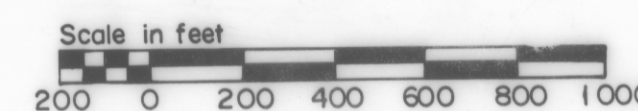

CONVENTIONAL SIGNS	
COUNTY LINE	---
TOWN LINE	- - - -
LIMITS OF ACCESS	○—○—○
POINT OF ACCESS	○—X
FENCE LINE	-x-x-
STONE WALL	—x—x—x—
TRAVELED WAY	—x—x—x—
GUARD RAIL	—o—o—o—
RAILROAD	—+—+—+—
SURVEY LINE	—+—+—+—
CULVERT	—+—+—+—
POWER POLE	—+—+—+—
TELEPHONE POLE	—+—+—+—
TREES	—+—+—+—
CONTROL OF ACCESS	—+—+—+—
PROPERTY LINE	—+—+—+—
R.O.W. TAKING LINE	—+—+—+—
SLOPE RIGHTS	—+—+—+—
TOP OF CUT	—+—+—+—
TOE OF SLOPE	—+—+—+—

DATUM	
VERTICAL	NGVD 1929
HORIZONTAL	N/A

These plans are subject to such engineering changes as may be required by the Federal Highway Administration or the Chief Engineer.

Construction is to be carried on in accordance with these plans and the Standard Specifications for Construction dated 1986, for use on these projects, including all subsequent provisions as are incorporated in these plans.

APPROVED DATE 7/10/89	RIGHT OF WAY DIRECTOR
SUBMITTED BY ORDER OF THE STATE TRANSPORTATION BOARD	
APPROVED DATE 7/10/89	DIRECTOR OF ENGINEERING AND CONSTRUCTION
DEPARTMENT OF TRANSPORTATION FEDERAL HIGHWAY ADMINISTRATION	
APPROVED _____ DATE _____	DIVISION ADMINISTRATOR
PROJECT No IR - 089 - 2(12)	
WILLISTON	
SHEET 1 OF 17 SHEETS	