

BEGIN RAMP "B"  
 STA. B19+84.06, 23' LT. =  
 BN I-89 NB SURV. STA. 19+86.30,  
 16.98' RT.

END RAMP "BB"  
 STA. BB29+95.11, 22' LT. =  
 BN RAMP "B" STA. B29+89.74, 22' LT.  
 BEGIN RAMP "BB"  
 STA. BB31+66.66 =  
 SURV. STA. 246+65.28, 37.04' LT.

END RAMP "B"  
 STA. B32+18.65, 22' LT. =  
 BN SURV. STA. 244+73.69,  
 44' LT.

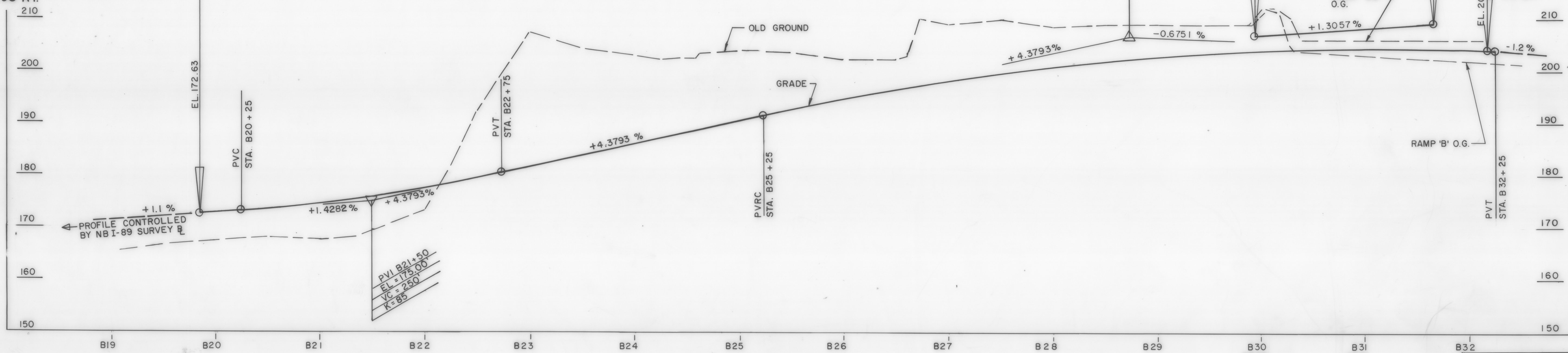

RAMP "B"  
 SCALE: 1" = 50' H  
 1" = 10' V

**R.O.W. PLAN**  
 THIS SHEET TO BE USED  
 FOR R.O.W. INFORMATION  
 ONLY.

BEGIN RAMP "C"  
 STA. C55+08.19, 22' LT. =  
 BN SURV. STA. 247+37.00,  
 54.42' LT.  
 BEGIN RAMP "CC"  
 STA. CC54+91.00 =  
 SURV. STA. 246+69.28,  
 37.21' LT.

END RAMP "CC"  
 STA. CC56+41.01 =  
 RAMP "BB" STA. BB30+16.48,  
 4' LT.

END RAMP "C"  
 STA. C67+60.55, 23' LT. =  
 BN I-89 NB SURV. STA. 27+81.84,  
 8.96' RT.



RAMP "C"  
 SCALE: 1" = 50' H  
 1" = 10' V

VT. SURVEY  
 CONSULTANTS DATE JAN.-89  
 DRAWN BY BRYANT ASSOC. DATE  
 TRACED BY DATE  
 COLCHESTER  
 PROJ. IR NO. 089-3(11)  
 SHEET 17 OF 17