

MAZZA, SAMUEL P. JR & ANNETTE M.

RAMP "A" CURVE DATA #2
 $D = 10^{\circ} 19' 45''$ RT.
 $\Delta = 10^{\circ} 19' 45''$ RT.
 $R = 2864.79'$
 $T = 258.94'$
 $L = 516.47'$
 $E = 11.68'$
 $BANK = 0.027$ FT/FT
 PCC STA. 17+79.41
 PT STA. 22+95.87

RAMP "A" CURVE DATA #1
 $D = 1^{\circ} 00' 00''$
 $\Delta = 7^{\circ} 47' 39''$ RT.
 $R = 5729.58'$
 $T = 390.31'$
 $L = 779.41'$
 $E = 13.28'$
 $BANK = 0.026$ FT/FT
 PC STA. 10+00.00
 PCC STA. 17+79.41

OPEN GRADE FRICTION COURSE
RAMP "A" STA. A10+00 ~ A16+50, DECEL. LANE
NB I-89 STA. 29+00 ~ 34+00, ACCEL. LANE

REMOVAL & DISPOSAL OF GUARD RAIL
SB I-89 STA. 81+69 ~ 87+47 LT.

NOTE: ALL RAIL, POSTS, & HARDWARE ARE TO BE COLLECTED AND DELIVERED TO TRANSPORTATION DISTRICT # 5 IN COLCHESTER.

STEEL BEAM GUARD RAIL W/WD. POSTS
RAMP "A" STA. A21+75 ~ A22+00 **RAMP "A" STA. A15+75 ~ A22+00**

BREAKAWAY CABLE TERMINAL
RAMP "A" STA. A21+50 ~ A21+75 **RAMP "A" STA. A15+50 ~ A15+75**

WOVEN WIRE FENCE WITH STEEL POSTS
STA. 234+50, 110' LT. - SB I-89 STA. 85+17, 85' LT.
STA. 248+00, 145' LT. - RAMP "C" STA. C60+02, 85' RT.
RAMP "C" STA. C60+02, 85' RT. - RAMP "C" STA. C63+50, 80' RT.
RAMP "C" STA. C63+50, 80' RT. - NB I-89 STA. 27+75, 120' RT.

FOR DRAINAGE DESIGN, SEE SHT. NO.

SHADOW CROSS FARM

REMOVAL OF WOVEN WIRE FENCE WITH STEEL POSTS
NB I-89 STA. 78+37, 85' LT. - SB I-89 STA. 85+17, 85' LT.
STA. 240+20, 114' LT. - NB I-89 STA. 20+87, 132' RT.
NB I-89 STA. 20+87, 132' RT. - NB I-89 STA. 26+80, 132' RT.
NB I-89 STA. 26+80, 132' RT. - NB I-89 STA. 27+75, 120' RT.

RAMP "A" PI#1 A13+90.31 = 13+89.10
 $\Delta = 7^{\circ} 47' 39''$ RT.

BEGIN RAMP "A" GORE
STA. A13+05.36, 16' LT. - SB I-89 STA. 89+94.25, 8.20' LT.

SB I-89 SURV. #
PI STA. 91+31.28
 $\Delta = 5^{\circ} 05' 58''$ LT.

BEGIN RAMP "A"
STA. A10+00.00 = SB I-89 POT. STA. 93+00, 8.5' RT.

END SURV. #
SB I-89 SURV. # POT. STA. 96+00.00

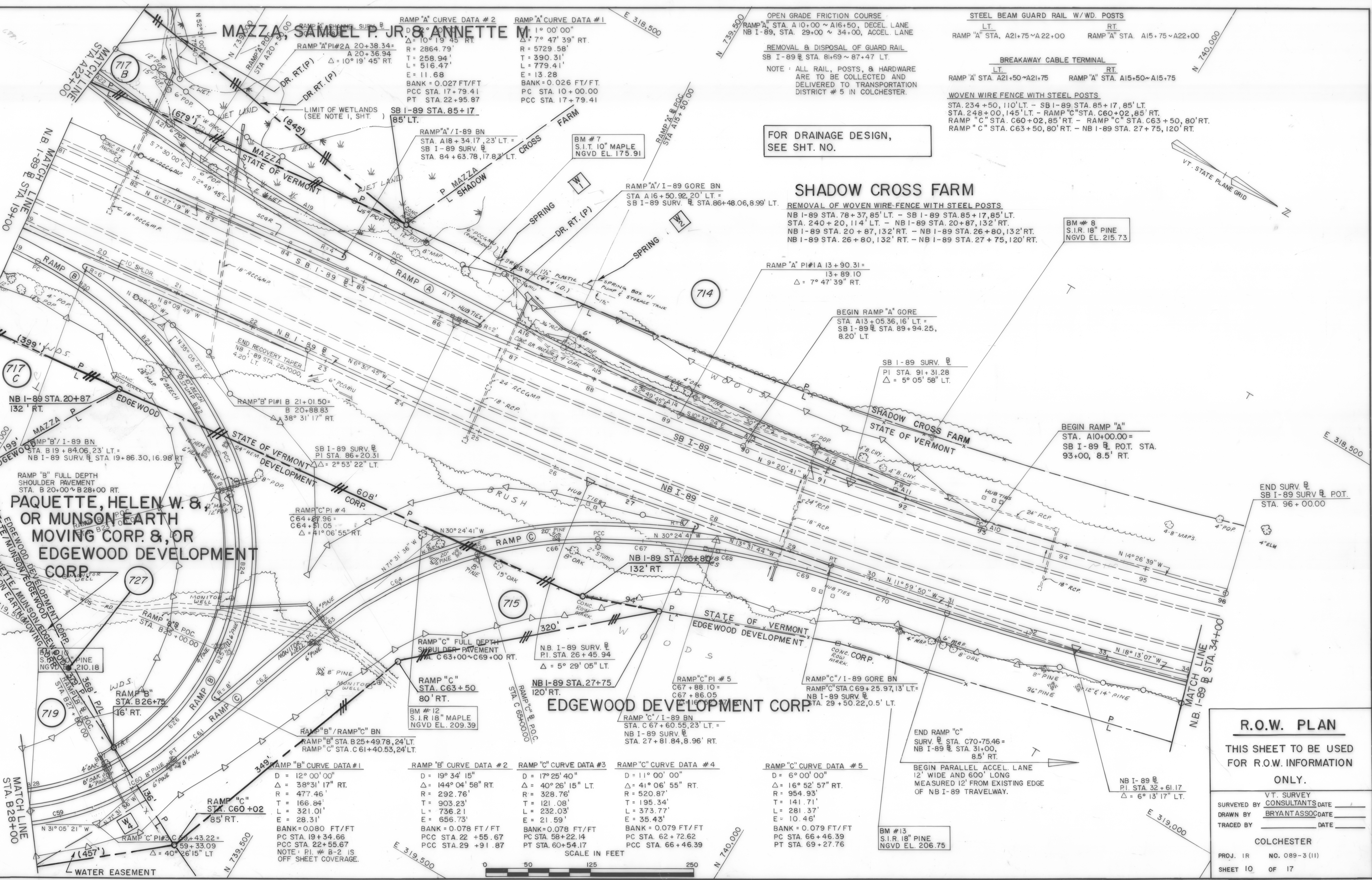

R.O.W. PLAN

THIS SHEET TO BE USED FOR R.O.W. INFORMATION ONLY.

VT. SURVEY CONSULTANTS DATE _____
 DRAWN BY BRYANT ASSOC DATE _____
 TRACED BY _____ DATE _____

COLCHESTER

PROJ. 1R NO. 089-3 (11)
 SHEET 10 OF 17