

RAMP "B" CURVE DATA #2
 D = 19° 34' 15"
 Δ = 144° 04' 56" RT.
 R = 292.76'
 T = 903.23'
 L = 736.21'
 E = 656.73'
 BANK = 0.078 FT/FT
 PCC STA. 22+56.66
 PT STA. 29+91.87

RAMP "C" CURVE DATA #3
 D = 17° 25' 40"
 Δ = 40° 26' 15" LT.
 R = 328.76'
 T = 121.08'
 L = 232.03'
 E = 21.59'
 BANK = 0.076 FT/FT
 PC STA. 58+22.14
 PT STA. 60+54.17

RAMP "C" CURVE DATA #2
 D = 57° 15' 00"
 Δ = 65° 37' 53" RT.
 R = 100.08'
 T = 92.73'
 L = 149.57'
 E = 36.35'
 BANK = 0.080 FT/FT
 PRC STA. 54+49.98
 PT STA. 55+99.55

RAMP "C" CURVE DATA #1
 D = 1° 13' 33"
 Δ = 2° 27' 05" LT.
 R = 4674.24
 T = 100.01'
 L = 199.98'
 E = 1.07'
 BANK = W.B. CONTROLLED
 PC STA. 52+50.00
 PRC STA. 54+49.98

WOVEN WIRE FENCE WITH STEEL POSTS
 NB I-89 STA. 13+25, 135' RT. - STA. 243+25, 85' RT.
 STA. 243+25, 85' RT. - STA. 251+50, 110' RT.
 STA. 251+50, 110' RT. - STA. 252+20, 280' RT.
 STA. 252+20, 280' RT. - STA. 255+65, 270' RT.
 RAMP "C" STA. C60+02, 85' RT. - STA. 248+00, 145' LT.
 STA. 248+00, 145' LT. - STA. 252+00, 125' LT.

PAQUETTE, HELEN W. & OR MUNSON EARTH MOVING CORP. & OR EDGEWOOD DEVELOPMENT CORP.

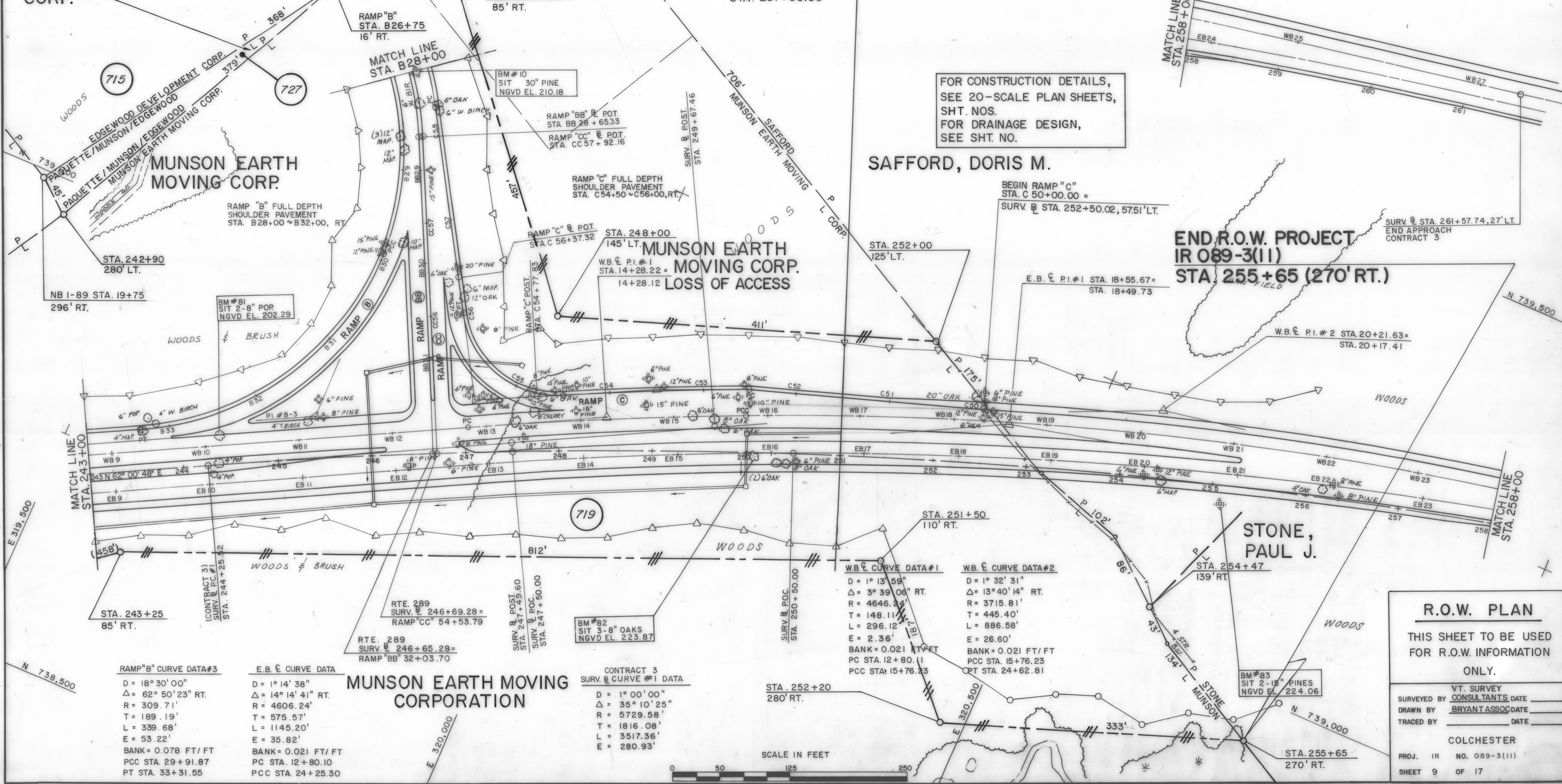

FOR CONSTRUCTION DETAILS, SEE 20-SCALE PLAN SHEETS, SHT. NOS. FOR DRAINAGE DESIGN, SEE SHT. NO.

SAFFORD, DORIS M.

END R.O.W. PROJECT IR 089-3(11) STA. 255+65 (270' RT.)

R.O.W. PLAN
 THIS SHEET TO BE USED FOR R.O.W. INFORMATION ONLY.

VT. SURVEY
 SURVEYED BY CONSULTANTS DATE _____
 DRAWN BY BRYANT ASSOC DATE _____
 TRACED BY _____ DATE _____

COLCHESTER
 PROJ. IR NO. 089-3(11)
 SHEET 9 OF 17

