

REMOVAL & DISPOSAL OF GUARD RAIL
 NB I-89 12+00 ~ 17+44, RT.
 NOTE: ALL RAIL, POSTS, AND HARDWARE ARE TO BE COLLECTED AND DELIVERED TO TRANSPORTATION DISTRICT #5 IN COLCHESTER.

RAMP "A" CURVE DATA #3
 D = 5° 30' 00"
 Δ = 13° 57' 19" LT.
 R = 1041.74'
 T = 127.50'
 L = 253.73'
 E = 7.77'
 BANK = 0.029 FT/FT
 PCC = STA. 24+03.02
 PT = STA. 26+56.75

RAMP "A" CURVE DATA #2
 D = 2° 00' 00"
 Δ = 10° 19' 45" RT.
 R = 2864.79'
 T = 258.94'
 L = 516.47'
 E = 11.68'
 BANK = 0.027 FT/FT
 PCC = STA. 17+79.41
 PT = STA. 22+95.87

RAMP "DD" CURVE DATA #1
 D = 6° 00' 00"
 Δ = 20° 32' 41" LT.
 R = 954.93'
 T = 173.06'
 L = 342.41'
 E = 15.56'
 BANK = 0.021 FT/FT
 PCC = STA. 34+97.18
 PT = STA. 38+39.59

OPEN GRADED ASPHALT FRICTION COURSE
 RAMP "B" STA. B12+00 ~ B17+00
WOVEN WIRE FENCE WITH STEEL POSTS
 STA. 229+00, 90' LT. - STA. 234+50, 110' LT.
 STA. 234+50, 110' LT. - SB I-89 STA. 85+17, 85' LT.
 STA. 229+00, 127' RT. - STA. 232+25, 105' RT.
 STA. 232+25, 105' RT. - SB I-89 STA. 71+15, 185' LT.
 NB I-89 STA. 13+25, 135' RT. - STA. 243+25, 85' RT.

REMOVAL OF WOVEN WIRE FENCE WITH STEEL POSTS
 RAMP "D" STA. D36+85, 25' RT. - SB I-89 STA. 78+37, 85' LT.
 SB I-89 STA. 78+37, 85' LT. - SB I-89 STA. 85+17, 85' LT.
 NB I-89 STA. 13+25, 135' RT. - STA. 240+20, 114' LT.
 STA. 240+20, 114' LT. - NB I-89 STA. 20+87, 132' RT.

STEEL BEAM GUARD RAIL W/ WOOD POSTS
 LT. STA. 229+00 - RAMP "A" 22+00, RT.
 RAMP "A" 22+00 - STA. 236+55
 STA. 239+95 - 241+82.50
 RT. STA. 229+00 - RAMP "D" STA. D 36+00 RT.
 RAMP "DD" 36+00 - STA. 236+00
 STA. 239+35 - 241+97.50

STEEL BEAM GUARD RAIL W/ STEEL POSTS
 RAMP "B" 12+00 ~ 18+00, RT.

GUARD RAIL APPROACH SECTION, TYPE I
 STA. 239+45 ~ 239+95, LT.
 STA. 236+00 ~ 236+50, RT.

GUARD RAIL APPROACH SECTION, TYPE II
 STA. 236+55 ~ 236+80, LT.
 STA. 239+10 ~ 239+35, RT.

BREAKAWAY CABLE TERMINAL
 STA. 241+82.50 - 242+07.50, LT.

TWISTED END SECTION (FLARED)
 STA. 241+97.50 - 242+22.50, RT.
 RAMP "B" 18+00 ~ 18+25, RT. (DO NOT FLARE)

REMOVE AND RESET GUARD RAIL
 SB I-89 STA. 76+0 ~ 77+50, LT.

RAMP "D" CURVE DATA #1
 D = 21° 59' 59"
 Δ = 82° 25' 09" RT.
 R = 260.44'
 T = 228.08'
 L = 374.64'
 E = 85.75'
 BANK = 0.080 FT/FT
 PCC = STA. 32+91.89
 PT = STA. 36+66.53

SURV. @ CURVE #12 DATA
 D = 0° 30' 00"
 Δ = 5° 34' 03"
 R = 11,459.16'
 T = 557.19'
 L = 1113.50'
 E = 13.54'
 BANK = NC

CHAN. @ 13+30.56 =
 RAMP "A" PC A24+03.02
 Δ = 27° 14' 05" LT.

BEGIN R.O.W. PROJECT
IR 089-3(11)
STA. 229+00 (127' RT. & 90' LT.)

MAZZA, SAMUEL P. JR. & ANNETTE M.

RTE. 289 SURV. @ STA. 229+00.00
 BEGIN PROJ. NO. IR 089-3(11)
 MATCH PROJ. NO. PB 033-1(1)

BM # 1
 S.I.R. 15" W. BIRCH
 NGVD EL. 131.05

END RAMP "A" @ STA. A26+56.85 =
 SURV. @ STA. 235+51.00, 32' LT.

BEGIN RAMP "DD" @ STA. DD 33+95.55 =
 SURV. @ STA. 235+36.86, 32' RT.

STA. 234+50
 110' LT.

STA. 229+00
 90' LT.

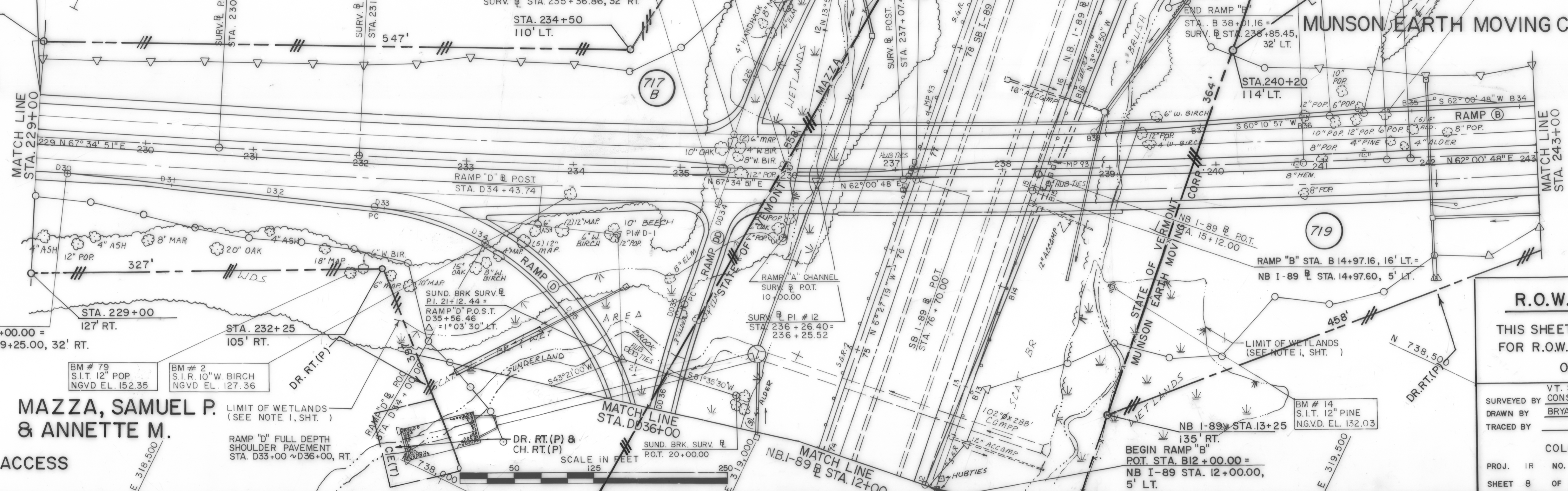

FOR HORIZONTAL ALIGNMENT
 DETAILS, SEE 20 SCALE PLANS,
 SHT. NO.
 FOR DRAINAGE DESIGN,
 SEE SHT. NO.

**PAQUETTE, HELEN W. & OR
 MUNSON EARTH MOVING CORP. & OR
 EDGEWOOD DEVELOPMENT CORP.**

**MAZZA,
 SAMUEL P. JR. &
 ANNETTE M.**

**NB I-89
 STA. 19+75
 296' RT.**

MUNSON EARTH MOVING CORP.

R.O.W. PLAN

THIS SHEET TO BE USED
 FOR R.O.W. INFORMATION
 ONLY.

SURVEYED BY _____ DATE _____
 DRAWN BY _____
 TRACED BY _____ DATE _____
 COLCHESTER
 PROJ. IR NO. 089-3(11)
 SHEET 8 OF 17

LOSS OF ACCESS

**MAZZA, SAMUEL P.
 & ANNETTE M.**

SCALE IN FEET